

# AUSTRALASIAN HFG STANDARD COMPONENTS

Room Layout Sheet

Room Name **CT Scanning - Procedure Room**

RLS Room Code **CTPR**

RDS Room Code **CTPR**

- AS ADJUSTABLE SHELF
  - COM/2 COMMUNICATION OUTLET - DOUBLE
  - CR CRASH RAIL
  - DP DOOR AND DOOR FRAME PROTECTION
  - EC EMERGENCY CALL
  - FS FIXED SHELF
  - GPO/C CLEANER'S GPO
  - GPO/1 EP EMERGENCY POWER - SINGLE
  - GPO/2 EP EMERGENCY POWER - DOUBLE
  - LS/R LIGHT SWITCH - ROOM
  - LS/DD LIGHT SWITCH + DIMMER FOR DOWNLIGHTS
  - M MEDICAL AIR
  - N2O NITROUS OXIDE
  - NA NURSE ASSIST CALL
  - O2 OXYGEN
  - OPS OBSERVATION PANEL - SLIDING COVER
  - PC2 90mm PLASTERBOARD CORNICE - FLUSH
  - RCD RESIDUAL CURRENT DEVICE
  - S SUCTION
  - SBB SUCTION BOTTLE BRACKET
  - SC SCAVENGE OUTLET
  - SK4 FLOOR VINYL COVED SKIRTING
  - V1 VINYL FLOORING, STANDARD
  - XRV/2 X-RAY VIEWER, 2 SCREEN
- 
- SERVICES PANEL 1 GPO/1 EP X 2  
RCD X 1  
EC  
NA
  - SERVICES PANEL 2 GPO/1 EP x 4  
COM/2  
RCDX1
  - SERVICES PANEL 3 O2 X 2  
N2O X 1  
MA X 1  
S X 2  
SC X 1

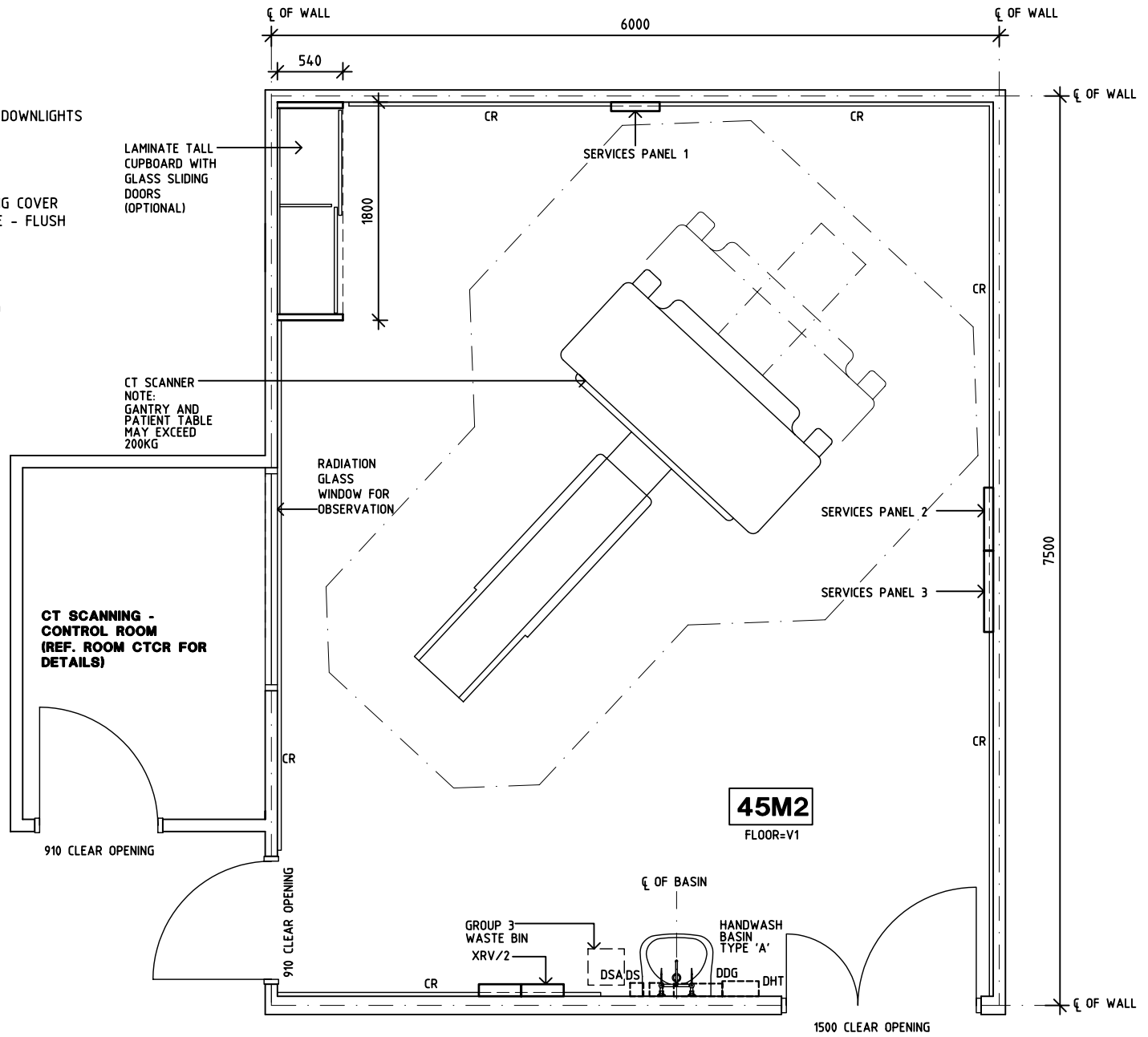

**PLAN**

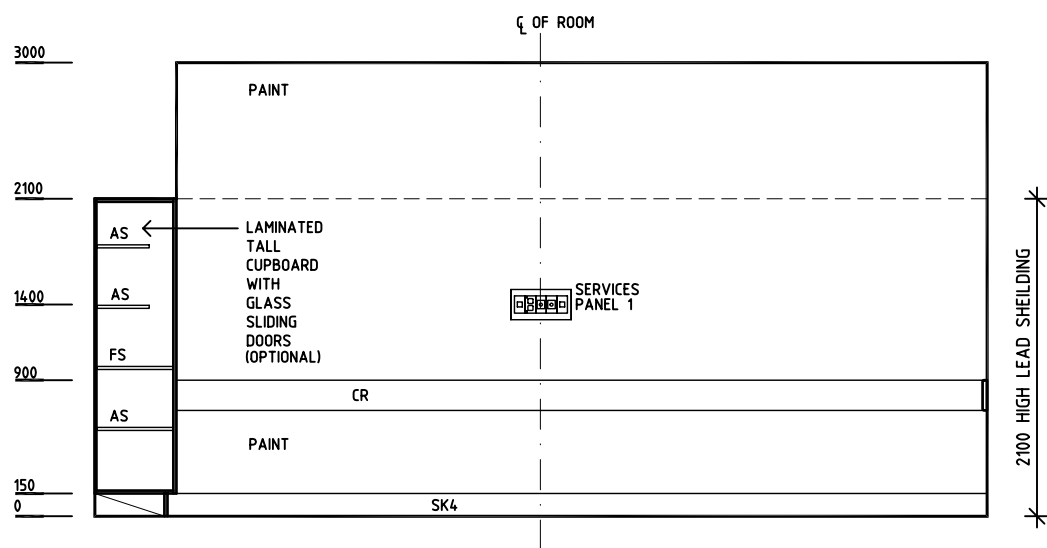

**ELEVATION 1**

REV	DESCRIPTION	DATE	BY	REV	DESCRIPTION	DATE	BY	REV	DESCRIPTION	DATE	BY
1	FIRST ISSUE	1.7.05	HS								



HPI

DESIGNED	APPROVED	SCALE(S)	ZONE(S)
HS/BJ	DB	1:50 in A3	
CAD FILE NAME CTPR		PAPER DRAWING ID CTPRa	

# NSW HFG STANDARD COMPONENTS

Room Layout Sheet

Room Name **CT Scanning - Procedure Room**

RLS Room Code **CTPR**

RDS Room Code **CTPR**

AS	ADJUSTABLE SHELF
COM/2	COMMUNICATION OUTLET - DOUBLE
CR	CRASH RAIL
DP	DOOR AND DOOR FRAME PROTECTION
EC	EMERGENCY CALL
FS	FIXED SHELF
GPO/C	CLEANER'S GPO
GPO/1 EP	EMERGENCY POWER - SINGLE
GPO/2 EP	EMERGENCY POWER - DOUBLE
LS/R	LIGHT SWITCH - ROOM
LS/DD	LIGHT SWITCH + DIMMER FOR DOWNLIGHTS
M	MEDICAL AIR
N20	NITROUS OXIDE
NA	NURSE ASSIST CALL
O2	OXYGEN
OPS	OBSERVATION PANEL - SLIDING COVER
PC2	90mm PLASTERBOARD CORNICE - FLUSH
RCD	RESIDUAL CURRENT DEVICE
S	SUCTION
SBB	SUCTION BOTTLE BRACKET
SC	SCAVENGE OUTLET
SK4	FLOOR VINYL COVED SKIRTING
V1	VINYL FLOORING, STANDARD
XR/2	X-RAY VIEWER, 2 SCREEN

SERVICES PANEL 1	GPO/1 EP X 2 RCD X 1 EC NA
SERVICES PANEL 2	GPO/1 EP x 4 COM/2 RCDX1
SERVICES PANEL 3	O2 X 2 N20 X 1 MA X 1 S X 2 SC X 1

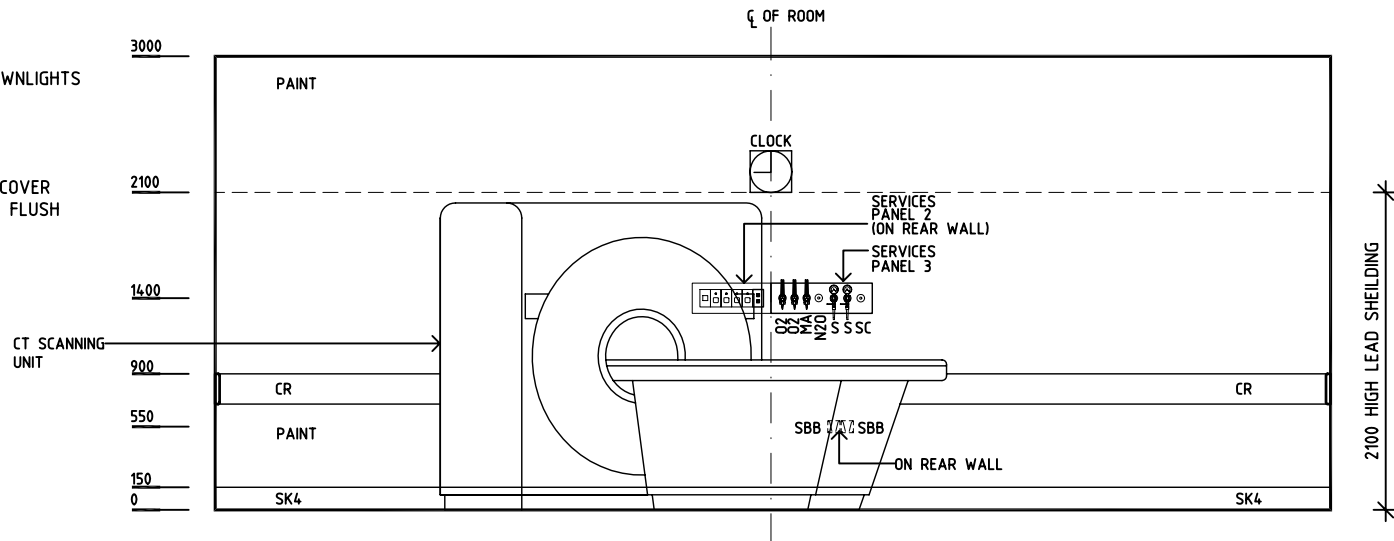

**ELEVATION 2**

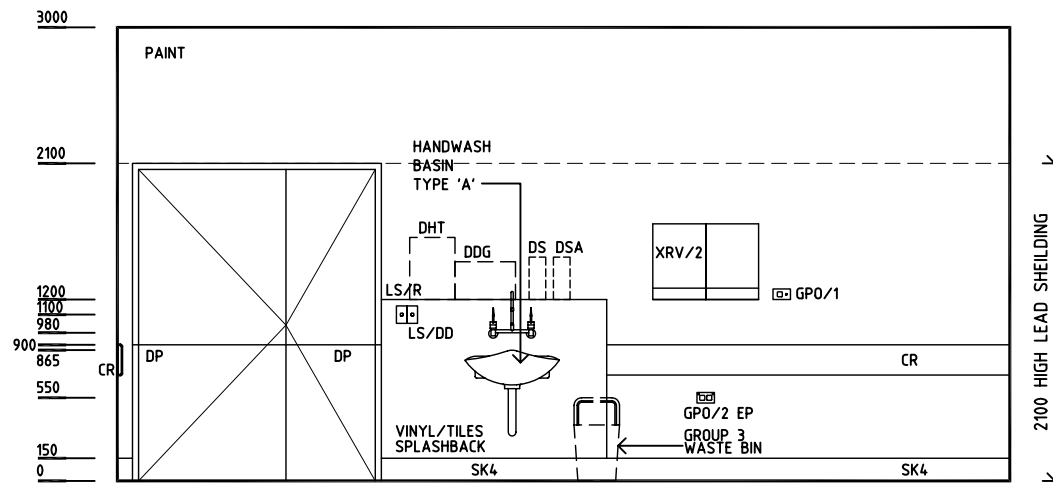

**ELEVATION 3**

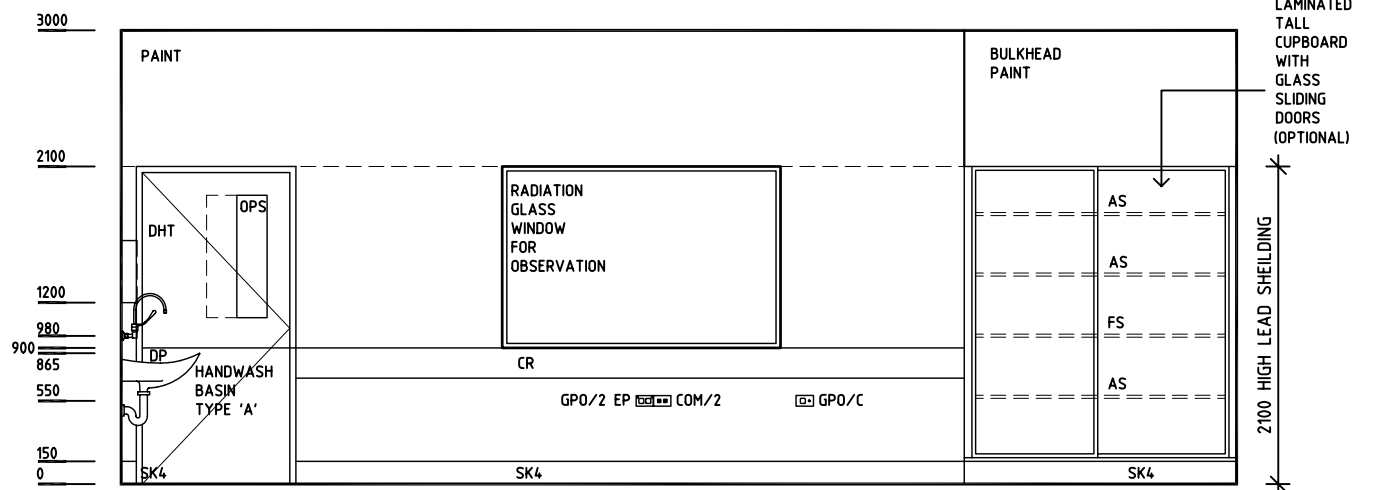

**ELEVATION 4**

REV	DESCRIPTION	DATE	BY	REV	DESCRIPTION	DATE	BY	REV	DESCRIPTION	DATE	BY
1	FIRST ISSUE	1.7.05	HS								



**HCAMC** in association with **UNSW**

HPI

DESIGNED	APPROVED	SCALE(S)	ZONE(S)
HS/BJ	DB	1:50 in A3	
CAD FILE NAME		PAPER DRAWING ID	
CTPR		CTPRb	