

AUSTRALASIAN HFG STANDARD COMPONENTS

Room Layout Sheet

Room Name **Pharmacy - Counter, 9m2**

RLS Room Code **PHA-CO**

RDS Room Code **PHA-CO**

- CAC CABLE ACCESS CAP
- COM/2 COMMUNICATIONS/DATA OUTLET - DOUBLE
- DA DURESS ALARM
- GPO/2 GENERAL PURPOSE OUTLET - DOUBLE
- GPO/2 EP EMERGENCY POWER - DOUBLE
- LS LIGHT SWITCH
- OP OBSERVATION PANEL
- PB PINBOARD, FABRIC COVERED
- SK5 VINYL FEATHER EDGE SKIRTING

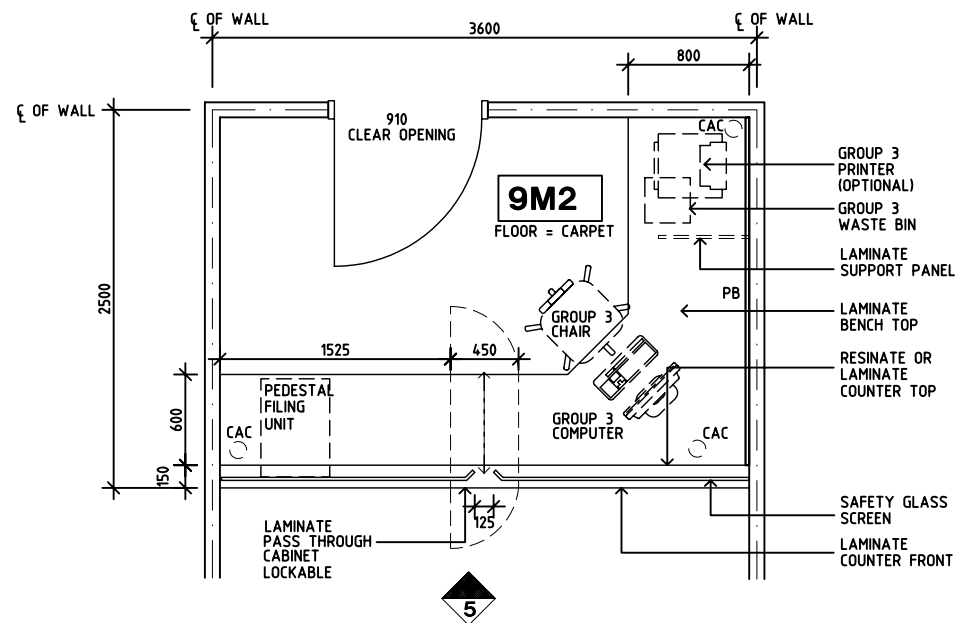

PLAN

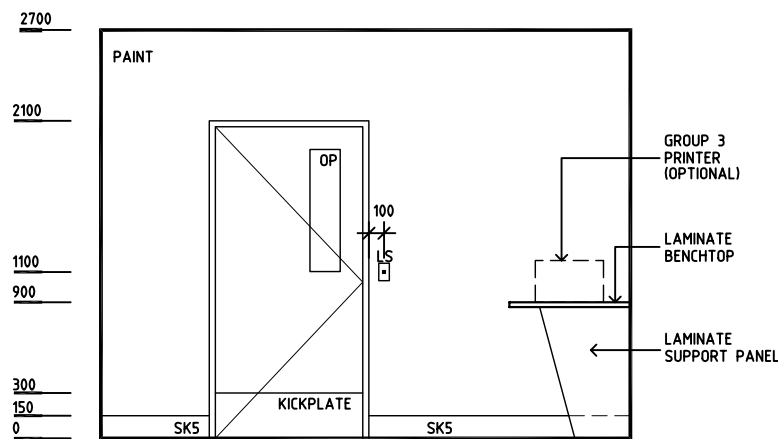

ELEVATION 1

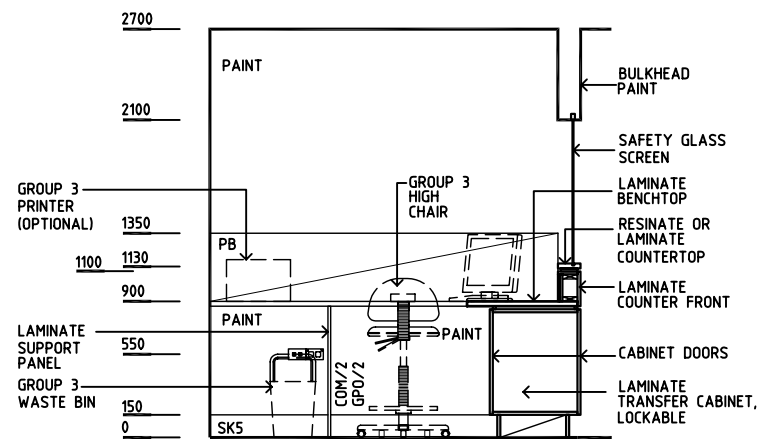

ELEVATION 2

REV	DESCRIPTION	DATE	BY	REV	DESCRIPTION	DATE	BY	REV	DESCRIPTION	DATE	BY
1	FIRST ISSUE	11.7.05	BJ								



HCAMC in association with
UNSW

HPI

DESIGNED	APPROVED	SCALE(S)	ZONE(S)
AA/CC	DB	1:50 in A3	
CAD FILE NAME PHA-CO		PAPER DRAWING ID PHA-COa	

NSW HFG STANDARD COMPONENTS

Room Layout Sheet

Room Name Pharmacy - Counter, 9m²

RLS Room Code PHA-CO

RDS Room Code PHA-CO

CAC	CABLE ACCESS CAP
COM/2	COMMUNICATIONS/DATA OUTLET - DOUBLE
DA	DURESS ALARM
GPO/2	GENERAL PURPOSE OUTLET - DOUBLE
GPO/2 EP	EMERGENCY POWER - DOUBLE
LS	LIGHT SWITCH
OP	OBSERVATION PANEL
PB	PINBOARD, FABRIC COVERED
SK5	VINYL FEATHER EDGE SKIRTING

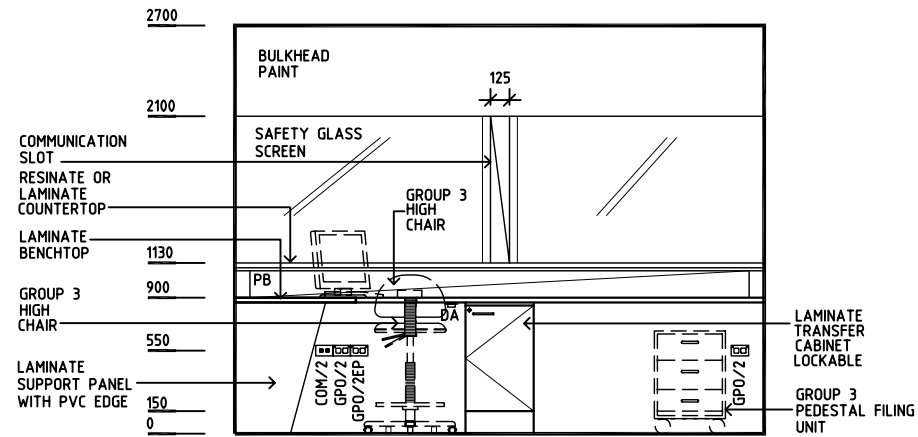

ELEVATION 3

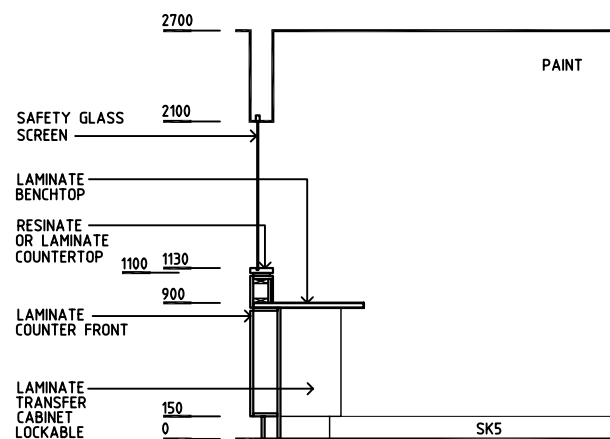

ELEVATION 4

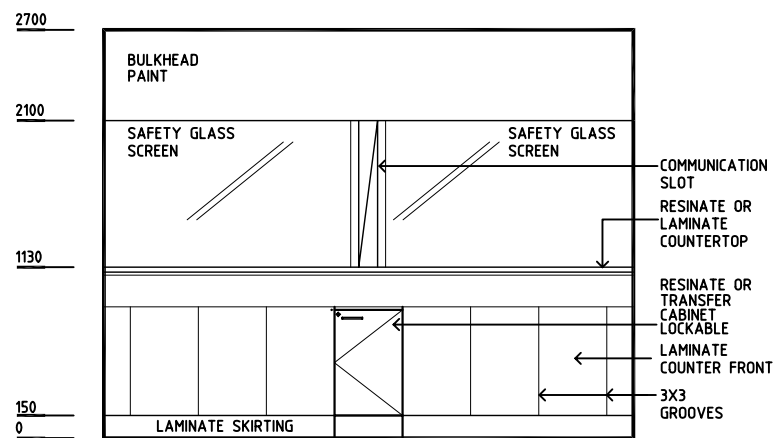

ELEVATION 5

REV	DESCRIPTION	DATE	BY	REV	DESCRIPTION	DATE	BY	REV	DESCRIPTION	DATE	BY
1	FIRST ISSUE	11.7.05	BJ								



HPI

DESIGNED AA/CC	APPROVED DB	SCALE(S) 1:50 in A3	ZONE(S)
CAD FILE NAME PHA-CO		PAPER DRAWING ID PHA-COb	