

AUSTRALASIAN HFG STANDARD COMPONENTS

Room Layout Sheet

RLS Room Code: **1BR-SP-A**

Room Name:

1:50 2.5m 2 1.5 1 0.5 0
1 BED ROOM - SPECIAL, 18m²

BIM ID	DESCRIPTION
2000	FLOOR VINYL COVED SKIRTING
2526	VINYL FLOORING, NON-SLIP 2526
2527	WALL SPLASHBACK
3092	WALL PROTECTION
4030	CORNER GUARD ANGLED
7001	WINDOWS
8010	DOOR PROTECTION
8040	DOOR PROTECTION - FRAME
FE-2800	BASIN - HANDWASH, TYPE B
FE-5622	BED - INPATIENT, ELECTRIC + STANDARD PATIENT MATTRESS
FE-54510	TELEPHONE - HANDSET, STANDARD
FF-150	AIR FLOWMETER
FF-1465	BRACKET - SUCTION BOTTLE
FF-2150	CHAIR - PATIENT
FF-2650	CHAIR - VISITOR, PATIENT
FF-4330	LAMINATED TALL CUPBOARD - WARDROBE
FF-4600	CURTAIN TRACK - BED SCREEN
FF-4900	CURTAIN TRACK - WINDOW
FF-5000	CURTAIN - BED SCREEN
FF-5410	CURTAIN - WINDOW DRAPES
FF-5547	PATIENT ENTERTAINMENT
FF-5824	WASTE BIN, GENERAL
FF-5825	BRACKET - PATIENT ENTERTAINMENT, CEILING
FF-5831	SHELF - LAMINATE, FLOWERS
FF-6152	DISPENSER - DISPOSABLE GLOVES
FF-6154	DISPENSER - HAND TOWEL
FF-6156	DISPENSER - SOAP
FF-6158	DISPENSER - SOAP ANTISEPTIC
FF-12450	MOBILE LOCKER - BEDSIDE
FF-16200	TABLE - OVERBED
FF-16250	OXYGEN FLOWMETER
FF-21950	SUCTION ADAPTER
FF-22000	SUCTION BOTTLE
S-1006	VOICE DATA OUTLET - DOUBLE
S-1090	TV - MATV
S-1951	STAFF ASSIST CALL
S-6050	SPECIAL - READING LIGHT, UP-DOWN
S-6060	SPECIAL - NIGHT LIGHT
S-6200	LIGHT SWITCH
S-7000	MEDICAL GAS OUTLET - OXYGEN
S-7020	MEDICAL GAS OUTLET - MEDICAL AIR
S-7040	MEDICAL GAS OUTLET - SUCTION
S-8000	PATIENT TO STAFF CALL
S-8005	PATIENT CALL HANDSET
S-8080	EMERGENCY CALL
S-9000	GENERAL POWER OUTLET - SINGLE
S-9000	GENERAL POWER OUTLET - SINGLE
S-9010	EMERGENCY POWER OUTLET - SINGLE
S-9015	GENERAL POWER OUTLET - CLEANER
S-9040	BODY PROTECTED
S-11000	MEDICAL SERVICES PANEL
S-9000200	GENERAL POWER OUTLET - SPECIAL MOUNT ON CEILING
S-9001650	GENERAL POWER OUTLET - DOUBLE (RCD PROTECTED)

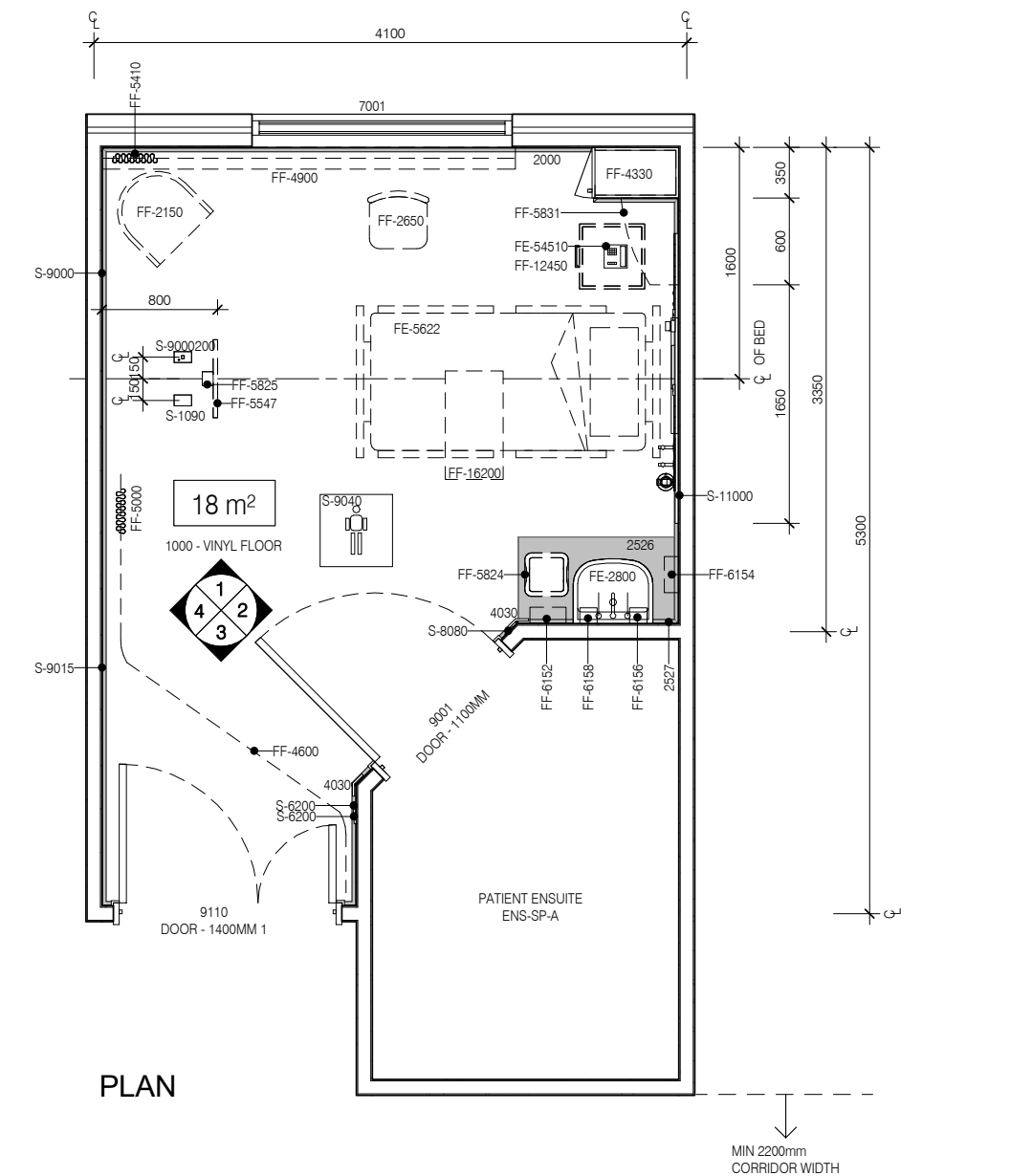
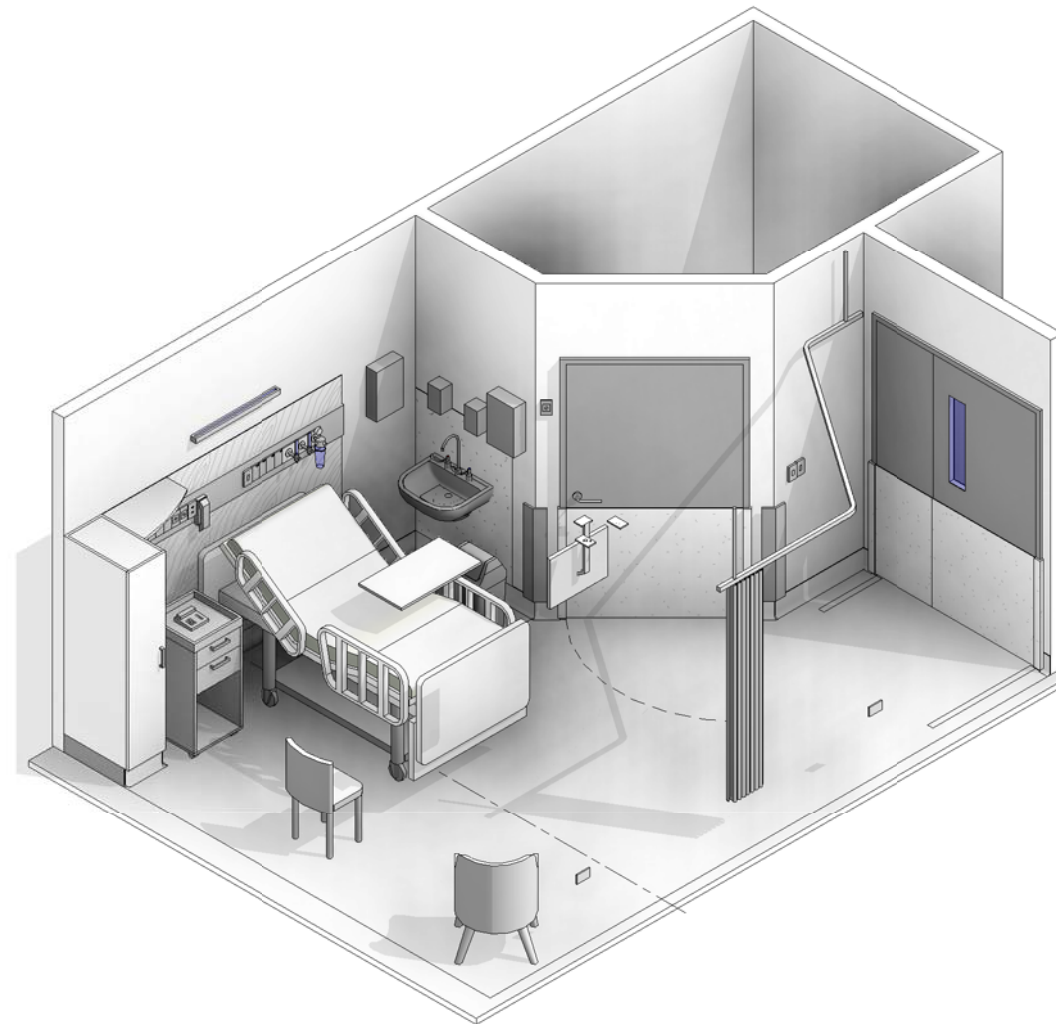

PLAN



REV	DESCRIPTION	DATE
2	This RLS has been redocumented	01.03.2016

FOR GUIDANCE

SCALE	RLS Room Code	Room Tag	REV
1 : 50 @ A3	1BR-SP-A	1.007.1	2

AUSTRALASIAN HFG STANDARD COMPONENTS

Room Layout Sheet

RLS Room Code: **1BR-SP-A**

Room Name:

1 BED ROOM - SPECIAL, 18m²

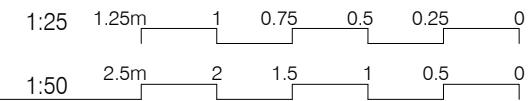

BIM ID	Description
2000	FLOOR VINYL COVED SKIRTING
2526	VINYL FLOORING, NON-SLIP 2526
2527	WALL SPLASHBACK
3092	WALL PROTECTION
4030	CORNER GUARD ANGLED
7001	WINDOWS
8010	DOOR PROTECTION
8040	DOOR PROTECTION - FRAME
FE-2800	BASIN - HANDWASH, TYPE B
FE-5622	BED - INPATIENT, ELECTRIC + STANDARD PATIENT MATTRESS
FE-54510	TELEPHONE - HANDSET, STANDARD
FF-150	AIR FLOWMETER
FF-1465	BRACKET - SUCTION BOTTLE
FF-2150	CHAIR - PATIENT
FF-2650	CHAIR - VISITOR, PATIENT
FF-4330	LAMINATED TALL CUPBOARD - WARDROBE
FF-4600	CURTAIN TRACK - BED SCREEN
FF-4900	CURTAIN TRACK - WINDOW
FF-5000	CURTAIN - BED SCREEN
FF-5410	CURTAIN - WINDOW DRAPES
FF-5547	PATIENT ENTERTAINMENT
FF-5824	WASTE BIN, GENERAL
FF-5825	BRACKET - PATIENT ENTERTAINMENT, CEILING
FF-5831	SHELF - LAMINATE, FLOWERS
FF-6152	DISPENSER - DISPOSABLE GLOVES
FF-6154	DISPENSER - HAND TOWEL
FF-6156	DISPENSER - SOAP
FF-6158	DISPENSER - SOAP ANTISEPTIC
FF-12450	MOBILE LOCKER - BEDSIDE
FF-16200	TABLE - OVERBED
FF-16250	OXYGEN FLOWMETER
FF-21950	SUCTION ADAPTER
FF-22000	SUCTION BOTTLE
S-1006	VOICE DATA OUTLET - DOUBLE
S-1090	TV - MATV
S-1951	STAFF ASSIST CALL
S-6050	SPECIAL - READING LIGHT, UP-DOWN
S-6060	SPECIAL - NIGHT LIGHT
S-6200	LIGHT SWITCH
S-7000	MEDICAL GAS OUTLET - OXYGEN
S-7020	MEDICAL GAS OUTLET - MEDICAL AIR
S-7040	MEDICAL GAS OUTLET - SUCTION
S-8000	PATIENT TO STAFF CALL
S-8005	PATIENT CALL HANDSET
S-8080	EMERGENCY CALL
S-9000	GENERAL POWER OUTLET - SINGLE
S-9000	GENERAL POWER OUTLET - SINGLE
S-9010	EMERGENCY POWER OUTLET - SINGLE
S-9015	GENERAL POWER OUTLET - CLEANER
S-9040	BODY PROTECTED
S-11000	MEDICAL SERVICES PANEL
S-9000200	GENERAL POWER OUTLET - SPECIAL MOUNT ON CEILING
S-9001650	GENERAL POWER OUTLET - DOUBLE (RCD PROTECTED)

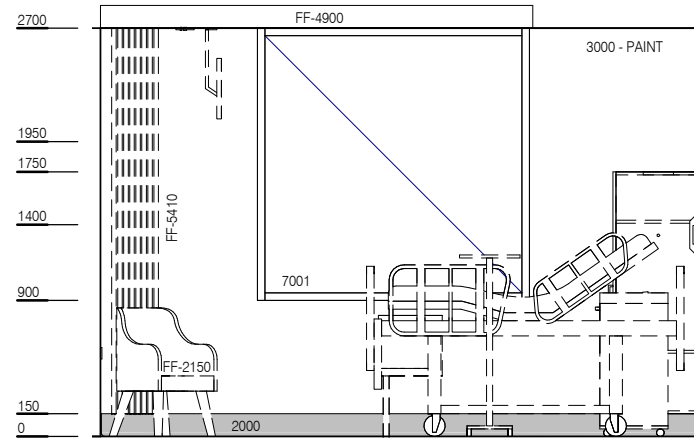

ELEVATION 1

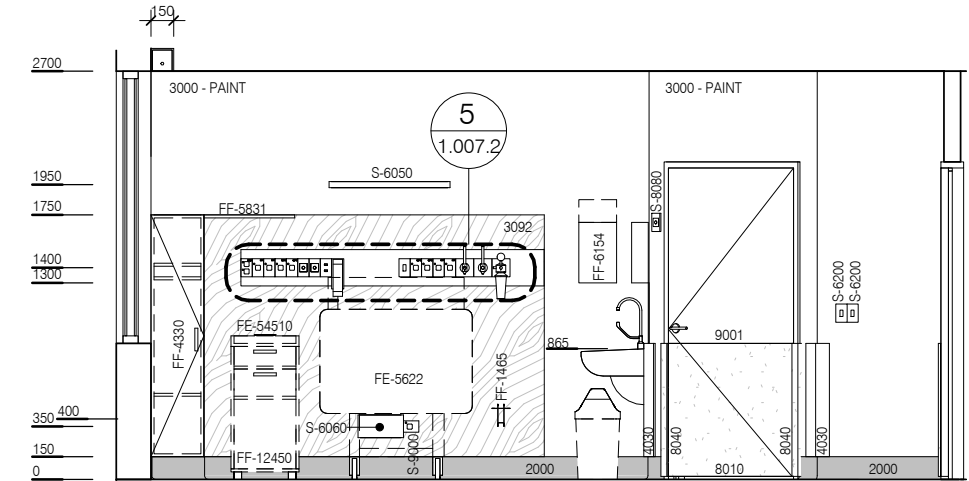

ELEVATION 2

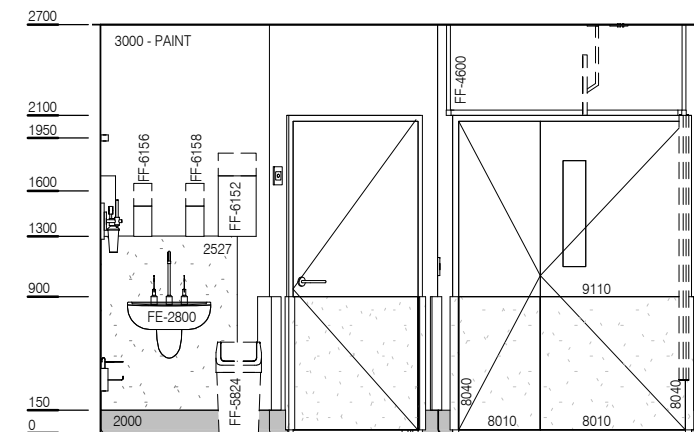

ELEVATION 3

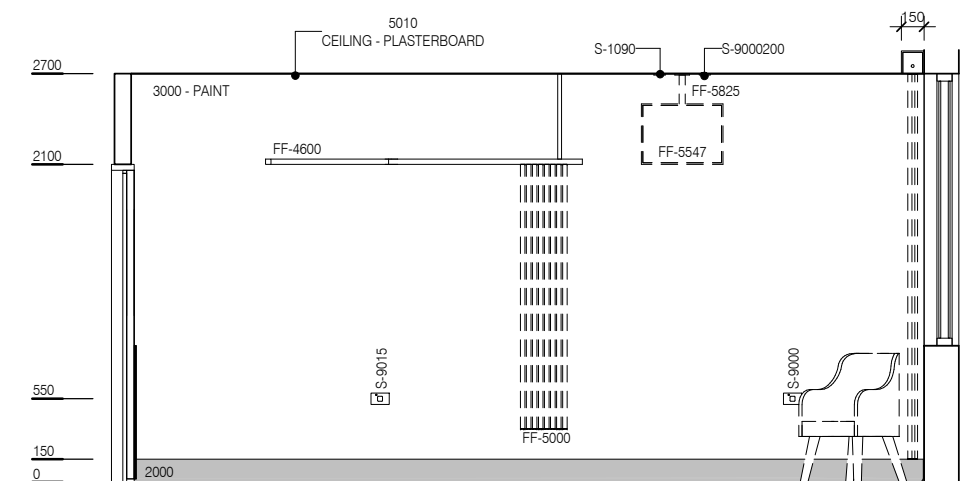

ELEVATION 4

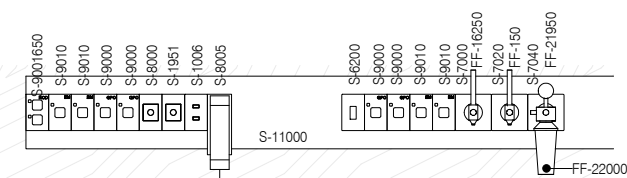

ELEVATION 5 (1 : 25 @ A3)



REV	DESCRIPTION	DATE
2	This RLS has been redocumented	01.03.2016

FOR GUIDANCE

SCALE	RLS Room Code	Room Tag	REV
1 : 50 @ A3	1BR-SP-A	1.007.2	2