

AUSTRALASIAN HFG STANDARD COMPONENTS

Room Layout Sheet

RLS Room Code: OFF-CLN

Room Name:

1:50 2.5m 2 1.5 1 0.5 0
OFFICE - CLINICAL WORKROOM

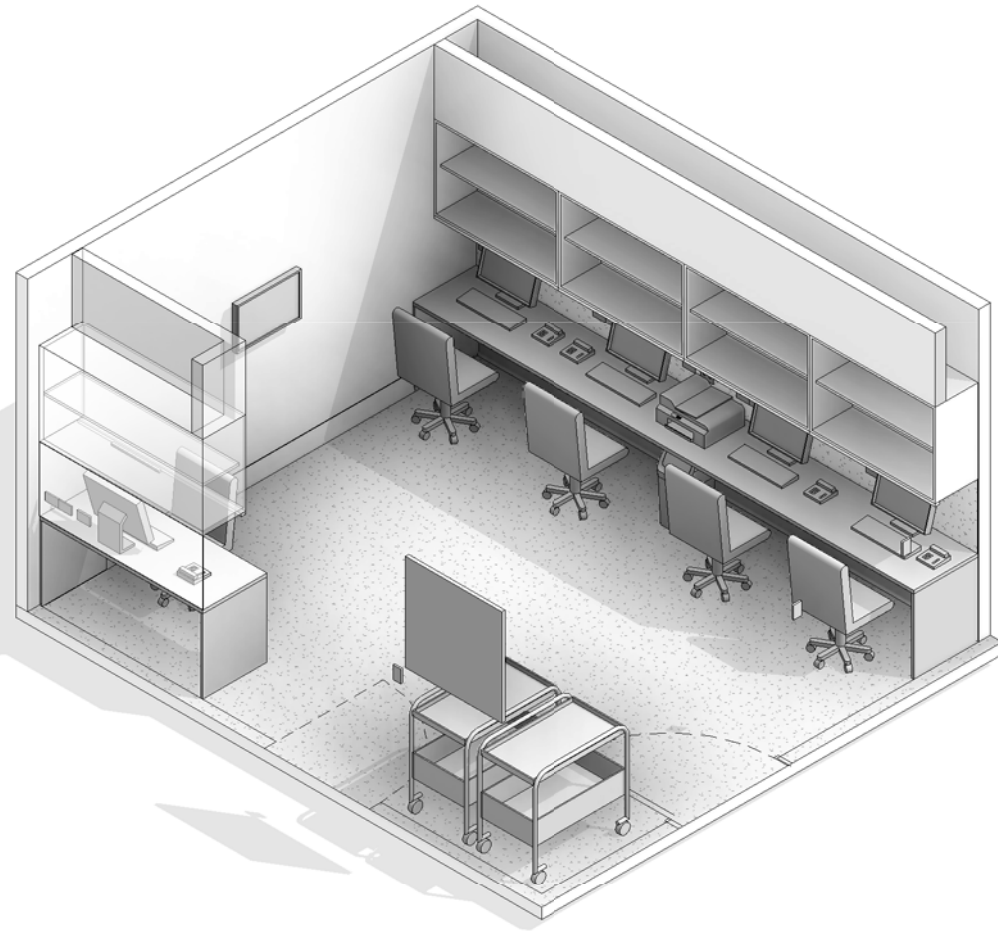

| BIMID | DESCRIPTION |
|----------|---|
| 2010 | SKIRTING VINYL, FEATHERED EDGED, 150mmH |
| 2591 | DOOR PROTECTION - KICKPLATE - 2591 |
| 7030 | OBSERVATION |
| FE-5835 | MONITOR - PATIENT FLOW, FLAT SCREEN |
| FE-11400 | COMPUTER - PC & MONITOR |
| FE-41100 | PRINTER - NETWORKED |
| FE-54510 | TELEPHONE - HANDSET, STANDARD |
| FF-1050 | BENCHTOP - LAMINATE |
| FF-2100 | CHAIR - ERGONOMIC OFFICE |
| FF-5824 | WASTE BIN, GENERAL |
| FF-5974 | BRACKET - PATIENT FLOW MONITOR |
| FF-17360 | PINBOARD - FABRIC COVERED |
| FF-20000 | ADJUSTABLE SHELVES |
| FF-23980 | TROLLEY - MEDICAL RECORDS |
| FF-24405 | WHITEBOARD - MAGNETIC |
| S-1006 | VOICE DATA OUTLET - DOUBLE |
| S-6055 | SPECIAL TASK LIGHT, BUILT-IN |
| S-6200 | LIGHT SWITCH |
| S-9001 | GENERAL POWER OUTLET - DOUBLE |

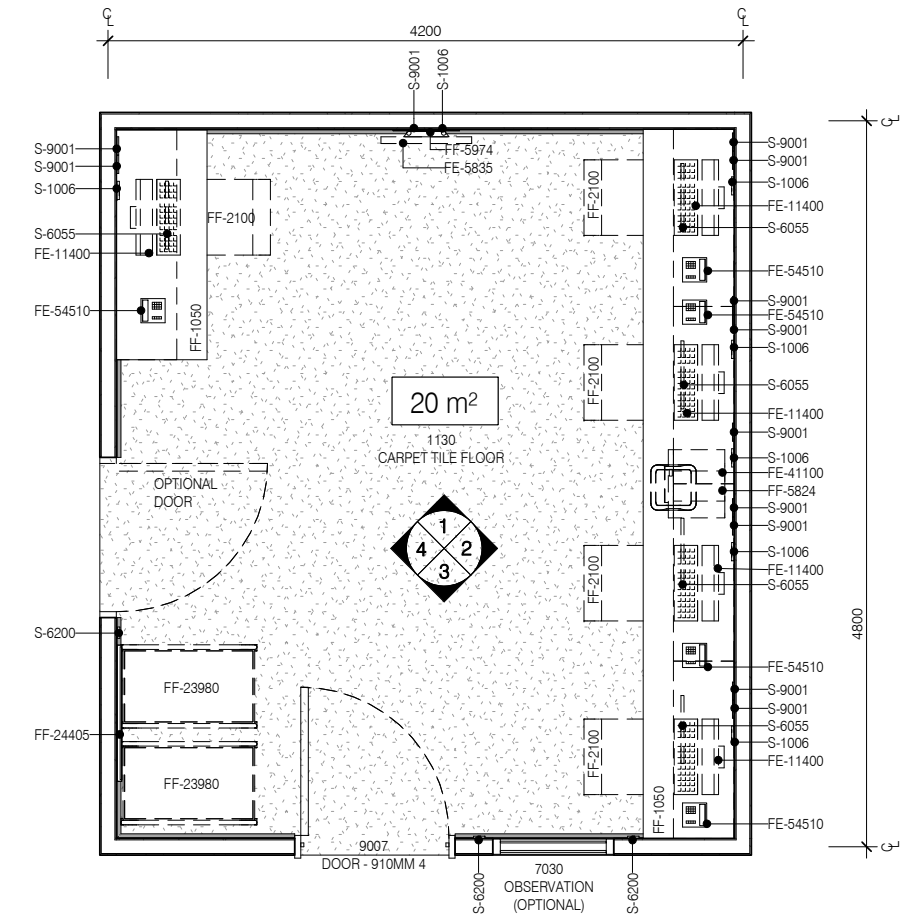

PLAN

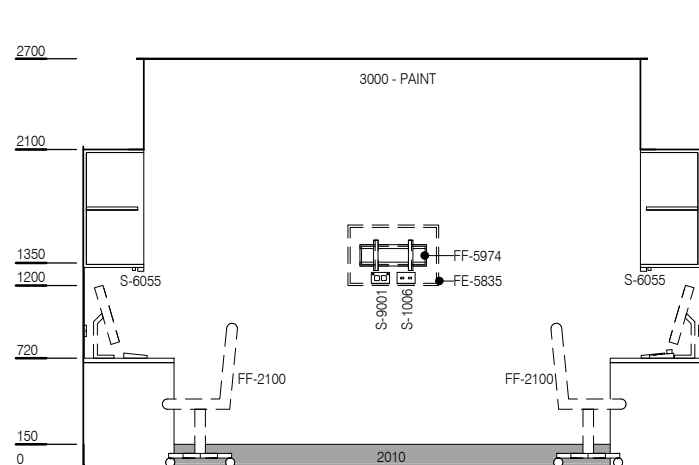

ELEVATION 1

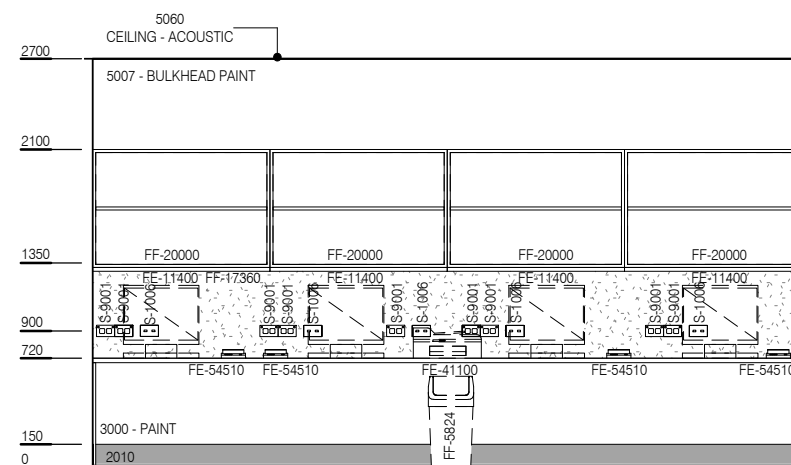

ELEVATION 2

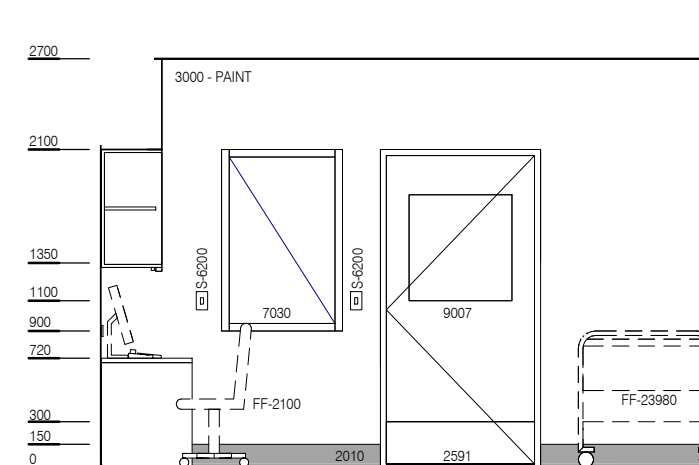

ELEVATION 3

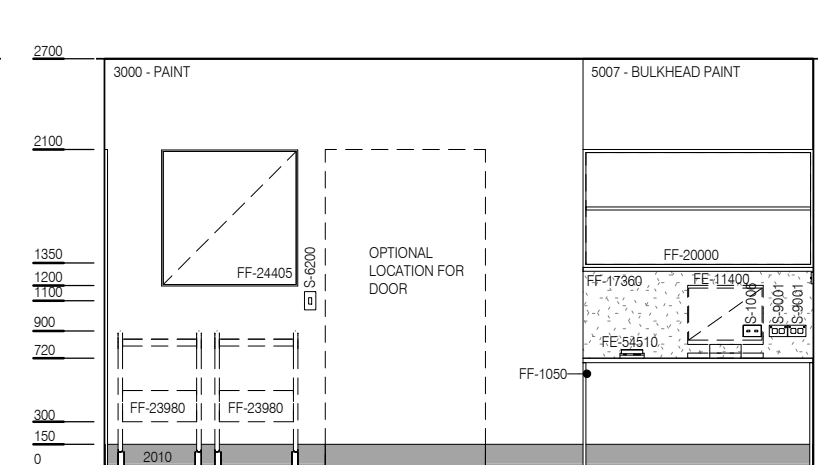

ELEVATION 4



| REV | DESCRIPTION | DATE |
|-----|---|------------|
| 4 | This RLS has been reviewed, redocumented and reissued | 01.03.2016 |

FOR GUIDANCE

| SCALE | RLS Room Code | Room Tag | REV |
|-------------|---------------|----------|-----|
| 1 : 50 @ A3 | OFF-CLN | 1.145 | 4 |