

# AUSTRALASIAN HFG STANDARD COMPONENTS

Room Layout Sheet

RLS Room Code: **SRM-18**

1:50 2.5m 2 1.5 1 0.5 0

Room Name:

**STAFF ROOM, 18m<sup>2</sup>**

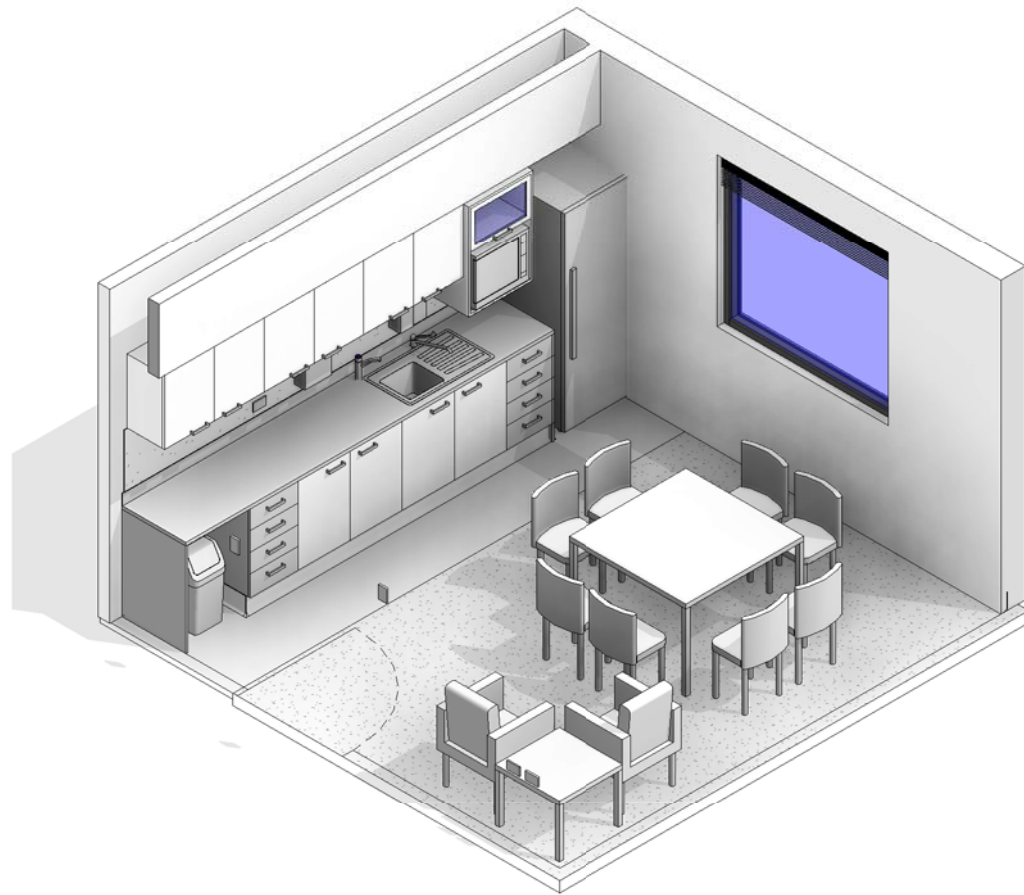

BIM ID	DESCRIPTION
2000	FLOOR VINYL COVERED SKIRTING
2010	SKIRTING VINYL, FEATHERED EDGED, 150mmH
2527	WALL SPLASHBACK
2710	DOOR PROTECTION - KICKPLATE - 2710
7001	WINDOWS
FE-2795	TELEVISION
FE-5080	BOILINGCHILLED WATER UNIT (COMB)
FE-5080	TAPWARE - BOILINGCHILLED WATER UNIT (COMB)
FE-35400	OVEN - MICROWAVE, DOMESTIC
FE-40403	TAPWARE - ACCESSIBLE BASIN MIXER
FE-44100	REFRIGERATOR - 250 LITRE, DOMESTIC
FE-47890	SINK WITH DRAINER, STAINLESS STEEL
FF-1050	BENCHTOP - LAMINATE
FF-1250	EXTERNAL WINDOW DRESSING - FF-1250
FF-1700	CHAIR - STAFF DINING
FF-2000	CHAIR - LOUNGE
FF-4410	CUPBOARD - UNDER BENCH DOUBLE - 970W X 870H X 600D
FF-4430	CUPBOARD DRAWER UNITS 450W
FF-4460	CUPBOARD - WALL MOUNTED
FF-5824	WASTE BIN, GENERAL
FF-6154	DISPENSER - HAND TOWEL
FF-6156	DISPENSER - SOAP
FF-16455	MAGAZINE RACK
FF-17360	PINBOARD - FABRIC COVERED
FF-19990	SHELVING UNIT, MICROWAVE WITH ADJUSTABLE SHELVES
FF-22800	TABLE - LOW
FF-23000	TABLE - DINING
FF-23410	TV BRACKET
FF-24405	WHITEBOARD - MAGNETIC
S-1005	VOICE DATA OUTLET - SINGLE
S-1006	VOICE DATA OUTLET - DOUBLE
S-1050	TELEPHONE - STANDARD - WALL MOUNTED
S-1090	TV - MATV
S-6200	LIGHT SWITCH
S-9000	GENERAL POWER OUTLET - SINGLE
S-9000	GENERAL POWER OUTLET - SINGLE
S-9001	GENERAL POWER OUTLET - DOUBLE

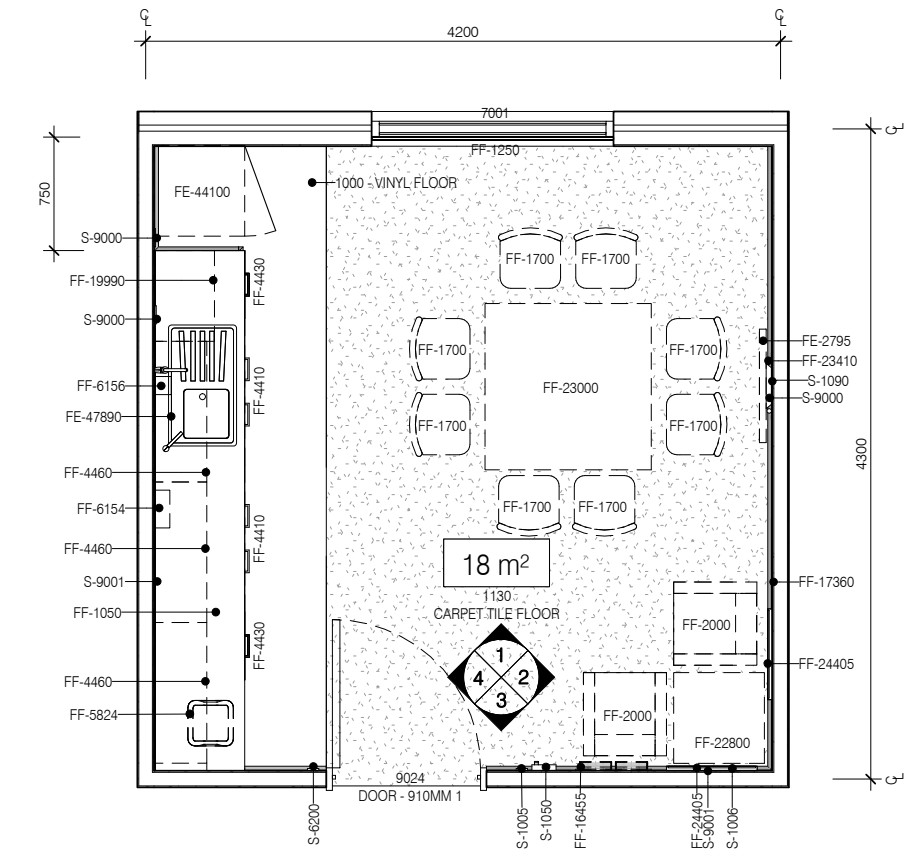

PLAN

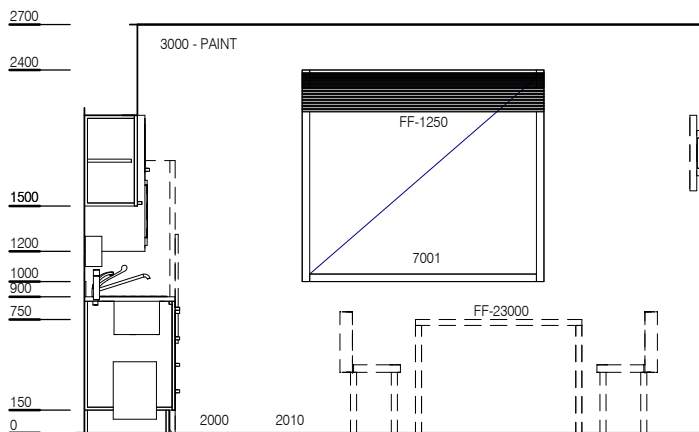

ELEVATION 1

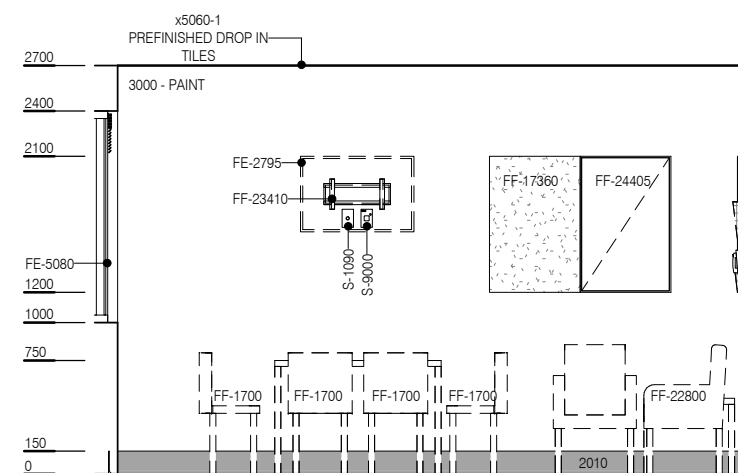

ELEVATION 2

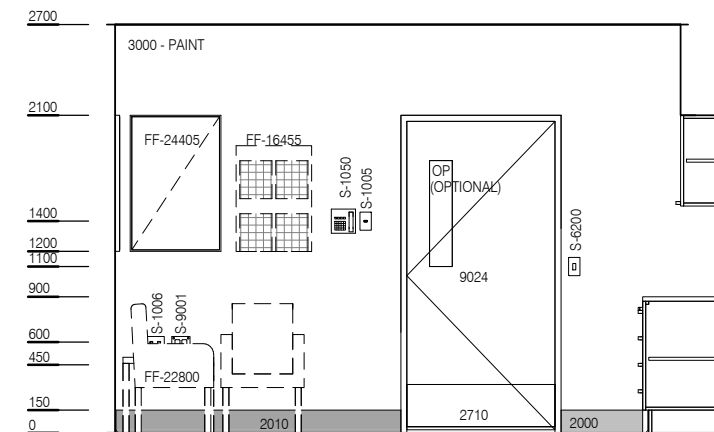

ELEVATION 3

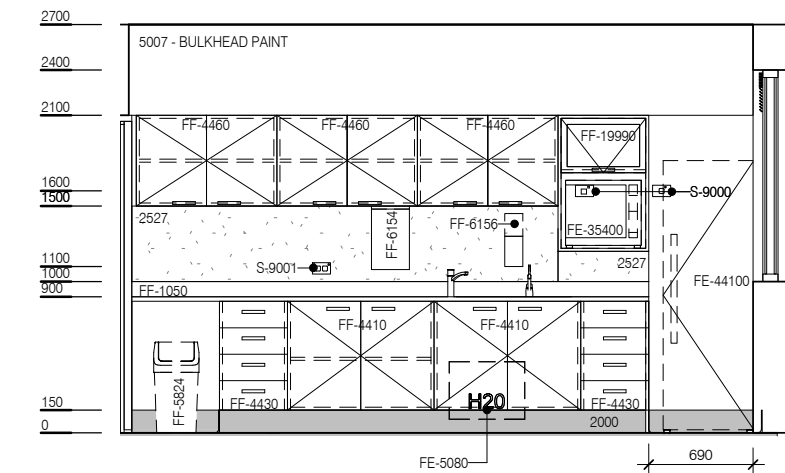

ELEVATION 4



REV	DESCRIPTION	DATE
3	This RLS has been reviewed, redocumented and reissued	01.03.2016

FOR GUIDANCE

SCALE	RLS Room Code	Room Tag	REV
1 : 50 @ A3	SRM-18	1.202	3