

AUSTRALASIAN HFG STANDARD COMPONENTS

Room Layout Sheet

RLS Room Code: STPS-10

Room Name:

STORE - PHOTOCOPY/ STATIONERY, 10m²

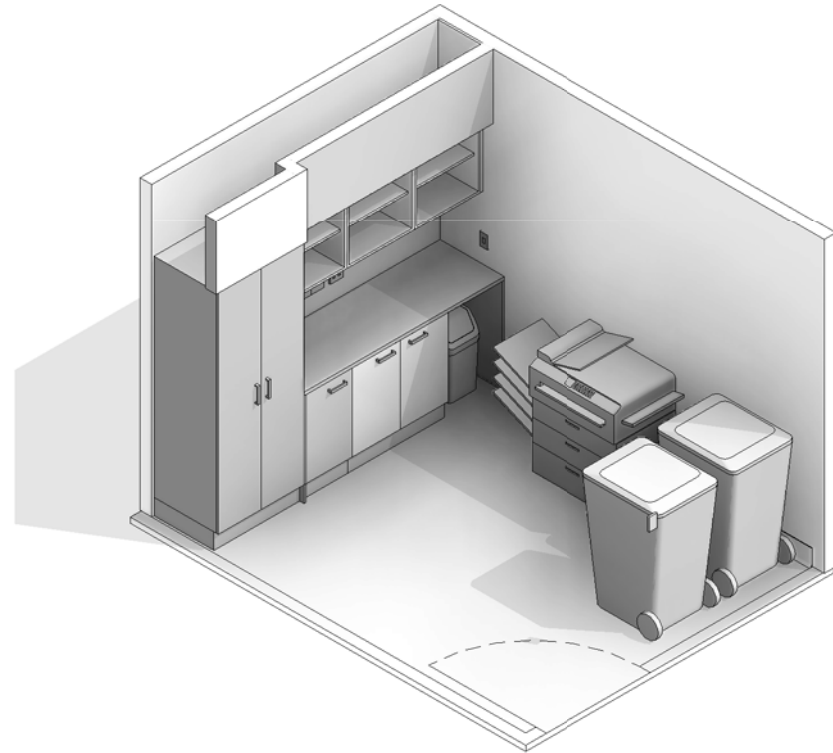
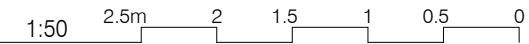

BIM ID	DESCRIPTION
2000	FLOOR VINYL COVERED SKIRTING
2539	DOOR PROTECTION - KICKPLATE - 2539
2668	WALL PROTECTION
FE-6040	MULTIFUNCTIONAL DEVICE, FREESTANDING
FF-1050	BENCHTOP - LAMINATE
FF-4360	CUPBOARD - DBL FULL HEIGHT
FF-4420	CUPBOARD - UNDER BENCH - 450W X 870H X 600D
FF-4420	CUPBOARD - UNDER BENCH DOUBLE - 900W X 870H X 600D
FF-5824	WASTE BIN, GENERAL
FF-6559	240L WASTE BIN - SECURE PAPER
FF-20000	ADJUSTABLE SHELVES
FF-24104	240L WASTE BIN - RECYCLING
S-1006	VOICE DATA OUTLET - DOUBLE
S-6055	SPECIAL TASK LIGHT, BUILT-IN
S-6200	LIGHT SWITCH
S-9000	GENERAL POWER OUTLET - SINGLE
S-9001	GENERAL POWER OUTLET - DOUBLE

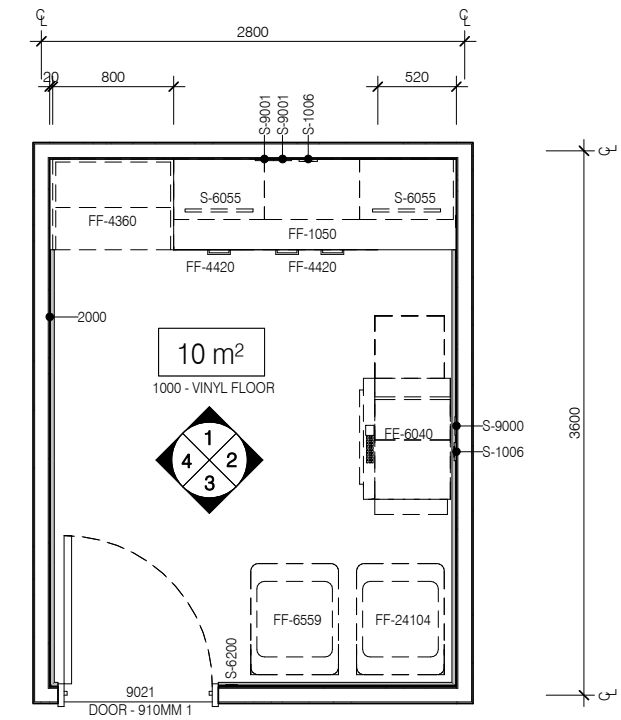

PLAN

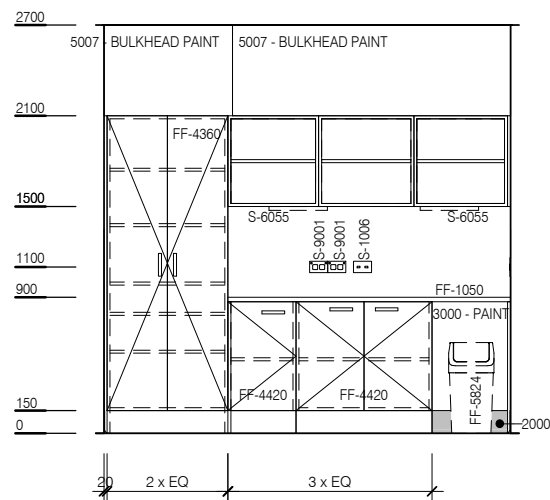

ELEVATION 1

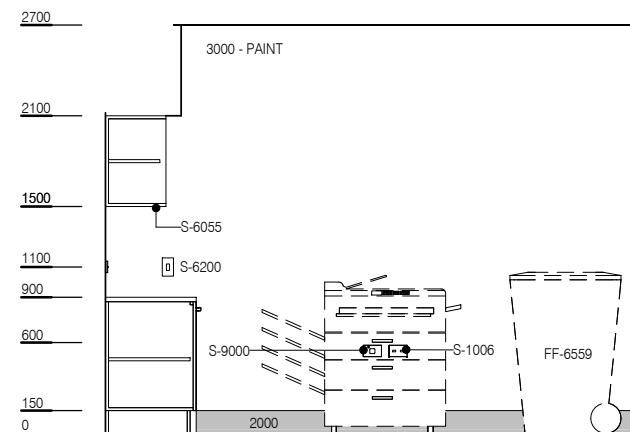

ELEVATION 2

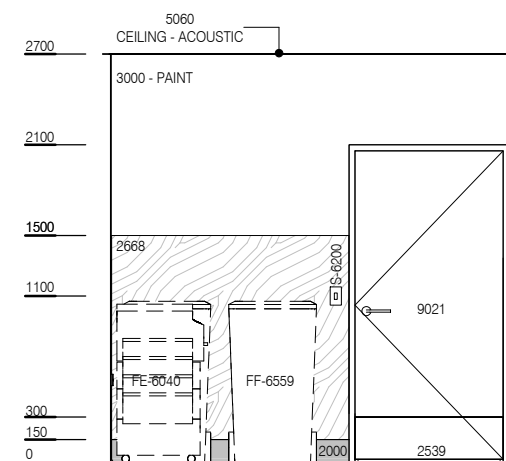

ELEVATION 3

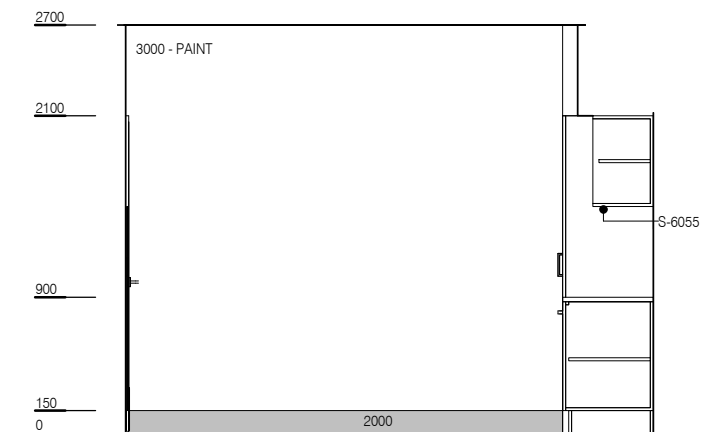

ELEVATION 4



REV	DESCRIPTION	DATE
2	This RLS has been reviewed, redocumented and reissued	01.03.2016

FOR GUIDANCE

SCALE	RLS Room Code	Room Tag	REV
1 : 50 @ A3	STPS-10	1.226	2