

AUSTRALASIAN HFG STANDARD COMPONENTS

Room Layout Sheet

RLS Room Code: **WAIT-SEC**

1:50 2.5m 2 1.5 1 0.5 0

Room Name:

WAITING - SECURE, 6m²

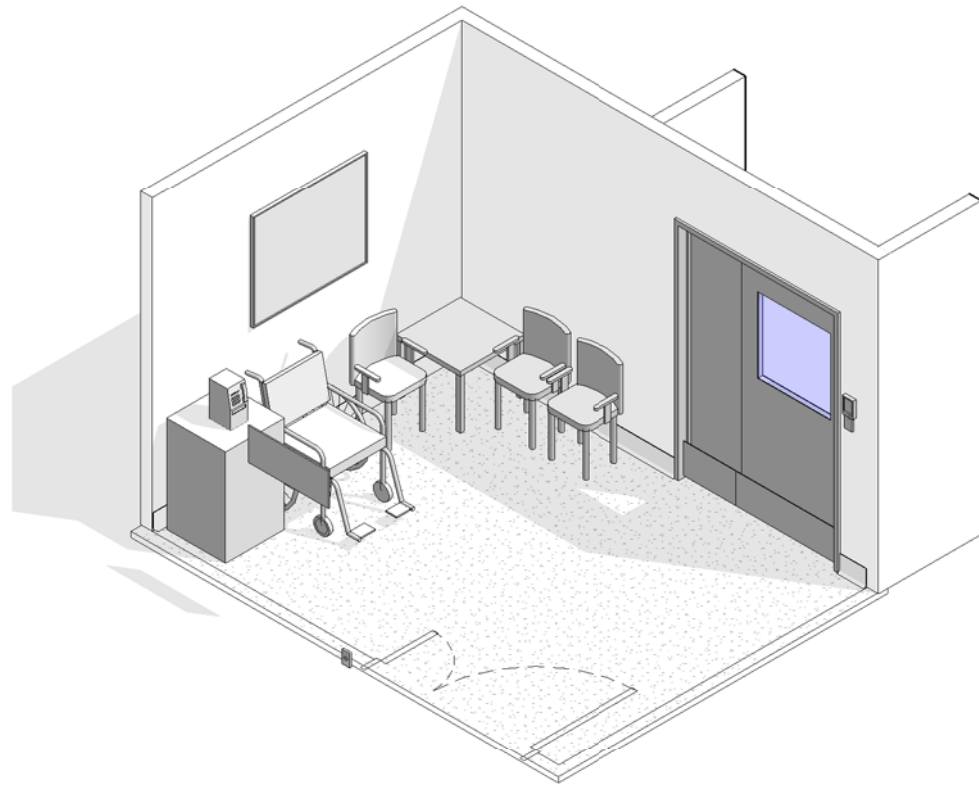

| BIMID | DESCRIPTION |
|----------|------------------------------------|
| 2000 | FLOOR VINYL COVERED SKIRTING |
| 7010 | 7010 - INTERNAL OBSERVATION |
| 8000 | DOOR PROTECTION - KICKPLATE - 8000 |
| FE-41900 | TELEPHONE - PUBLIC |
| FF-2700 | CHAIR - WAITING FF-2700 |
| FF-13121 | MAGAZINE AND PAMPHLET RACK - SMALL |
| FF-17361 | PINBOARD |
| FF-22800 | TABLE - LOW |
| FF-23295 | STAND FOR PHONE |
| S-1005 | VOICE DATA OUTLET - SINGLE |
| S-1035 | DOOR BUZZER |
| S-1040 | INTERCOM HANDS FREE |
| S-9001 | GENERAL POWER OUTLET - DOUBLE |

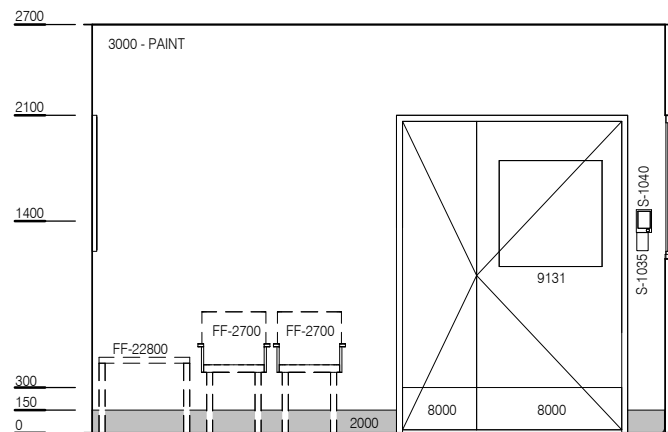
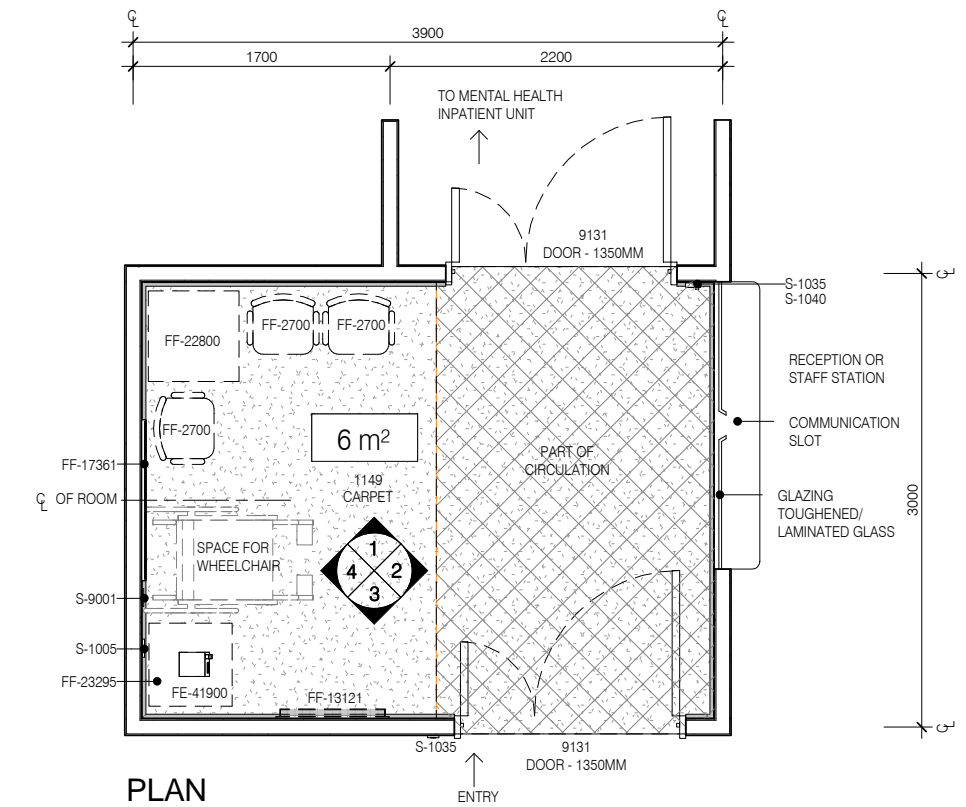

ELEVATION 1

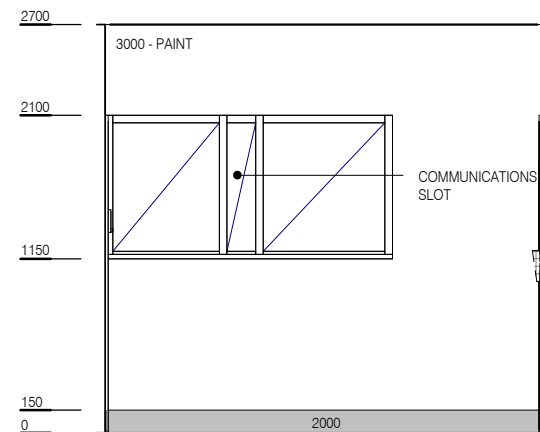

ELEVATION 2

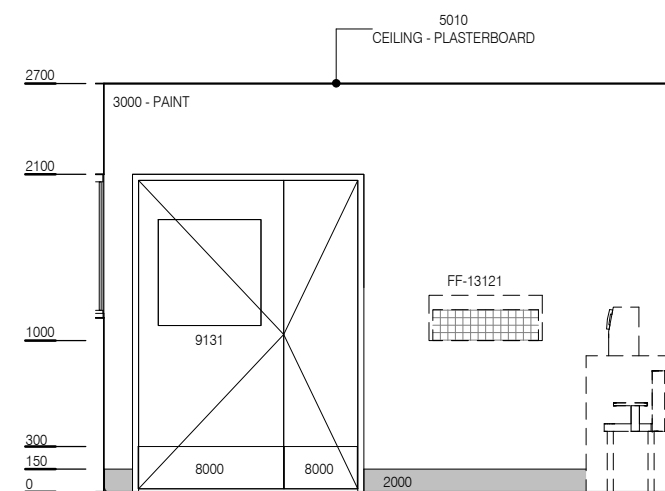

ELEVATION 3

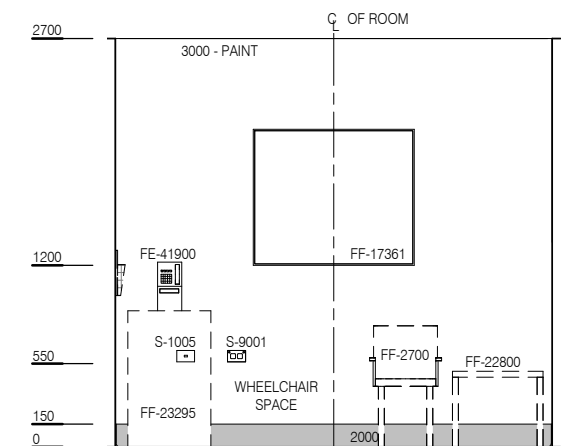

ELEVATION 4



| REV | DESCRIPTION | DATE |
|-----|--------------------------------|------------|
| 2 | This RLS has been redocumented | 01.03.2016 |

FOR GUIDANCE

| SCALE | RLS Room Code | Room Tag | REV |
|-------------|---------------|----------|-----|
| 1 : 50 @ A3 | WAIT-SEC | 1.246 | 2 |