

# AUSTRALASIAN HFG STANDARD COMPONENTS

Room Layout Sheet

RLS Room Code: **1BR-H-12**

Room Name:

**1 BED ROOM - HOLDING, 12m<sup>2</sup>**

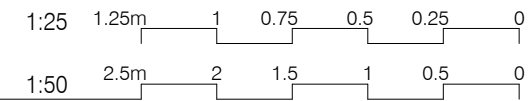

| CODE       | DESCRIPTION   |
|------------|---|
| DWOB-002   | OBSERVATION: internal window, alum/glass, door height, powdercoat |
| DWOB-010   | OBSERVATION: through door/s, glass, clear                         |
| DWPR-006   | DOOR PROTECTION: protection plate, to 900 AFFL, PVC, prefinished  |
| DWPR-010   | DOOR PROTECTION: to door frame, PVC, prefinished                  |
| DWWD-007   | BLIND: venetian, integral   |
| DWWD-013   | WINDOW DRESSING: external window                                  |
| DWWH-005   | WINDOW  |
| ELBO-015   | SWITCH: light, single   |
| ELGP-101   | GPO: single, ceiling mounted                                      |
| ELGP-105   | GPO: single, on services panel                                    |
| ELGP-122.1 | GPO: emergency power, single, on services panel (V)               |
| ELGP-206   | GPO: double, on services panel, RCD protected                     |
| ELGP-208   | GPO: double, wall mounted   |
| ELPR-001   | BODY PROTECTED ELECTRICAL AREA                                    |
| FIBM-019   | WHITEBOARD: fixed, magnetic                                       |
| FIDI-001   | DISPENSER: alcohol based hand rub                                 |
| FIDI-014   | DISPENSER: disposable glove                                       |
| FIDI-022   | DISPENSER: moisturiser  |
| FIDI-025   | DISPENSER: paper/hand towel                                       |
| FIDI-030   | DISPENSER: soap   |
| FIDI-031   | DISPENSER: soap antiseptic  |
| FIHR-004   | BRACKET: for display screen, ceiling mounted                      |
| FIHR-019   | BRACKET: for suction bottle                                       |
| FIHR-033   | PANEL: for storage bins, wall mount                               |
| FIRT-025   | TRACK: curtain, bedscreen, U shaped                               |
| FLSK-010   | SKIRTING: vinyl, floor vinyl coved, 150H, prefinished             |
| FLVY-007   | FLOOR FINISH: vinyl, seamless, coved, standard slip resistant     |
| FLVY-009   | FLOOR FINISH: vinyl, seamless, coved, wet area, non-slip          |
| FOBS-030   | CHAIR: visitor, patient   |

| CODE     | DESCRIPTION  |
|----------|--|
| FOCW-016 | BIN: waste, general, 20L                               |
| FOGE-009 | CURTAIN: bed screen                                    |
| FOSN-007 | BIN: storage bins, wire mesh, stainless steel          |
| FQTA-013 | TABLE: overbed   |
| HYBA-010 | BASIN: handwash, Type B                                |
| HYTP-037 | TAPWARE: mixer, elbow levers                           |
| ITBU-012 | DISPLAY SCREEN: patient entertainment system           |
| ITCL-004 | BUTTON: nurse call, emergency                          |
| ITCL-006 | BUTTON: nurse call, patient to staff                   |
| ITCL-008 | BUTTON: nurse call, staff assist                       |
| ITCL-028 | HANDSET: nurse call, with patient to staff call button |
| ITIN-025 | OUTLET: data, double RJ45, on services panel           |
| ITIN-070 | OUTLET: MATV   |
| LIFX-011 | LIGHT: reading light                                   |
| LIFX-013 | LIGHT: procedure, ceiling mounted, small               |
| LIFX-017 | LIGHT: night light                                     |
| LIFX-032 | LIGHT: downlight, examination, ceiling mounted         |
| MGAS-022 | OUTLET: medical air (MA), on services panel            |
| MGAS-042 | OUTLET: oxygen (O2), on services panel                 |
| MGAS-062 | OUTLET: suction, on services panel                     |
| MGFP-002 | FLOWMETER: medical air                                 |
| MGFP-004 | FLOWMETER: oxygen                                      |
| MMBE-010 | BED: patient, electric with mattress                   |
| MMGE-002 | ADAPTER: suction                                       |
| MMGE-100 | SUCTION BOTTLE   |
| MMSP-026 | SERVICES PANEL: wall mounted                           |
| WLPR-001 | WALL PROTECTION: bed protection wall panel             |
| WLWA-004 | WALL FINISH: paint, acrylic, washable                  |
| WLWA-007 | WALL FINISH: splashback                                |

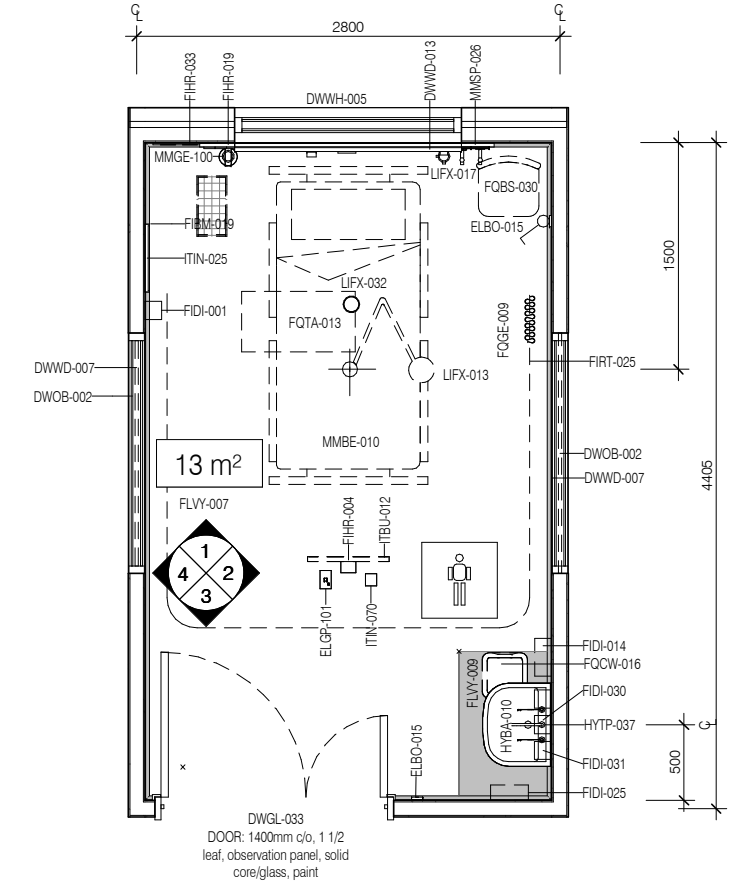

PLAN

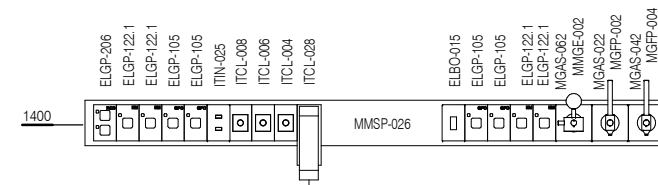

ELEVATION 5 ( 1 : 25 @ A3 )

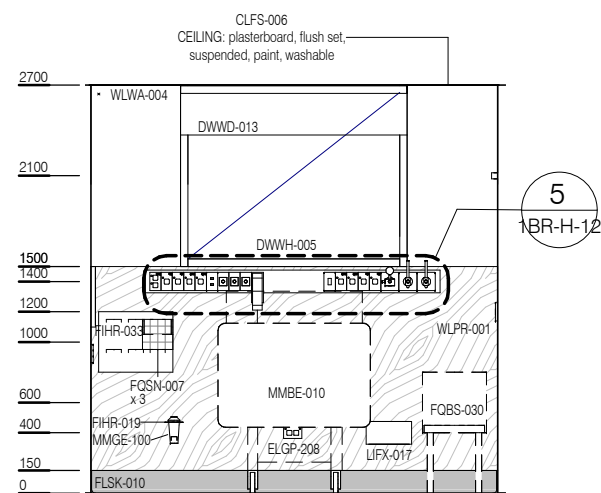

ELEVATION 1

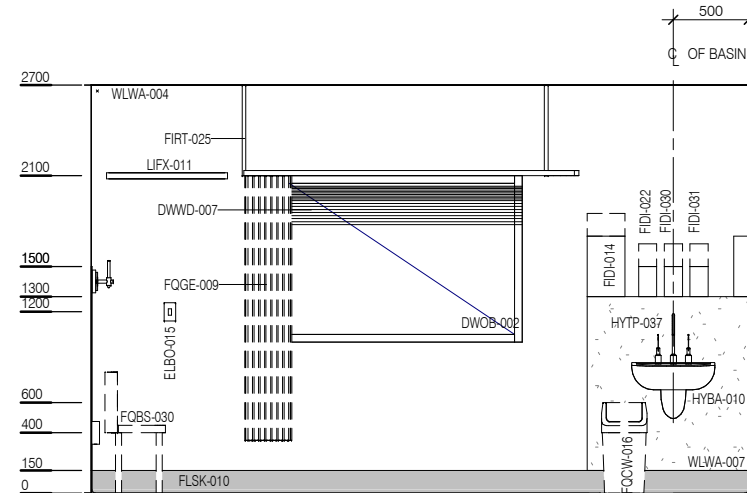

ELEVATION 2

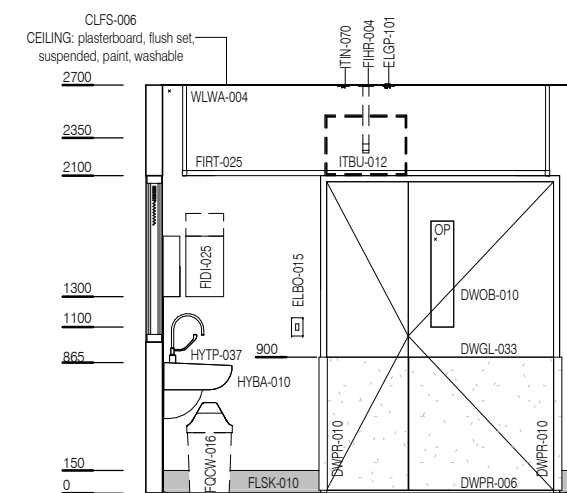

ELEVATION 3

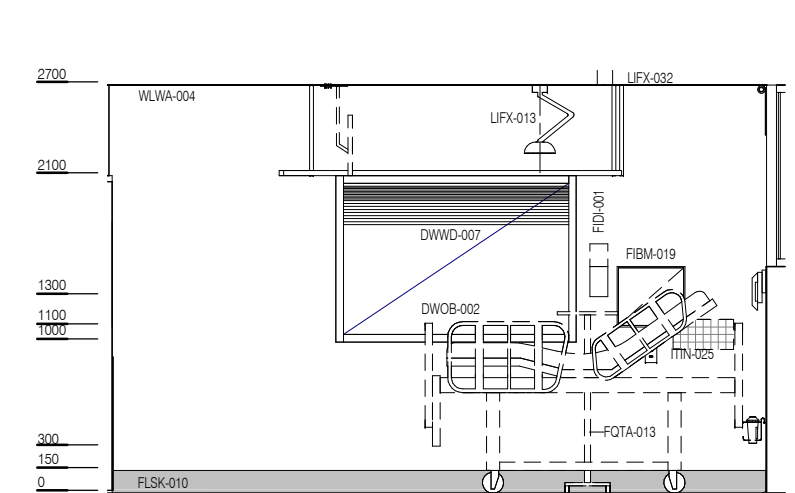

ELEVATION 4



| REV | DESCRIPTION               | DATE       |
|-----|---------------------------|------------|
| 3   | Coding and naming updated | 20.03.2017 |

FOR GUIDANCE

| SCALE       | RLS Room Code | REV |
|-------------|---------------|-----|
| 1 : 50 @ A3 | 1BR-H-12      | 3   |