

# AUSTRALASIAN HFG STANDARD COMPONENTS

Room Layout Sheet

RLS Room Code: 1BR-IC

1:50 2.5m 2 1.5 1 0.5 0

Room Name:

1 BED ROOM - INTENSIVE CARE

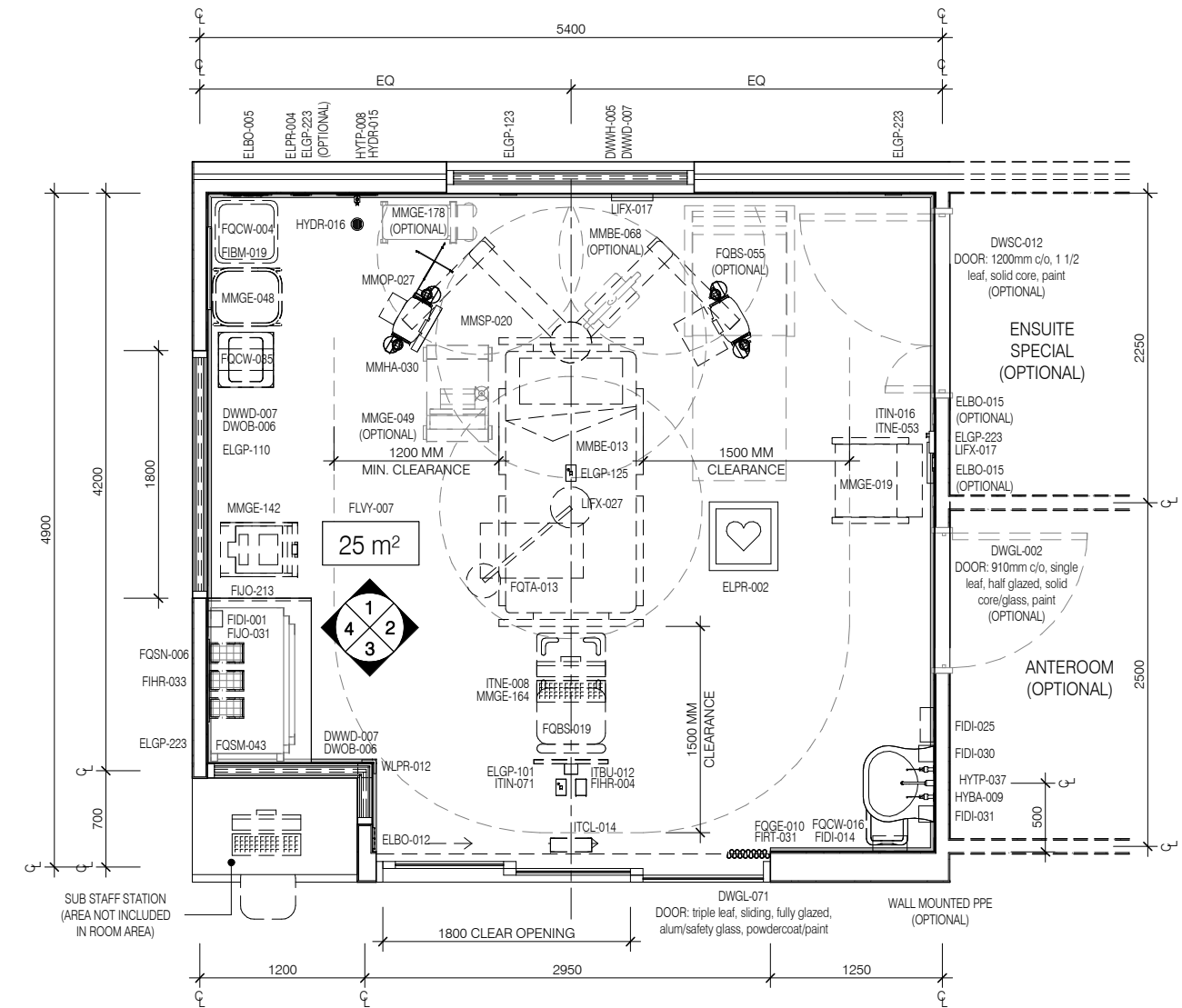
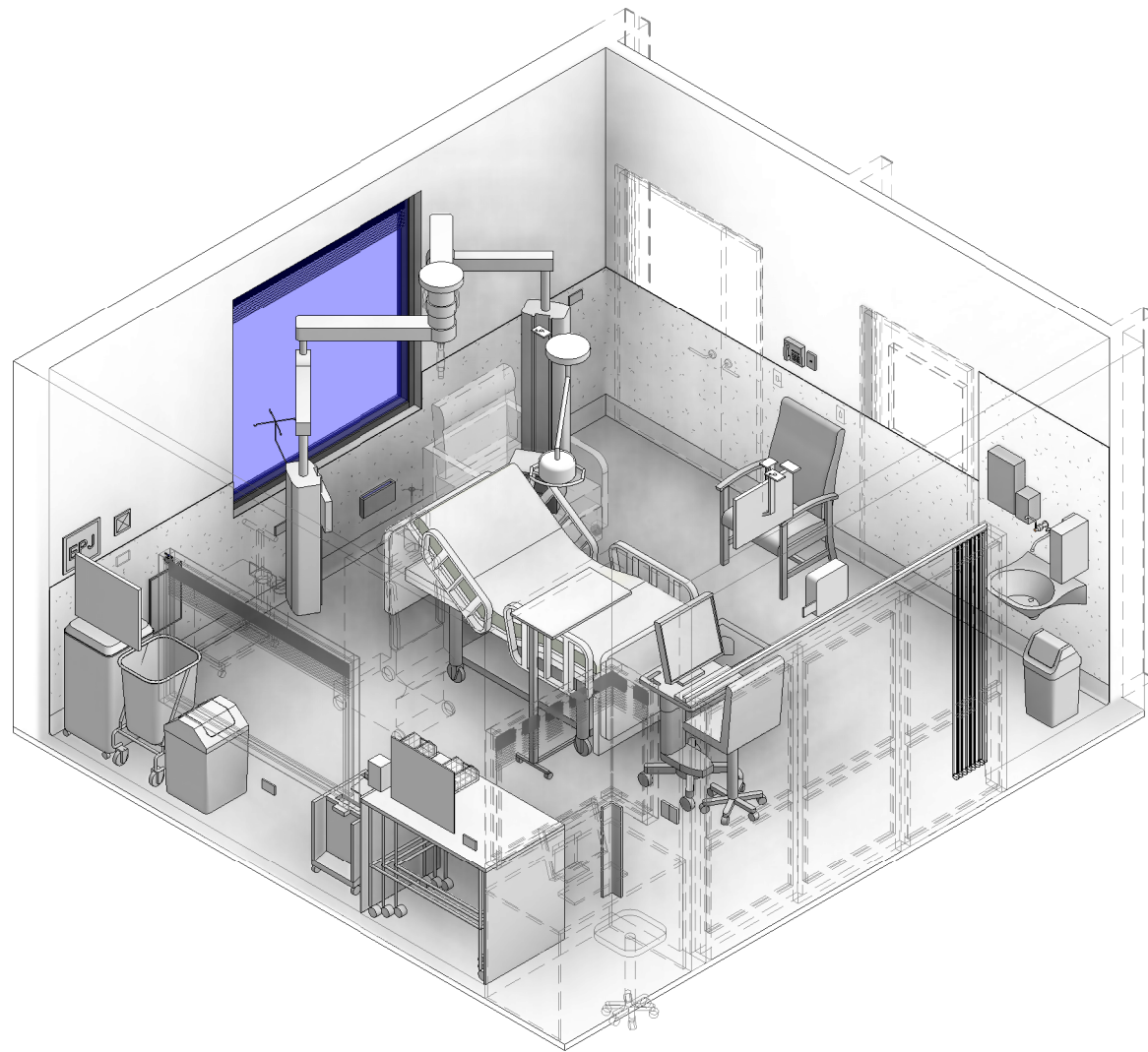

CODE	DESCRIPTION
DWOB-006	OBSERVATION: internal window, alum/safety glass, double glazed, integral venetian blind, powdercoat
DWWD-007	BLIND: venetian, integral
DWWH-005	WINDOW
ELBO-005	EQUIPOTENTIAL JUNCTION BOX
ELBO-012	SWITCH: light, dimmer
ELBO-015	SWITCH: light, single
ELGP-101	GPO: single, ceiling mounted
ELGP-109	GPO: single, wall mounted
ELGP-110	GPO: single, wall mounted, cleaner
ELGP-123	GPO: emergency power, single, wall mounted
ELGP-125	GPO: emergency power, single, ceiling mounted
ELGP-223	GPO: emergency power, double, wall mounted
ELPR-002	CARDIAC PROTECTED ELECTRICAL AREA
ELPR-004	MONITOR: line isolation
FIBM-019	WHITEBOARD: fixed, magnetic
FIDI-001	DISPENSER: alcohol based hand rub
FIDI-014	DISPENSER: disposable glove
FIDI-025	DISPENSER: paper/hand towel
FIDI-030	DISPENSER: soap
FIDI-031	DISPENSER: soap antiseptic
FIHR-004	BRACKET: for display screen, ceiling mounted
FIHR-033	PANEL: for storage bins, wall mount
FUO-031	BENCH: 750D, open under, laminate finish
FUO-213	PANEL: joinery carcass end
FIRT-031	TRACK: curtain, privacy
FLSK-010	SKIRTING: vinyl, floor vinyl covered, 150H, prefinished
FLVY-007	FLOOR FINISH: vinyl, seamless, coved, standard slip resistant
FQBS-019	CHAIR: office, ergonomic, high
FQBS-055	CHAIR: overnight fold out
FQCW-004	BIN: waste, clinical, 120L

CODE	DESCRIPTION
FQCW-016	BIN: waste, general, 20L
FQCW-035	BIN: waste, recycling, plastics, 50L
FQGE-010	CURTAIN: privacy screen
FQSM-043	TROLLEY: nested, set of 3, underbench
FQSN-006	BIN: storage bins, for wall mounted panel
FQTA-013	TABLE: overbed
HYBA-009	BASIN: handwash, Type A, scrub
HYDR-015	DRAIN: tundish unit, integral drainage outlets
HYDR-016	DRAIN: floor waste, sealed
HYTP-008	OUTLET: cold water
HYTP-037	TAPWARE: mixer, elbow levers
ITBU-012	DISPLAY SCREEN: patient entertainment system
ITCL-014	CLOCK: analogue, electric
ITIN-016	OUTLET: data, single RJ45, wall mounted
ITIN-071	OUTLET: MATV, ceiling mounted
ITNE-008	COMPUTER: for workstation on wheels
ITNE-053	TELEPHONE: handset, wall mount, handsfree
LIFX-017	LIGHT: night light
LIFX-027	LIGHT: examination, ceiling mounted
MMBE-013	BED: patient, ICU, electric
MMBE-068	LIFTER: patient, pendant mounted
MMGE-019	CHAIR: patient
MMGE-048	LINEN CARRIER: dirty, single
MMGE-049	MACHINE: dialysis
MMGE-142	TROLLEY: sharps bin
MMGE-164	WORKSTATION ON WHEELS: clinical, mobile
MMGE-178	PROCESSOR: reverse osmosis RO water, mobile
MMHA-030	MONITOR: patient, cardiac, pendant mounted
MMOP-027	IV POLE: on pendant
MMSP-020	PENDANT: tandem, wet and dry combination (fixed or adjustable height)
WLPR-012	WALL PROTECTION: corner guards, to 900 AFFL, prefinished PVC

CODE	DESCRIPTION
WLWA-004	WALL FINISH: paint, acrylic, washable
WLWA-010	WALL FINISH: splashback, vinyl
WLWA-025	WALL FINISH: vinyl, to 1200 AFFL

1BR-IC PENDANT 1-B		
CODE	DESCRIPTION	COUNT
ELGP-121.1	GPO: emergency power, single, on pendant (V)	8
ELGP-132	GPO: UPS, single, on pendant	2
ELPR-006	RCD: residual current device	1
ELPR-007	UPS: status indicator	1
FIHR-019	BRACKET: for suction bottle	2
ITBU-006	CONTROL PANEL: patient entertainment, handset	1
ITCL-004	BUTTON: nurse call, emergency	1
ITIN-014	OUTLET: data, single RJ45, on pendant	4
MGAS-021	OUTLET: medical air (MA), on pendant	1
MGAS-041	OUTLET: oxygen (O2), on pendant	2
MGAS-061	OUTLET: suction, on pendant	2
MGFP-002	FLOWMETER: medical air	1
MGFP-004	FLOWMETER: oxygen	2
MMGE-002	ADAPTER: suction	2
MMGE-100	SUCTION BOTTLE	2

## PLAN

NOTE: IF CONFIGURED FOR ISOLATION, 1 1/2 LEAF DOORS TO BE USED IN LIEU OF SLIDING DOOR

1BR-IC PENDANT 1-A		
CODE	DESCRIPTION	COUNT
ELBO-012	SWITCH: light, dimmer	1
ELGP-121.1	GPO: emergency power, single, on pendant (V)	8
ELGP-132	GPO: UPS, single, on pendant	2
ELPR-006	RCD: residual current device	1
ELPR-007	UPS: status indicator	1
FIHR-019	BRACKET: for suction bottle	2
ITCL-004	BUTTON: nurse call, emergency	1
ITCL-006	BUTTON: nurse call, patient to staff	1
ITCL-008	BUTTON: nurse call, staff assist	1
ITCL-028	HANDSET: nurse call, with patient to staff call button	1
ITIN-014	OUTLET: data, single RJ45, on pendant	2
MGAS-021	OUTLET: medical air (MA), on pendant	2
MGAS-041	OUTLET: oxygen (O2), on pendant	2
MGAS-061	OUTLET: suction, on pendant	2
MGFP-002	FLOWMETER: medical air	2
MGFP-004	FLOWMETER: oxygen	2
MMGE-002	ADAPTER: suction	2
MMHA-100	SUCTION BOTTLE	2
MMHA-023	VENTILATOR	1



REV	DESCRIPTION	DATE
1	First Issue	29.05.2019

FOR GUIDANCE

SCALE	RLS Room Code	REV
1 : 50 @ A3	1BR-IC	1

# AUSTRALASIAN HFG STANDARD COMPONENTS

Room Layout Sheet

RLS Room Code: 1BR-IC

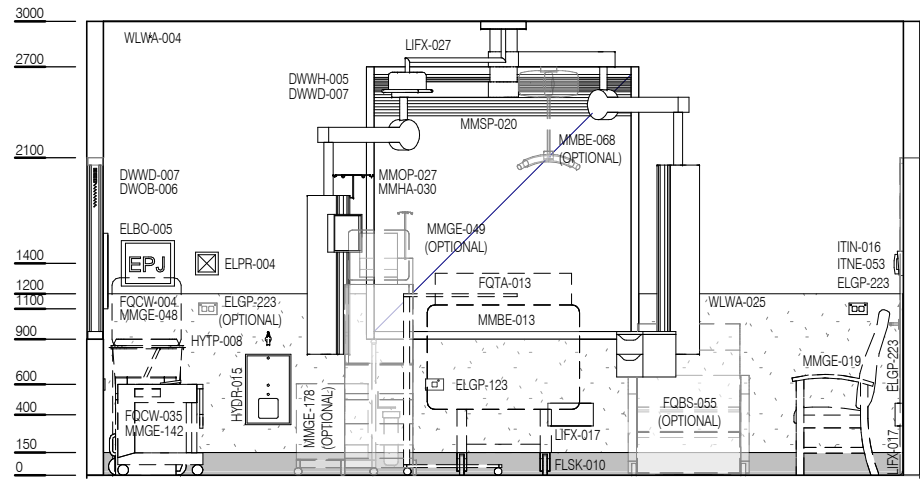

ELEVATION 1

NOTE: PROVISIONS FOR DIALYSIS ARE OPTIONAL AND TO BE PROVIDED TO A SELECTION OF ROOMS ONLY

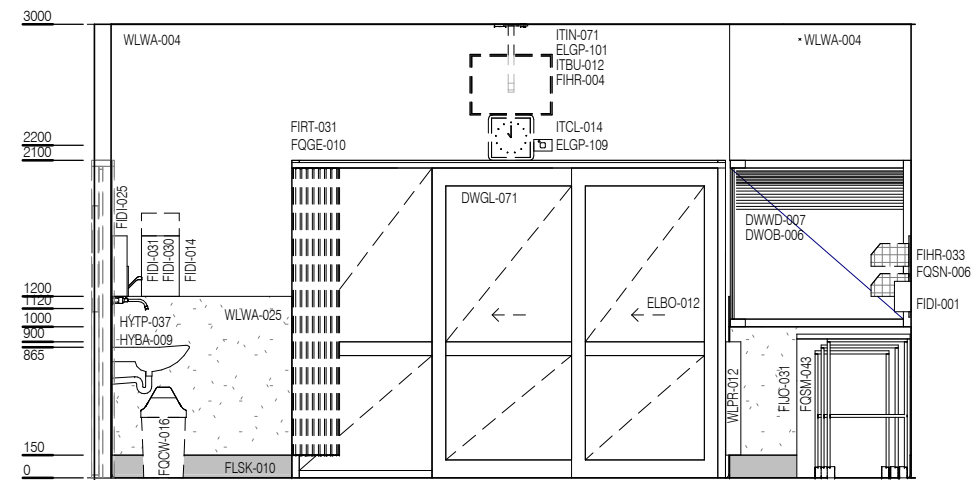

ELEVATION 3

1BR-IC PENDANT 1-A		
CODE	DESCRIPTION	COUNT
ELBO-012	SWITCH: light, dimmer	1
ELGP-121.1	GPO: emergency power, single, on pendant (V)	8
ELGP-132	GPO: UPS, single, on pendant	2
ELPR-006	RCD: residual current device	1
ELPR-007	UPS: status indicator	1
FIHR-019	BRACKET: for suction bottle	2
ITCL-004	BUTTON: nurse call, emergency	1
ITCL-006	BUTTON: nurse call, patient to staff	1
ITCL-008	BUTTON: nurse call, staff assist	1
ITCL-028	HANDSET: nurse call, with patient to staff call button	1
ITIN-014	OUTLET: data, single RJ45, on pendant	2
MGAS-021	OUTLET: medical air (MA), on pendant	2
MGAS-041	OUTLET: oxygen (O2), on pendant	2
MGAS-061	OUTLET: suction, on pendant	2
MGFP-002	FLOWMETER: medical air	2
MGFP-004	FLOWMETER: oxygen	2
MMGE-002	ADAPTER: suction	2
MMGE-100	SUCTION BOTTLE	2
MMHA-023	VENTILATOR	1

CODE	DESCRIPTION
DWOB-006	OBSERVATION: internal window, alum/safety glass, double glazed, integral venetian blind, powdercoat
DWWD-007	BLIND: venetian, integral
DWWH-005	WINDOW
ELBO-005	EQUIPOTENTIAL JUNCTION BOX
ELBO-012	SWITCH: light, dimmer
ELBO-015	SWITCH: light, single
ELGP-101	GPO: single, ceiling mounted
ELGP-109	GPO: single, wall mounted
ELGP-110	GPO: single, wall mounted, cleaner
ELGP-123	GPO: emergency power, single, wall mounted
ELGP-125	GPO: emergency power, single, ceiling mounted
ELGP-223	GPO: emergency power, double, wall mounted
ELPR-002	CARDIAC PROTECTED ELECTRICAL AREA
ELPR-004	MONITOR: line isolation
FIBM-019	WHITEBOARD: fixed, magnetic
FIDI-001	DISPENSER: alcohol based hand rub
FIDI-014	DISPENSER: disposable glove
FIDI-025	DISPENSER: paper/hand towel
FIDI-030	DISPENSER: soap
FIDI-031	DISPENSER: soap antiseptic
FIHR-004	BRACKET: for display screen, ceiling mounted
FIHR-033	PANEL: for storage bins, wall mount
FLJO-031	BENCH: 750D, open under, laminate finish
FLJO-213	PANEL: joinery carcass end
FIRT-031	TRACK: curtain, privacy
FLSK-010	SKIRTING: vinyl, floor vinyl coved, 150H, prefinished
FLVY-007	FLOOR FINISH: vinyl, seamless, coved, standard slip resistant
FOBS-019	CHAIR: office, ergonomic, high
FOBS-055	CHAIR: overnight fold out
FOCW-004	BIN: waste, clinical, 120L
FOCW-016	BIN: waste, general, 20L
FOCW-035	BIN: waste, recycling, plastics, 50L
FOGE-010	CURTAIN: privacy screen
FOSM-043	TROLLEY: nested, set of 3, underbench
FOSN-006	BIN: storage bins, for wall mounted panel
FOTA-013	TABLE: overbed
HYBA-009	BASIN: handwash, Type A, scrub
HYDR-015	DRAIN: tundish unit, integral drainage outlets
HYDR-016	DRAIN: floor waste, sealed
HYTP-008	OUTLET: cold water
HYTP-037	TAPWARE: mixer, elbow levers
ITBU-012	DISPLAY SCREEN: patient entertainment system
ITCL-014	CLOCK: analogue, electric
ITIN-016	OUTLET: data, single RJ45, wall mounted
ITIN-071	OUTLET: MATV, ceiling mounted
ITNE-008	COMPUTER: for workstation on wheels
ITNE-053	TELEPHONE: handset, wall mount, handsfree
LIFX-017	LIGHT: night light
LIFX-027	LIGHT: examination, ceiling mounted
MMBE-013	BED: patient, ICU, electric
MMBE-068	LIFTER: patient, pendant mounted
MMGE-019	CHAIR: patient
MMGE-048	LINEN CARRIER: dirty, single
MMGE-049	MACHINE: dialysis
MMGE-142	TROLLEY: sharps bin
MMGE-164	WORKSTATION ON WHEELS: clinical, mobile
MMGE-178	PROCESSOR: reverse osmosis RO water, mobile
MMHA-030	MONITOR: patient, cardiac, pendant mounted
MMOP-027	IV POLE: on pendant
MMSP-020	PENDANT: tandem, wet and dry combination (fixed or adjustable height)
WLPR-012	WALL PROTECTION: corner guards, to 900 AFFL, prefinished PVC
WLWA-004	WALL FINISH: paint, acrylic, washable
WLWA-010	WALL FINISH: splashback, vinyl
WLWA-025	WALL FINISH: vinyl, to 1200 AFFL

Room Name:

1 BED ROOM - INTENSIVE CARE

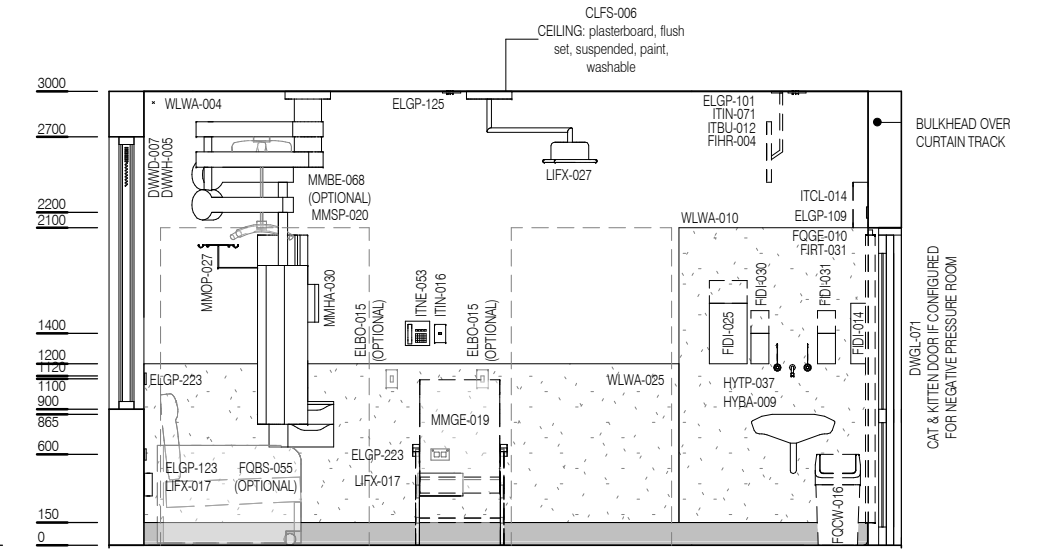

ELEVATION 2

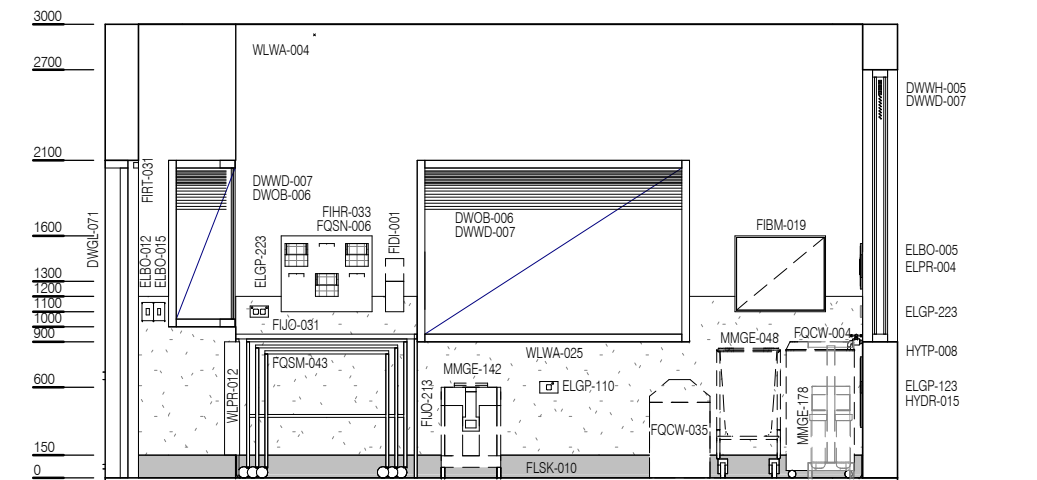

ELEVATION 4

1BR-IC PENDANT 1-B		
CODE	DESCRIPTION	COUNT
ELGP-121.1	GPO: emergency power, single, on pendant (V)	8
ELGP-132	GPO: UPS, single, on pendant	2
ELPR-006	RCD: residual current device	1
ELPR-007	UPS: status indicator	1
FIHR-019	BRACKET: for suction bottle	2
ITBU-006	CONTROL PANEL: patient entertainment, handset	1
ITCL-004	BUTTON: nurse call, emergency	1
ITIN-014	OUTLET: data, single RJ45, on pendant	4
MGAS-021	OUTLET: medical air (MA), on pendant	1
MGAS-041	OUTLET: oxygen (O2), on pendant	2
MGAS-061	OUTLET: suction, on pendant	2
MGFP-002	FLOWMETER: medical air	1
MGFP-004	FLOWMETER: oxygen	2
MMGE-002	ADAPTER: suction	2
MMGE-100	SUCTION BOTTLE	2



REV	DESCRIPTION	DATE
1	First Issue	29.05.2019

FOR GUIDANCE

SCALE	RLS Room Code	REV
1 : 50 @ A3	1BR-IC	1