

# AUSTRALASIAN HFG STANDARD COMPONENTS

Room Layout Sheet

RLS Room Code: 2BR-ST-B(1)

Room Name:

2 BED ROOM - OUTBOARD ENSUITE

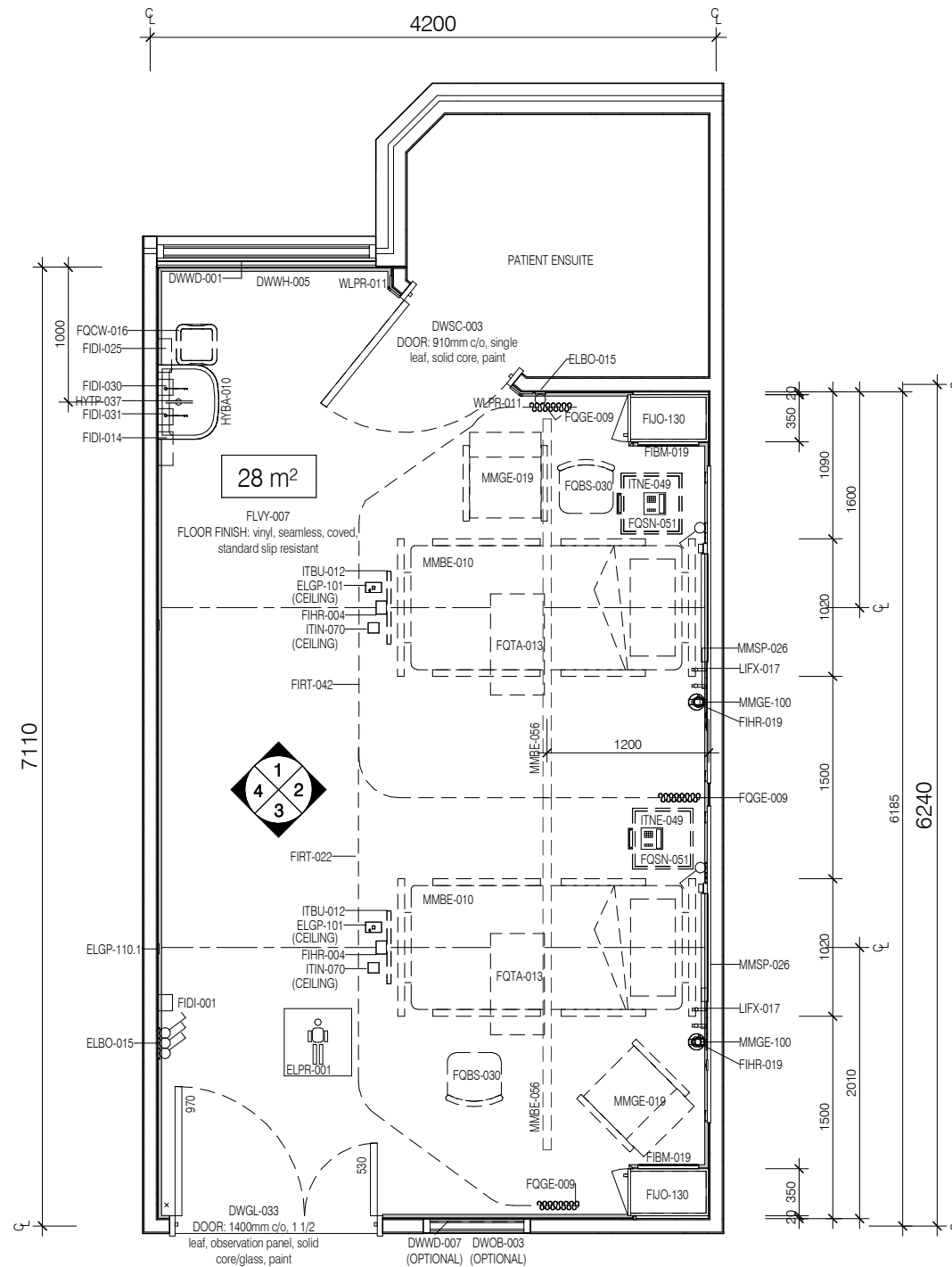
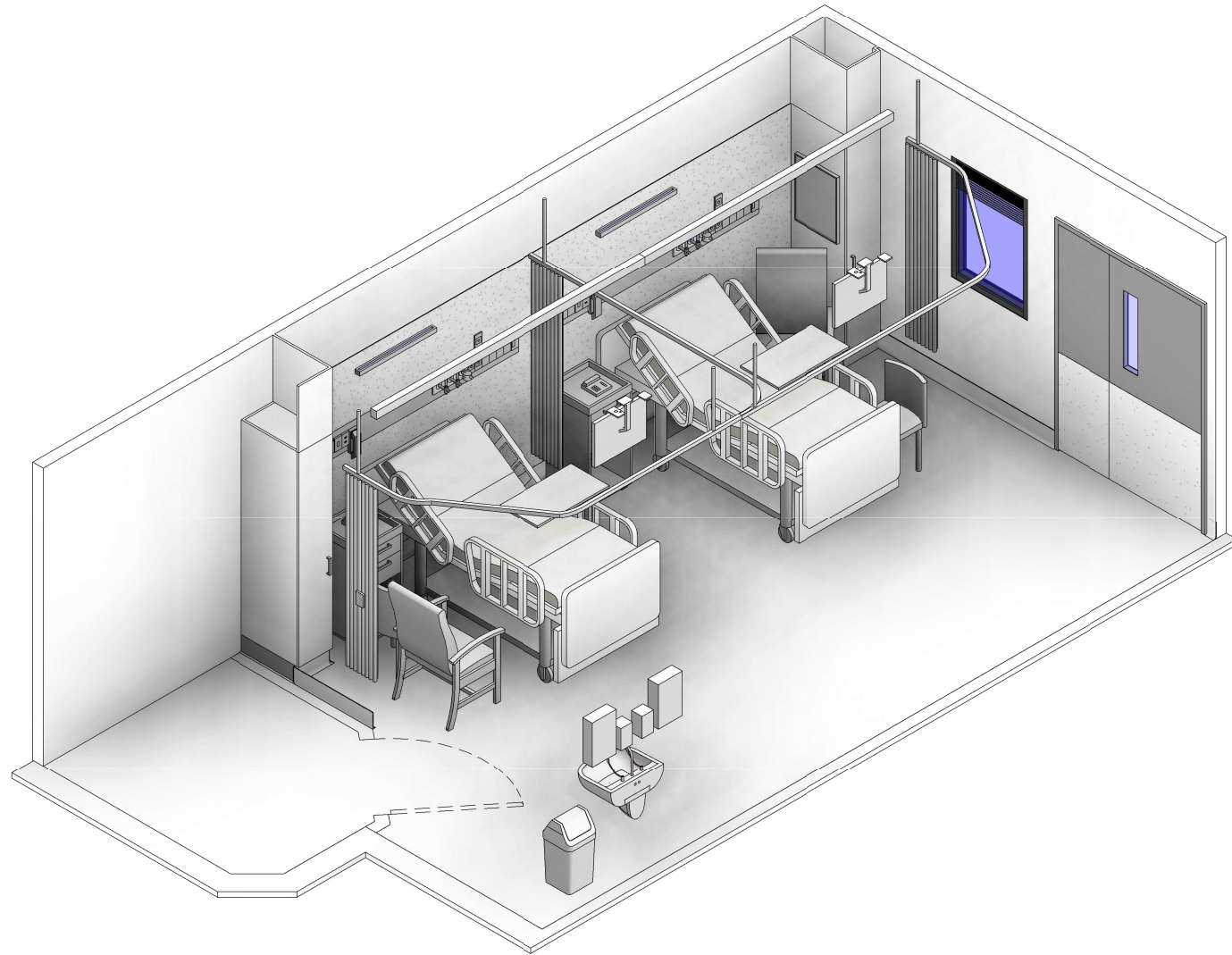
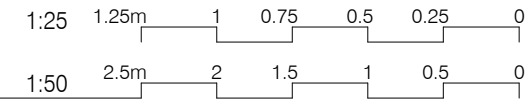

PLAN

CODE	DESCRIPTION
CLGE-001	CEILING: plasterboard, bulkhead, paint
DWOB-003	OBSERVATION: internal window, alum/glass, double glazed, integral venetian blind, powdercoat
DWPR-005	DOOR PROTECTION: protection plate to 900 AFFL
DWWD-001	BLIND: blackout
DWWD-007	BLIND: venetian, integral
DWWH-005	WINDOW
ELBO-015	SWITCH: light, single
ELGP-101	GPO: single, ceiling mounted
ELGP-105	GPO: single, on services panel
ELGP-109.1	GPO: single, wall mounted (V)
ELGP-110.1	GPO: single, wall mounted, cleaner vertical
ELGP-122.1	GPO: emergency power, single, on services panel (V)
ELGP-208.1	GPO: double, wall mounted (V)
ELPR-001	BODY PROTECTED ELECTRICAL AREA
ELPR-006	RCB: residual current device
FIBM-019	WHITEBOARD: fixed, magnetic
FIDI-001	DISPENSER: alcohol based hand rub
FIDI-014	DISPENSER: disposable glove
FIDI-025	DISPENSER: paper/hand towel
FIDI-030	DISPENSER: soap
FIDI-031	DISPENSER: soap antiseptic
FIHR-004	BRACKET: for display screen, ceiling mounted
FIHR-019	BRACKET: for suction bottle
FIJO-130	CUPBOARD: tall, single door, adj shelves and clothes rail
FIRT-022	TRACK: curtain, bedscreen, 2nd bed
FIRT-042	TRACK: curtain, bedscreen, U shaped, angled
FLSK-010	SKIRTING: vinyl, floor vinyl coved, 150H, prefinished
FLVY-007	FLOOR FINISH: vinyl, seamless, coved, standard slip resistant
FOBS-030	CHAIR: visitor, patient
FQCW-016	BIN: waste, general, 20L
FOGE-009	CURTAIN: bed screen
FQSN-051	LOCKER: 2 drawers, open under, lockable, mobile
FOTA-013	TABLE: overbed
HYBA-010	BASIN: handwash, Type B
HYTP-037	TAPWARE: mixer, elbow levers
ITBU-012	DISPLAY SCREEN: patient entertainment system
ITCL-004	BUTTON: nurse call, emergency
ITCL-006	BUTTON: nurse call, patient to staff
ITCL-008	BUTTON: nurse call, staff assist
ITCL-028	HANDSET: nurse call, with patient to staff call button
ITIN-025	OUTLET: data, double RJ45, on services panel
ITIN-070	OUTLET: MATV
ITNE-049	TELEPHONE: handset, desktop
LIFX-011	LIGHT: reading light
LIFX-017	LIGHT: night light
MGAS-022	OUTLET: medical air (MA), on services panel
MGAS-042	OUTLET: oxygen (O2), on services panel
MGAS-062	OUTLET: suction, on services panel
MGFP-002	FLOWMETER: medical air
MGFP-004	FLOWMETER: oxygen
MMBE-010	BED: patient, electric with mattress
MMBE-056	LIFTER: patient, ceiling mounted, track, linear
MMGE-002	ADAPTER: suction
MMGE-019	CHAIR: patient
MMGE-100	SUCTION BOTTLE
MMSP-026	SERVICES PANEL: wall mounted
WLPR-001	WALL PROTECTION: bed protection wall panel
WLPR-011	WALL PROTECTION: corner guards, to 900 AFFL min.
WLWA-004	WALL FINISH: paint, acrylic, washable
WLWA-010	WALL FINISH: splashback, vinyl



REV	DESCRIPTION	DATE
3	General revision incl name change	16.05.2005
4	Updated following ERG Review	05.04.2018

FOR GUIDANCE

SCALE	RLS Room Code	REV
1 : 50 @ A3	2BR-ST-B(1)	4

# AUSTRALASIAN HFG STANDARD COMPONENTS

Room Layout Sheet

RLS Room Code: **2BR-ST-B(2)**

Room Name:

**2 BED ROOM - OUTBOARD ENSUITE**

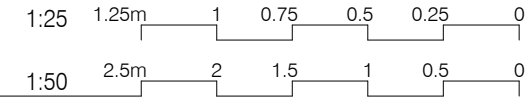

CODE	DESCRIPTION
CLGE-001	CEILING: plasterboard, bulkhead, paint
DWOB-003	OBSERVATION: internal window, alum/glass, double glazed, integral venetian blind, powdercoat
DWPR-005	DOOR PROTECTION: protection plate to 900 AFFL
DWWD-001	BLIND: blackout
DWWD-007	BLIND: venetian, integral
DWWH-005	WINDOW
ELBO-015	SWITCH: light, single
ELGP-101	GPO: single, ceiling mounted
ELGP-105	GPO: single, on services panel
ELGP-109.1	GPO: single, wall mounted (V)
ELGP-110.1	GPO: single, wall mounted, cleaner vertical
ELGP-122.1	GPO: emergency power, single, on services panel (V)
ELGP-208.1	GPO: double, wall mounted (V)
ELPR-001	BODY PROTECTED ELECTRICAL AREA
ELPR-006	RCD: residual current device
FIBM-019	WHITEBOARD: fixed, magnetic
FIDI-001	DISPENSER: alcohol based hand rub
FIDI-014	DISPENSER: disposable glove
FIDI-025	DISPENSER: paper/hand towel
FIDI-030	DISPENSER: soap
FIDI-031	DISPENSER: soap antiseptic
FIHR-004	BRACKET: for display screen, ceiling mounted
FIHR-019	BRACKET: for suction bottle
FUO-130	CUPBOARD: tall, single door, adj shelves and clothes rail
FIRT-022	TRACK: curtain, bedscreen, 2nd bed
FIRT-042	TRACK: curtain, bedscreen, U shaped, angled
FLSK-010	SKIRTING: vinyl, floor vinyl coved, 150H, prefinished
FLVY-007	FLOOR FINISH: vinyl, seamless, coved, standard slip resistant
FQBS-030	CHAIR: visitor, patient
FQCW-016	BIN: waste, general, 20L
FQGE-009	CURTAIN: bed screen
FQSN-051	LOCKER: 2 drawers, open under, lockable, mobile
FQTA-013	TABLE: overbed
HYBA-010	BASIN: handwash, Type B
HYTP-037	TAPWARE: mixer, elbow levers
ITBU-012	DISPLAY SCREEN: patient entertainment system
ITCL-004	BUTTON: nurse call, emergency
ITCL-006	BUTTON: nurse call, patient to staff
ITCL-008	BUTTON: nurse call, staff assist
ITCL-028	HANDSET: nurse call, with patient to staff call button
ITIN-025	OUTLET: data, double RJ45, on services panel
ITIN-070	OUTLET: MATV
ITNE-049	TELEPHONE: handset, desktop
LIFX-011	LIGHT: reading light
LIFX-017	LIGHT: night light
MGAS-022	OUTLET: medical air (MA), on services panel
MGAS-042	OUTLET: oxygen (O2), on services panel
MGAS-062	OUTLET: suction, on services panel
MGFP-002	FLOWMETER: medical air
MGFP-004	FLOWMETER: oxygen
MMBE-010	BED: patient, electric with mattress
MMBE-056	LIFTER: patient, ceiling mounted, track, linear
MMGE-002	ADAPTER: suction
MMGE-019	CHAIR: patient
MMGE-100	SUCTION BOTTLE
MMSP-026	SERVICES PANEL: wall mounted
WLPR-001	WALL PROTECTION: bed protection wall panel
WLPR-011	WALL PROTECTION: corner guards, to 900 AFFL min.
WLWA-004	WALL FINISH: paint, acrylic, washable
WLWA-010	WALL FINISH: splashback, vinyl

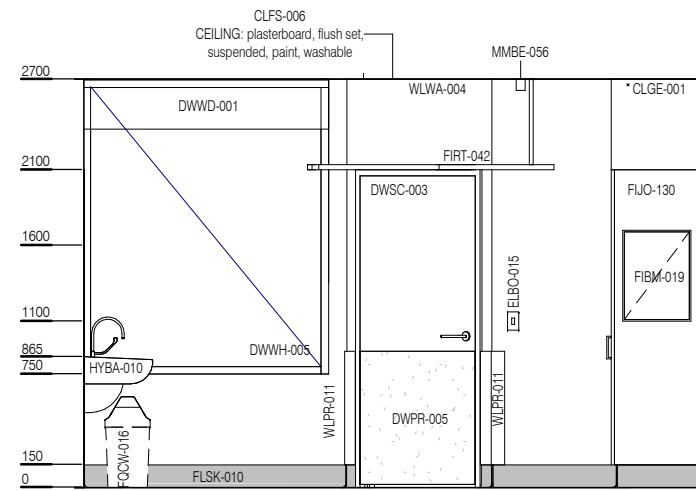

ELEVATION 1

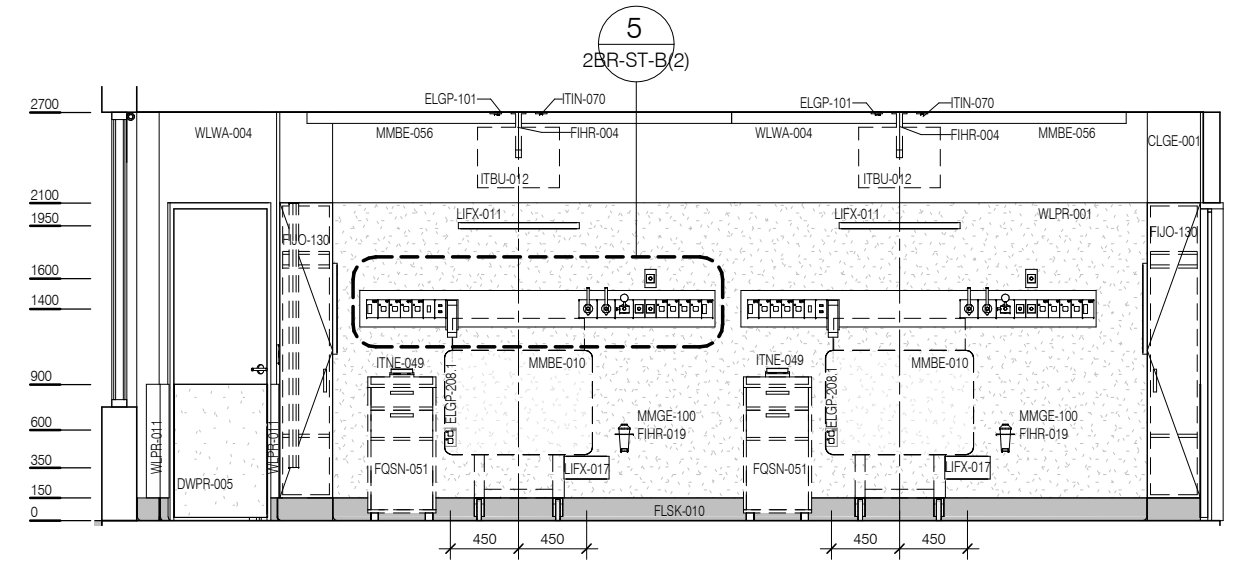

ELEVATION 2

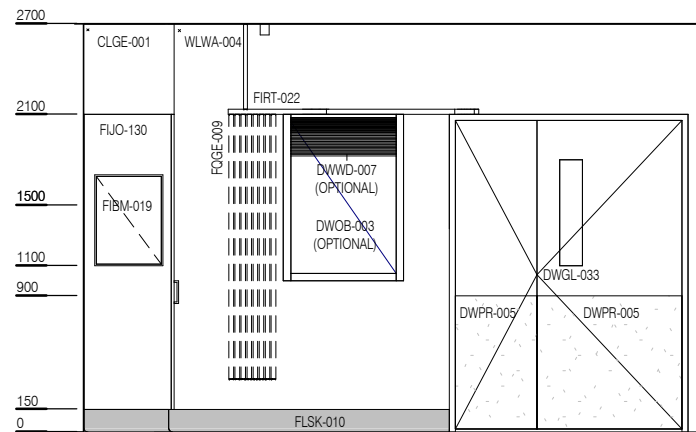

ELEVATION 3



ELEVATION 4

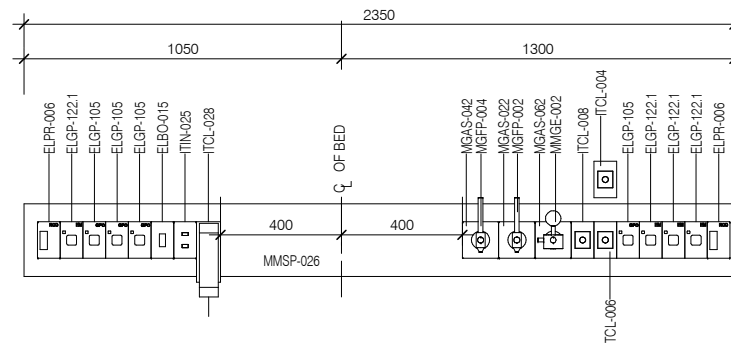

ELEVATION 5 ( 1 : 25 @ A3 )



REV	DESCRIPTION	DATE
3	General revision incl name change	16.05.2005
4	Updated following ERG Review	05.04.2018

DRAFT

SCALE	RLS Room Code	REV
1 : 50 @ A3	2BR-ST-B(2)	4