

# AUSTRALIAN HFG STANDARD COMPONENTS

Room Layout Sheet

RLS Room Code: **ADLK- ENC**

Room Name:

1:50 2.5m 2 1.5 1 0.5 0

**ADL KITCHEN - ENCLOSED**

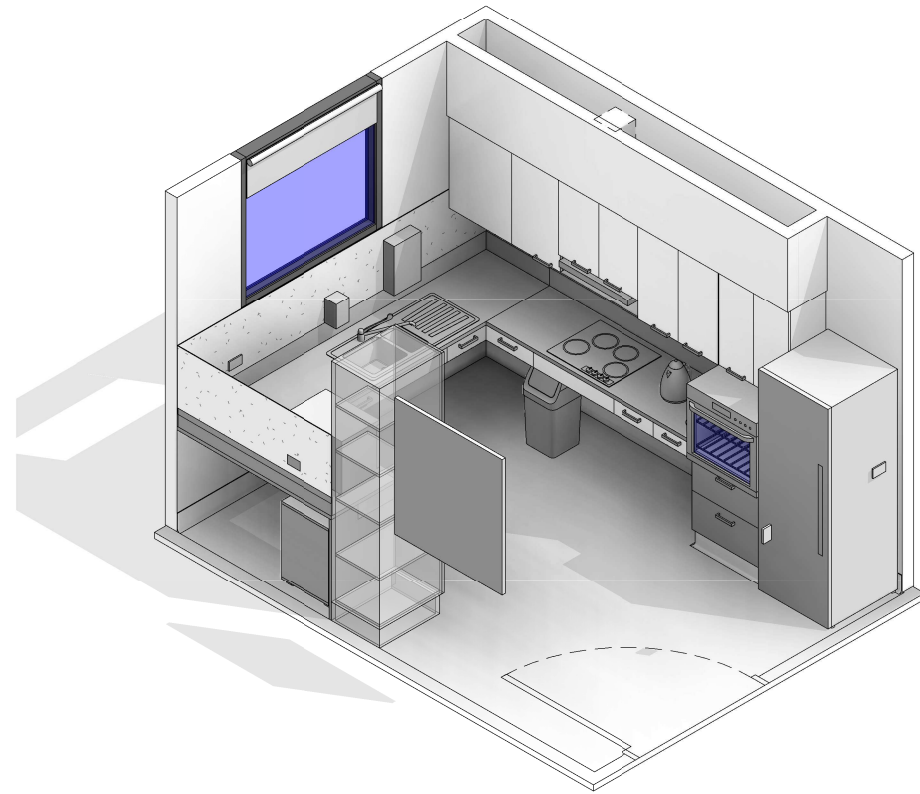

| CODE     | DESCRIPTION  |
|----------|--|
| CLGE-001 | CEILING: plasterboard, bulkhead, paint                           |
| DWPR-006 | DOOR PROTECTION: protection plate, to 900 AFLL, PVC, prefinished |
| DWPR-010 | DOOR PROTECTION: to door frame, PVC, prefinished                 |
| DWWD-013 | WINDOW DRESSING: external window                                 |
| DWWH-005 | WINDOW   |
| ELBO-015 | SWITCH: light, single  |
| ELGE-001 | DIRECT CONNECTION: power   |
| ELGP-109 | GPO: single, wall mounted  |
| ELGP-208 | GPO: double, wall mounted  |
| ELPR-001 | BODY PROTECTED ELECTRICAL AREA                                   |
| FIBM-019 | WHITEBOARD: fixed, magnetic                                      |
| FIDI-025 | DISPENSER: paper/hand towel                                      |
| FIDI-030 | DISPENSER: soap  |
| FUJO-059 | BENCH TOP: 600D, joinery under, laminate finish                  |
| FUJO-114 | CUPBOARD: drawer unit, lockable                                  |
| FUJO-131 | CUPBOARD: tall, single door, adj shelves, lockable               |
| FUJO-143 | CUPBOARD: wall mount, double door, adj shelves                   |
| FUJO-157 | CUPBOARD: wall mount, single door, adj shelves, lockable         |
| FUJO-205 | CUPBOARD: drawer unit, lockable, single drawer                   |
| FLSK-010 | SKIRTING: vinyl, floor vinyl coved, 150H, prefinished            |
| FLVY-007 | FLOOR FINISH: vinyl, seamless, coved, standard slip resistant    |
| FQCA-007 | COOKTOP: electric  |
| FQCA-032 | FRIDGE: domestic, 300L   |
| FQCA-046 | KETTLE: electric   |
| FQCA-063 | OVEN: electric   |
| FQCA-067 | OVEN: microwave, domestic  |
| FQCA-072 | RANGEHOOD  |
| FQCA-080 | TOASTER: domestic  |
| FQCW-016 | BIN: waste, general, 20L   |
| FQSM-040 | PEDESTAL: mobile, drawer unit, lockable, 660H                    |
| HYBA-041 | SINK: double, with drainer, half size rinse bowl                 |
| HYTP-040 | TAPWARE: mixer, sink, accessible                                 |
| WLWA-004 | WALL FINISH: paint, acrylic, washable                            |
| WLWA-007 | WALL FINISH: splashback  |

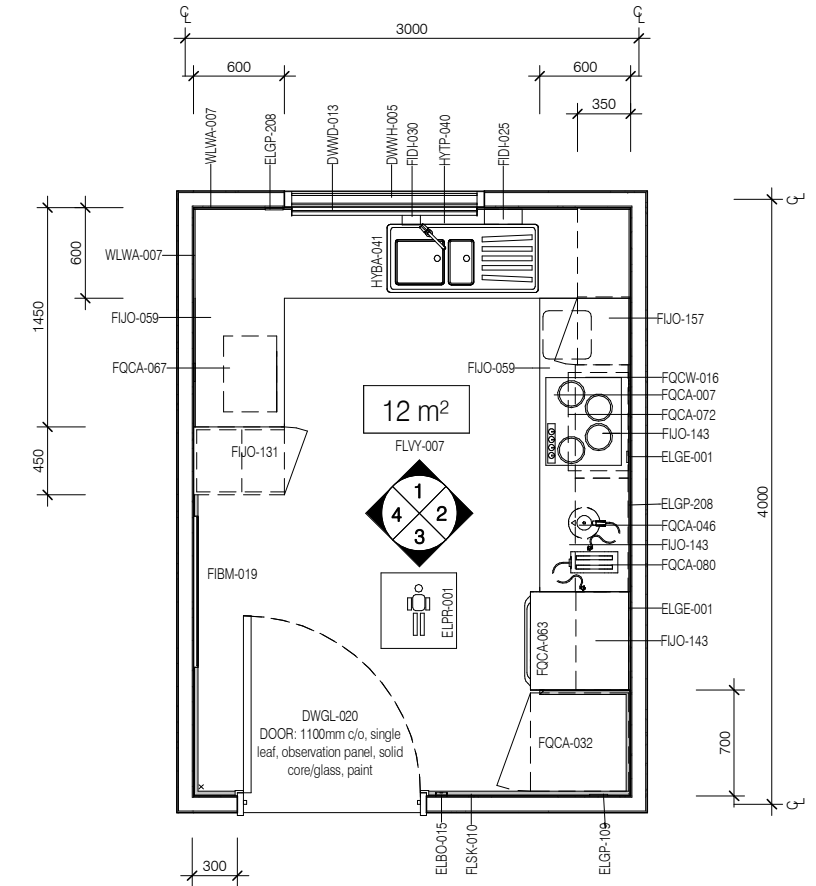

**PLAN**

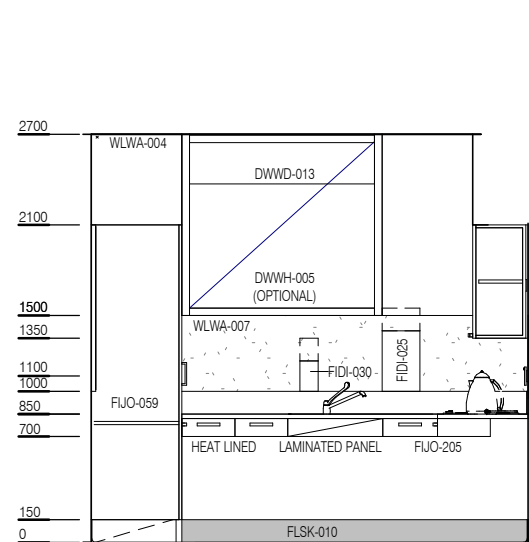

**ELEVATION 1**

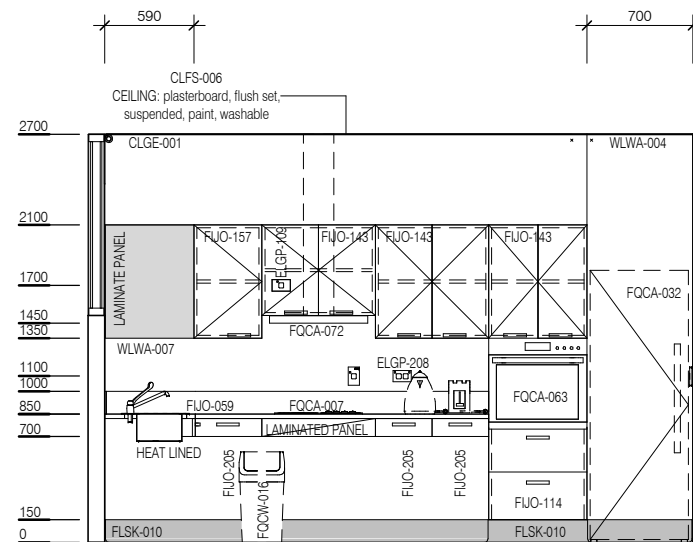

**ELEVATION 2**

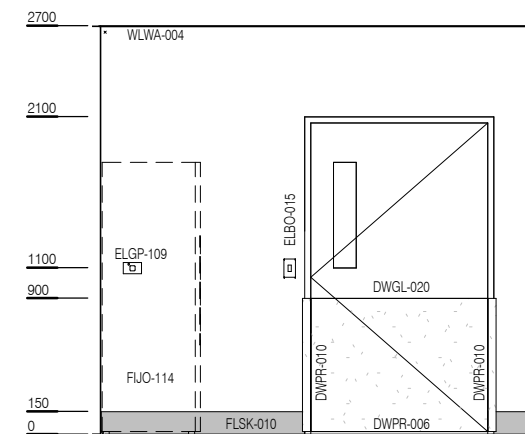

**ELEVATION 3**

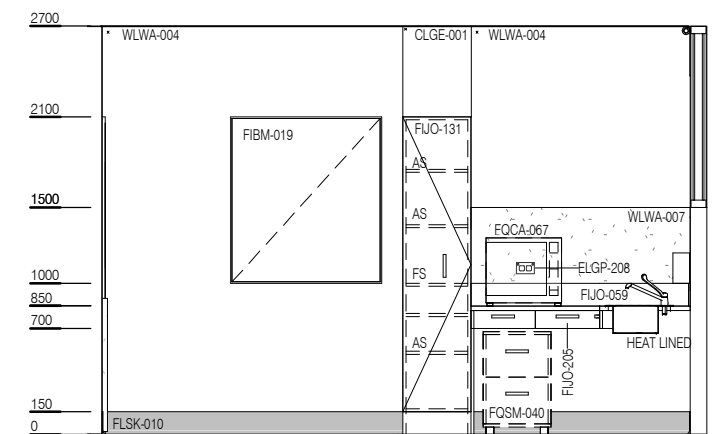

**ELEVATION 4**



| REV | DESCRIPTION               | DATE       |
|-----|---------------------------|------------|
| 3   | Coding and naming updated | 20.03.2017 |

FOR GUIDANCE

| SCALE       | RLS Room Code | REV |
|-------------|---------------|-----|
| 1 : 50 @ A3 | ADLK- ENC     | 3   |