

CODE	DESCRIPTION
CLGE-001	CEILING: plasterboard, bulkhead, paint
DWWD-013	WINDOW DRESSING: external window
DWWH-005	WINDOW
ELBO-015	SWITCH: light, single
ELGE-001	DIRECT CONNECTION: power
ELGP-109	GPO: single, wall mounted
ELGP-208	GPO: double, wall mounted
ELGP-209	GPO: double, wall mounted, RCD protected
ELPR-001	BODY PROTECTED ELECTRICAL AREA
FIBM-019	WHITEBOARD: fixed, magnetic
FIDI-025	DISPENSER: paper/hand towel
FIDI-030	DISPENSER: soap
FIJO-059	BENCH TOP: 600D, joinery under, laminate finish
FIJO-059.1	BENCH TOP: 600D, joinery under, laminate finish, rounded corners
FIJO-114	CUPBOARD: drawer unit, lockable
FIJO-131	CUPBOARD: tall, single door, adj shelves, lockable
FIJO-143	CUPBOARD: wall mount, double door, adj shelves
FIJO-156	CUPBOARD: wall mount, single door, adj shelves
FIJO-202	CUPBOARD: drawer unit, lockable, single row
FLSK-010	SKIRTING: vinyl, floor vinyl coved, 150H, prefinished
FLVY-007	FLOOR FINISH: vinyl, seamless, coved, standard slip resistant
FQCA-007	COOKTOP: electric
FQCA-031	FRIDGE: domestic, 250L
FQCA-046	KETTLE: electric
FQCA-063	OVEN: electric
FQCA-067	OVEN: microwave, domestic
FQCA-072	RANGEHOOD
FQCA-080	TOASTER: domestic
FQCW-016	BIN: waste, general, 20L
FQSM-040	PEDESTAL: mobile, drawer unit, lockable, 660H
HYBA-041	SINK: double, with drainer, half size rinse bowl
HYTP-040	TAPWARE: mixer, sink, accessible
WLWA-004	WALL FINISH: paint, acrylic, washable
WLWA-007	WALL FINISH: splashback

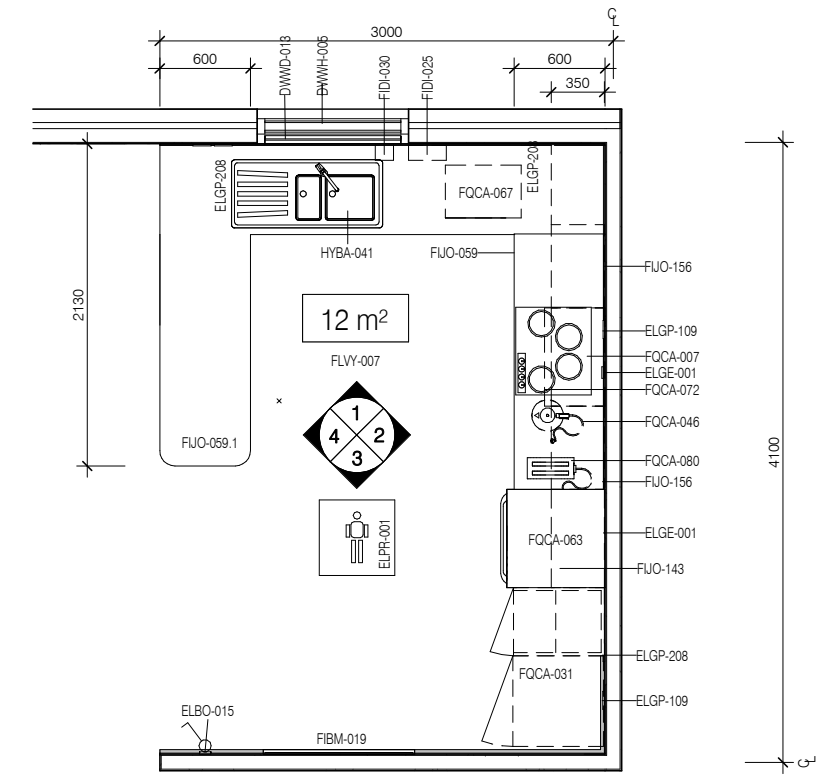

PLAN

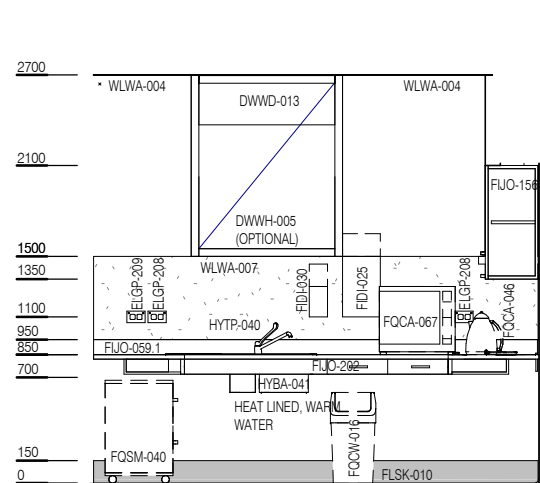

ELEVATION 1

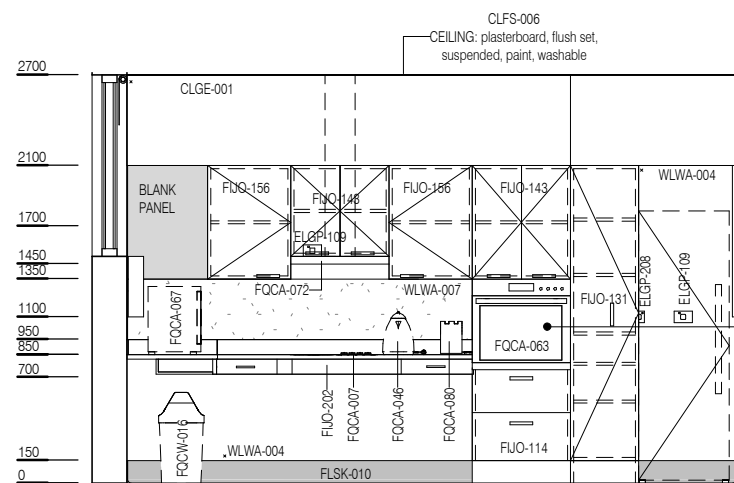

ELEVATION 2

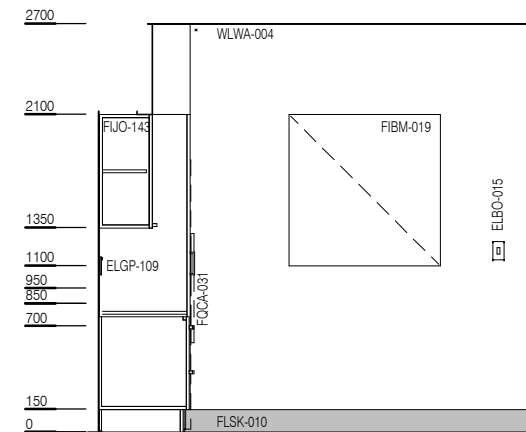

ELEVATION 3

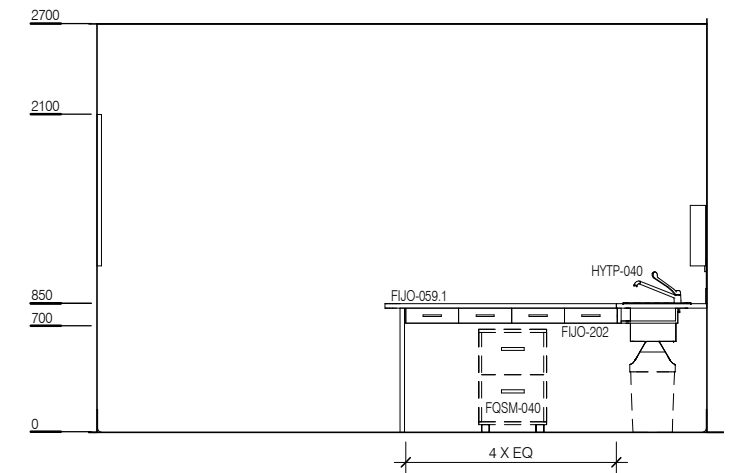

ELEVATION 4