

AUSTRALASIAN HFG STANDARD COMPONENTS

Room Layout Sheet

RLS Room Code: **ADLK**

Room Name:

ADL KITCHEN

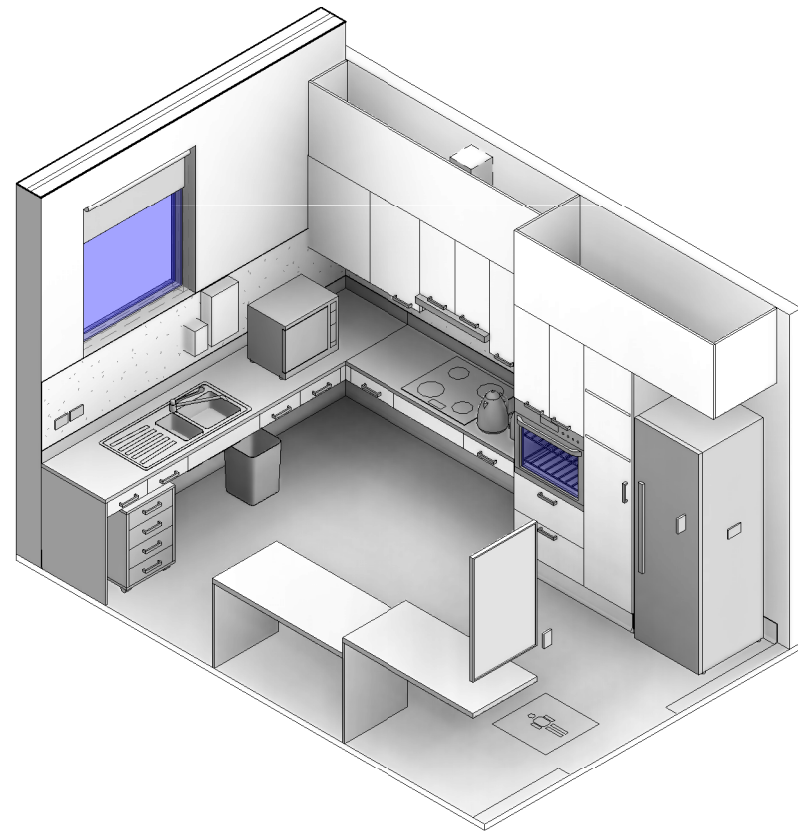
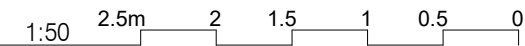

CODE	DESCRIPTION
DWWD-004	BLIND: roller
DWWH-005	WINDOW
ELBO-007	SWITCH: emergency isolation
ELBO-015	SWITCH: light, single
ELGE-001	DIRECT CONNECTION: power
ELGP-109	GPO: single, wall mounted
ELGP-208	GPO: double, wall mounted
ELPR-001	BODY PROTECTED ELECTRICAL AREA
ELPR-006	RCD: residual current device
FIBM-019	WHITEBOARD: fixed, magnetic
FIDI-025	DISPENSER: paper/hand towel
FIDI-030	DISPENSER: soap
FUJO-020	BENCH: 600D, open under, laminate finish
FUJO-059	BENCH TOP: 600D, joinery under, laminate finish
FUJO-131	CUPBOARD: tall, single door, adj shelves, lockable
FUJO-143	CUPBOARD: wall mount, double door, adj shelves
FUJO-156	CUPBOARD: wall mount, single door, adj shelves
FUJO-205	CUPBOARD: drawer unit, single drawer, lockable
FUJO-212	BULKHEAD: joinery
FUJO-213	PANEL: joinery carcass end
FUJO-223	CUPBOARD: tall, oven cabinet
FUJO-224	PANEL: joinery fixed panel
FLSK-010	SKIRTING: vinyl, floor vinyl covered, 150H, prefinished
FLVY-007	FLOOR FINISH: vinyl, seamless, covered, standard slip resistant
FQCA-031	FRIDGE: domestic, 250L
FQCA-046	KETTLE: electric
FQCA-063	OVEN: electric
FQCA-067	OVEN: microwave, domestic
FQCA-072	RANGEHOOD
FQCA-080	TOASTER: domestic
FQCA-089	COOKTOP: induction
FQCW-016	BIN: waste, general, 20L
FQSM-040	PEDESTAL: mobile, drawer unit, lockable, 660H
HYBA-041	SINK: double, with drainer, half size rinse bowl
HYTP-040	TAPWARE: mixer, sink, accessible
WLWA-004	WALL FINISH: paint, acrylic, washable
WLWA-007	WALL FINISH: splashback

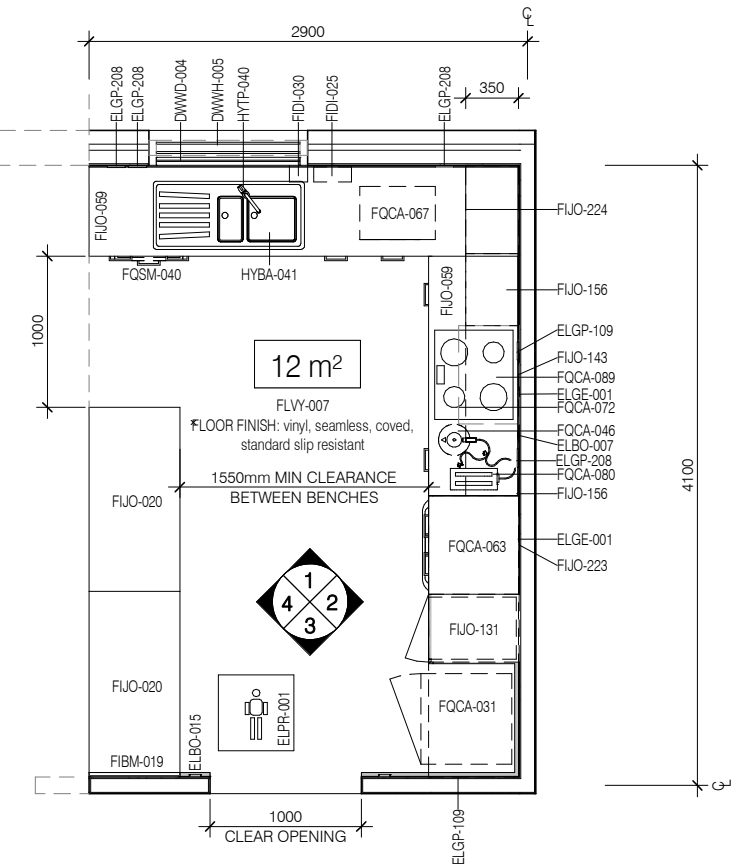
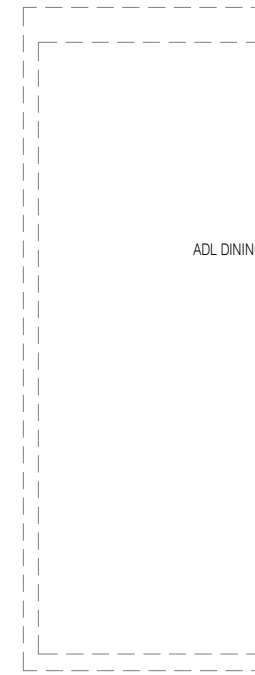

PLAN

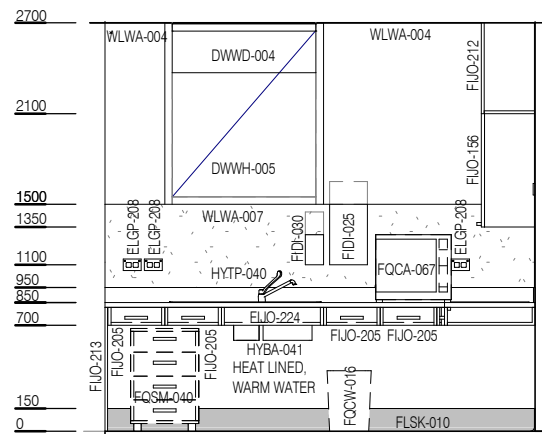

ELEVATION 1

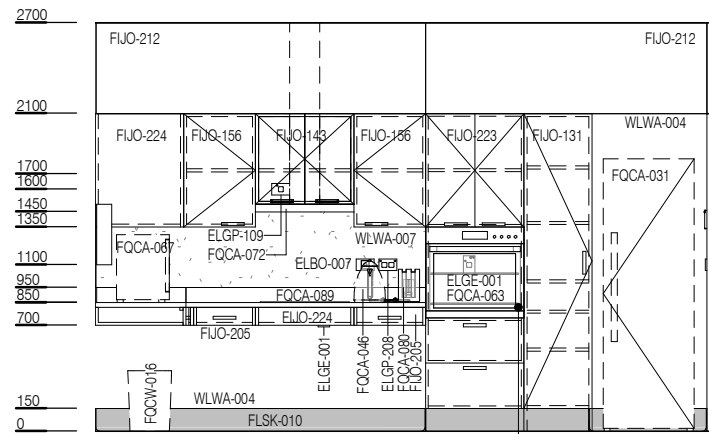

ELEVATION 2

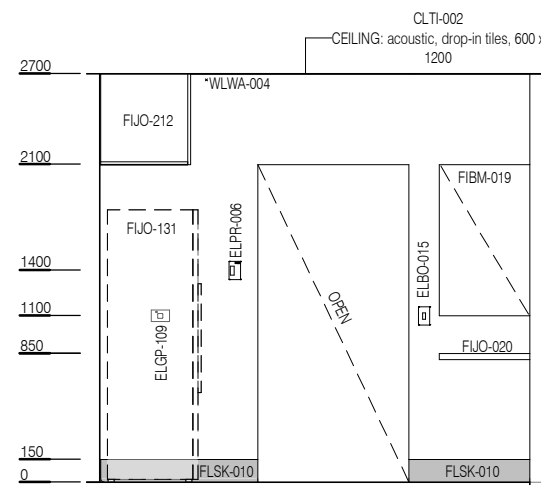

ELEVATION 3

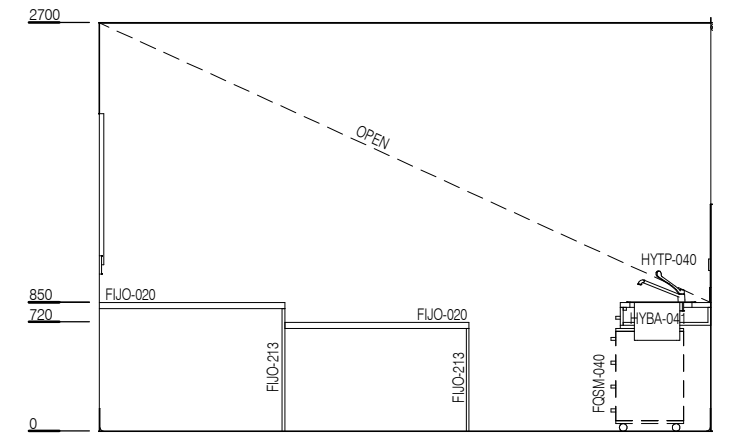

ELEVATION 4

OVEN BOTTOM SHELF TO BE AT 850 AFFL



REV	DESCRIPTION	DATE
4	General update following ERG review	26.04.2021

FOR GUIDANCE

SCALE	RLS Room Code	REV
1 : 50 @ A3	ADLK	4