

# AUSTRALASIAN HFG STANDARD COMPONENTS

Room Layout Sheet

RLS Room Code: **AHDR**

Room Name:

1:50 2.5m 2 1.5 1 0.5 0

**AFTER HOURS DRUG STORE**

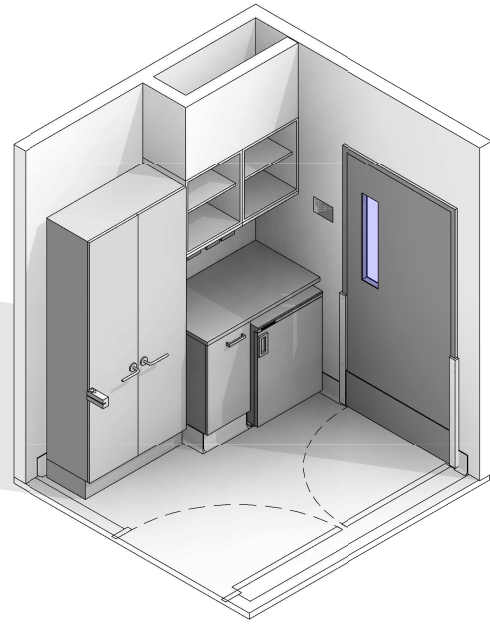

CODE	DESCRIPTION
CLGE-001	CEILING: plasterboard, bulkhead, paint
DWPR-001	DOOR PROTECTION: kickplate, to 300 AFFL
DWPR-010	DOOR PROTECTION: to door frame, PVC, prefinished
ELBO-015	SWITCH: light, single
ELGP-123.1	GPO: emergency power, single, wall mounted (V)
ELGP-208	GPO: double, wall mounted
ELGP-223	GPO: emergency power, double, wall mounted
FUJO-059	BENCH TOP: 600D, joinery under, laminate finish
FUJO-119	CUPBOARD: tall, double door, pharmacy shelves, lockable
FUJO-141	CUPBOARD: underbench, single door, adj shelves, lockable
FUJO-152	CUPBOARD: wall mount, shelf unit, adj shelves
FLSK-010	SKIRTING: vinyl, floor vinyl coved, 150H, prefinished
FLVY-007	FLOOR FINISH: vinyl, seamless, coved, standard slip resistant
FQCW-016	BIN: waste, general, 20L
ITIN-016	OUTLET: data, single RJ45, wall mounted
ITIN-026	OUTLET: data, double RJ45, wall mounted
ITSE-006	BUTTON: duress, fixed
ITSE-038	READER: access control, general
MMGE-035	FRIDGE: drugs, small
WLWA-004	WALL FINISH: paint, acrylic, washable

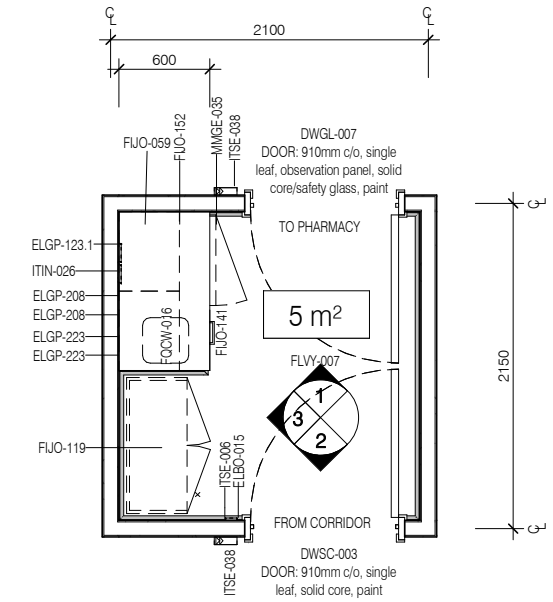

**PLAN**

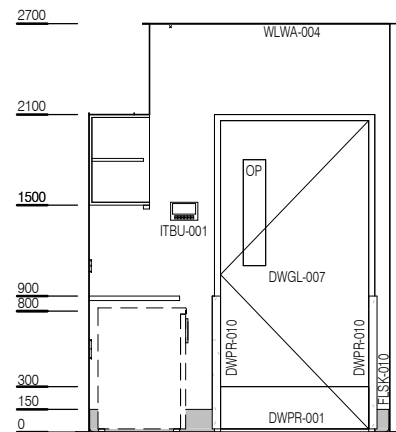

**ELEVATION 1**

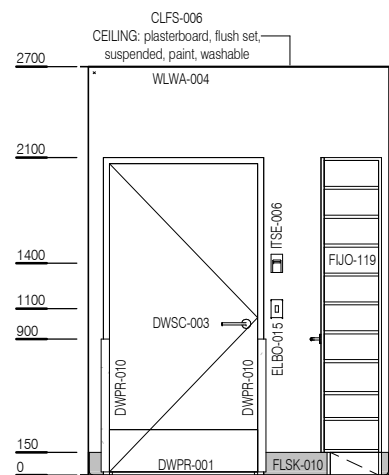

**ELEVATION 2**

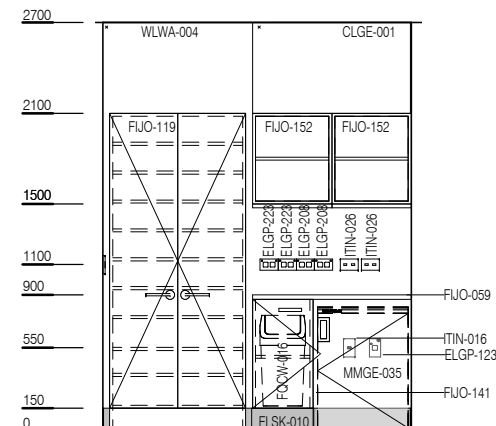

**ELEVATION 3**



REV	DESCRIPTION	DATE
3	Coding and naming updated	20.03.2017

**FOR GUIDANCE**

SCALE	RLS Room Code	REV
1 : 50 @ A3	AHDR	3