

AUSTRALASIAN HFG STANDARD COMPONENTS

Room Layout Sheet

RLS Room Code: ANAE-16

Room Name:

ANAESTHETIC PREPARATION ROOM, 16m²

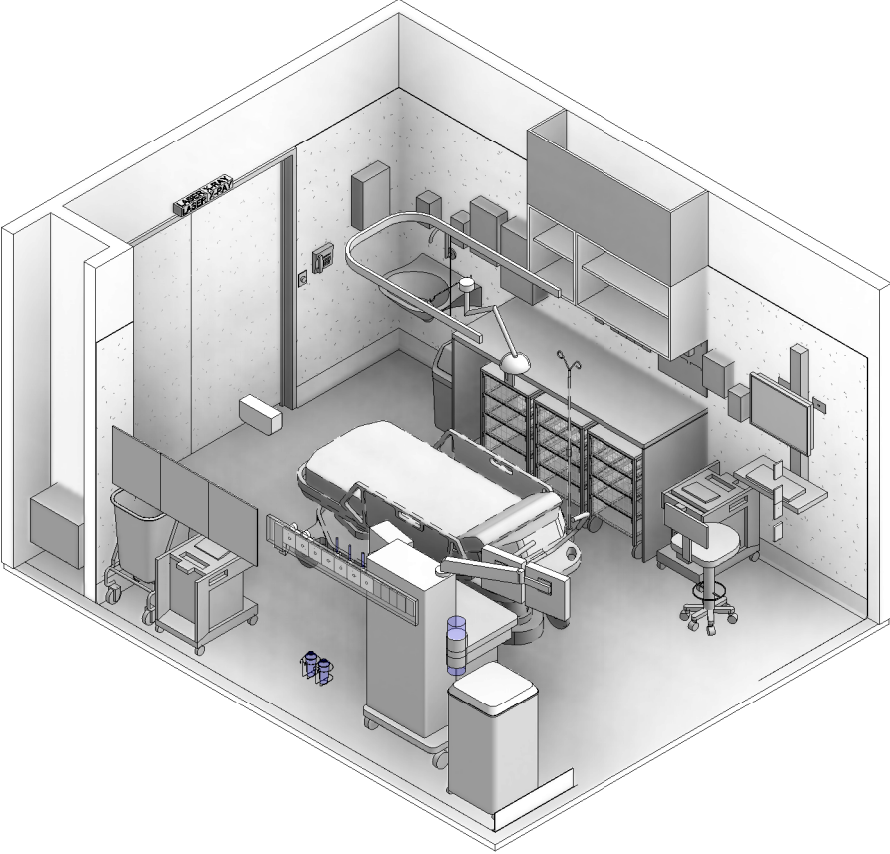
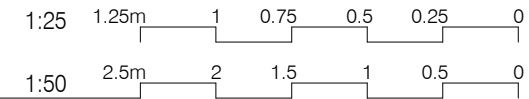

CODE	DESCRIPTION
DWPR-005	DOOR PROTECTION: protection plate to 900 AFFL
DWPR-011	DOOR PROTECTION: protection plate, to full height
ELBO-015	SWITCH: light, single
ELGP-122.1	GPO: emergency power, single, on services panel (V)
ELGP-123	GPO: emergency power, single, wall mounted
ELGP-123.1	GPO: emergency power, single, wall mounted (V)
ELPR-006	RCD: residual current device
FIDI-001	DISPENSER: alcohol based hand rub
FIDI-014	DISPENSER: disposable glove
FIDI-021	DISPENSER: mask
FIDI-025	DISPENSER: paper/hand towel
FIDI-030	DISPENSER: soap
FIDI-031	DISPENSER: soap antiseptic
FIHR-019	BRACKET: for suction bottle
FIHR-062	RACK: wire basket
FIHR-063	BRACKET: for all-in-one computer, with keyboard shelf, wall mounted
FUJO-020	BENCH: 600D, open under, laminate finish
FUJO-152	CUPBOARD: wall mount, shelf unit, adj shelves
FUJO-212	BULKHEAD: Joinery
FUJO-213	PANEL: joinery carcass end
FIRT-020	TRACK: ceiling mounted, IV
FLSK-010	SKIRTING: vinyl, floor vinyl coved, 150H, prefinished
FLVY-007	FLOOR FINISH: vinyl, seamless, coved, standard slip resistant
FOCW-004	BIN: waste, clinical, 120L
FOCW-016	BIN: waste, general, 20L
FQSM-003	PEDESTAL: mobile, wire basket unit, 840H
HYBA-009	BASIN: handwash, Type A, scrub
HYTP-042	TAPWARE: sensor
ITCL-004	BUTTON: nurse call, emergency
ITCL-005	BUTTON: nurse call, orderly / porter
ITCL-008	BUTTON: nurse call, staff assist

CODE	DESCRIPTION
ITCL-018	CLOCK: clock system slave, digital
ITCL-028	HANDSET: nurse call, with patient to staff call button
ITIN-016	OUTLET: data, single RJ45, wall mounted
ITIN-025	OUTLET: data, double RJ45, on services panel
ITIN-026	OUTLET: data, double RJ45, wall mounted
ITNE-052	TELEPHONE: handset, wall mount
ITNE-066	COMPUTER: all-in-one, wall mounted
ITNE-067	KEYBOARD: keyboard and mouse only
ITSE-025	DOOR RELEASE: access control, remote activation
LIFX-002	LIGHT: illuminated sign, "X-Ray in Use"
LIFX-003	LIGHT: illuminated sign, "Laser in Use"
LIFX-013	LIGHT: procedure, ceiling mounted, small
LIFX-016	LIGHT: pelmet light
MEE-008	EXHAUST: low level
MGAS-022	OUTLET: medical air (MA), on services panel
MGAS-032	OUTLET: nitrous oxide (N2O), on services panel
MGAS-042	OUTLET: oxygen (O2), on services panel
MGAS-053	OUTLET: scavenge, on services panel
MGAS-062	OUTLET: suction, on services panel
MGFP-002	FLOWMETER: medical air
MGFP-004	FLOWMETER: oxygen
MMBE-044	TROLLEY: patient, transport
MMGE-002	ADAPTER: suction
MMGE-014	CHAIR: anaesthetist
MMGE-039	HANGER: IV, for ceiling track
MMGE-048	LINEN CARRIER: dirty, single
MMGE-088	SAFE: dangerous drugs, small
MMGE-100	SUCTION BOTTLE
MMGE-142	TROLLEY: sharps bin
MMOP-040	MACHINE: anaesthetic
MMSP-026	SERVICES PANEL: wall mounted
WLWA-004	WALL FINISH: paint, acrylic, washable
WLWA-023	WALL FINISH: vinyl, to 2100 AFFL

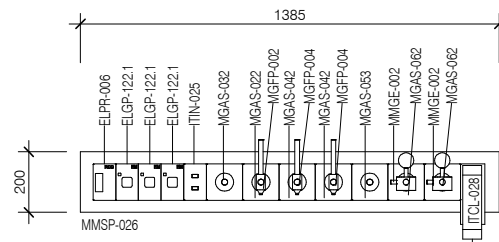

ELEVATION 5 (1 : 25 @ A3)

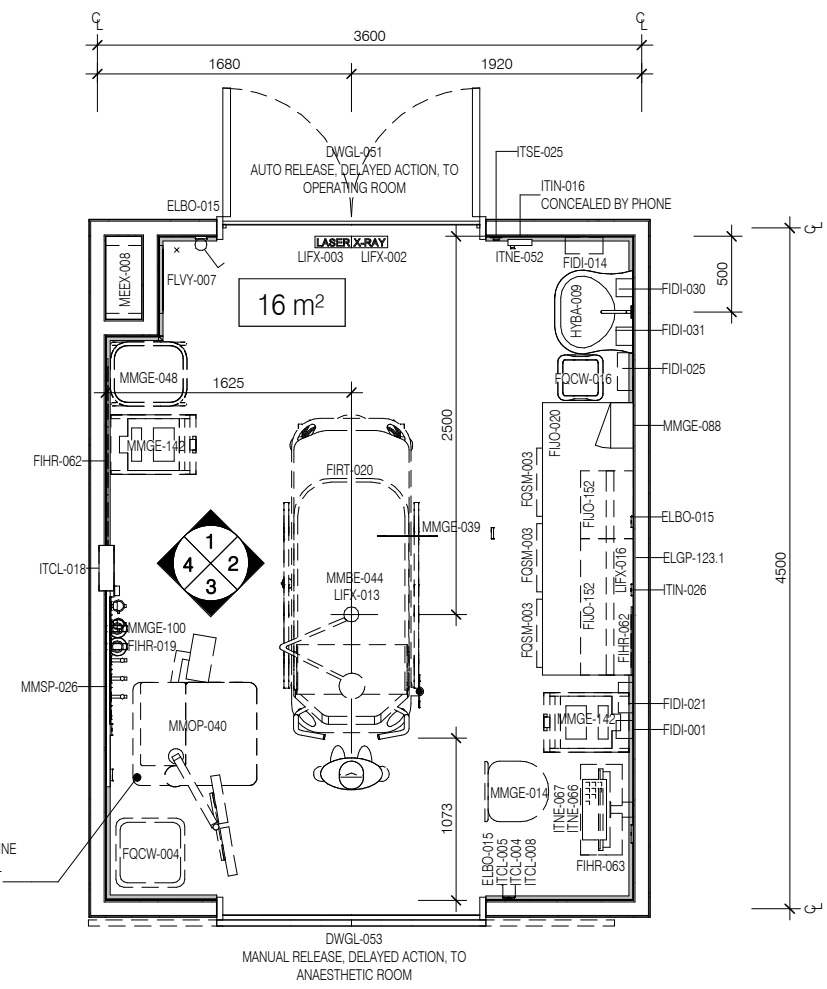

PLAN

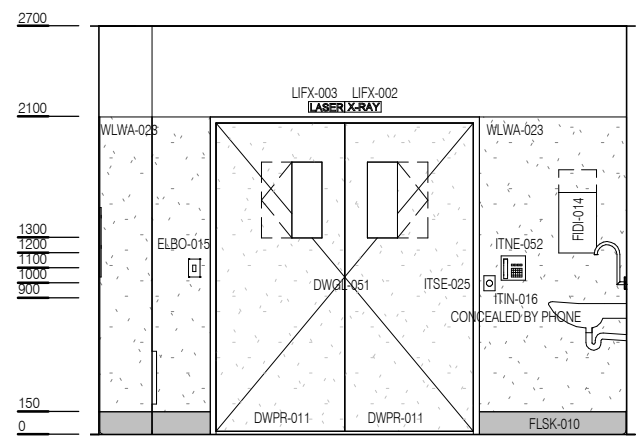

ELEVATION 1

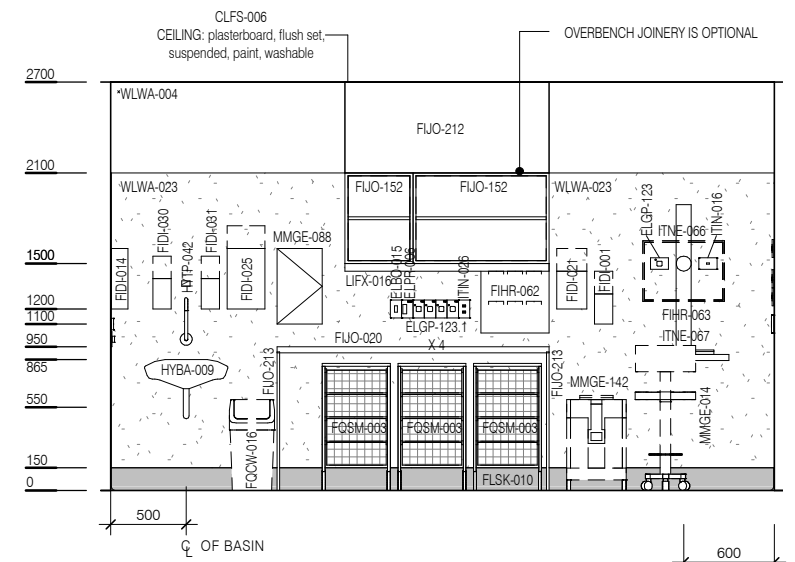

ELEVATION 2

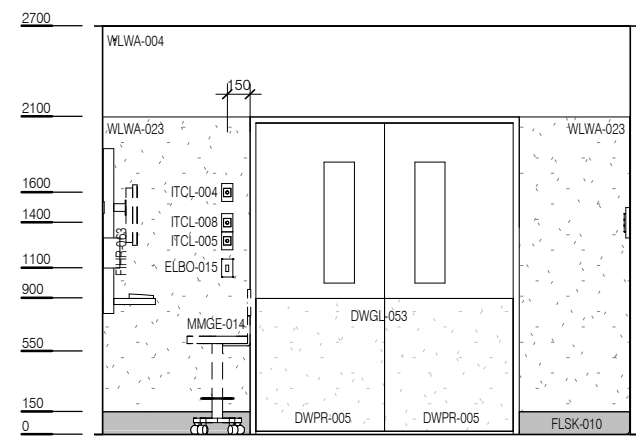

ELEVATION 3

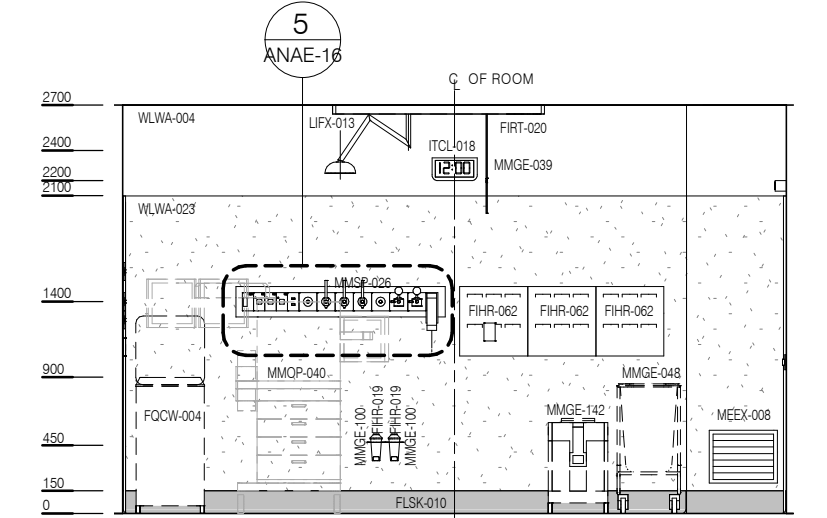

ELEVATION 4



REV	DESCRIPTION	DATE
1	FIRST ISSUE	02.07.2018

FOR GUIDANCE

SCALE	RLS Room Code	REV
1 : 50 @ A3	ANAE-16	1