

AUSTRALASIAN HFG STANDARD COMPONENTS

Room Layout Sheet

RLS Room Code: AUD-TR

Room Name:

1:50 2.5m 2 1.5 1 0.5 0
AUDIOLOGY TESTING ROOM

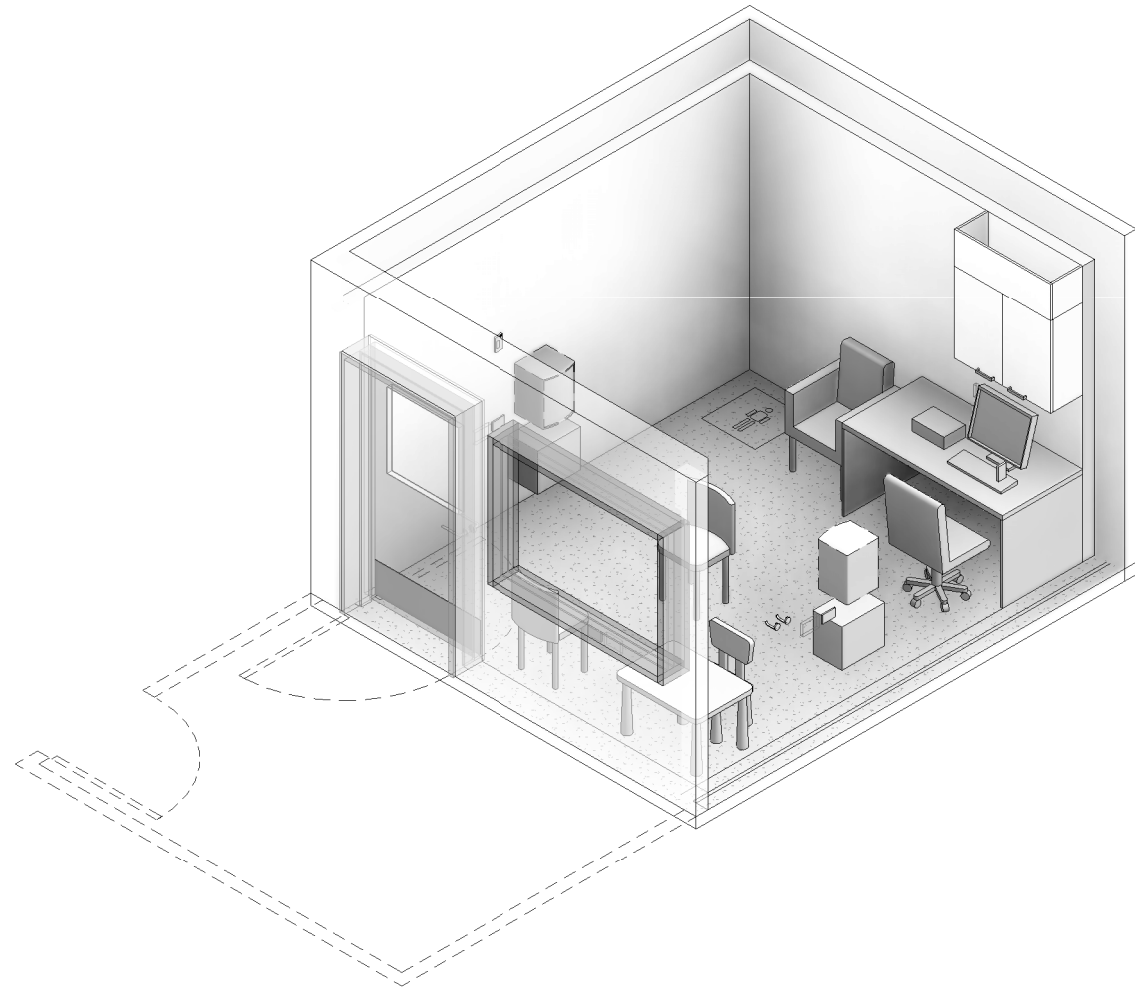

CODE	DESCRIPTION
DWPR-001	DOOR PROTECTION: kickplate, to 300 AFFL
ELBO-012	SWITCH: light, dimmer
ELGP-208	GPO: double, wall mounted
ELPR-001	BODY PROTECTED ELECTRICAL AREA
ELPR-006	RCD: residual current device
FIHR-029	HOOK: equipment
FIJO-145	CUPBOARD: wall mount, double door, adj shelves, lockable
FIJO-212	BULKHEAD: joinery
FLCP-006	FLOOR FINISH: carpet, carpet tiles, 90/10 wool/nylon
FQBS-012	CHAIR: child
FQBS-014	CHAIR: client
FQBS-018	CHAIR: office, ergonomic
FQBS-039	LOUNGE: 1 seat
FQDW-001	DESK: adj height, 1500W x 750D x 750H nom.
FQTA-003	TABLE: children's play
ITAV-061	SPEAKER: audiology
ITIN-026	OUTLET: data, double RJ45, wall mounted
ITNE-007	COMPUTER: desktop, with display screen
ITSE-006	BUTTON: duress, fixed
MMAH-005	BOOTH: audiometric
MMAH-036	CONSOLE: control, audiometric booth
MMAH-043	DEVICE: visual reinforcement audiometry
MMSP-032	SERVICES PANEL: instrument jack

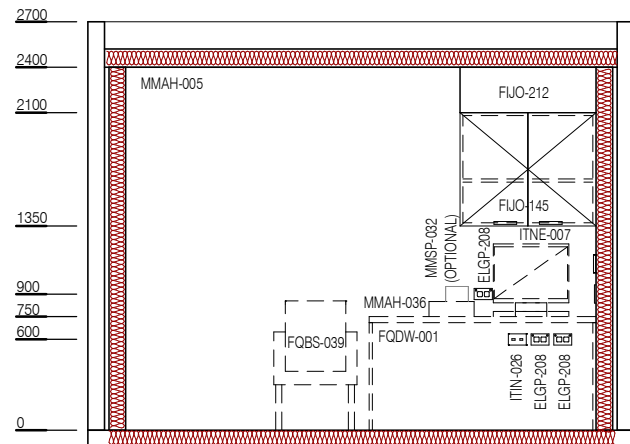
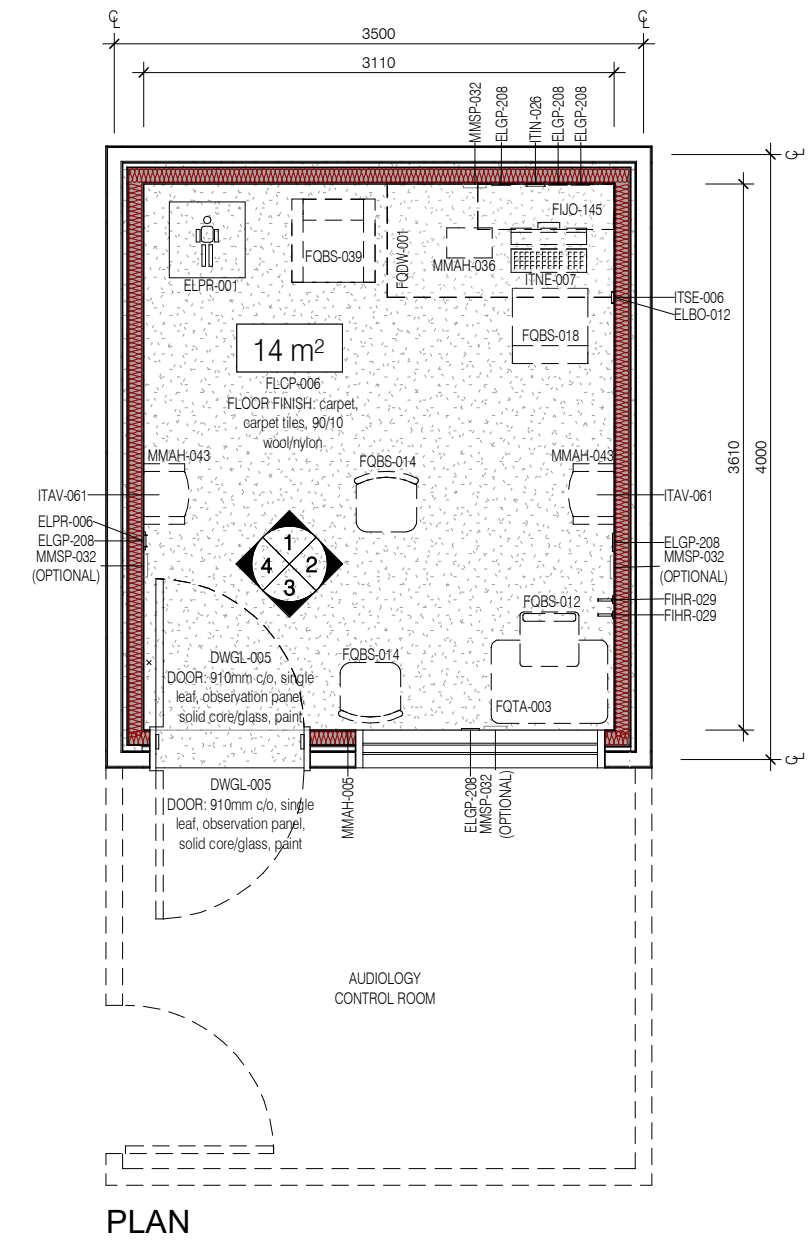

ELEVATION 1

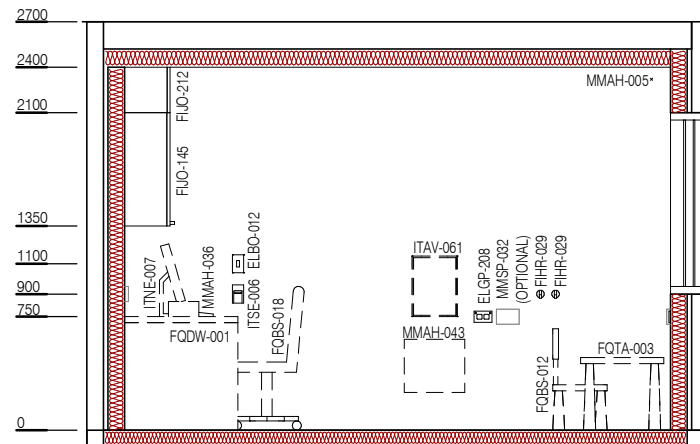

ELEVATION 2

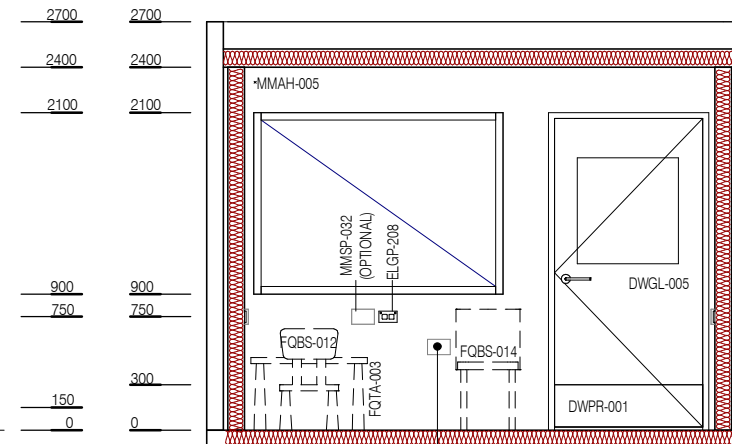

ELEVATION 3

SERVICES CUT-OUT TO CONTROL ROOM AS REQUIRED

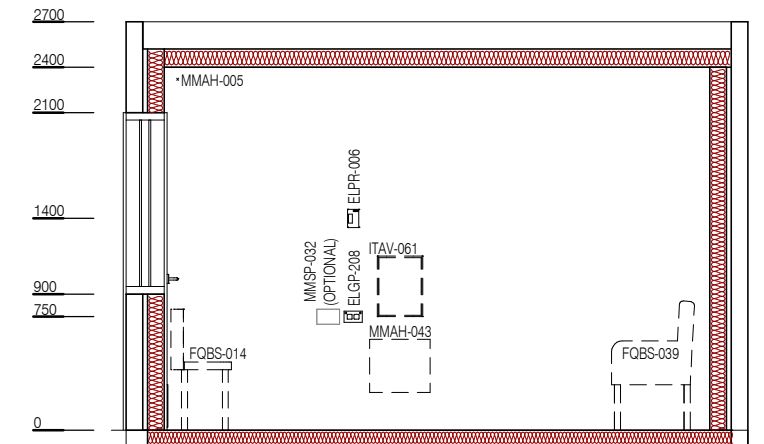

ELEVATION 4



REV	DESCRIPTION	DATE
4	General update following ERG review	26.04.2021

FOR GUIDANCE

SCALE	RLS Room Code	REV
1 : 50 @ A3	AUD-TR	4