

AUSTRALASIAN HFG STANDARD COMPONENTS

Room Layout Sheet

RLS Room Code: **BIRM-A(1)**

1:50 2.5m 2 1.5 1 0.5 0

Room Name: **BIRTHING ROOM - LDR WITHOUT BATH**

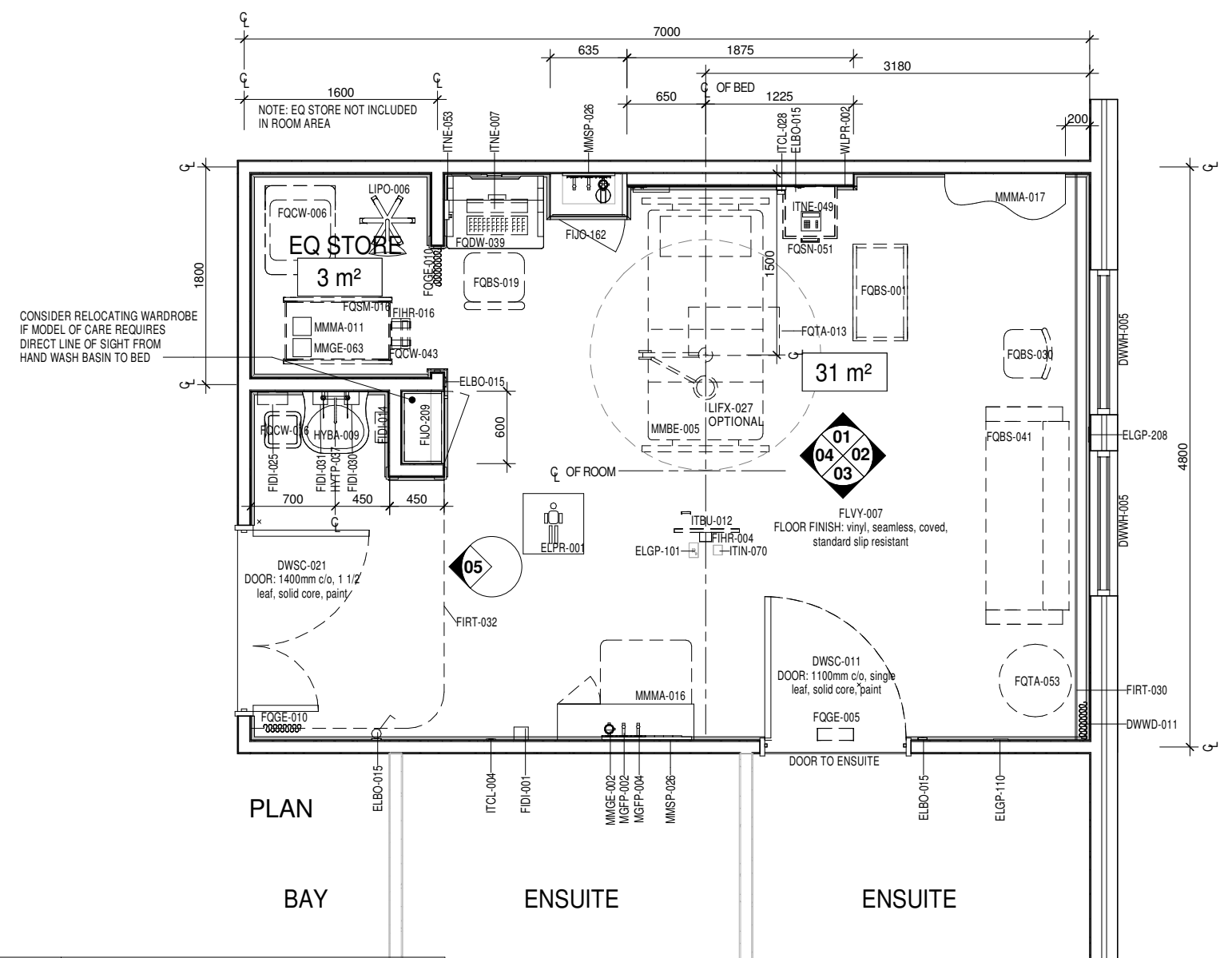

CODE	DESCRIPTION
CLGE-001	CEILING: plasterboard, bulkhead, paint
DWPR-005	DOOR PROTECTION: protection plate to 900 AFFL
DWWD-011	CURTAIN: window, drapes
DWWH-005	WINDOW
ELBO-015	SWITCH: light, single
ELGP-101	GPO: single, ceiling mounted
ELGP-109.1	GPO: single, wall mounted (V)
ELGP-110	GPO: single, wall mounted, cleaner
ELGP-122.1	GPO: emergency power, single, on services panel (V)
ELGP-123.1	GPO: emergency power, single, wall mounted (V)
ELGP-205	GPO: double, on services panel
ELGP-208	GPO: double, wall mounted
ELGP-208.1	GPO: double, wall mounted (V)
ELPR-001	BODY PROTECTED ELECTRICAL AREA
ELPR-006	RCD: residual current device
FIDI-001	DISPENSER: alcohol based hand rub
FIDI-014	DISPENSER: disposable glove
FIDI-025	DISPENSER: paper/hand towel
FIDI-030	DISPENSER: soap
FIDI-031	DISPENSER: soap antiseptic
FIHR-004	BRACKET: for display screen, ceiling mounted
FIHR-019	BRACKET: for suction bottle
FUO-162	CUPBOARD: tall, single door, to conceal services
FUO-209	CUPBOARD: tall, single door, adj shelves and clothes rail, recessed
FIRT-030	TRACK: curtain, flat pelmet
FIRT-032	TRACK: curtain, privacy, L shaped

CODE	DESCRIPTION
FLSK-010	SKIRTING: vinyl, floor vinyl coved, 150H, prefinished
FLVY-007	FLOOR FINISH: vinyl, seamless, coved, standard slip resistant
FQBS-001	BASSINET
FQBS-019	CHAIR: office, ergonomic, high
FQBS-030	CHAIR: visitor, patient
FQBS-041	LOUNGE: 2.5 seat
FQCW-016	BIN: waste, general, 20L
FQDW-039	DESK: adj height, 800W x 600D x 1000H nom.
FQGE-005	CLOCK: analogue, battery operated
FQGE-010	CURTAIN: privacy screen
FQSN-051	LOCKER: 2 drawers, open under, lockable, mobile
FQTA-013	TABLE: overbed
FQTA-053	TABLE: round, 600 diam, low height
HYBA-009	BASIN: handwash, Type A, scrub
HYTP-037	TAPWARE: mixer, elbow levers
ITBU-012	DISPLAY SCREEN: patient entertainment system
ITCL-004	BUTTON: nurse call, emergency
ITCL-006	BUTTON: nurse call, patient to staff
ITCL-008	BUTTON: nurse call, staff assist
ITCL-028	HANDSET: nurse call, with patient to staff call button
ITIN-026	OUTLET: data, double RJ45, wall mounted
ITIN-070	OUTLET: MATV
ITNE-007	COMPUTER: desktop, with display screen
ITNE-049	TELEPHONE: handset, desktop
ITNE-053	TELEPHONE: handset, wall mount, handsfree
LIFX-011	LIGHT: reading light

CODE	DESCRIPTION
LIFX-017	LIGHT: night light
LIFX-027	LIGHT: examination, ceiling mounted
MGAS-022	OUTLET: medical air (MA), on services panel
MGAS-023	OUTLET: medical air (MA), wall mounted
MGAS-033	OUTLET: nitrous oxide (N2O), wall mounted
MGAS-042	OUTLET: oxygen (O2), on services panel
MGAS-043	OUTLET: oxygen (O2), wall mounted
MGAS-055	OUTLET: scavenge, wall mounted
MGAS-062	OUTLET: suction, on services panel
MGAS-063	OUTLET: suction, wall mounted
MGFP-002	FLOWMETER: medical air
MGFP-004	FLOWMETER: oxygen
MMBE-005	BED: patient, birthing, electric
MMGE-002	ADAPTER: suction
MMGE-100	SUCTION BOTTLE
MMMA-016	RESUSCITATOR: infant, wall mounted
MMMA-017	MANTLEPIECE: birthing, wall mounted
MMSP-026	SERVICES PANEL: wall mounted
WLPR-002	WALL PROTECTION: bed protection wall panel, composite, laminate finish
WLPR-011	WALL PROTECTION: corner guards, to 900 AFFL min.
WLWA-004	WALL FINISH: paint, acrylic, washable
WLWA-010	WALL FINISH: splashback, vinyl

EQUIPMENT STORE 1	
CODE	DESCRIPTION
FIHR-016	BRACKET: for sharps bin
FLSK-010	SKIRTING: vinyl, floor vinyl coved, 150H, prefinished
FQCW-006	BIN: waste, clinical, 240L
FQCW-043	BIN: waste, sharps, on trolley
FQGE-010	CURTAIN: privacy screen
FQSM-016	TROLLEY
LIPO-006	LIGHT: examination, mobile
MMGE-063	MONITOR: patient, foetal, CTG
MMMA-011	MIXER: oxygen and nitrous oxide
WLPR-011	WALL PROTECTION: corner guards, to 900 AFFL min.



REV	DESCRIPTION	DATE
3	Coding and naming updated	20.03.2017
4	First Issue. replaces previous Standard Component BIRM	05.04.2018

FOR GUIDANCE

SCALE	RLS Room Code	REV
1 : 50 @ A3	BIRM-A(1)	4

