

# AUSTRALASIAN HFG STANDARD COMPONENTS

Room Layout Sheet

RLS Room Code: **CLAB-EP**

1:50 2.5m 2 1.5 1 0.5 0

Room Name: **CATHETER LABORATORY - ELECTROPHYSIOLOGY STUDIES**

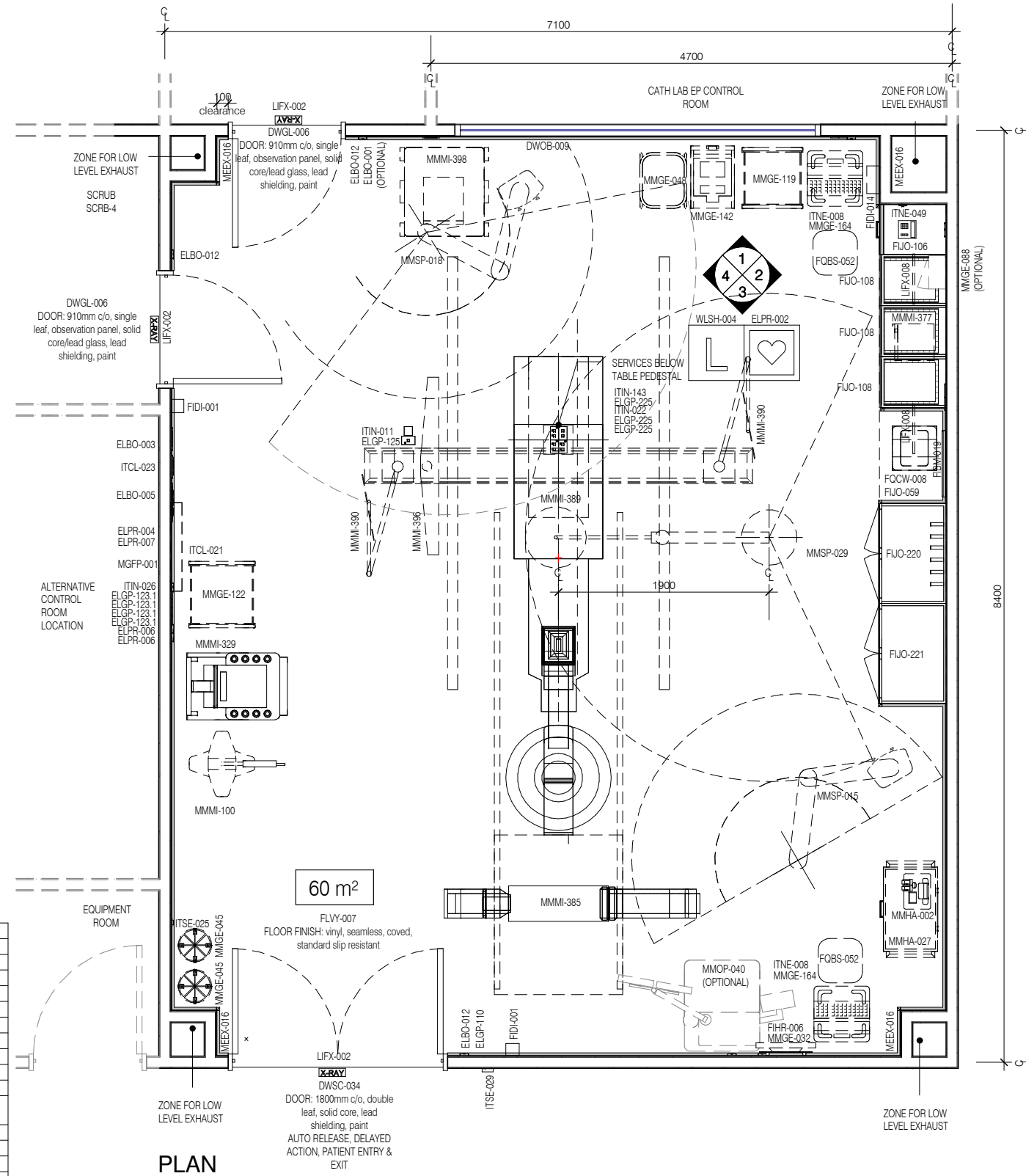
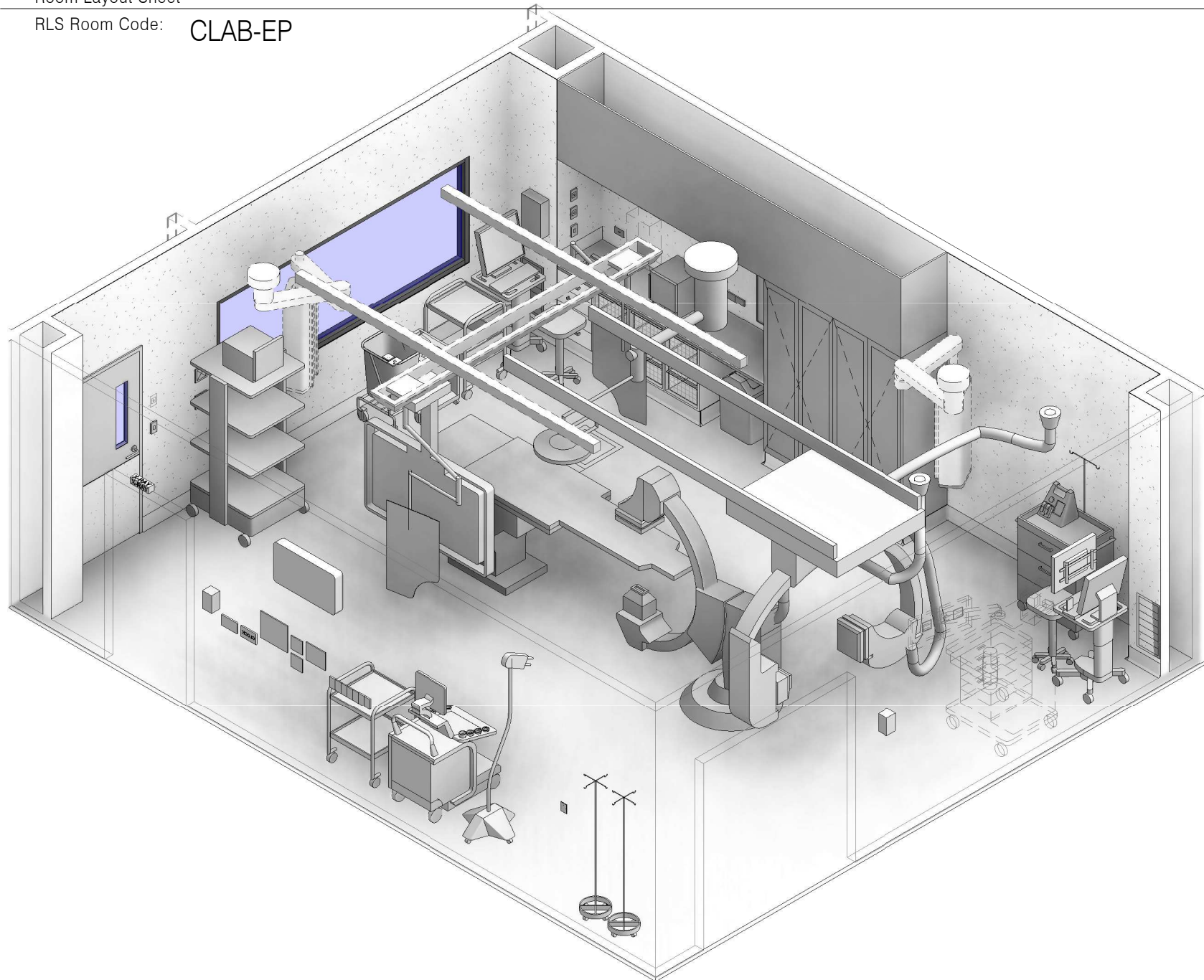

CODE	DESCRIPTION
DWOB-009	OBSERVATION: internal window, lead glass, clear
DWPR-005	DOOR PROTECTION: protection plate to 900 AFFL
ELBO-001	BUTTON: emergency stop
ELBO-003	CONTROL PANEL: lighting
ELBO-005	EQUIPOTENTIAL JUNCTION BOX
ELBO-012	SWITCH: light, dimmer
ELGP-110	GPO: single, wall mounted, cleaner
ELGP-123.1	GPO: emergency power, single, wall mounted (V)
ELGP-125	GPO: emergency power, single, ceiling mounted
ELGP-223	GPO: emergency power, double, wall mounted
ELGP-225	GPO: emergency power, double, in floorbox
ELPR-002	CARDIAC PROTECTED ELECTRICAL AREA
ELPR-004	MONITOR: line isolation
ELPR-006	RCD: residual current device
ELPR-007	MONITOR: UPS Status indicator
FIBM-019	WHITEBOARD: fixed, magnetic
FIDI-001	DISPENSER: alcohol based hand rub
FIDI-014	DISPENSER: disposable glove
FIHR-006	BRACKET: for display screen, wall mounted
FUJO-059	BENCH TOP: 600D, joinery under, laminate finish
FUJO-106	CUPBOARD: drawer unit, 4 equal
FUJO-108	CUPBOARD: drawer unit, baskets, 3 x Wire (400mm wide)
FUJO-212	BULKHEAD: joinery
FUJO-220	CUPBOARD: tall, double door, glazed, catheter hanging
FUJO-221	CUPBOARD: tall, double door, glazed

CODE	DESCRIPTION
FLSK-010	SKIRTING: vinyl, floor vinyl coved, 150H, prefinished
FLVY-007	FLOOR FINISH: vinyl, seamless, coved, standard slip resistant
FOBS-052	STOOL: mobile, high, adj height
FQCW-008	BIN: waste, clinical, 50L
ITCL-004	BUTTON: nurse call, emergency
ITCL-008	BUTTON: nurse call, staff assist
ITCL-021	CLOCK: clock system slave dual time / elapsed time
ITCL-023	CONTROL PANEL: master clock system
ITIN-011	OUTLET: data, single RJ45, ceiling mounted
ITIN-016	OUTLET: data, single RJ45, wall mounted
ITIN-022	OUTLET: data, double RJ45, in floorbox
ITIN-026	OUTLET: data, double RJ45, wall mounted
ITIN-143	FLOORBOX: for power, data, AV, flush mounted
ITNE-008	COMPUTER: for workstation on wheels
ITNE-049	TELEPHONE: handset, desktop
ITSE-025	DOOR RELEASE: access control, remote activation
ITSE-029	INTERCOM: audio, wall mount
LIFX-002	LIGHT: illuminated sign, "X-Ray in Use"
LIFX-008	LIGHT: task light, built in
MEEEX-016	RETURN AIR: grille, low level
MGFP-001	ALARM PANEL: medical gases
MMGE-032	DISPLAY SCREEN: slave, for patient monitor
MMGE-045	IV STAND: mobile
MMGE-048	LINEN CARRIER: dirty, single
MMGE-088	SAFE: dangerous drugs, small

CODE	DESCRIPTION
MMGE-119	TROLLEY: equipment
MMGE-122	TROLLEY: gowns
MMGE-142	TROLLEY: sharps bin
MMGE-164	WORKSTATION ON WHEELS: clinical, mobile
MMHA-002	DEFIBRILLATOR
MMHA-027	TROLLEY: resuscitation, adult
MMMI-100	INJECTOR: contrast, CT
MMMI-329	DEVICE: imaging, ultrasound scanning unit
MMMI-377	WARMER: contrast
MMMI-385	SYSTEM: imaging, cath lab, dual plane, ceiling
MMMI-389	TABLE: operating, fixed, narrow table plate, cath lab, dual plane
MMMI-390	SHIELD: radiation, upper body, mobile, cath lab
MMMI-396	DISPLAY SCREEN: cath lab, multi modality
MMMI-398	SYSTEM: electrophysiology, cath lab
MMMI-400	STAND: ceiling, with traverse bridge, cath lab
MMOP-040	MACHINE: anaesthetic with integral monitors
MMSP-015	PENDANT: single, anaesthetic (fixed or adjustable height)
MMSP-018	PENDANT: single, wet and dry combination (fixed or adjustable height)
MMSP-029	LIGHT: operating, single, 550 diam nom.
WLSH-004	SHIELDING: lead lining
WLWA-019	WALL FINISH: vinyl, full height



REV	DESCRIPTION	DATE
1	First Issue	13.05.2020

FOR GUIDANCE

SCALE	RLS Room Code	REV
1 : 50 @ A3	CLAB-EP	1

# AUSTRALASIAN HFG STANDARD COMPONENTS

Room Layout Sheet

RLS Room Code: **CLAB-EP**

Room Name: **CATHETER LABORATORY - ELECTROPHYSIOLOGY STUDIES**

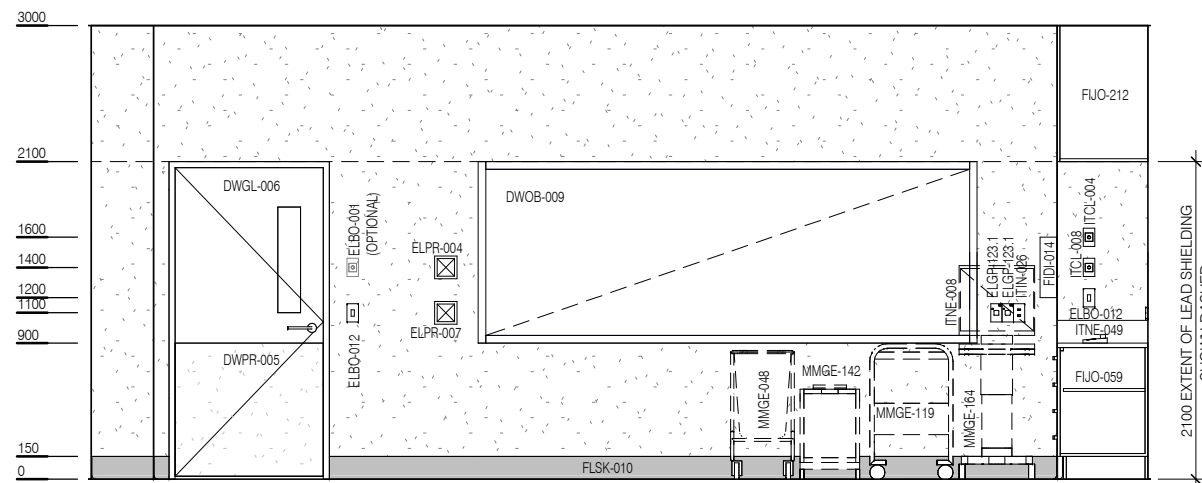
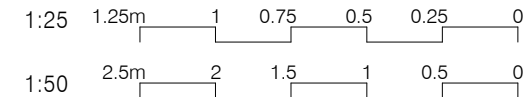

**ELEVATION 1**

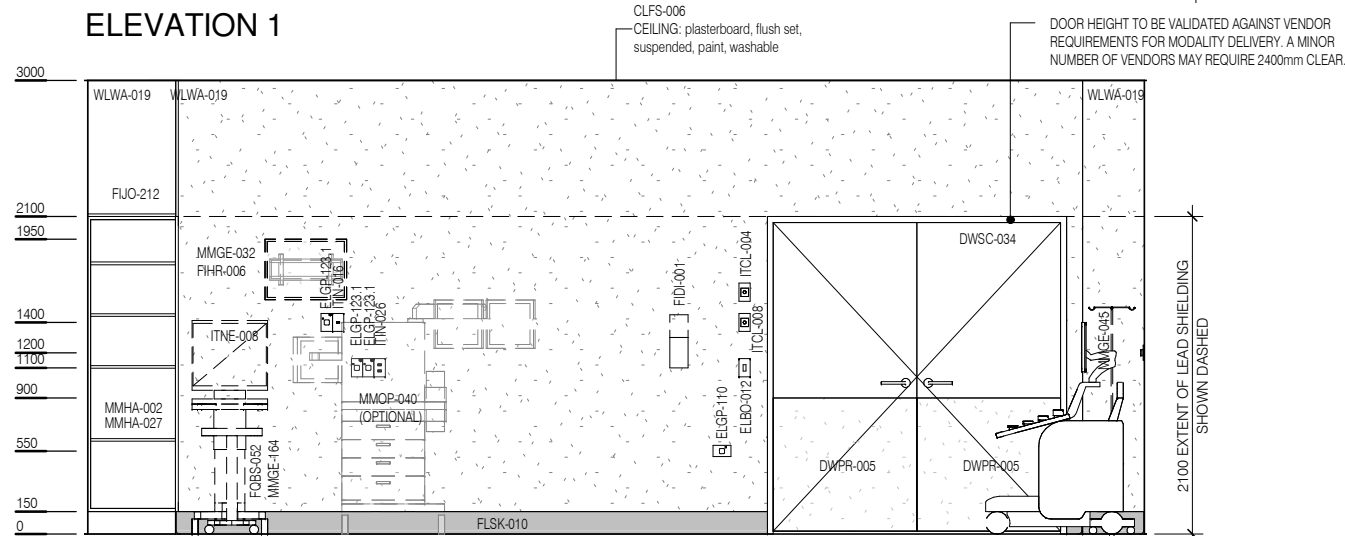

**ELEVATION 2**

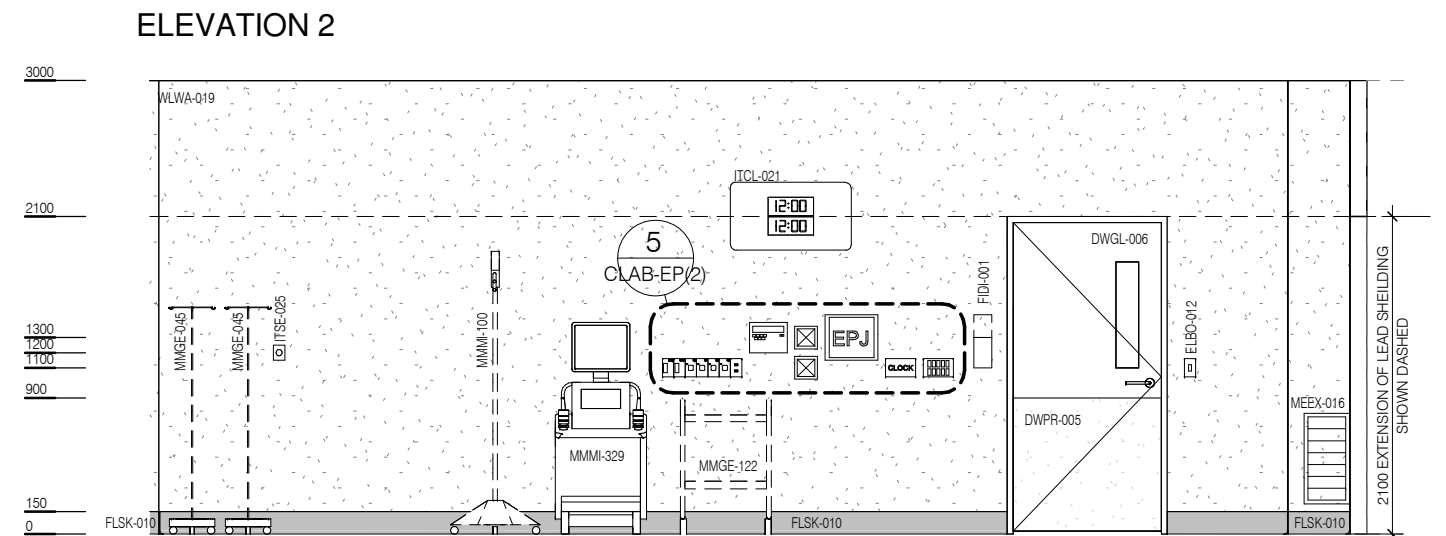

**ELEVATION 3**

**ELEVATION 4**

CODE	DESCRIPTION
DWOB-009	OBSERVATION: internal window, lead glass, clear
DWPR-005	DOOR PROTECTION: protection plate to 900 AFFL
ELBO-001	BUTTON: emergency stop
ELBO-003	CONTROL PANEL: lighting
ELBO-005	EQUIPOTENTIAL JUNCTION BOX
ELBO-012	SWITCH: light, dimmer
ELGP-110	GPO: single, wall mounted, cleaner
ELGP-123.1	GPO: emergency power, single, wall mounted (V)
ELGP-125	GPO: emergency power, single, ceiling mounted
ELGP-223	GPO: emergency power, double, wall mounted
ELGP-225	GPO: emergency power, double, in floorbox
ELPR-002	CARDIAC PROTECTED ELECTRICAL AREA
ELPR-004	MONITOR: line isolation
ELPR-006	RCD: residual current device
ELPR-007	MONITOR:UPS Status indicator
FIBM-019	WHITEBOARD: fixed, magnetic
FIDI-001	DISPENSER: alcohol based hand rub
FIDI-014	DISPENSER: disposable glove
FIHR-006	BRACKET: for display screen, wall mounted
FJO-059	BENCH TOP: 600D, joinery under, laminate finish
FJO-106	CUPBOARD: drawer unit, 4 equal
FJO-108	CUPBOARD: drawer unit, baskets, 3 x Wire (400mm wide)
FJO-212	BULKHEAD: joinery
FJO-220	CUPBOARD: tall, double door, glazed, catheter hanging
FJO-221	CUPBOARD: tall, double door, glazed
FLSK-010	SKIRTING: vinyl, floor vinyl coved, 150H, prefinished
FLVY-007	FLOOR FINISH: vinyl, seamless, coved, standard slip resistant
FQBS-052	STOOL: mobile, high, adj height
FQCW-008	BIN: waste, clinical, 50L
ITCL-004	BUTTON: nurse call, emergency

CODE	DESCRIPTION
ITCL-008	BUTTON: nurse call, staff assist
ITCL-021	CLOCK: clock system slave dual time / elapsed time
ITCL-023	CONTROL PANEL: master clock system
ITIN-011	OUTLET: data, single RJ45, ceiling mounted
ITIN-016	OUTLET: data, single RJ45, wall mounted
ITIN-022	OUTLET: data, double RJ45, in floorbox
ITIN-026	OUTLET: data, double RJ45, wall mounted
ITIN-143	FLOORBOX: for power, data, AV, flush mounted
ITNE-008	COMPUTER: for workstation on wheels
ITNE-049	TELEPHONE: handset, desktop
ITSE-025	DOOR RELEASE: access control, remote activation
ITSE-029	INTERCOM: audio, wall mount
LIFX-002	LIGHT: illuminated sign, "X-Ray in Use"
LIFX-008	LIGHT: task light, built in
MEEEX-016	RETURN AIR: grille, low level
MGFP-001	ALARM PANEL: medical gases
MMGE-032	DISPLAY SCREEN: slave, for patient monitor
MMGE-045	IV STAND: mobile
MMGE-048	LINEN CARRIER: dirty, single
MMGE-088	SAFE: dangerous drugs, small
MMGE-119	TROLLEY: equipment
MMGE-122	TROLLEY: gowns
MMGE-142	TROLLEY: sharps bin
MMGE-164	WORKSTATION ON WHEELS: clinical, mobile
MMHA-002	DEFIBRILLATOR
MMHA-027	TROLLEY: resuscitation, adult
MMMI-100	INJECTOR: contrast, CT
MMMI-329	DEVICE: imaging, ultrasound scanning unit
MMMI-377	WARMER: contrast
MMMI-385	SYSTEM: imaging, cath lab, dual plane, ceiling

CODE	DESCRIPTION
MMMI-389	TABLE: operating, fixed, narrow table plate, cath lab, dual plane
MMMI-390	SHIELD: radiation, upper body, mobile, cath lab
MMMI-396	DISPLAY SCREEN: cath lab, multi modality
MMMI-398	SYSTEM: electrophysiology, cath lab
MMMI-400	STAND: ceiling, with traverse bridge, cath lab
MMOP-040	MACHINE: anaesthetic with integral monitors
MMSP-015	PENDANT: single, anaesthetic (fixed or adjustable height)
MMSP-018	PENDANT: single, wet and dry combination (fixed or adjustable height)
MMSP-029	LIGHT: operating, single, 550 diam nom.
WLSH-004	SHIELDING: lead lining
WLWA-019	WALL FINISH: vinyl, full height

NOTE: REFER TO RDS FOR PENDANT MOUNTED SERVICES AS THESE ITEMS ARE NOT INCLUDED IN THIS SCHEDULE

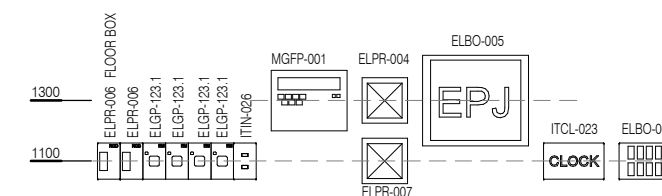

**ELEVATION 5 ( 1 : 25 @ A3 )**



REV	DESCRIPTION	DATE
1	First Issue	13.05.2020

FOR GUIDANCE

SCALE	RLS Room Code	REV
1 : 50 @ A3	CLAB-EP	1