

CODE	DESCRIPTION
CLGE-001	CEILING: plasterboard, bulkhead, paint
DWPR-006	DOOR PROTECTION: protection plate, to 900 AFFL, PVC, prefinished
DWPR-010	DOOR PROTECTION: to door frame, PVC, prefinished
ELBO-015	SWITCH: light, single
ELGP-208	GPO: double, wall mounted
ELGP-223	GPO: emergency power, double, wall mounted
FIDI-014	DISPENSER: disposable glove
FIDI-025	DISPENSER: paper/hand towel
FIDI-030	DISPENSER: soap
FIDI-031	DISPENSER: soap antiseptic
FIHR-016	BRACKET: for sharps bin
FUJO-032	BENCH: 750D, open under, stainless steel lipped
FUJO-059	BENCH TOP: 600D, joinery under, laminate finish
FUJO-100	BENCH LEGS: stainless steel, for bench top
FUJO-104	CUPBOARD: drawer unit, 3 equal
FUJO-143	CUPBOARD: wall mount, double door, adj shelves
FUJO-156	CUPBOARD: wall mount, single door, adj shelves
FUJO-196	SHELF: stainless steel, overbench, wall mount
FUJO-197	SHELF: stainless steel, underbench
FLSK-010	SKIRTING: vinyl, floor vinyl coved, 150H, prefinished
FLY-004	FLOOR FINISH: vinyl, seamless, coved, non-slip, safety
FQCW-006	BIN: waste, clinical, 240L
FQCW-016	BIN: waste, general, 20L
HYBA-010	BASIN: handwash, Type B
HYBA-046	SINK: flushing rim
HYBA-063	SINK: single, 750 x 500 x 300D
HYDR-004	DRAIN: floor waste
HYDR-006	DRAIN: tundish
HYTP-006	HOSE: spray, pressure control
HYTP-008	OUTLET: cold water
HYTP-013	OUTLET: hot water
HYTP-015	ELBOW: brass
LIFX-008	LIT: task light, built in
MGAS-023	LET: medical air (M)
MGAS-063	LET: suction, wall mounted
MGFP-002	METER: medical air
MMGE-002	METER: suction
MMIC-054	MILISER: low temperature, rapid cycle, single door
WLWA-004	WALL FINISH: paint, washable
WLWA-020	WALL FINISH: vinyl, to 1500 AFFL

**RETIRED**

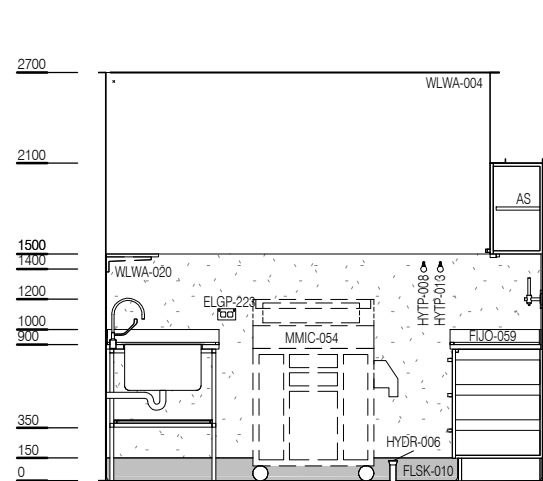

ELEVATION 1

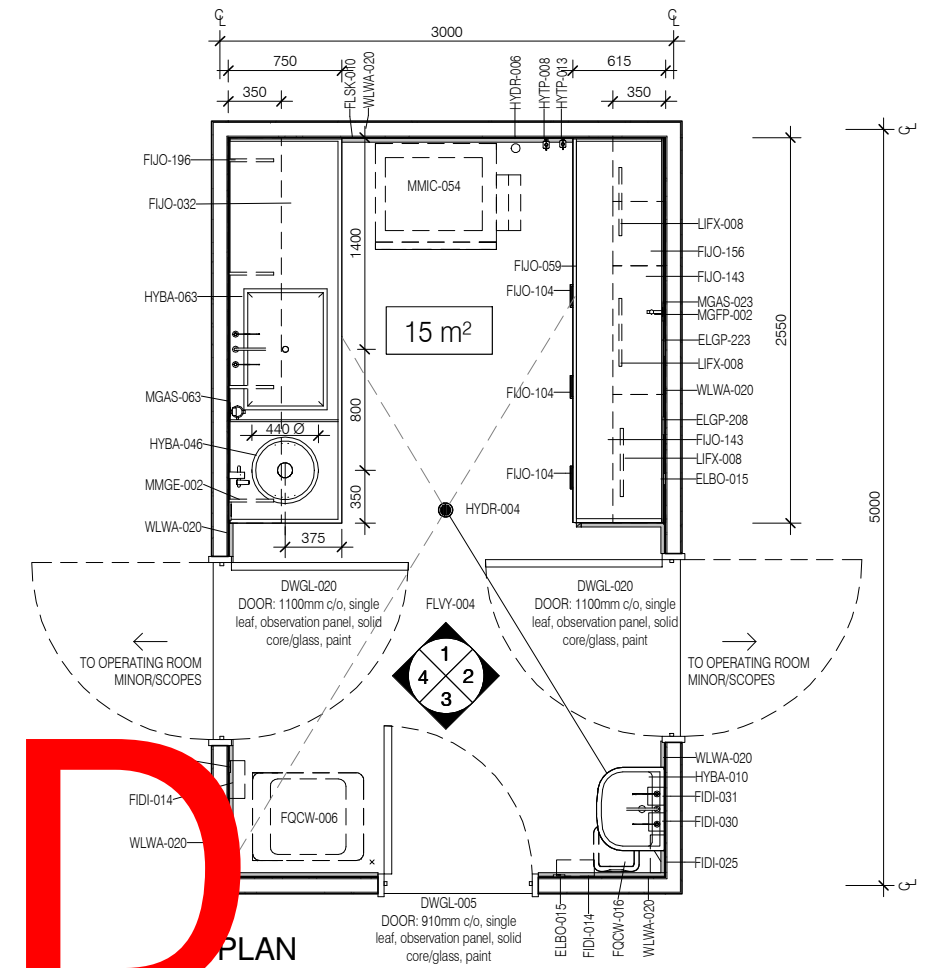
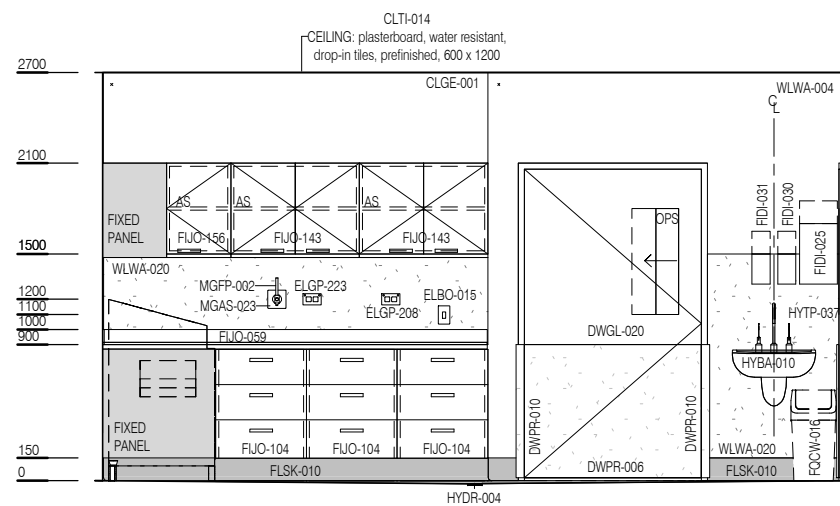

ELEVATION 2

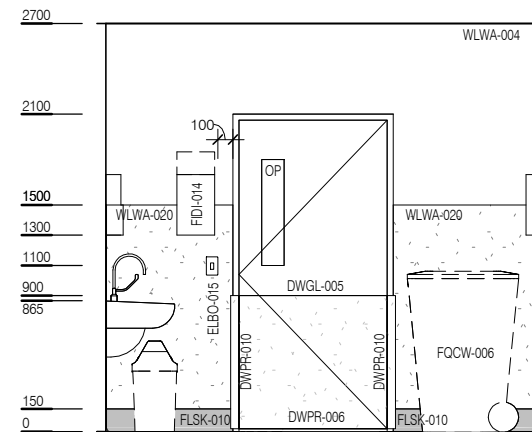

ELEVATION 3

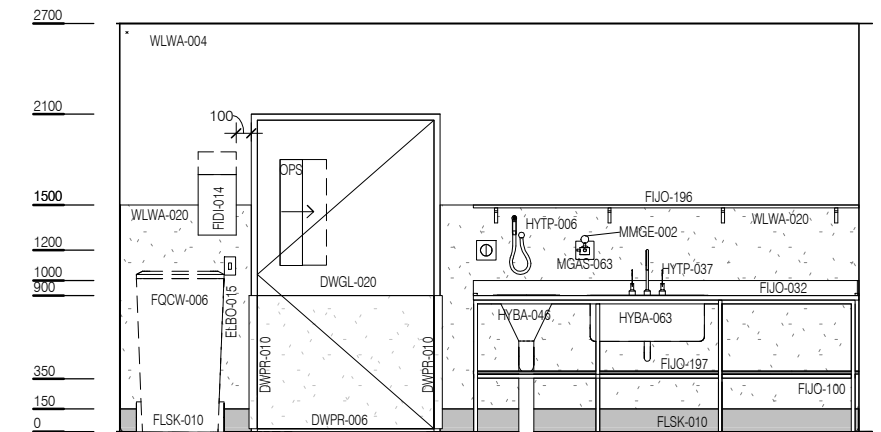

ELEVATION 4