

AUSTRALASIAN HFG STANDARD COMPONENTS

Room Layout Sheet

RLS Room Code: **CLUP-P**

Room Name:

CLEAN-UP ROOM (PATHOLOGY), 12m²

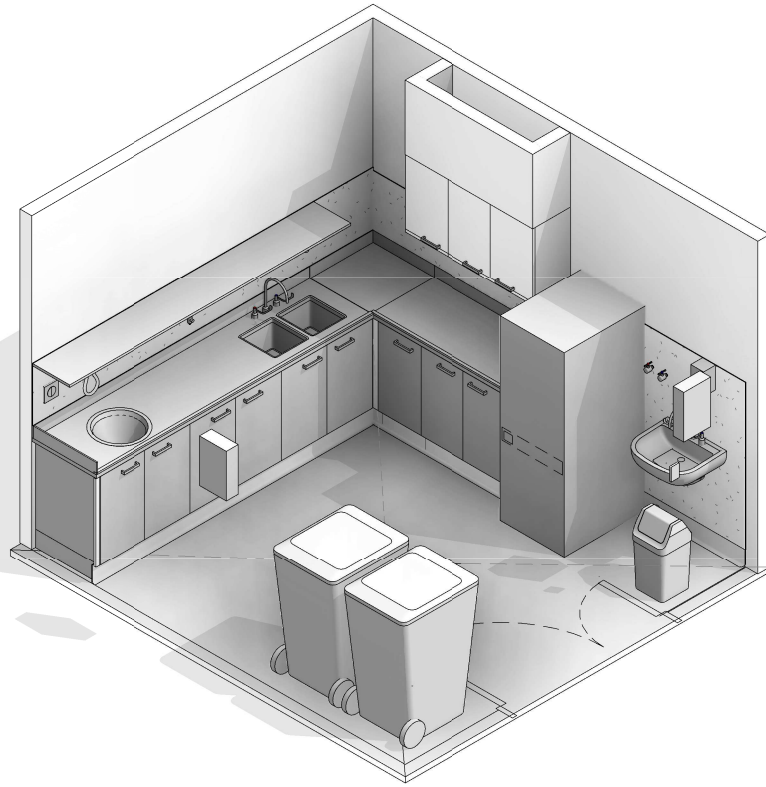
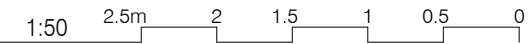

CODE	DESCRIPTION
CLGE-001	CEILING: plasterboard, bulkhead, paint
DWPR-006	DOOR PROTECTION: protection plate, to 900 AFFL, PVC, prefinished
DWPR-010	DOOR PROTECTION: to door frame, PVC, prefinished
ELBO-015	SWITCH: light, single
ELGP-106	GPO: single, special, for equipment
ELGP-208	GPO: double, wall mounted
ELPR-003	ISOLATOR: electrical, 1ph+n
FIDI-014	DISPENSER: disposable glove
FIDI-025	DISPENSER: paper/hand towel
FIDI-030	DISPENSER: soap
FUJO-060	BENCH TOP: 600D, joinery under, stainless steel lipped
FUJO-135	CUPBOARD: underbench, double door, adj shelves
FUJO-140	CUPBOARD: underbench, single door, adj shelves
FUJO-143	CUPBOARD: wall mount, double door, adj shelves
FUJO-156	CUPBOARD: wall mount, single door, adj shelves
FUJO-196	SHELF: stainless steel, overbench, wall mount
FLSK-010	SKIRTING: vinyl, floor vinyl coved, 150H, prefinished
FLVY-004	FLOOR FINISH: vinyl, seamless, coved, non-slip, safety
FOCW-006	BIN: waste, clinical, 240L
FOCW-016	BIN: waste, general, 20L
HYBA-010	BASIN: handwash, Type B
HYBA-043	SINK: double
HYBA-046	SINK: flushing rim
HYDR-004	DRAIN: floor waste
HYDR-006	DRAIN: tundish
HYTP-006	HOSE: spray, pressure control
HYTP-008	OUTLET: cold water
HYTP-013	OUTLET: hot water
HYTP-037	TAPWARE: mixer, elbow levers
LIFX-008	LIGHT: task light, built in
MGAS-023	OUTLET: medical air (MA), wall mounted
MGFP-002	FLOWMETER: medical air
MMIC-097	WASHER SANITISER: utensil washer
WLWA-004	WALL FINISH: paint, acrylic, washable
WLWA-020	WALL FINISH: vinyl, to 1500 AFFL

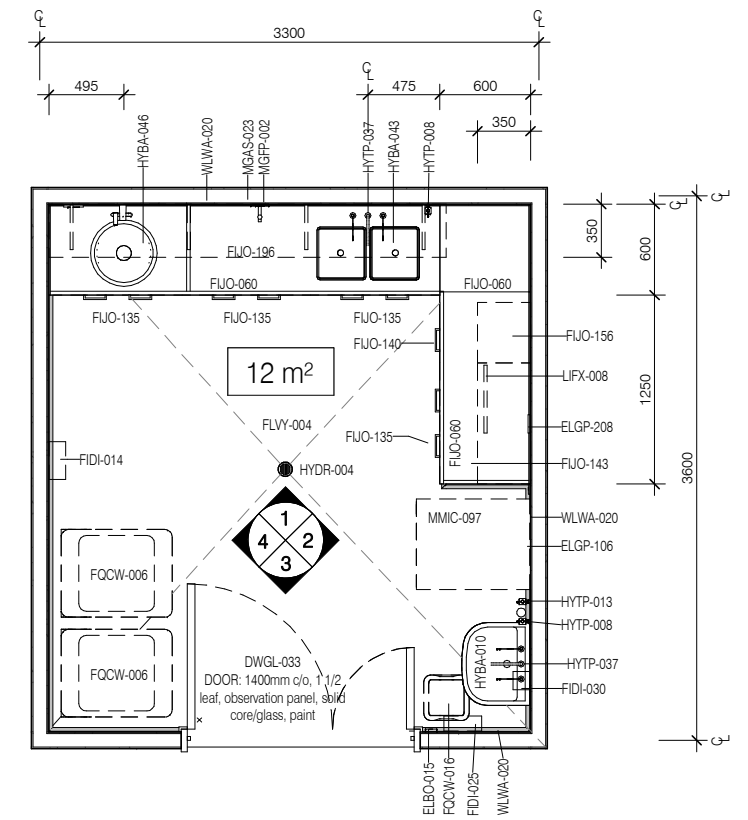

PLAN

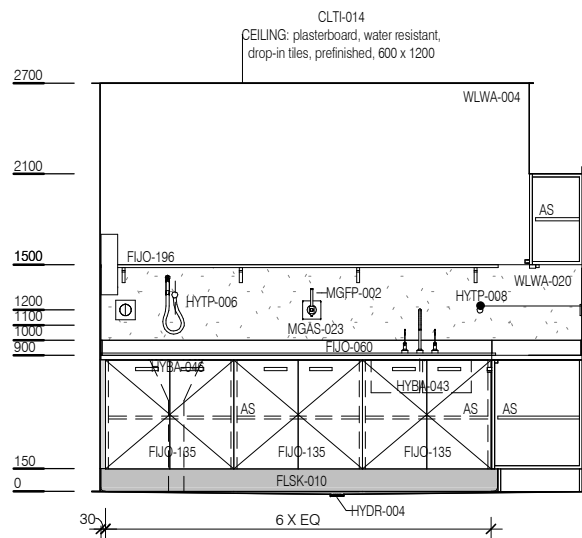

ELEVATION 1

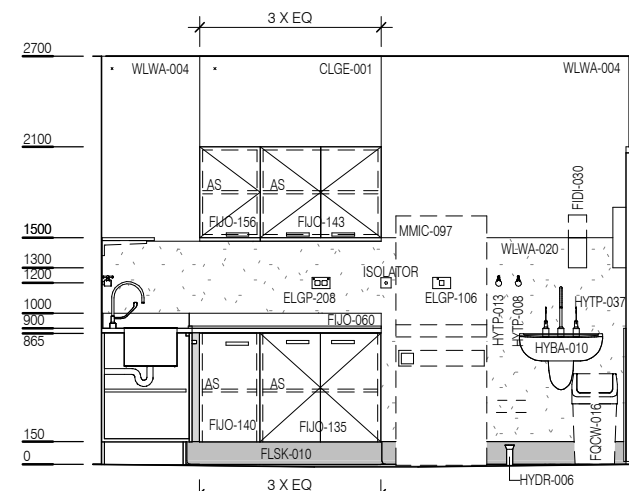

ELEVATION 2

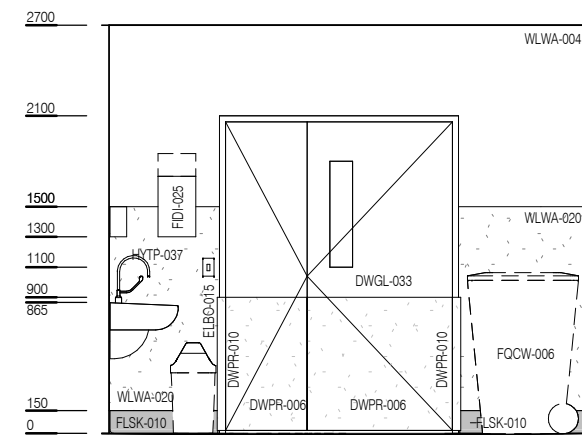

ELEVATION 3

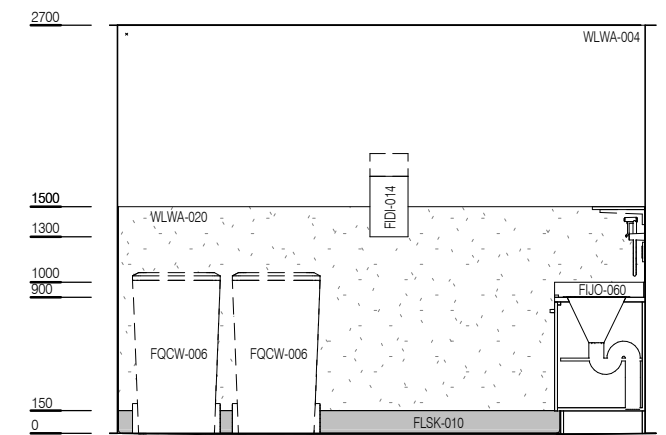

ELEVATION 4

MIN REQUIRED FOR ISOLATOR
MIN REQUIRED FOR TUNDISH
NOTE: ISOLATOR AND TUNDISH ARE REQUIRED FOR SOME MODELS ONLY
SERVICES AS REQUIRED IF UTENSIL WASHER IS INSTALLED.



REV	DESCRIPTION	DATE
3	Coding and naming updated	20.03.2017

FOR GUIDANCE

SCALE	RLS Room Code	REV
1 : 50 @ A3	CLUP-P	3