

# AUSTRALASIAN HFG STANDARD COMPONENTS

Room Layout Sheet

RLS Room Code: **CLUR-14**

Room Name:

**CLEAN UTILITY / MEDICATION ROOM, 14m<sup>2</sup>**



CODE	DESCRIPTION
CLGE-001	CEILING: plasterboard, bulkhead, paint
DWPR-006	DOOR PROTECTION: protection plate, to 900 AFFL, PVC, prefinished
DWPR-010	DOOR PROTECTION: to door frame, PVC, prefinished
ELBO-015	SWITCH: light, single
ELGP-109	GPO: single, wall mounted
ELGP-123.1	GPO: emergency power, single, wall mounted (V)
FIDI-001	DISPENSER: alcohol based hand rub
FIDI-014	DISPENSER: disposable glove
FIDI-022	DISPENSER: moisturiser
FIDI-025	DISPENSER: paper/hand towel
FIDI-030	DISPENSER: soap
FIDI-031	DISPENSER: soap antiseptic
FIHR-016	BRACKET: for sharps bin
FIHR-033	PANEL: for storage bins, wall mount
FUJO-044	BENCH: special depth, open under
FUJO-059	BENCH TOP: 600D, joinery under, laminate finish
FUJO-119	CUPBOARD: tall, double door, pharmacy shelves, lockable
FUJO-126	CUPBOARD: tall, shelf unit, adj shelves
FUJO-135	CUPBOARD: underbench, double door, adj shelves
FUJO-140	CUPBOARD: underbench, single door, adj shelves
FUJO-148	CUPBOARD: wall mount, double door, glazed, adj shelves, lockable
FUJO-152	CUPBOARD: wall mount, shelf unit, adj shelves
FUJO-194	SHELF: laminate
FUJO-204	CUPBOARD: wall mount, shelf unit, double, fixed shelves
FLSK-010	SKIRTING: vinyl, floor vinyl coved, 150H, prefinished
FLVY-007	FLOOR FINISH: vinyl, seamless, coved, standard slip resistant
FLVY-009	FLOOR FINISH: vinyl, seamless, coved, wet area, non-slip
FQCW-016	BIN: waste, general, 20L
FQCW-044	BIN: waste, sharps, wall mounted
FQGE-056	PRINTER: desktop, labels
FQSN-005	BIN: pharmacy returns
FQSN-007	BIN: storage bins, wire mesh, stainless steel
HYBA-010	BASIN: handwash, Type B
HYBA-052	SINK: single, 450 x 350 x 250D
HYTP-037	TAPWARE: mixer, elbow levers
ITBU-001	ALARM: equipment monitoring, temperature
ITIN-016	OUTLET: data, single RJ45, wall mounted
ITIN-026	OUTLET: data, double RJ45, wall mounted
ITNE-007	COMPUTER: desktop, with display screen
ITNE-049	TELEPHONE: handset, desktop
ITSE-038	READER: access control, general
LIFX-008	LIGHT: task light, built in
MMGE-035	FRIDGE: drugs, small
MMGE-087	SAFE: dangerous drugs, medium
MMGE-113	TROLLEY: dressing
MMGE-130	TROLLEY: medication
WLWA-004	WALL FINISH: paint, acrylic, washable
WLWA-020	WALL FINISH: vinyl, to 1500 AFFL

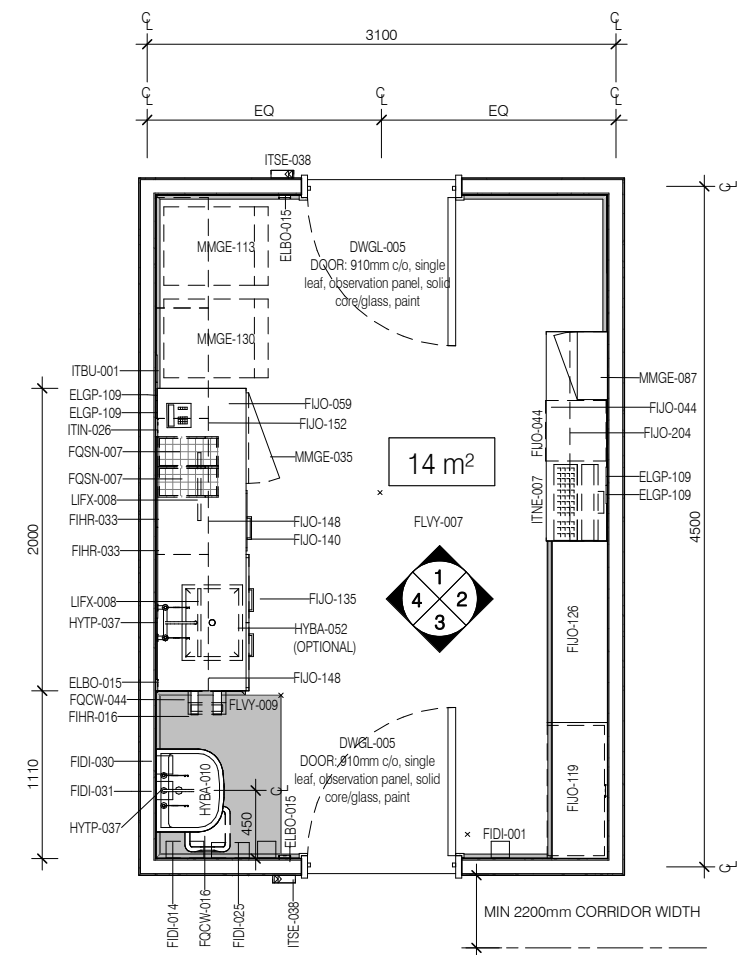
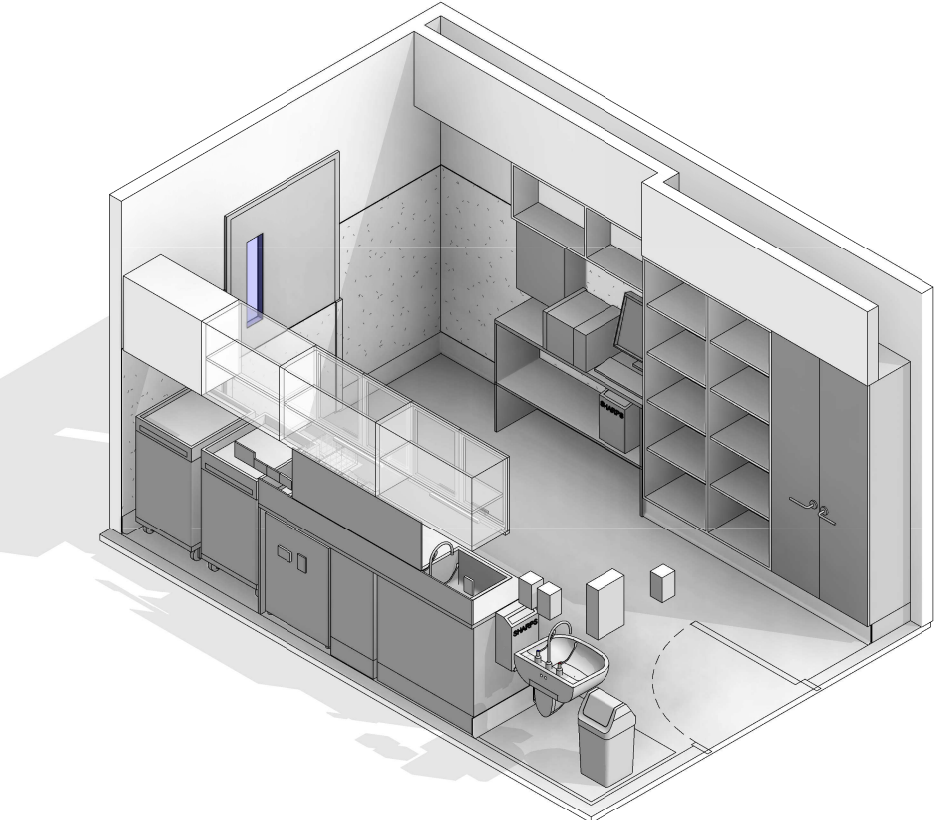

PLAN

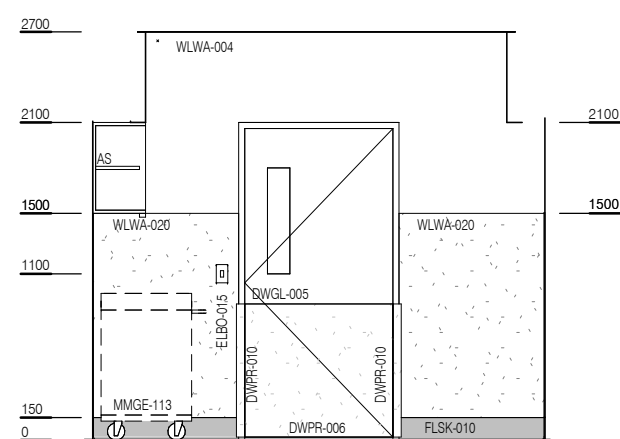

ELEVATION 1

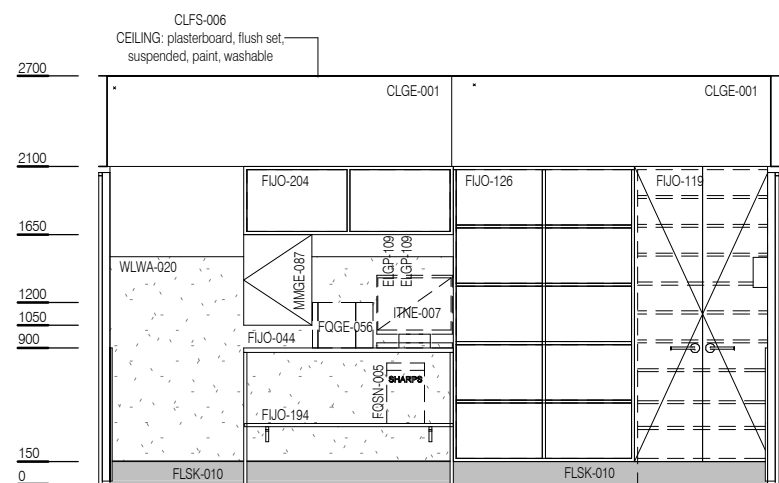

ELEVATION 2

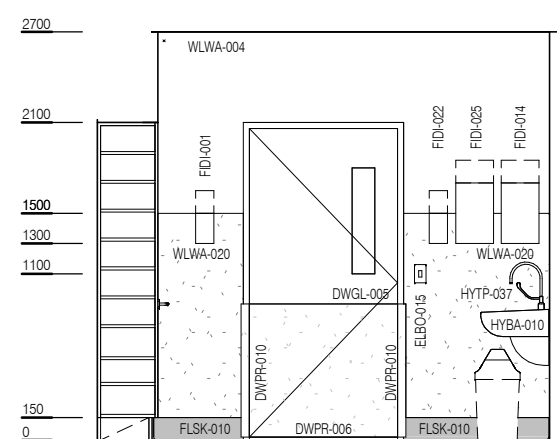

ELEVATION 3

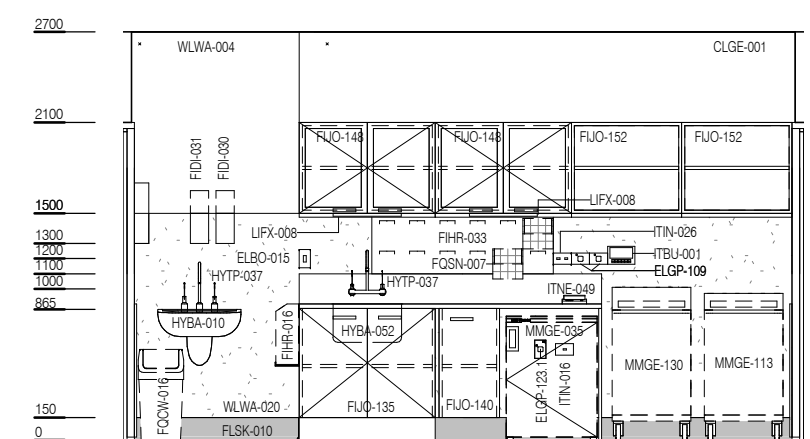

ELEVATION 4

NOTE: FF-19062 - SUPPORTED BY STRUCTURAL SHS POST ON EITHER SIDE, CONCEALED WITHIN STUD WALL, 150mm ABOVE BENCH, TO STRUCTURAL ENGINEERS DESIGN



REV	DESCRIPTION	DATE
6	Coding and naming updated	20.03.2017

FOR GUIDANCE

SCALE	RLS Room Code	REV
1 : 50 @ A3	CLUR-14	6