

AUSTRALASIAN HFG STANDARD COMPONENTS

Room Layout Sheet

RLS Room Code: **CTCR**

Room Name:

1:50 2.5m 2 1.5 1 0.5 0
CT IMAGING CONTROL ROOM

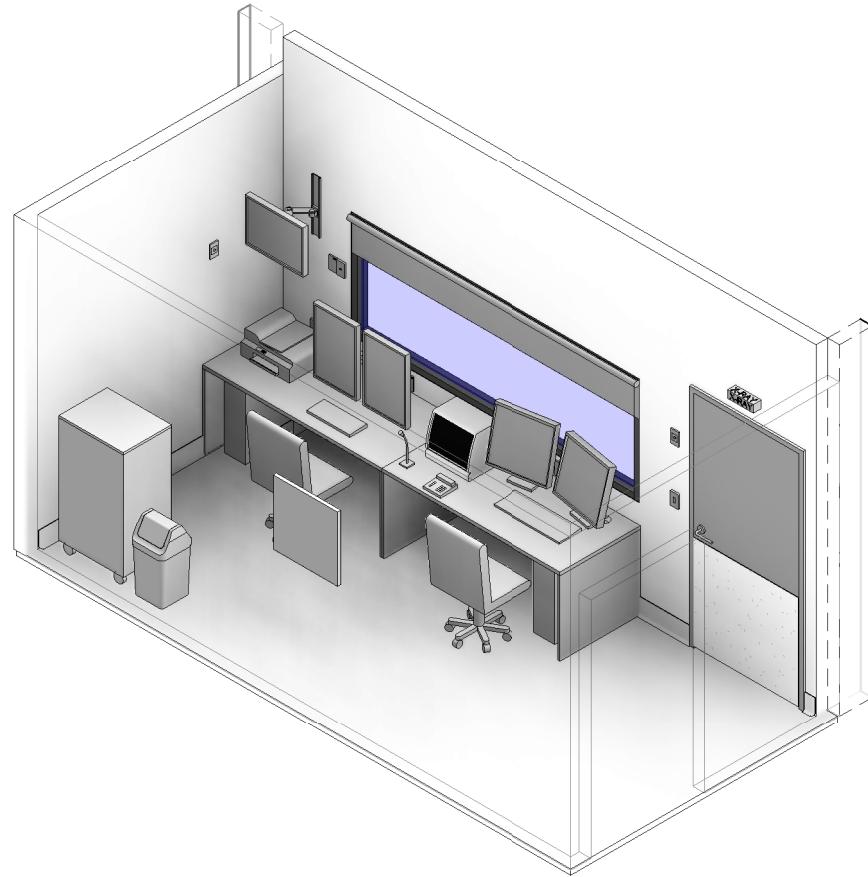

CODE	DESCRIPTION
DWOB-009	OBSERVATION: internal window, lead glass, clear
DWPR-005	DOOR PROTECTION: protection plate to 900 AFFL
DWWD-004	BLIND: roller
ELBO-001	BUTTON: emergency stop
ELBO-012	SWITCH: light, dimmer
ELGP-110	GPO: single, wall mounted, cleaner
ELGP-123.1	GPO: emergency power, single, wall mounted (V)
ELGP-135	GPO: UPS, single, wall mounted
ELGP-208	GPO: double, wall mounted
ELGP-208.1	GPO: double, wall mounted (V)
ELGP-223.1	GPO: emergency power, double, wall mounted (V)
FIBM-019	WHITEBOARD: fixed, magnetic
FIDI-001	DISPENSER: alcohol based hand rub
FIHR-044	RACK: lead apron
FIHR-066	BRACKET: for display screen, wall mounted, articulated, adj height
FIHR-070	BRACKET: for display screen, dual, desk mounted
FIHR-075	BRACKET: for computer CPU, underdesk mounted
FUJO-031	BENCH: 750D, open under, laminate finish
FUJO-099	CAC: cable access cap
FLSK-010	SKIRTING: vinyl, floor vinyl coved, 150H, prefinished
FLVY-007	FLOOR FINISH: vinyl, seamless, coved, standard slip resistant
FOBS-018	CHAIR: office, ergonomic
FQCW-016	BIN: waste, general, 20L
FOSN-031	CABINET: short, single door, tambour, adj shelves, lockable
ITAV-014	MICROPHONE: surface mounted, gooseneck
ITCL-004	BUTTON: nurse call, emergency
ITIN-016	OUTLET: data, single RJ45, wall mounted
ITIN-026	OUTLET: data, double RJ45, wall mounted
ITNE-023	PRINTER: networked
ITNE-049	TELEPHONE: handset, desktop
ITNE-067	KEYBOARD: keyboard and mouse only
ITNE-068	COMPUTER: hi performance, for clinical / PACS use, CPU, underbench mount
ITNE-069	DISPLAY SCREEN: PACS, portrait
LIFX-002	LIGHT: illuminated sign, "X-Ray in Use"
MMGE-032	DISPLAY SCREEN: slave, for patient monitor
MMMI-095	COMPUTER: tower, ICS, CT
MMMI-097	CONTROL UNIT: c/w display, control box and keyboard, CT
MMMI-369	DISPLAY SCREEN: contrast injector
WLWA-004	WALL FINISH: paint, acrylic, washable

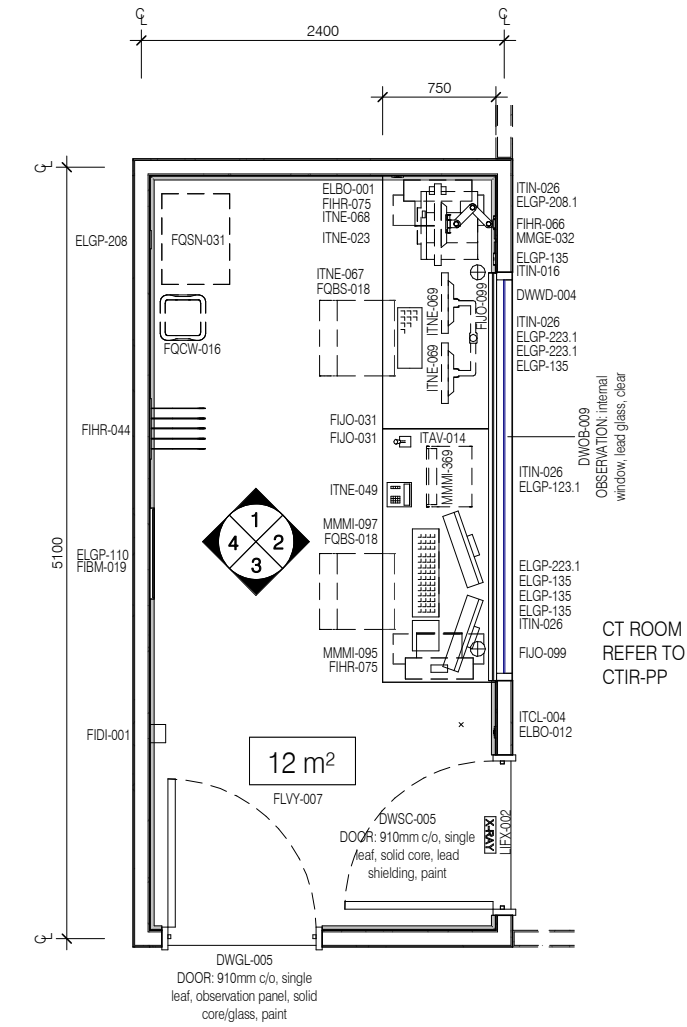

PLAN

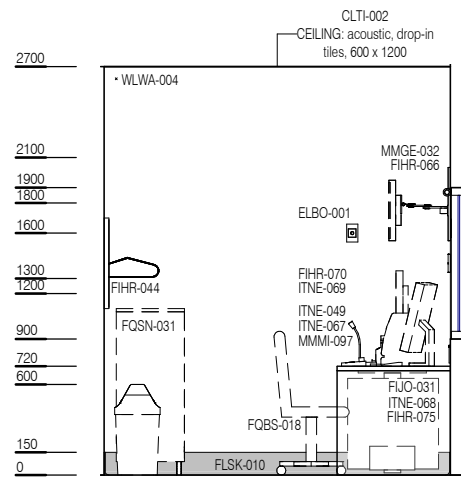

ELEVATION 1

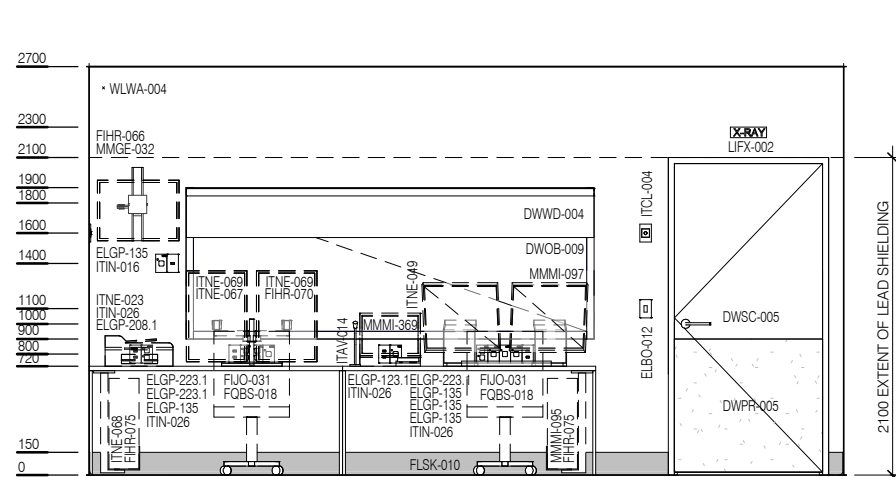

ELEVATION 2

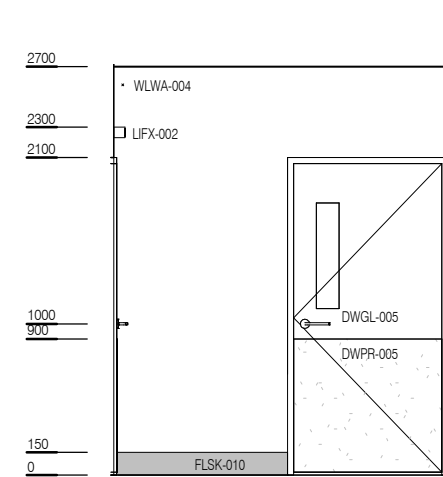

ELEVATION 3

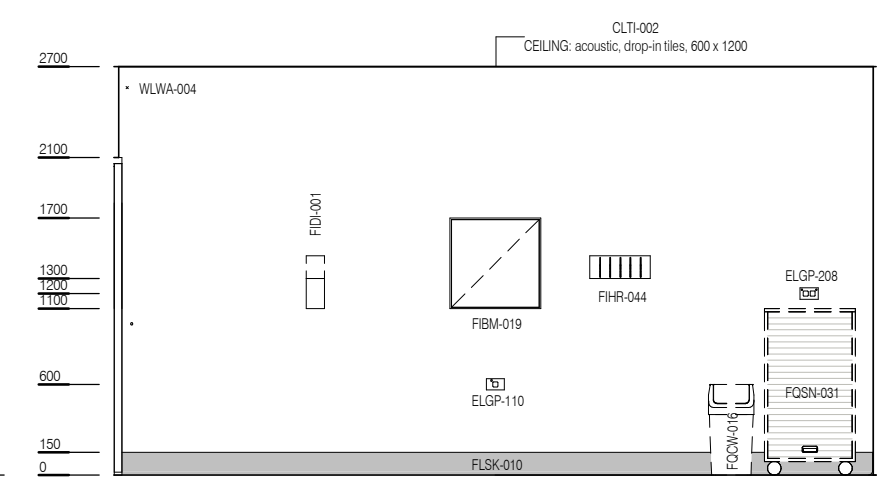

ELEVATION 4