

AUSTRALASIAN HFG STANDARD COMPONENTS

Room Layout Sheet

RLS Room Code: **CTPR**



Room Name:

CT PLANNING ROOM

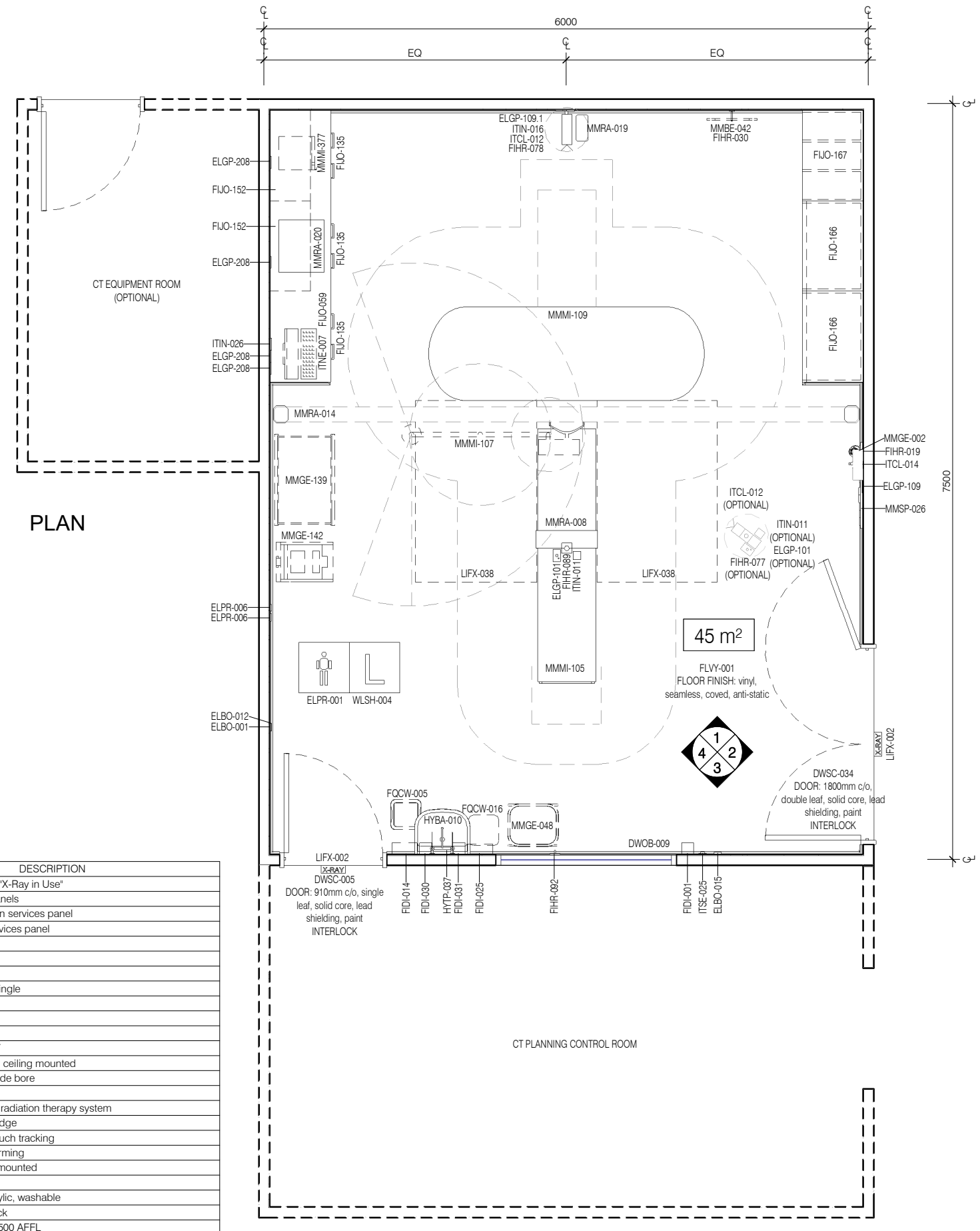
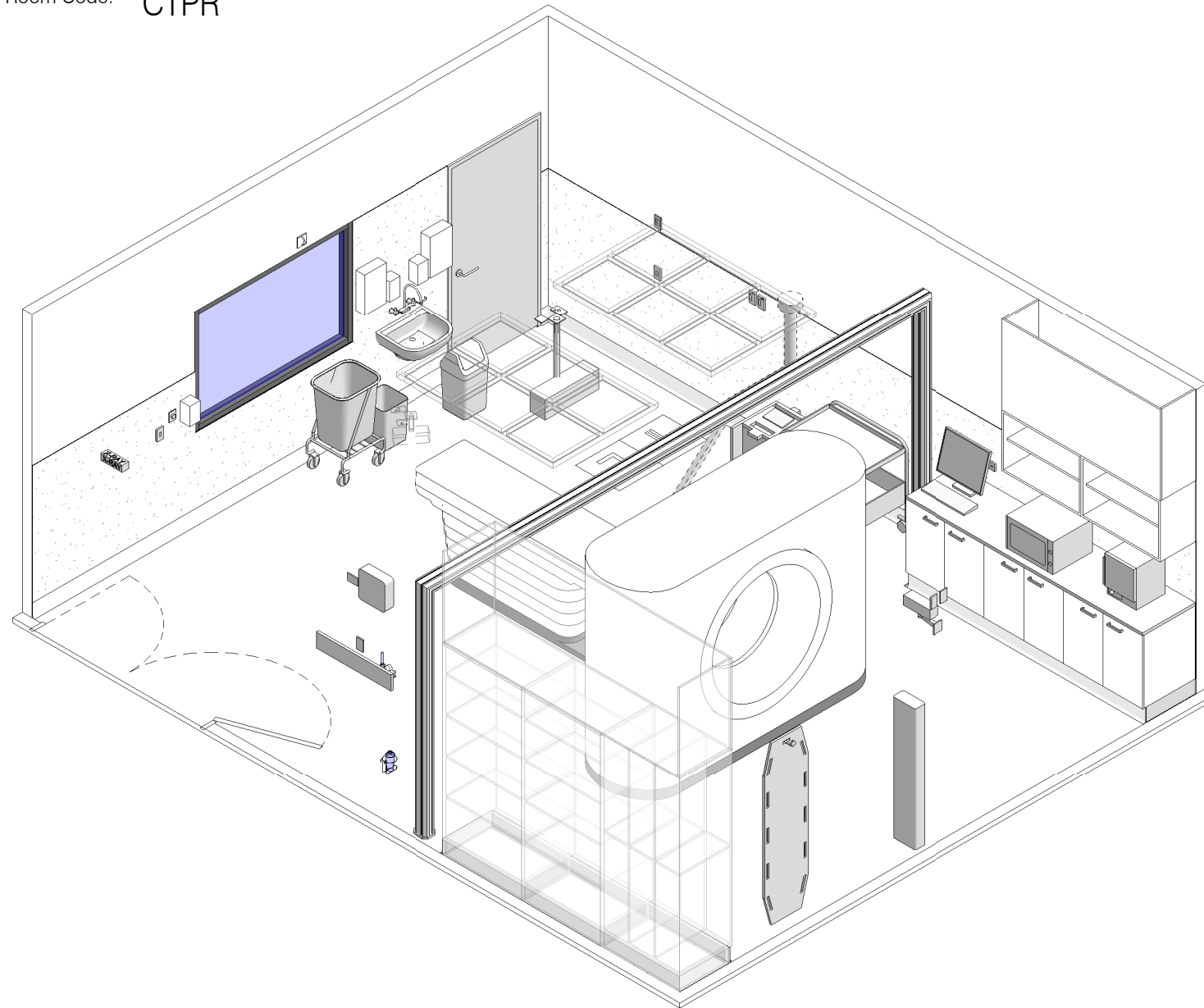

CODE	DESCRIPTION
DWOB-009	OBSERVATION: internal window, lead glass, clear
DWPR-005	DOOR PROTECTION: protection plate to 900 AFFL
ELBO-001	BUTTON: emergency stop
ELBO-012	SWITCH: light, dimmer
ELBO-015	SWITCH: light, single
ELGP-101	GPO: single, ceiling mounted
ELGP-109	GPO: single, wall mounted
ELGP-109.1	GPO: single, wall mounted (V)
ELGP-122	GPO: emergency power, single, on services panel
ELGP-208	GPO: double, wall mounted
ELPR-001	BODY PROTECTED ELECTRICAL AREA
ELPR-006	RCD: residual current device
FIDI-001	DISPENSER: alcohol based hand rub
FIDI-014	DISPENSER: disposable glove
FIDI-025	DISPENSER: paper/hand towel
FIDI-030	DISPENSER: soap
FIDI-031	DISPENSER: soap antiseptic
FIHR-019	BRACKET: for suction bottle
FIHR-030	HOOK: equipment, on mounting plate
FIHR-077	BRACKET: for observation camera, ceiling mounted
FIHR-078	BRACKET: for observation camera, wall mounted
FIHR-089	BRACKET: surface guided radiation therapy system, ceiling mounted
FIHR-092	HOOK: anchor, patient ladder

CODE	DESCRIPTION
FIJO-059	BENCH TOP: 600D, joinery under, laminate finish
FIJO-135	CUPBOARD: underbench, double door, adj shelves
FIJO-152	CUPBOARD: wall mount, shelf unit, adj shelves
FIJO-166	CUPBOARD: tall, shelving, horizontal patient device storage, radiotherapy
FIJO-167	CUPBOARD: tall, shelving, vertical patient device storage, radiotherapy
FIJO-212	BULKHEAD: joinery
FLSK-010	SKIRTING: vinyl, floor vinyl coved, 150H, prefinished
FLVY-001	FLOOR FINISH: vinyl, seamless, coved, anti-static
FOCW-005	BIN: waste, clinical, 20L
FOCW-016	BIN: waste, general, 20L
HYBA-010	BASIN: handwash, Type B
HYTP-037	TAPWARE: mixer, elbow levers
ITCL-004	BUTTON: nurse call, emergency
ITCL-008	BUTTON: nurse call, staff assist
ITCL-012	CAMERA: observation
ITCL-014	CLOCK: analogue, electric
ITIN-011	OUTLET: data, single RJ45, ceiling mounted
ITIN-016	OUTLET: data, single RJ45, wall mounted
ITIN-025	OUTLET: data, double RJ45, on services panel
ITIN-026	OUTLET: data, double RJ45, wall mounted
ITNE-007	COMPUTER: desktop, with display screen
ITSE-025	DOOR RELEASE: access control, remote activation

CODE	DESCRIPTION
LIFX-002	LIGHT: illuminated sign, "X-Ray in Use"
LIFX-038	LIGHT: backlight feature panels
MGAS-042	OUTLET: oxygen (O2), on services panel
MGAS-062	OUTLET: suction, on services panel
MGFP-004	FLOWMETER: oxygen
MMBE-042	SLIDE: patient
MMGE-002	ADAPTER: suction
MMGE-048	LINER CARRIER: dirty, single
MMGE-100	SUCTION BOTTLE
MMGE-139	TROLLEY: procedure
MMGE-142	TROLLEY: sharps bin
MMMI-105	TABLE: patient, fixed, CT
MMMI-107	INJECTOR: contrast, CT, ceiling mounted
MMMI-109	DEVICE: imaging, CT, wide bore
MMMI-377	WARMER: contrast
MMRA-008	DEVICE: surface guided radiation therapy system
MMRA-014	LASER: radiotherapy, bridge
MMRA-019	LASER: radiotherapy, couch tracking
MMRA-020	OVEN: thermoplastic warming
MMSP-026	SERVICES PANEL: wall mounted
WLSH-004	SHIELDING: lead lining
WLWA-004	WALL FINISH: paint, acrylic, washable
WLWA-007	WALL FINISH: splashback
WLWA-020	WALL FINISH: vinyl, to 1500 AFFL



REV	DESCRIPTION	DATE
1	First Issue	28.06.2021

FOR GUIDANCE

SCALE	RLS Room Code	REV
1 : 50 @ A3	CTPR	1

AUSTRALASIAN HFG STANDARD COMPONENTS

Room Layout Sheet

RLS Room Code: **CTPR**



Room Name:

CT PLANNING ROOM

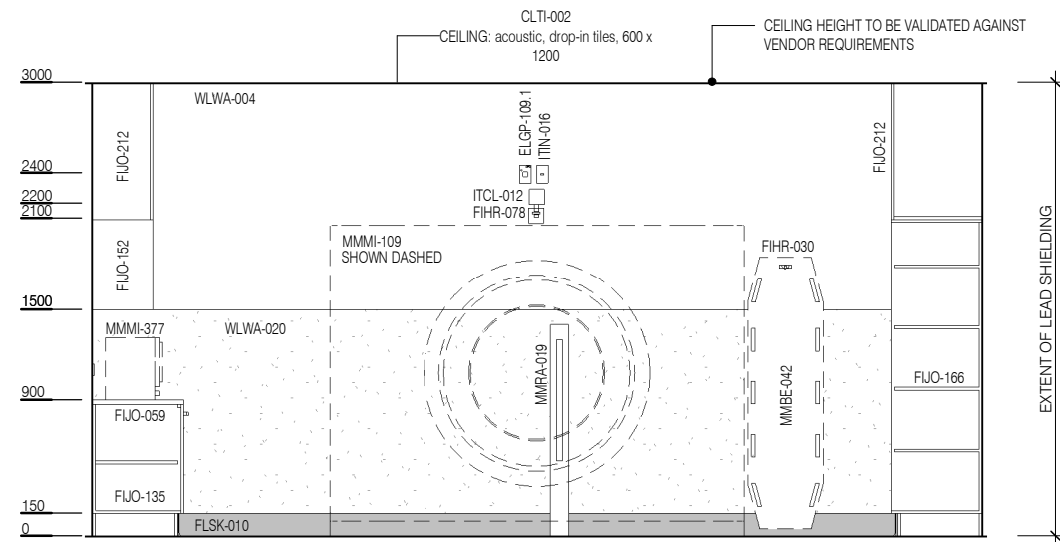

ELEVATION 1

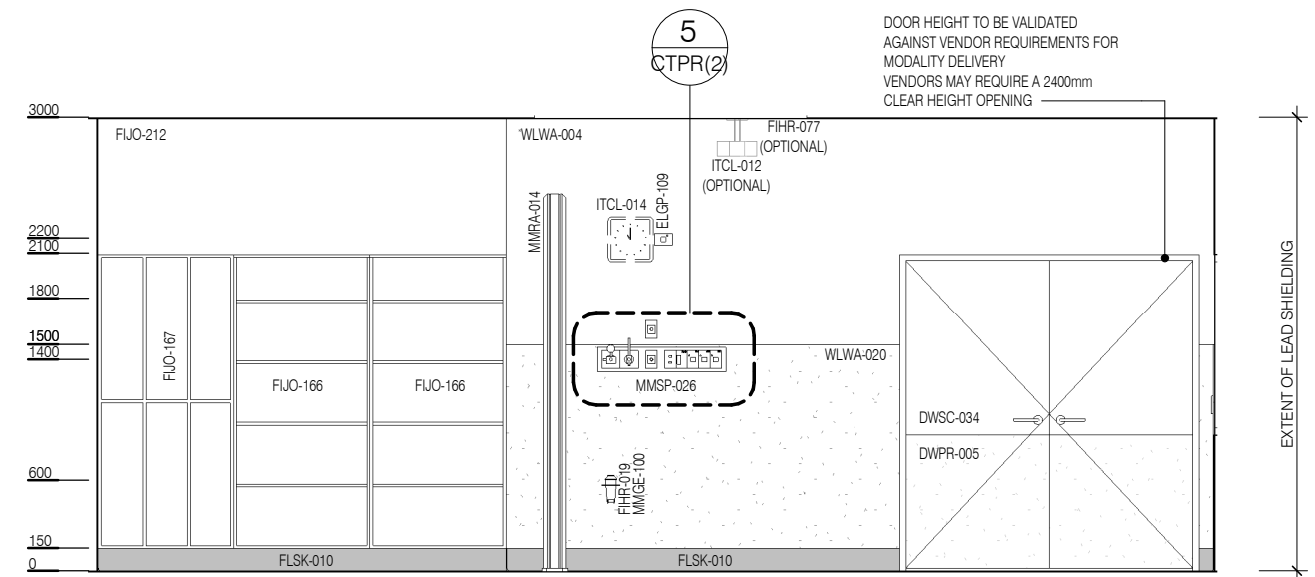

ELEVATION 2

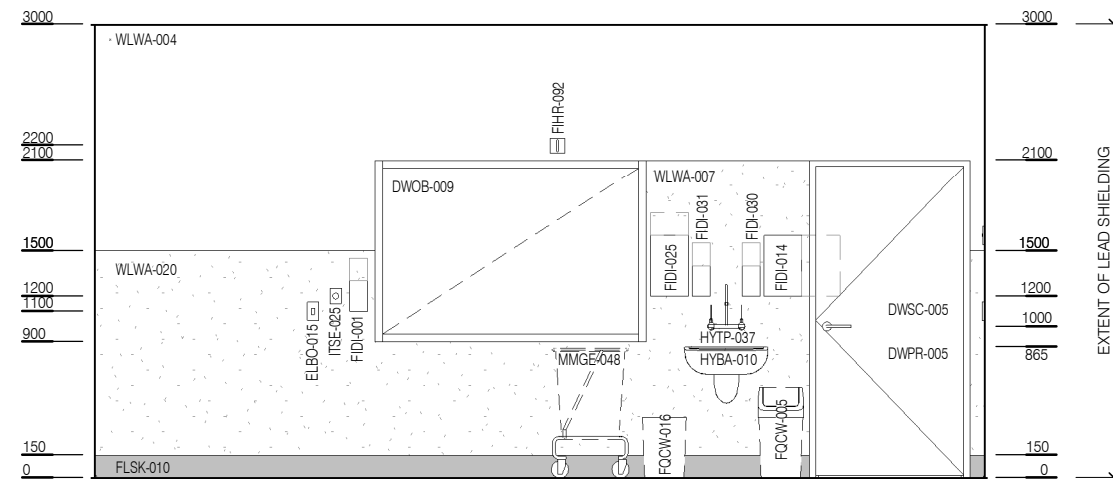

ELEVATION 3

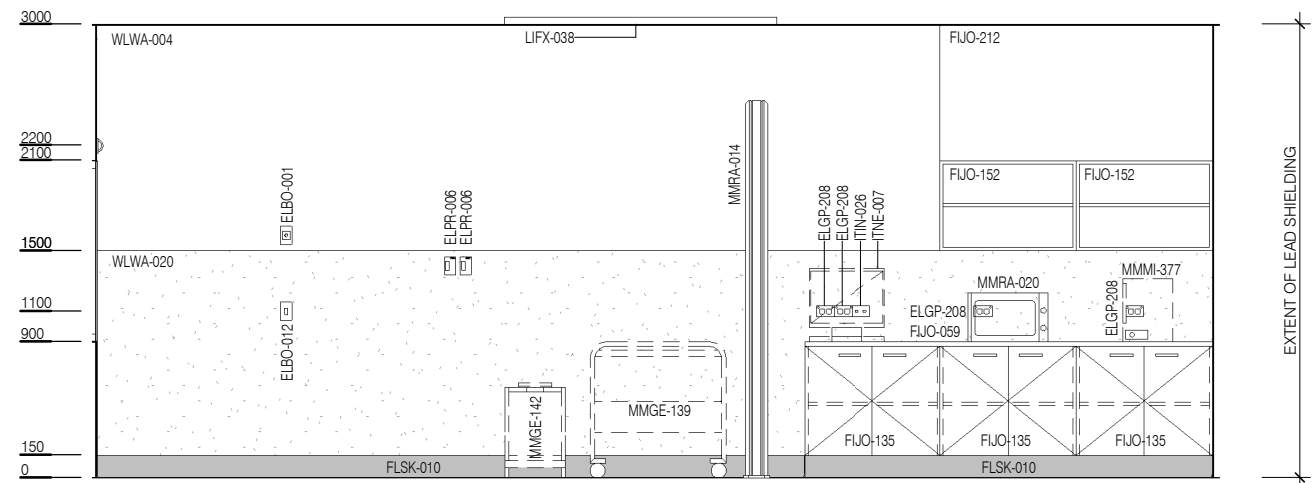

ELEVATION 4

CODE	DESCRIPTION
DWOB-009	OBSERVATION: internal window, lead glass, clear
DWPR-005	DOOR PROTECTION: protection plate to 900 AFFL
ELBO-001	BUTTON: emergency stop
ELBO-012	SWITCH: light, dimmer
ELBO-015	SWITCH: light, single
ELGP-101	GPO: single, ceiling mounted
ELGP-109	GPO: single, wall mounted
ELGP-109.1	GPO: single, wall mounted (V)
ELGP-122	GPO: emergency power, single, on services panel
ELGP-208	GPO: double, wall mounted
ELPR-001	BODY PROTECTED ELECTRICAL AREA
ELPR-006	RCD: residual current device
FIDI-001	DISPENSER: alcohol based hand rub
FIDI-014	DISPENSER: disposable glove
FIDI-025	DISPENSER: paper/hand towel
FIDI-030	DISPENSER: soap
FIDI-031	DISPENSER: soap antiseptic
FIHR-019	BRACKET: for suction bottle
FIHR-030	HOOK: equipment, on mounting plate
FIHR-077	BRACKET: for observation camera, ceiling mounted
FIHR-078	BRACKET: for observation camera, wall mounted
FIHR-089	BRACKET: surface guided radiation therapy system, ceiling mounted
FIHR-092	HOOK: anchor, patient ladder

CODE	DESCRIPTION
FIJO-059	BENCH TOP: 600D, joinery under, laminate finish
FIJO-135	CUPBOARD: underbench, double door, adj shelves
FIJO-152	CUPBOARD: wall mount, shelf unit, adj shelves
FIJO-166	CUPBOARD: tall, shelving, horizontal patient device storage, radiotherapy
FIJO-167	CUPBOARD: tall, shelving, vertical patient device storage, radiotherapy
FIJO-212	BULKHEAD: joinery
FLSK-010	SKIRTING: vinyl, floor vinyl coved, 150H, prefinished
FLVY-001	FLOOR FINISH: vinyl, seamless, coved, anti-static
FQCW-005	BIN: waste, clinical, 20L
FQCW-016	BIN: waste, general, 20L
HYBA-010	BASIN: handwash, Type B
HYTP-037	TAPWARE: mixer, elbow levers
ITCL-004	BUTTON: nurse call, emergency
ITCL-008	BUTTON: nurse call, staff assist
ITCL-012	CAMERA: observation
ITCL-014	CLOCK: analogue, electric
ITIN-011	OUTLET: data, single RJ45, ceiling mounted
ITIN-016	OUTLET: data, single RJ45, wall mounted
ITIN-025	OUTLET: data, double RJ45, on services panel
ITIN-026	OUTLET: data, double RJ45, wall mounted
ITNE-007	COMPUTER: desktop, with display screen
ITSE-025	DOOR RELEASE: access control, remote activation

CODE	DESCRIPTION
LIFX-002	LIGHT: illuminated sign, "X-Ray in Use"
LIFX-038	LIGHT: backlit feature panels
MGAS-042	OUTLET: oxygen (O2), on services panel
MGAS-062	OUTLET: suction, on services panel
MGFP-004	FLOWMETER: oxygen
MMBE-042	SLIDE: patient
MMGE-002	ADAPTER: suction
MMGE-048	LINEN CARRIER: dirty, single
MMGE-100	SUCTION BOTTLE
MMGE-139	TROLLEY: procedure
MMGE-142	TROLLEY: sharps bin
MMMI-105	TABLE: patient, fixed, CT
MMMI-107	INJECTOR: contrast, CT, ceiling mounted
MMMI-109	DEVICE: imaging, CT, wide bore
MMMI-377	WARMER: contrast
MMRA-008	DEVICE: surface guided radiation therapy system
MMRA-014	LASER: radiotherapy, bridge
MMRA-019	LASER: radiotherapy, couch tracking
MMRA-020	OVEN: thermoplastic warming
MMSP-026	SERVICES PANEL: wall mounted
WLSH-004	SHIELDING: lead lining
WLWA-004	WALL FINISH: paint, acrylic, washable
WLWA-007	WALL FINISH: splashback
WLWA-020	WALL FINISH: vinyl, to 1500 AFFL

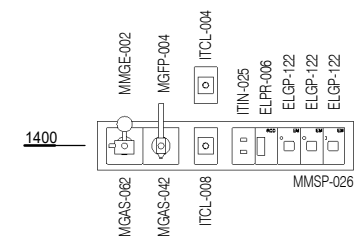

ELEVATION 5 (1 : 25 @ A3)



REV	DESCRIPTION	DATE
1	First Issue	28.06.2021

FOR GUIDANCE

SCALE	RLS Room Code	REV
1 : 50 @ A3	CTPR	1