

# AUSTRALASIAN HFG STANDARD COMPONENTS

Room Layout Sheet

RLS Room Code: **DENSR-14**

1:50 2.5m 2 1.5 1 0.5 0

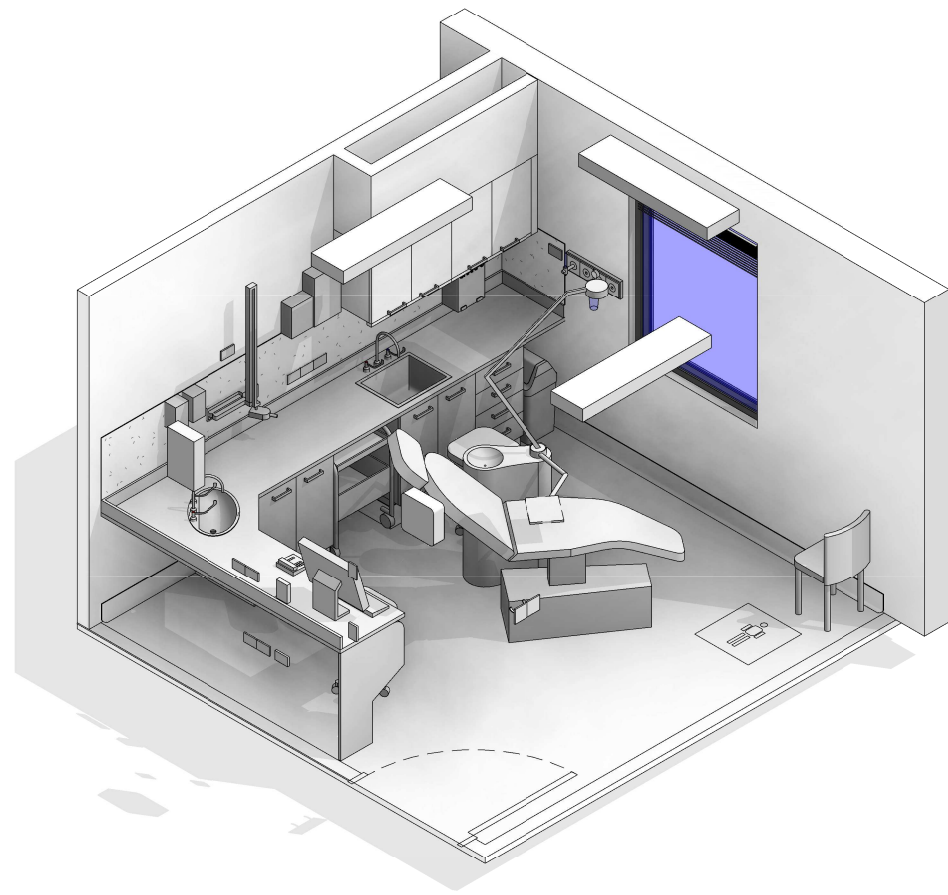

| CODE     | DESCRIPTION  |
|----------|--|
| CAC      | Cable access cap   |
| CLGE-001 | CEILING: plasterboard, bulkhead, paint                           |
| DWPR-006 | DOOR PROTECTION: protection plate, to 900 AFFL, PVC, prefinished |
| DWPR-010 | DOOR PROTECTION: to door frame, PVC, prefinished                 |
| DWWD-006 | BLIND: venetian  |
| DWWH-005 | WINDOW   |
| ELBO-015 | SWITCH: light, single  |
| ELGP-107 | GPO: single, special, for equipment, floor mounted               |
| ELGP-109 | GPO: single, wall mounted  |
| ELGP-110 | GPO: single, wall mounted, cleaner                               |
| ELGP-208 | GPO: double, wall mounted  |
| ELPR-001 | BODY PROTECTED ELECTRICAL AREA                                   |
| FIBM-018 | WHITEBOARD: fixed  |
| FIDI-014 | DISPENSER: disposable glove                                      |
| FIDI-021 | DISPENSER: mask  |
| FIDI-025 | DISPENSER: paper/hand towel                                      |
| FIDI-030 | DISPENSER: soap  |
| FIDI-031 | DISPENSER: soap antiseptic                                       |
| FIHR-016 | BRACKET: for sharps bin  |
| FIHR-019 | BRACKET: for suction bottle                                      |
| FIHR-031 | HOOK: heavy duty   |
| FUO-102  | CUPBOARD: drawer unit  |
| FUO-135  | CUPBOARD: underbench, double door, adj shelves                   |
| FUO-145  | CUPBOARD: wall mount, double door, adj shelves, lockable         |
| FUO-157  | CUPBOARD: wall mount, single door, adj shelves, lockable         |
| FUO-203  | BENCH TOP: 600D, joinery under, laminate finish, corner unit     |
| FLSK-010 | SKIRTING: vinyl, floor vinyl coved, 150H, prefinished            |
| FLVY-007 | FLOOR FINISH: vinyl, seamless, coved, standard slip resistant    |
| FOBS-028 | CHAIR: visitor, clinical areas                                   |
| FOBS-051 | STOOL: mobile, adj height  |
| FOCW-016 | BIN: waste, general, 20L   |
| FOCW-044 | BIN: waste, sharps, wall mounted                                 |
| FOQE-005 | CLOCK: analogue, battery operated                                |
| HYBA-013 | BASIN: vanity  |
| HYBA-051 | SINK: single   |
| HYTP-037 | TAPWARE: mixer, elbow levers                                     |
| ITCL-004 | BUTTON: nurse call, emergency                                    |
| ITIN-026 | OUTLET: data, double RJ45, wall mounted                          |
| ITNE-007 | COMPUTER: desktop, with display screen                           |
| ITNE-049 | TELEPHONE: handset, desktop                                      |
| ITSE-029 | INTERCOM: audio, wall mount                                      |
| LIFX-008 | LIGHT: task light, built in                                      |
| LIFX-023 | LIGHT: fluorescent light, recessed and sealed                    |
| MGAS-032 | OUTLET: nitrous oxide (N2O), on services panel                   |
| MGAS-042 | OUTLET: oxygen (O2), on services panel                           |
| MGAS-053 | OUTLET: scavenge, on services panel                              |
| MGAS-062 | OUTLET: suction, on services panel                               |
| MGFP-004 | FLOWMETER: oxygen  |
| MMDN-002 | CHAIR: dental, electric  |
| MMDN-015 | SERVICE UNIT: dental, chair (spittoon)                           |
| MMDN-016 | TROLLEY: dental  |
| MMDN-018 | X-RAY UNIT: dental, wall mounted                                 |
| MMDN-019 | LIGHT: dental  |
| MMGE-002 | ADAPTER: suction   |
| MMGE-100 | SUCTION BOTTLE   |
| MMGE-150 | VIEWER: X-ray, 1 screen  |
| MMSP-026 | SERVICES PANEL: wall mounted                                     |
| WLPT-003 | PARTITION: laminate  |
| WLWA-004 | WALL FINISH: paint, acrylic, washable                            |
| WLWA-010 | WALL FINISH: splashback, vinyl                                   |

Room Name:

**DENTAL SURGERY, 14m<sup>2</sup>**

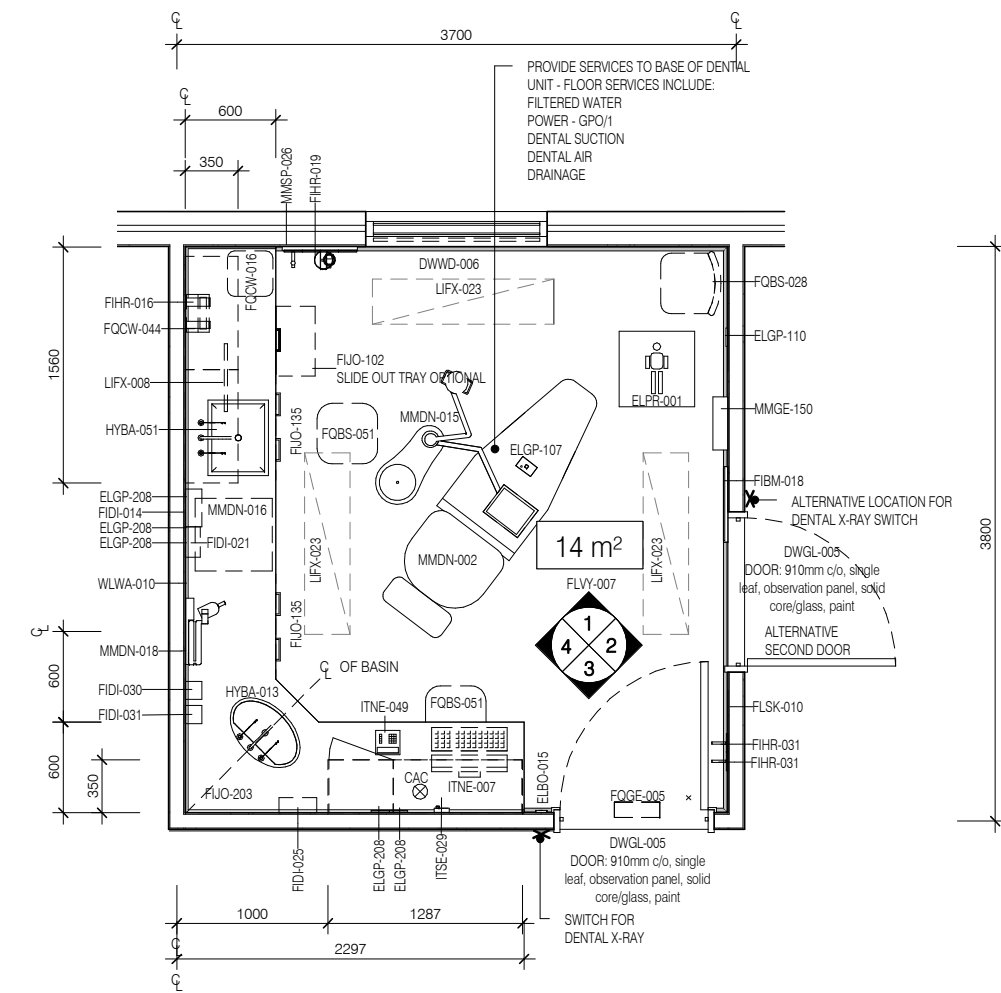

PLAN

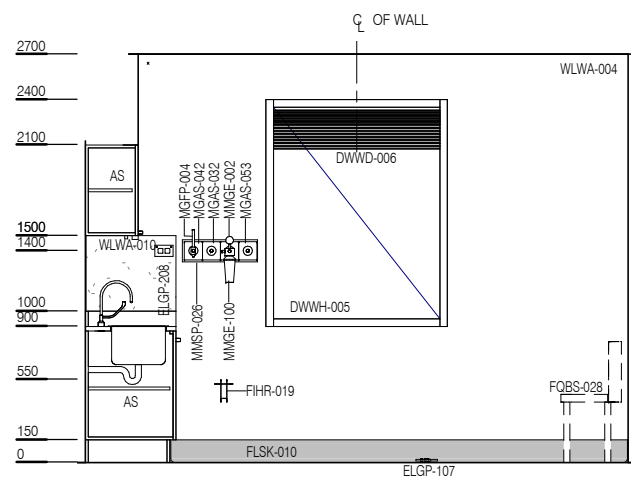

ELEVATION 1

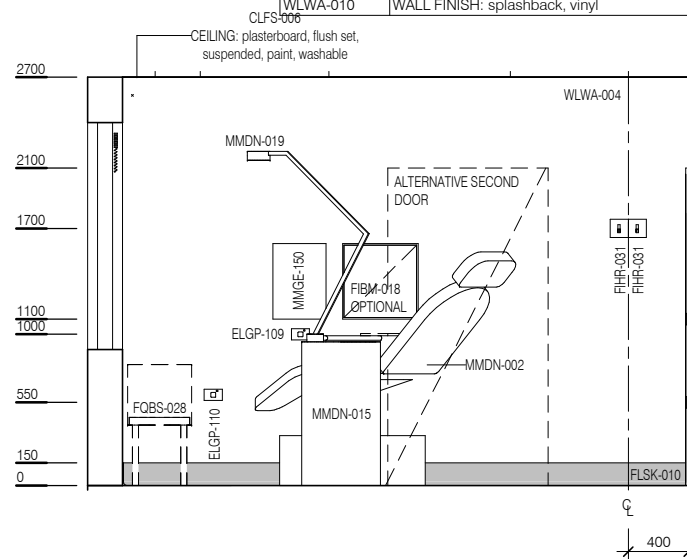

ELEVATION 2

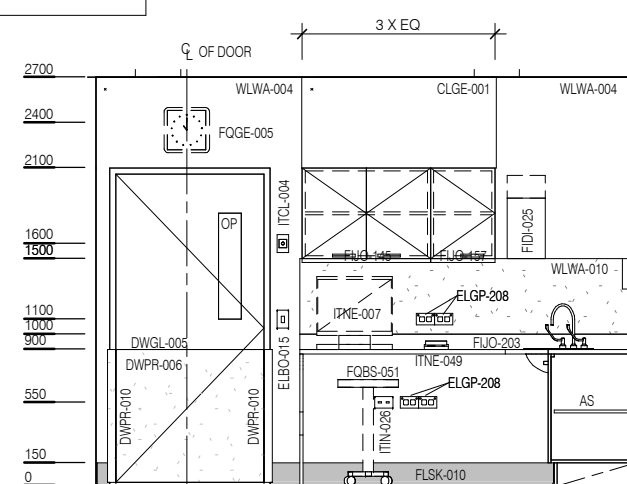

ELEVATION 3

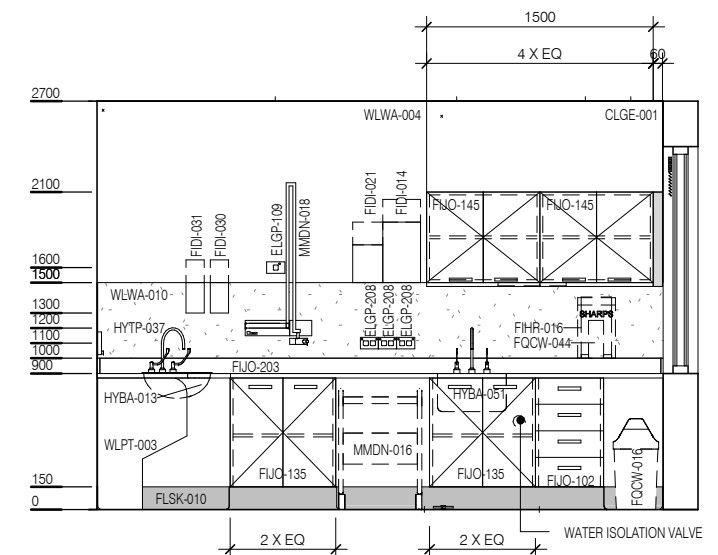

ELEVATION 4



| REV | DESCRIPTION               | DATE       |
|-----|---------------------------|------------|
| 4   | Coding and naming updated | 20.03.2017 |

FOR GUIDANCE

| SCALE       | RLS Room Code | REV |
|-------------|---------------|-----|
| 1 : 50 @ A3 | DENSR-14      | 4   |