

# AUSTRALASIAN HFG STANDARD COMPONENTS

Room Layout Sheet

RLS Room Code: **DENSR-14**

1:50 2.5m 2 1.5 1 0.5 0

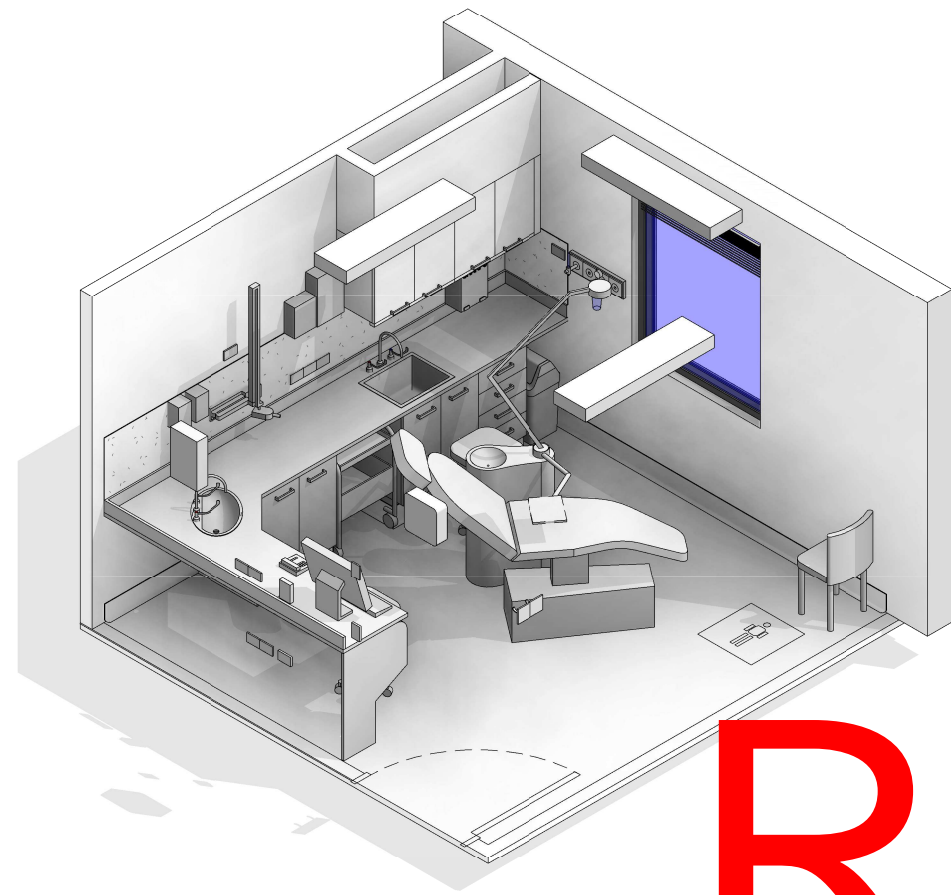

CODE	DESCRIPTION
CAC	Cable access cap
CLGE-001	CEILING: plasterboard, bulkhead, paint
DWPR-006	DOOR PROTECTION: protection plate, to 900 AFFL, PVC, prefinished
DWPR-010	DOOR PROTECTION: to door frame, PVC, prefinished
DWWD-006	BLIND: venetian
DWWH-005	WINDOW
ELBO-015	SWITCH: light, single
ELGP-107	GPO: single, special, for equipment, floor mounted
ELGP-109	GPO: single, wall mounted
ELGP-110	GPO: single, wall mounted, cleaner
ELGP-208	GPO: double, wall mounted
ELPR-001	BODY PROTECTED ELECTRICAL AREA
FIBM-018	WHITEBOARD: fixed
FIDI-014	DISPENSER: disposable glove
FIDI-021	DISPENSER: mask
FIDI-025	DISPENSER: paper/hand towel
FIDI-030	DISPENSER: soap
FIDI-031	DISPENSER: soap antiseptic
FIHR-016	BRACKET: for sharps bin
FIHR-019	BRACKET: for suction bottle
FIHR-031	HOOK: heavy duty
FUO-102	CUPBOARD: drawer unit
FUO-135	CUPBOARD: underbench, double door, adj shelves
FUO-145	CUPBOARD: wall mount, double door, adj shelves, lockable
FUO-157	CUPBOARD: wall mount, single door, adj shelves, lockable
FUO-203	BENCH TOP: 600D, joinery under, laminate finish, corner unit
FLSK-010	SKIRTING: vinyl, floor vinyl coved, 150H, prefinished
FLVY-007	FLOOR FINISH: vinyl, seamless, coved, standard slip resistant
FOBS-028	CHAIR: visitor, clinical areas
FOBS-051	STOOL: mobile, adj height
FOCW-016	BIN: waste, general, 20L
FOCW-044	BIN: waste, sharps, wall mounted
FOQE-005	CLOCK: analogue, battery operated
HYBA-013	BASIN: vanity
HYBA-051	SINK: single
HYTP-037	TAPWARE: mixer, elbow levers
ITCL-004	BUTTON: nurse call, emergency
ITIN-026	OUTLET: data, double RJ45, wall mounted
ITNE-049	TELEPHONE: handset, desk
ITNE-077	INTERCOM: audio, wall mounted
ITSE-009	LIGHT: task light, built in
ITSE-023	LIGHT: fluorescent light, recessed and sealed
ITSE-026	OUTLET: nitrous oxide (N2O), on services panel
ITSE-042	OUTLET: oxygen (O2), on services panel
ITSE-053	OUTLET: scavenge, on services panel
ITSE-062	OUTLET: suction, on services panel
ITSE-064	FLOWMETER: oxygen
MMDN-002	CHAIR: dental, electric
MMDN-002	UNIT: dental, chair (cotton)
MMDN-016	TROLLEY: dental
MMDN-018	X-RAY UNIT: dental, wall mounted
MMDN-019	LIGHT: dental
MMGE-002	ADAPTER: suction
MMGE-100	SUCTION BOTTLE
MMGE-150	VIEWER: X-ray, 1 screen
MMSP-026	SERVICES PANEL: wall mounted
WLPT-003	PARTITION: laminate
WLWA-004	WALL FINISH: paint, acrylic, washable
WLWA-010	WALL FINISH: splashback, vinyl

Room Name:

**DENTAL SURGERY, 14m<sup>2</sup>**

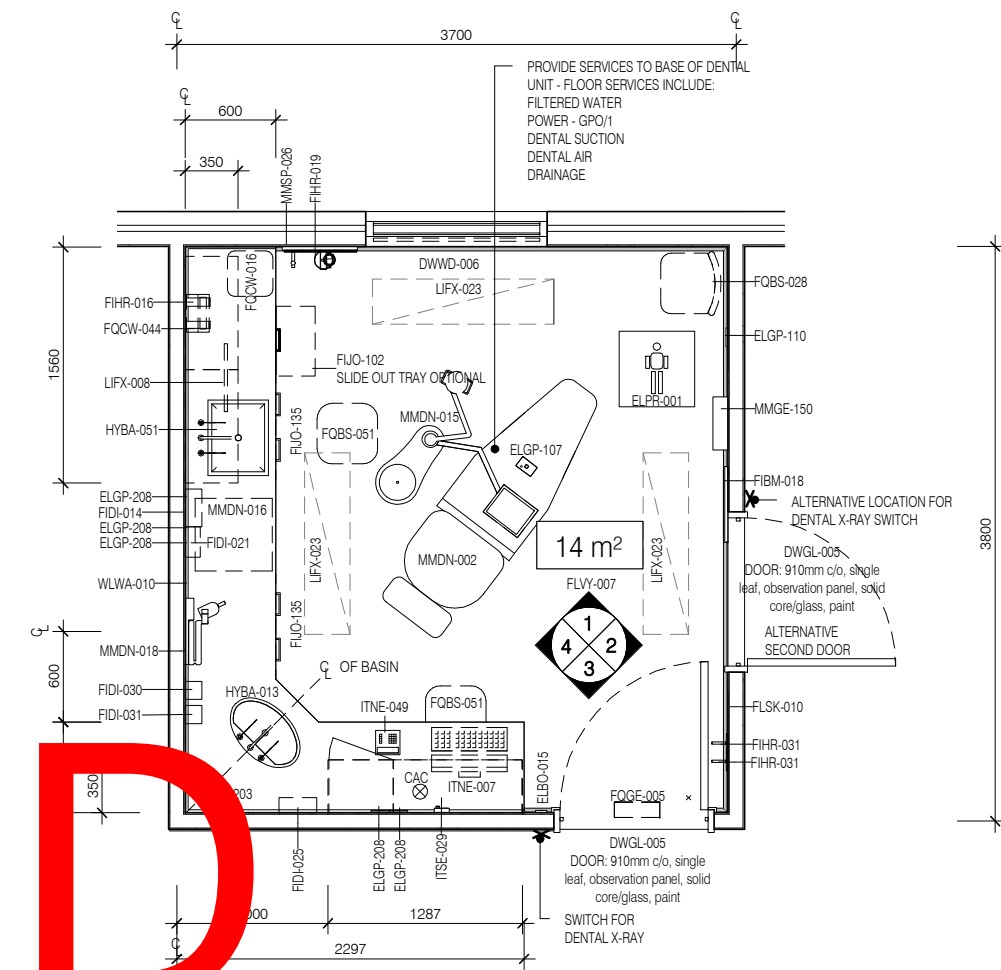

PLAN

# RETIRED

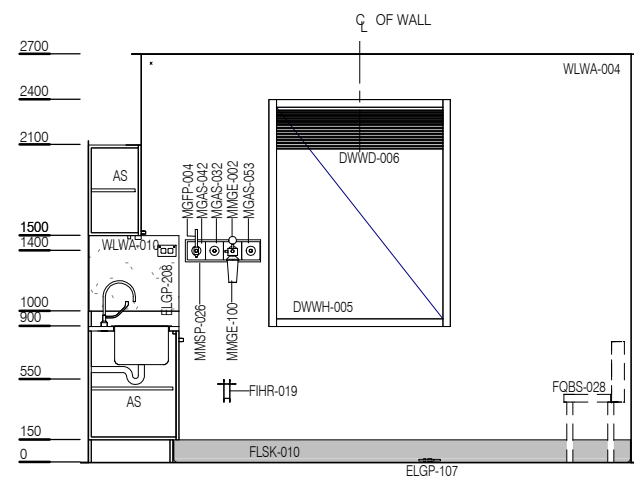

ELEVATION 1

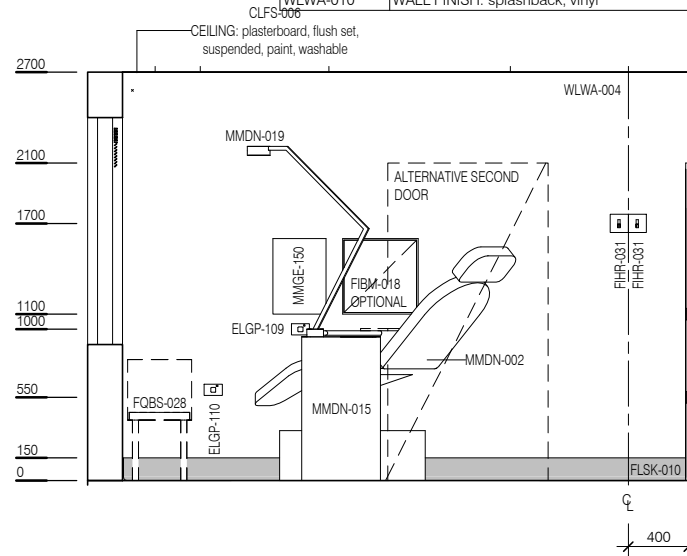

ELEVATION 2

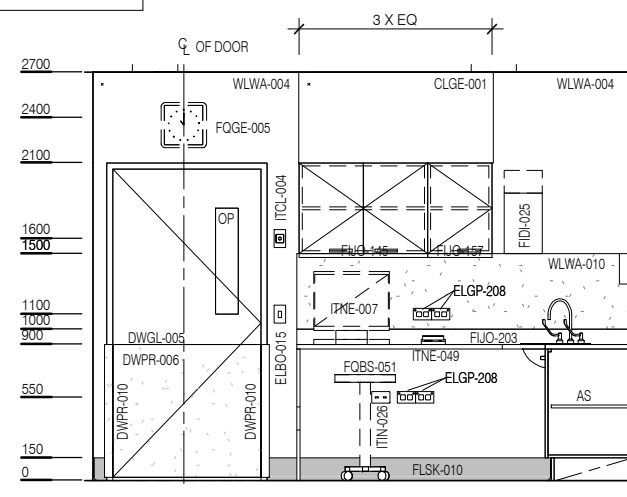

ELEVATION 3

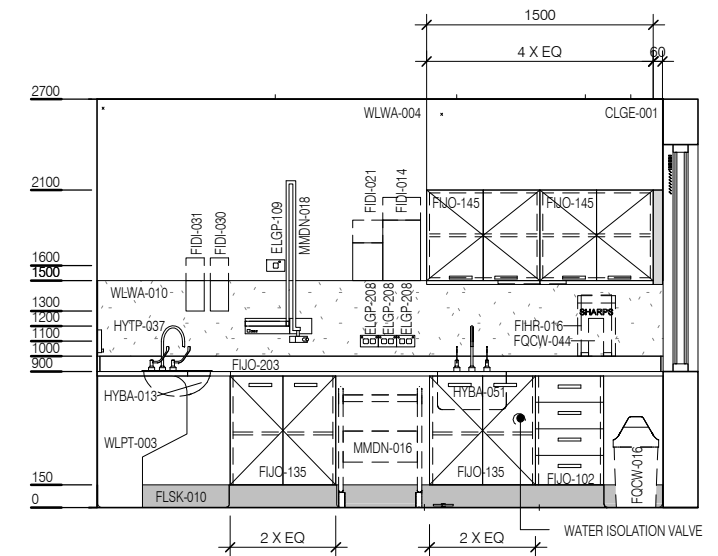

ELEVATION 4



REV	DESCRIPTION	DATE
4	Coding and naming updated	20.03.2017

FOR GUIDANCE

SCALE	RLS Room Code	REV
1 : 50 @ A3	DENSR-14	4