

AUSTRALASIAN HFG STANDARD COMPONENTS

Room Layout Sheet

RLS Room Code: **DENW**

Room Name:

DENTAL WORKROOM

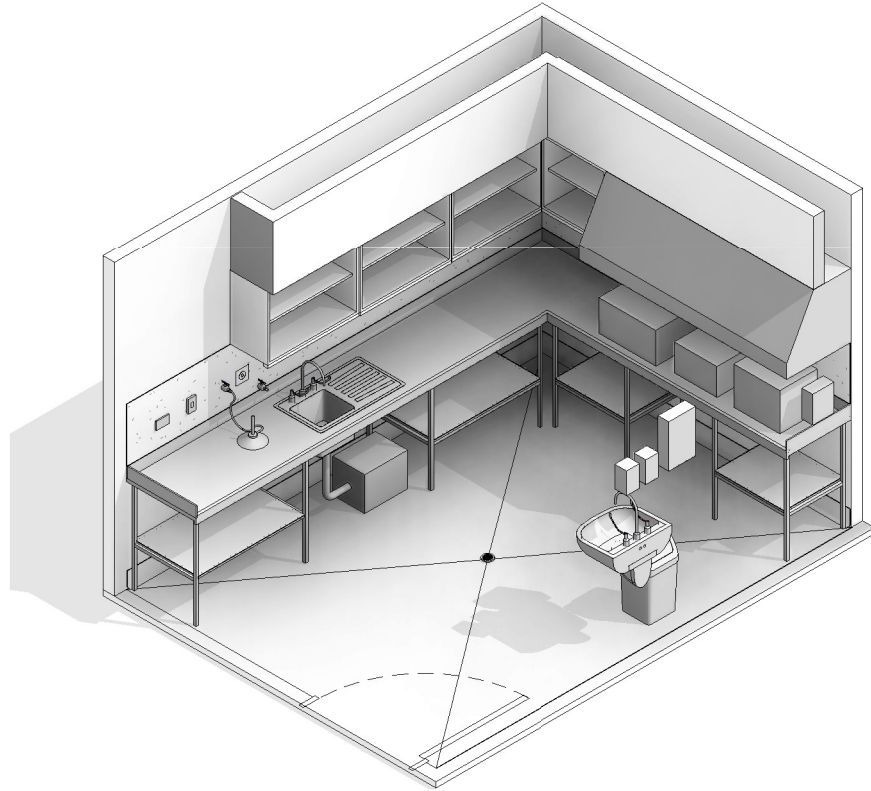
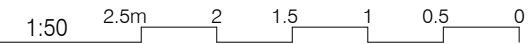

CODE	DESCRIPTION
CLGE-001	CEILING: plasterboard, bulkhead, paint
DWPR-006	DOOR PROTECTION: protection plate, to 900 AFFL, PVC, prefinished
DWPR-010	DOOR PROTECTION: to door frame, PVC, prefinished
ELBO-015	SWITCH: light, single
ELGP-208	GPO: double, wall mounted
FIDI-014	DISPENSER: disposable glove
FIDI-021	DISPENSER: mask
FIDI-025	DISPENSER: paper/hand towel
FIDI-030	DISPENSER: soap
FIDI-031	DISPENSER: soap antiseptic
FUJO-021	BENCH: 600D, open under, stainless steel lipped
FUJO-100	BENCH LEGS: stainless steel, for bench top
FUJO-152	CUPBOARD: wall mount, shelf unit, adj shelves
FUJO-197	SHELF: stainless steel, underbench
FLSK-010	SKIRTING: vinyl, floor vinyl covered, 150H, prefinished
FLVY-007	FLOOR FINISH: vinyl, seamless, coved, standard slip resistant
FQCW-016	BIN: waste, general, 20L
HYBA-010	BASIN: handwash, Type B
HYBA-069	SINK: single, with drainer, 930mmL
HYDR-004	DRAIN: floor waste
HYDR-008	TRAP: plaster
HYTP-008	OUTLET: cold water
HYTP-014	OUTLET: natural gas
HYTP-037	TAPWARE: mixer, elbow levers
ITIN-026	OUTLET: data, double RJ45, wall mounted
ITSE-029	INTERCOM: audio, wall mount
LIFX-008	LIGHT: task light, built in
MEEX-007	EXHAUST: hood
MGAS-008	OUTLET: compressed air, wall mounted
MMDN-008	GRINDER: dental, workshop
MMDN-009	LATHE: dental, polishing
MMDN-017	UNIT: processing, denture
MMLA-016	BURNER: bunsen
WLWA-004	WALL FINISH: paint, acrylic, washable
WLWA-010	WALL FINISH: splashback, vinyl

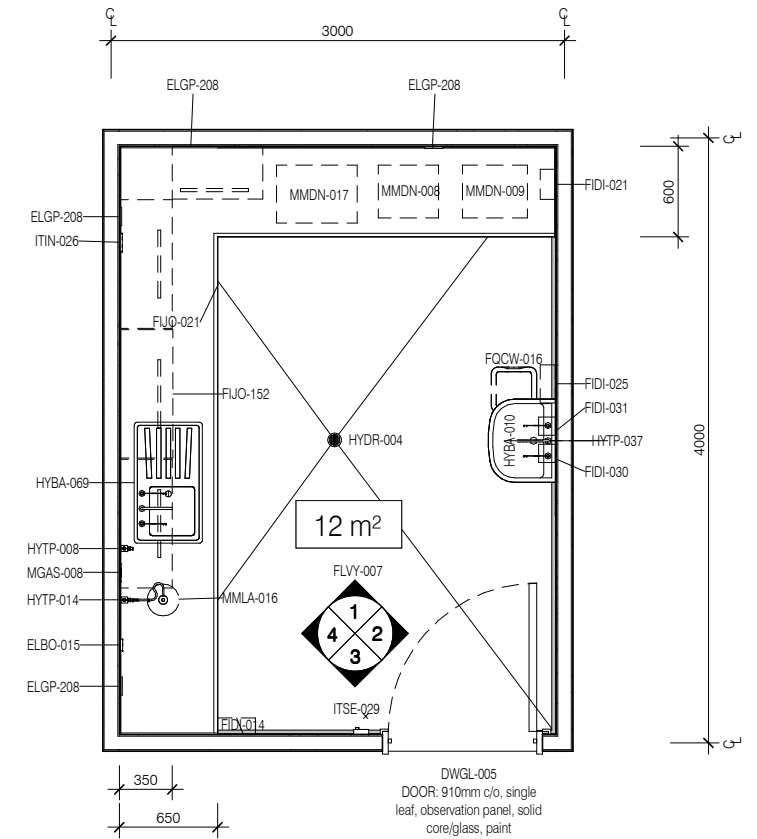

PLAN

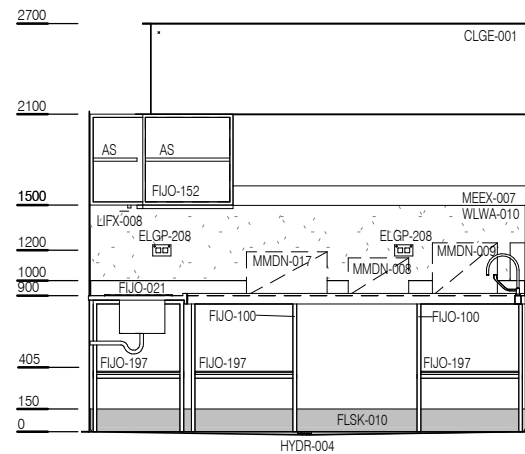

ELEVATION 1

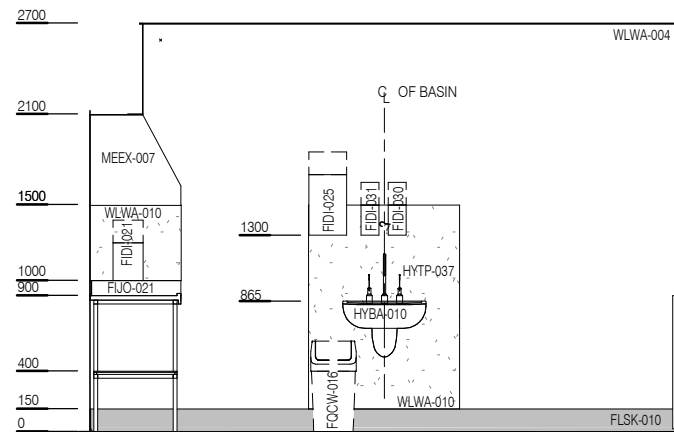

ELEVATION 2

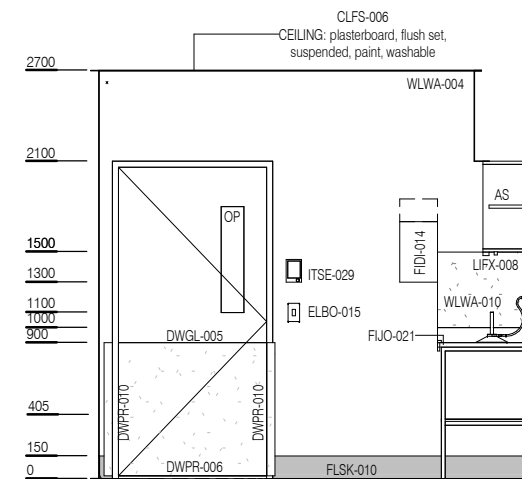

ELEVATION 3

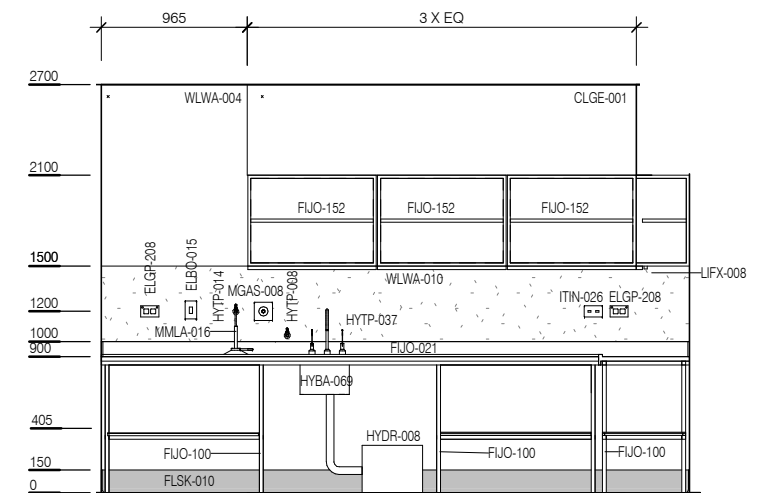

ELEVATION 4



REV	DESCRIPTION	DATE
3	Coding and naming updated	20.03.2017

FOR GUIDANCE

SCALE	RLS Room Code	REV
1 : 50 @ A3	DENW	3