

AUSTRALASIAN HFG STANDARD COMPONENTS

Room Layout Sheet

RLS Room Code: **ECHO**

Room Name:

ECHOCARDIOGRAPHY - TRANS-OESOPHAGEAL

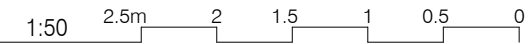

CODE	DESCRIPTION
CLGE-001	CEILING: plasterboard, bulkhead, paint
DWPR-006	DOOR PROTECTION: protection plate, to 900 AFFL, PVC, prefinished
DWPR-010	DOOR PROTECTION: to door frame, PVC, prefinished
ELBO-015	SWITCH: light, single
ELGP-106	GPO: single, special, for equipment
ELGP-109.1	GPO: single, wall mounted (V)
ELGP-122.1	GPO: emergency power, single, on services panel (V)
ELGP-208	GPO: double, wall mounted
ELPR-001	BODY PROTECTED ELECTRICAL AREA
FIDI-014	DISPENSER: disposable glove
FIDI-025	DISPENSER: paper/hand towel
FIDI-030	DISPENSER: soap
FIDI-031	DISPENSER: soap antiseptic
FIHR-026	HOOK: coat
FIJO-059	BENCH TOP: 600D, joinery under, laminate finish
FIJO-116	CUPBOARD: tall, double door, adj shelves
FIJO-135	CUPBOARD: underbench, double door, adj shelves
FIJO-143	CUPBOARD: wall mount, double door, adj shelves
FIRT-032	TRACK: curtain, privacy, L shaped
FLSK-010	SKIRTING: vinyl, floor vinyl coved, 150H, prefinished
FLVY-007	FLOOR FINISH: vinyl, seamless, coved, standard slip resistant
FOBS-014	CHAIR: client
FOBS-018	CHAIR: office, ergonomic
FOBS-037	FOOTSTOOL
FQCW-016	BIN: waste, general, 20L
FQGE-005	CLOCK: analogue, battery operated
FQGE-010	CURTAIN: privacy screen
HYBA-010	BASIN: handwash, Type B
HYTP-037	TAPWARE: mixer, elbow levers
ITCL-004	BUTTON: nurse call, emergency
ITCL-006	BUTTON: nurse call, patient to staff
ITCL-008	BUTTON: nurse call, staff assist
ITIN-026	OUTLET: data, double RJ45, wall mounted
ITNE-053	TELEPHONE: handset, wall mount, handsfree
LIFX-008	LIGHT: task light, built in
LIFX-013	LIGHT: procedure, ceiling mounted, small
MGAS-022	OUTLET: medical air (MA), on services panel
MGAS-042	OUTLET: oxygen (O2), on services panel
MGAS-062	OUTLET: suction, on services panel
MGFP-002	FLOWMETER: medical air
MGFP-004	FLOWMETER: oxygen
MMBE-014	BED: patient, ICU, electric with mattress
MMBE-024	COUCH: examination, manual, mobile
MMGE-002	ADAPTER: suction
MMMI-325	DEVICE: imaging, echocardiography machine
MMSP-026	SERVICES PANEL: wall mounted
WLWA-004	WALL FINISH: paint, acrylic, washable
WLWA-010	WALL FINISH: splashback, vinyl

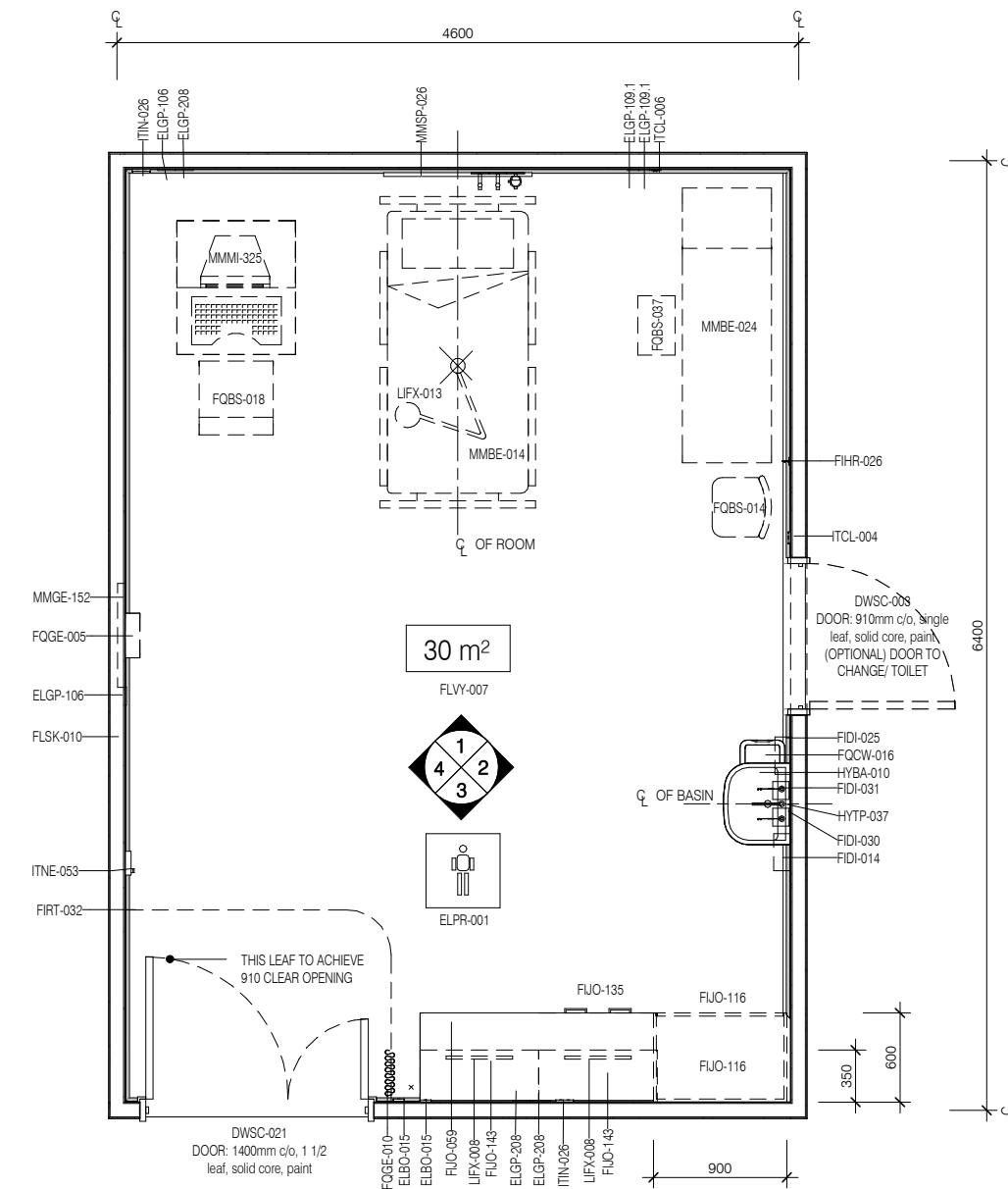
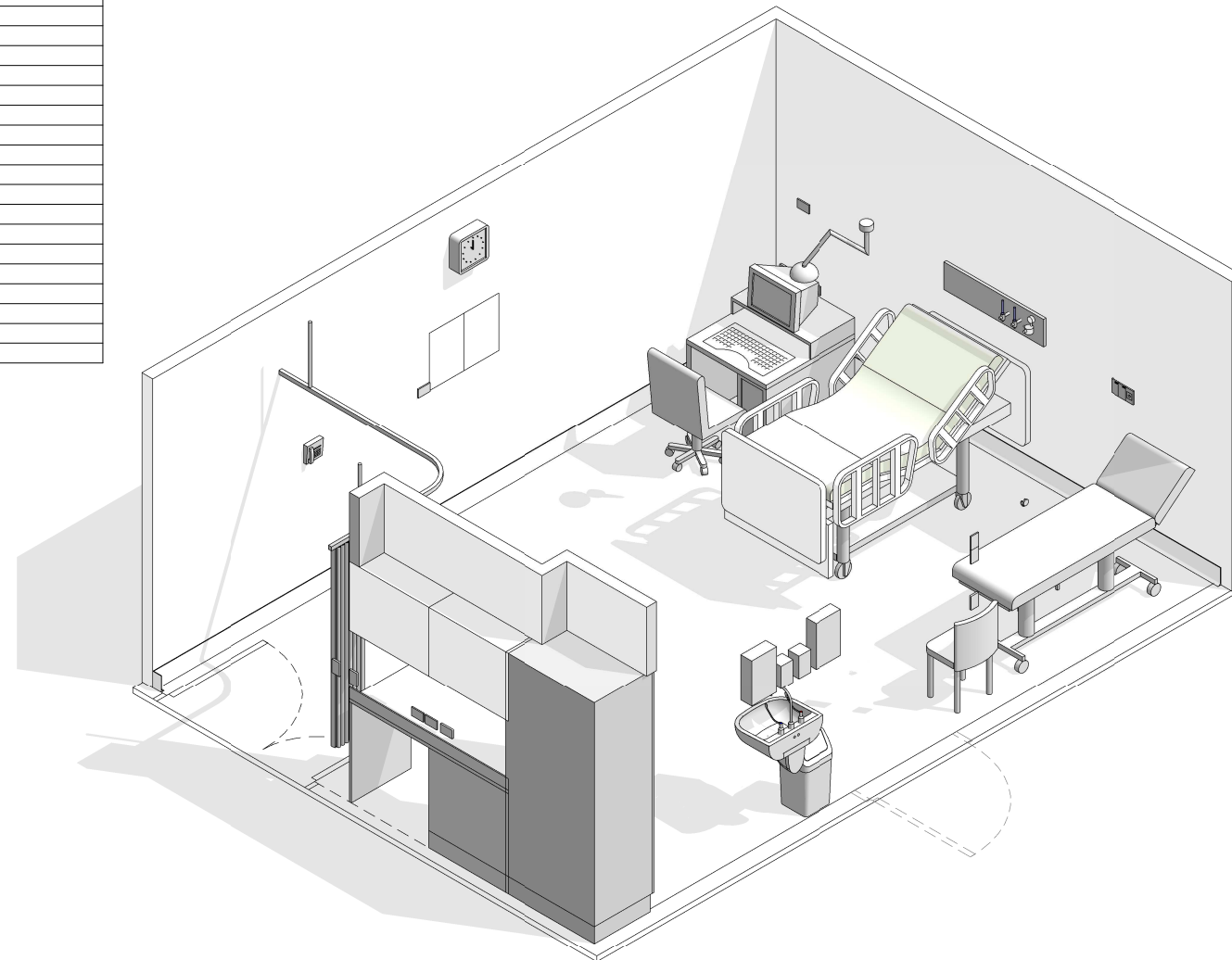

REV	DESCRIPTION	DATE
4	Coding and naming updated	20.03.2017

FOR GUIDANCE

SCALE	RLS Room Code	REV
1 : 50 @ A3	ECHO	4

AUSTRALASIAN HFG STANDARD COMPONENTS

Room Layout Sheet

RLS Room Code: **ECHO**

Room Name: **ECHOCARDIOGRAPHY - TRANS-OESOPHAGEAL**

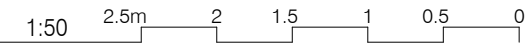

CODE	DESCRIPTION
CLGE-001	CEILING: plasterboard, bulkhead, paint
DWPR-006	DOOR PROTECTION: protection plate, to 900 AFFL, PVC, prefinished
DWPR-010	DOOR PROTECTION: to door frame, PVC, prefinished
ELBO-015	SWITCH: light, single
ELGP-106	GPO: single, special, for equipment
ELGP-109.1	GPO: single, wall mounted (V)
ELGP-122.1	GPO: emergency power, single, on services panel (V)
ELGP-208	GPO: double, wall mounted
ELPR-001	BODY PROTECTED ELECTRICAL AREA
FIDI-014	DISPENSER: disposable glove
FIDI-025	DISPENSER: paper/hand towel
FIDI-030	DISPENSER: soap
FIDI-031	DISPENSER: soap antiseptic
FIHR-026	HOOK: coat
FJO-059	BENCH TOP: 600D, joinery under, laminate finish
FJO-116	CUPBOARD: tall, double door, adj shelves
FJO-135	CUPBOARD: underbench, double door, adj shelves
FJO-143	CUPBOARD: wall mount, double door, adj shelves
FIRT-032	TRACK: curtain, privacy, L shaped
FLSK-010	SKIRTING: vinyl, floor vinyl coved, 150H, prefinished
FLVY-007	FLOOR FINISH: vinyl, seamless, coved, standard slip resistant
FOBS-014	CHAIR: client
FOBS-018	CHAIR: office, ergonomic
FOBS-037	FOOTSTOOL
FQCW-016	BIN: waste, general, 20L
FQGE-005	CLOCK: analogue, battery operated
FQGE-010	CURTAIN: privacy screen
HYBA-010	BASIN: handwash, Type B
HYTP-037	TAPWARE: mixer, elbow levers
ITCL-004	BUTTON: nurse call, emergency
ITCL-006	BUTTON: nurse call, patient to staff
ITCL-008	BUTTON: nurse call, staff assist
ITIN-026	OUTLET: data, double RJ45, wall mounted
ITNE-053	TELEPHONE: handset, wall mount, handsfree
LIFX-008	LIGHT: task light, built in
LIFX-013	LIGHT: procedure, ceiling mounted, small
MGAS-022	OUTLET: medical air (MA), on services panel
MGAS-042	OUTLET: oxygen (O2), on services panel
MGAS-062	OUTLET: suction, on services panel
MGFP-002	FLOWMETER: medical air
MGFP-004	FLOWMETER: oxygen
MMBE-014	BED: patient, ICU, electric with mattress
MMBE-024	COUCH: examination, manual, mobile
MMGE-002	ADAPTER: suction
MMMI-325	DEVICE: imaging, echocardiography machine
MMSP-026	SERVICES PANEL: wall mounted
WLWA-004	WALL FINISH: paint, acrylic, washable
WLWA-010	WALL FINISH: splashback, vinyl

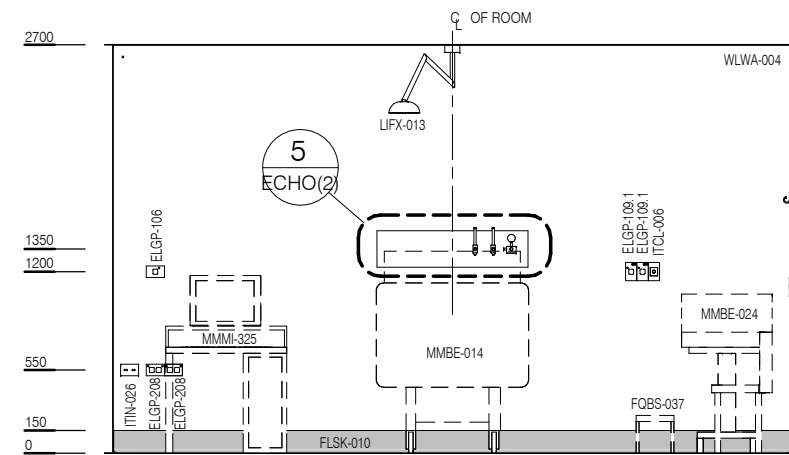

ELEVATION 1

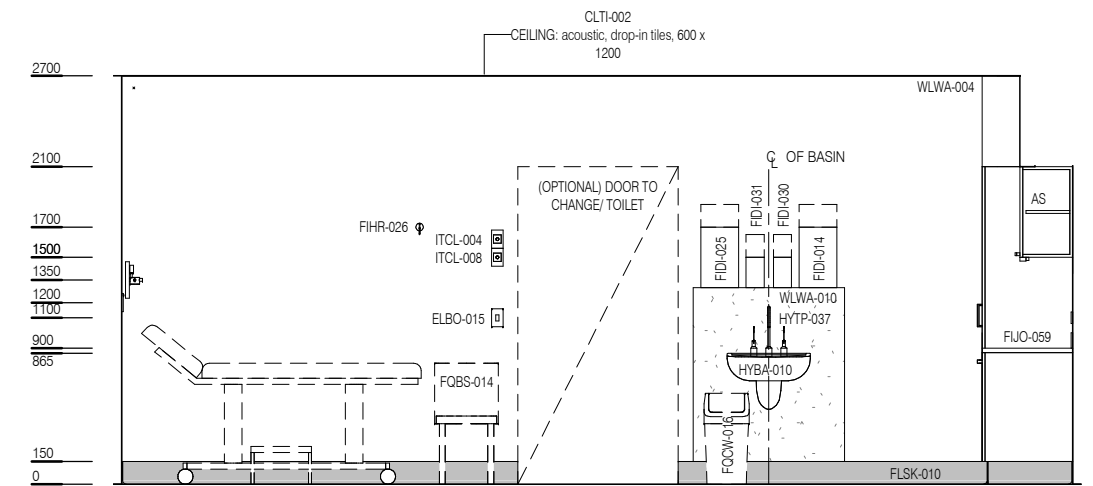

ELEVATION 2

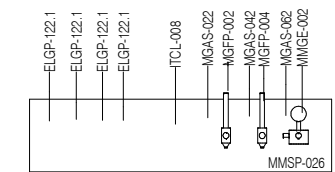

ELEVATION 5 (1 : 25 @ A3)

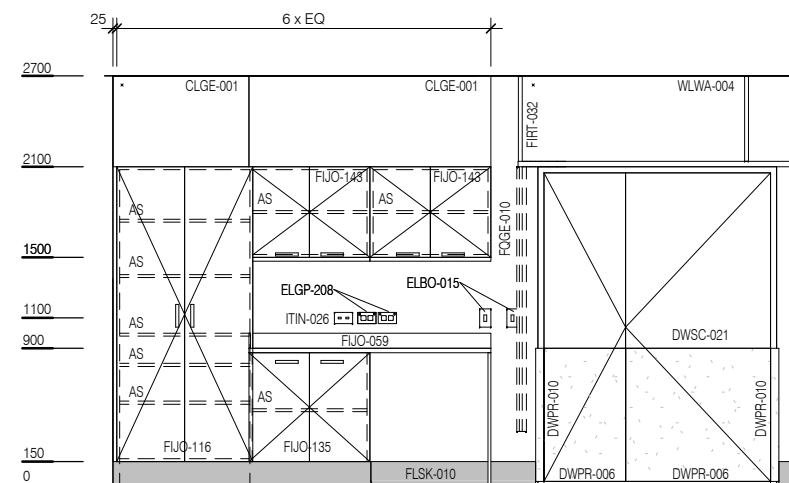

ELEVATION 3

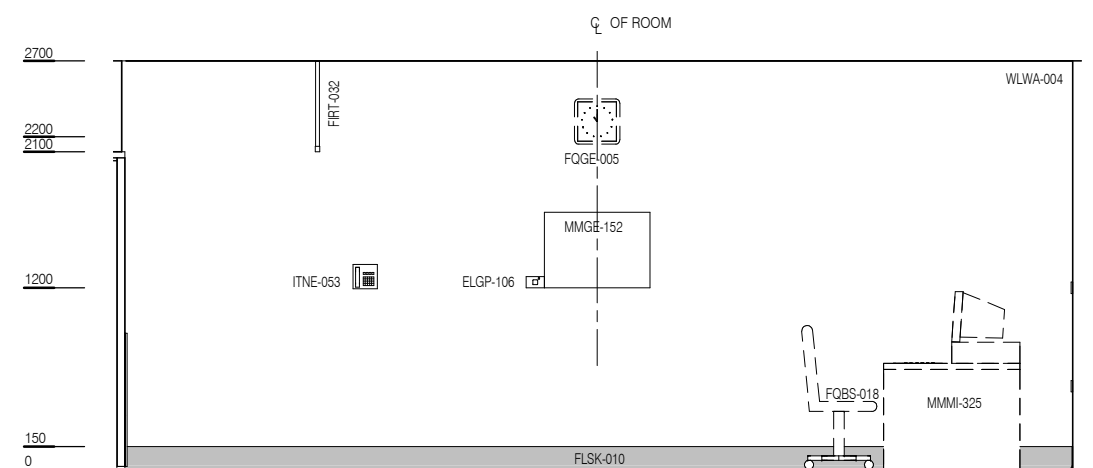

ELEVATION 4



REV	DESCRIPTION	DATE
4	Coding and naming updated	20.03.2017

FOR GUIDANCE

SCALE	RLS Room Code	REV
1 : 50 @ A3	ECHO	4