

AUSTRALASIAN HFG STANDARD COMPONENTS

Room Layout Sheet

RLS Room Code: **ECL-14**

Room Name:

1:50 2.5m 2 1.5 1 0.5 0
EQUIPMENT CLEAN-UP, 14m²

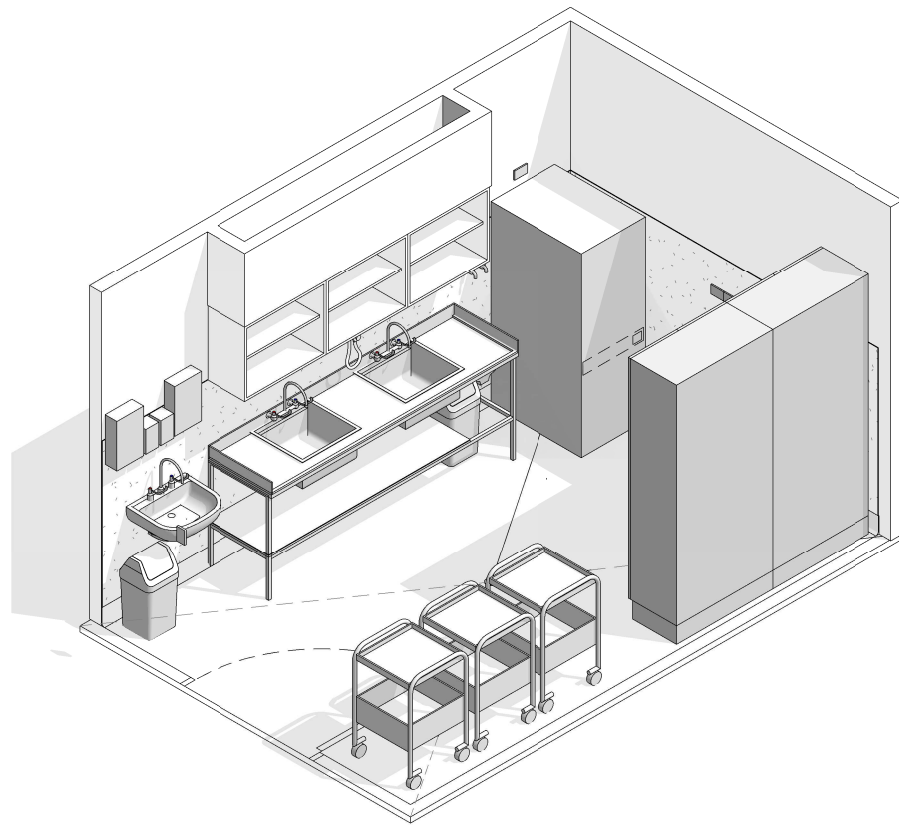

CODE	DESCRIPTION
CLGE-001	CEILING: plasterboard, bulkhead, paint
DWPR-006	DOOR PROTECTION: protection plate, to 900 AFFL, PVC, prefinished
DWPR-010	DOOR PROTECTION: to door frame, PVC, prefinished
ELBO-015	SWITCH: light, single
ELGP-106	GPO: single, special, for equipment
ELGP-208	GPO: double, wall mounted
ELPR-003	ISOLATOR: electrical, 1ph+n
FIDI-014	DISPENSER: disposable glove
FIDI-025	DISPENSER: paper/hand towel
FIDI-030	DISPENSER: soap
FIDI-031	DISPENSER: soap antiseptic
FUJO-021	BENCH: 600D, open under, stainless steel lipped
FUJO-100	BENCH LEGS: stainless steel, for bench top
FUJO-117	CUPBOARD: tall, double door, adj shelves, lockable
FUJO-152	CUPBOARD: wall mount, shelf unit, adj shelves
FUJO-197	SHELF: stainless steel, underbench
FLSK-010	SKIRTING: vinyl, floor vinyl coved, 150H, prefinished
FLVY-004	FLOOR FINISH: vinyl, seamless, coved, non-slip, safety
FQCW-016	BIN: waste, general, 20L
HYBA-010	BASIN: handwash, Type B
HYBA-055	SINK: single, 500 x 450 x 250D
HYDR-004	DRAIN: floor waste
HYTP-004	HOSE: spray
HYTP-008	OUTLET: cold water
HYTP-013	OUTLET: hot water
HYTP-037	TAPWARE: mixer, elbow levers
MMGE-119	TROLLEY: equipment
MMIC-097	WASHER SANITISER: utensil washer
WLWA-004	WALL FINISH: paint, acrylic, washable
WLWA-020	WALL FINISH: vinyl, to 1500 AFFL

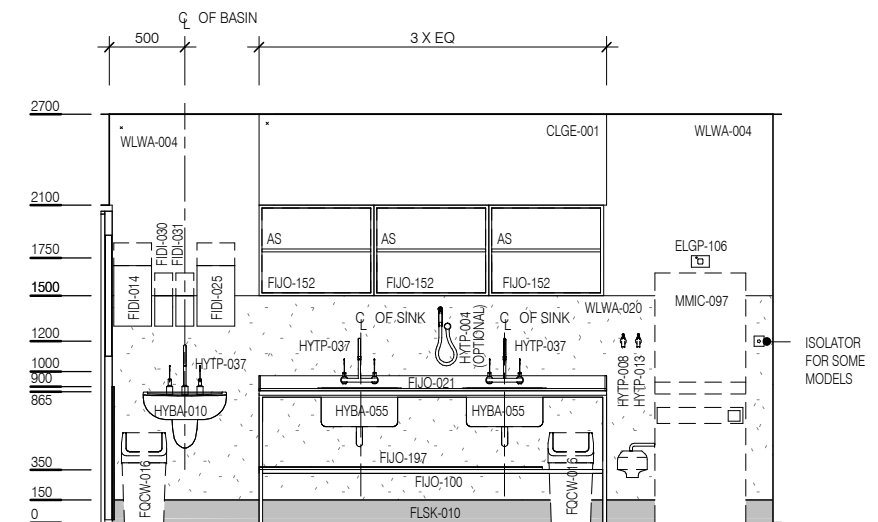
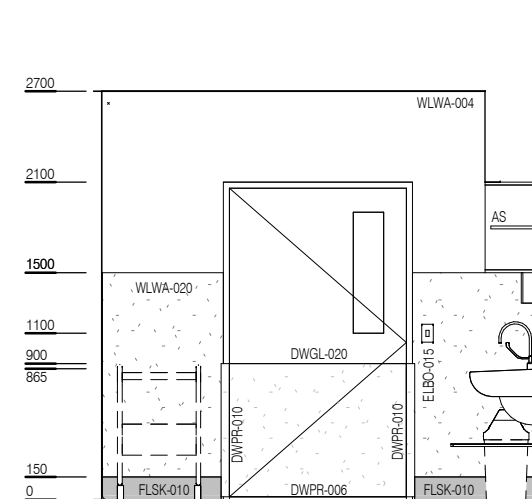
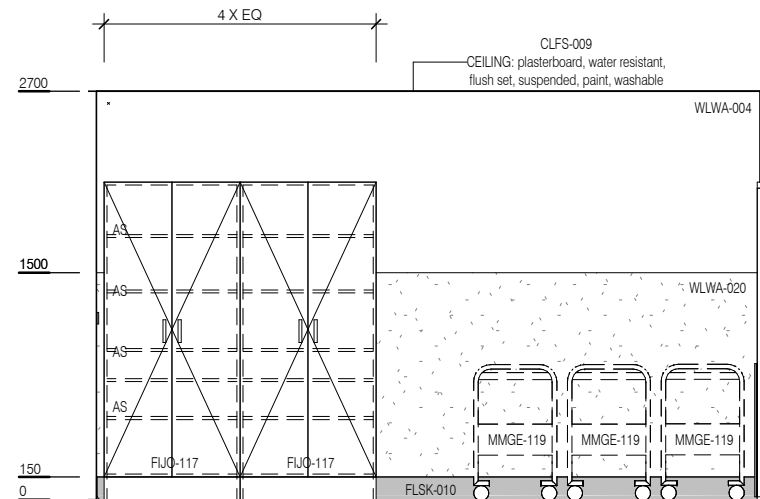
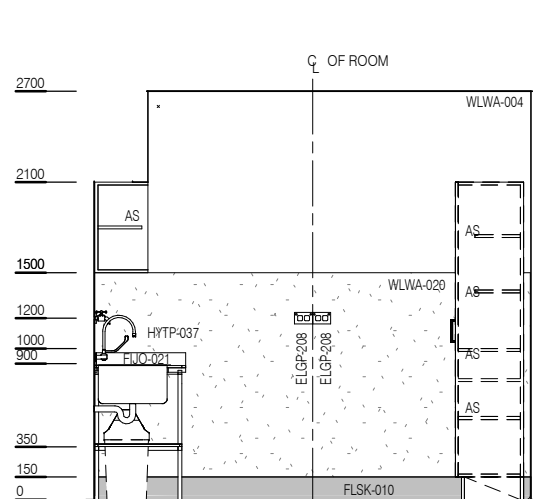
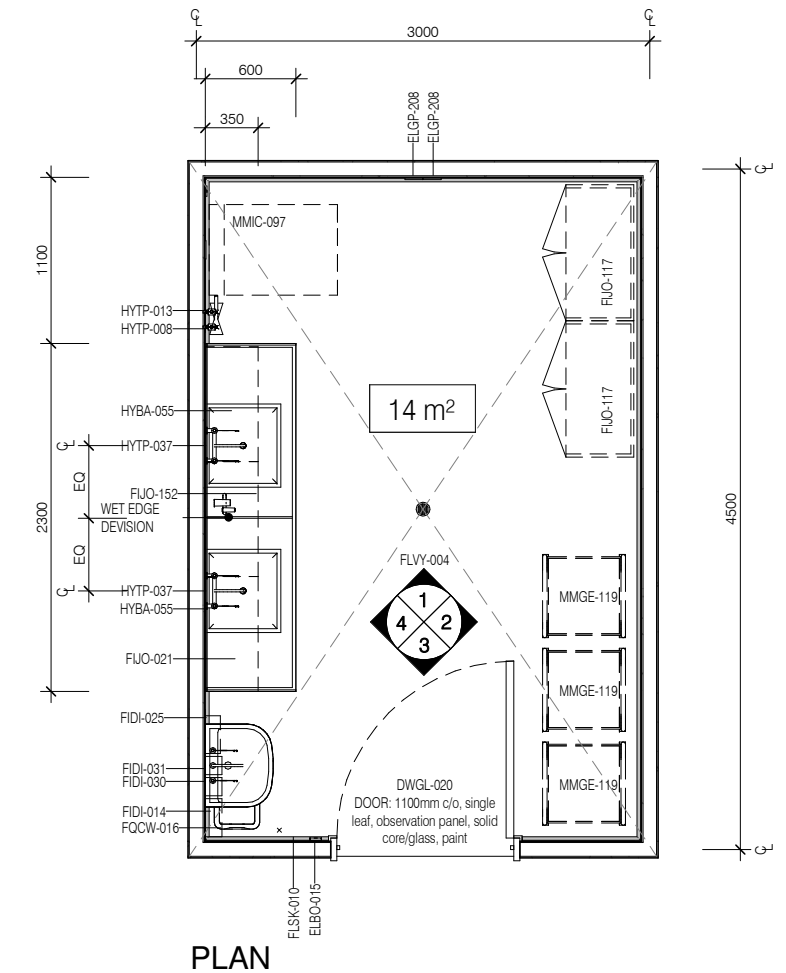

REV	DESCRIPTION	DATE
4	Coding and naming updated	20.03.2017

FOR GUIDANCE

SCALE	RLS Room Code	REV
1 : 50 @ A3	ECL-14	4

