

AUSTRALASIAN HFG STANDARD COMPONENTS

Room Layout Sheet

RLS Room Code: **GYAH-ID**

1:100 5m 4 3 2 1 0

Room Name:

GYMNASIUM, INDIVIDUAL TREATMENT

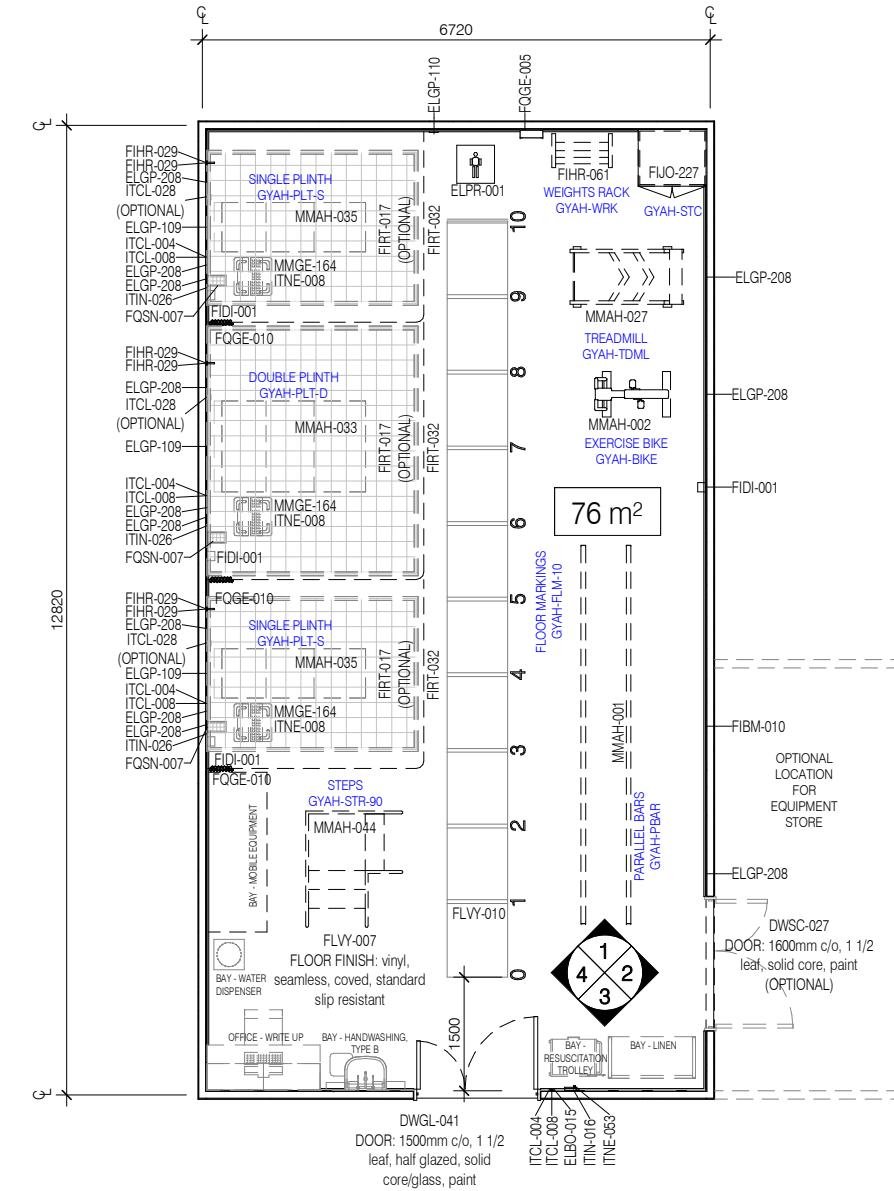
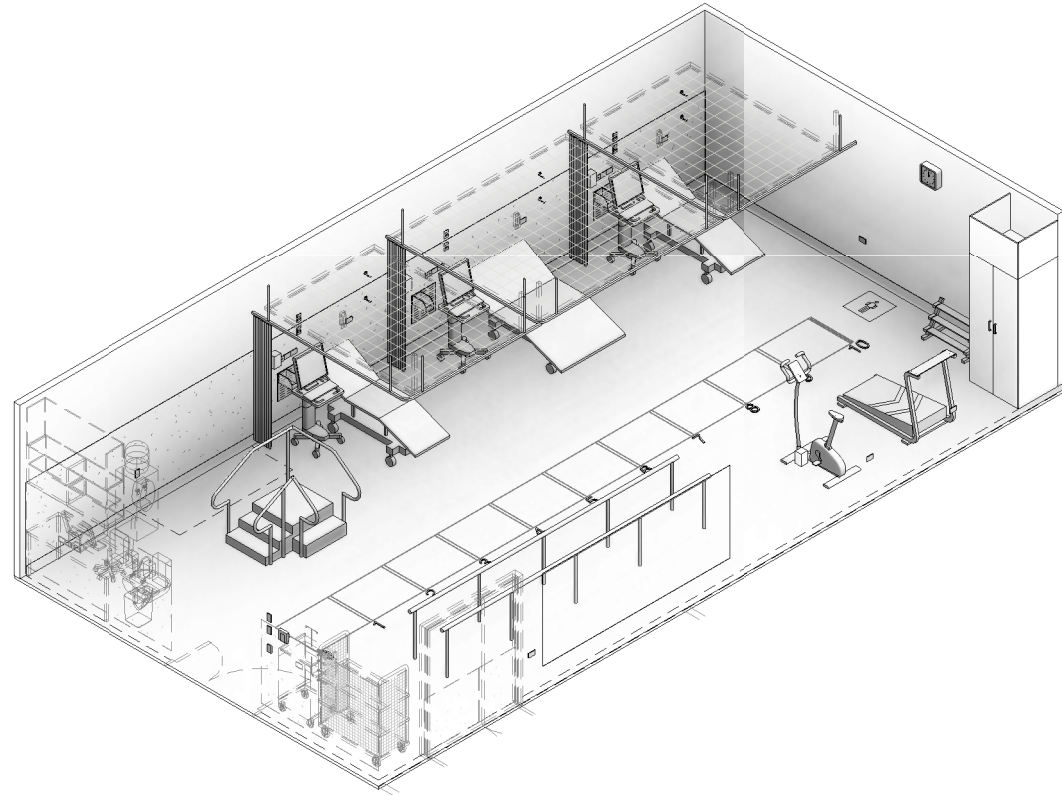

PLAN

GYMNASIUM EQUIPMENT AND ARRANGEMENTS WILL VARY. LAYOUT INDICATES A SCENARIO FOR INDIVIDUAL TREATMENT FOR UP TO 8 PATIENTS. SEE SUPPLEMENTARY DOCUMENTATION FOR CLEARANCE AND CIRCULATION GUIDANCE FOR COMMON GYMNASIUM COMPONENTS.

THE OVERALL AREA OF THE LAYOUT IS 86m². THE INDICATED AREA IS 76m². THIS AREA HAS BEEN CALCULATED AS THE SPACES BELOW, THAT ARE LISTED SEPARATELY IN THE ALLIED HEALTH HPU SCHEDULE OF ACCOMMODATION. HAVE BEEN COMBINED INTO THIS LAYOUT AND SUBTRACTED FROM THE TOTAL AREA TO PROVIDE THIS EXAMPLE:

- OFF-WI-S, OFFICE - WRITE UP (2.5m²)
- BHWS-B, BAY - HANDWASHING, TYPE B (1m²)
- BWD, WATER DISPENSER (1m²)
- BRES, RESUSCITATION TROLLEY (1.5m²)
- BLIN, BAY - LINEN (2m²)
- BMEQ, BAY - MOBILE EQUIPMENT (2m²)

REFER TO SEPARATE STANDARD COMPONENTS FOR REQUIREMENTS

| CODE | DESCRIPTION |
|----------|---|
| DWPR-005 | DOOR PROTECTION: protection plate to 900 AFFL |
| ELGP-109 | GPO: single, wall mounted |
| ELGP-110 | GPO: single, wall mounted, cleaner |
| ELGP-208 | GPO: double, wall mounted |
| ELPR-001 | BODY PROTECTED ELECTRICAL AREA |
| FIBM-010 | MIRROR: fixed, safety glass, full length |
| FIDI-001 | DISPENSER: alcohol based hand rub |
| FIHR-029 | HOOK: equipment |
| FIHR-033 | PANEL: for storage bins, wall mount |
| FIHR-061 | RACK: weights |
| FJO-212 | BULKHEAD: joinery |
| FJO-227 | CUPBOARD: tall, double door, gym equipment storage |
| FIRT-017 | STEEL MESH: framed, ceiling mount |
| FIRT-032 | TRACK: curtain, privacy, L shaped |
| FLSK-010 | SKIRTING: vinyl, floor vinyl coved, 150H, prefinished |
| FLVY-007 | FLOOR FINISH: vinyl, seamless, coved, standard slip resistant |
| FLVY-010 | FLOOR FINISH: vinyl, seamless, inset floor markings |
| FQGE-005 | CLOCK: analogue, battery operated |
| FQGE-010 | CURTAIN: privacy screen |
| FQSN-007 | BIN: storage bins, wire mesh, stainless steel |
| ITCL-004 | BUTTON: nurse call, emergency |
| ITCL-008 | BUTTON: nurse call, staff assist |
| ITCL-028 | HANDSET: nurse call, with patient to staff call button |
| ITIN-026 | OUTLET: data, double RJ45, wall mounted |
| ITNE-008 | COMPUTER: for workstation on wheels |
| MMAH-001 | BARS: parallel |
| MMAH-002 | BICYCLE: exercise |
| MMAH-027 | TREADMILL: automatic |
| MMAH-033 | PLINTH: double width |
| MMAH-035 | PLINTH: single width |
| MMAH-044 | STAIRS: exercise, 90 degree |
| MMGE-164 | WORKSTATION ON WHEELS: clinical, mobile |
| WLWA-004 | WALL FINISH: paint, acrylic, washable |
| WLWA-020 | WALL FINISH: vinyl, to 1500 AFFL |

