

AUSTRALASIAN HFG STANDARD COMPONENTS

Room Layout Sheet

RLS Room Code: **MRIR**

1:50 2.5m 2 1.5 1 0.5 0

Room Name:

MRI ROOM

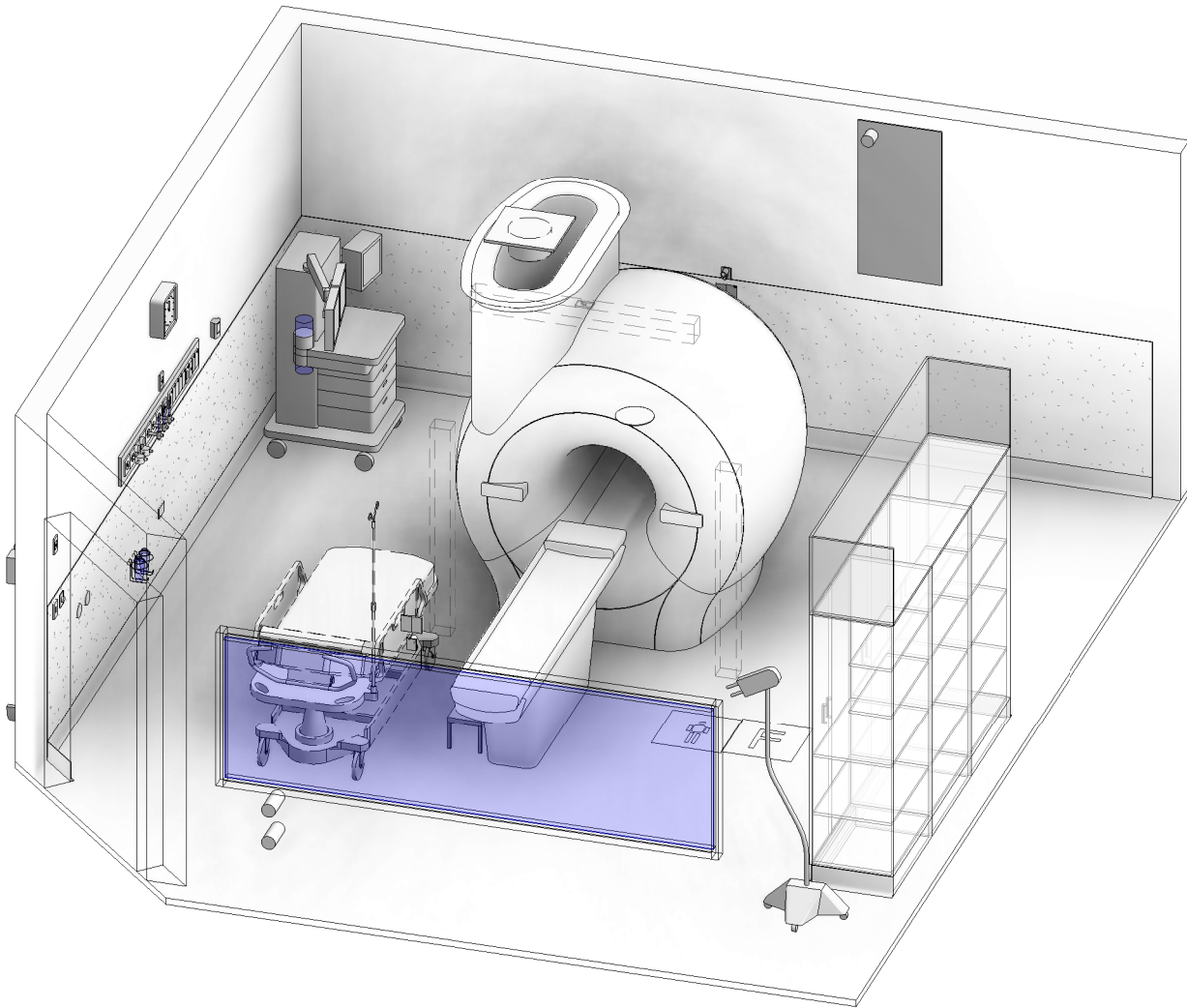

PROPORTIONS OF THE ROOM ARE DETERMINED BY THE 5 GAUSS LINE, WHICH IS SPECIFIC TO EACH MODALITY. SOME LAYOUTS MAY NEED TO BE LONGER AND/OR NARROWER TO ACCOMMODATE CERTAIN VENDORS. SEEK JURISDICTIONAL GUIDANCE ON PLANNING FOR ANTICIPATED VENDOR RANGE.

**ANAE-16
ANAESTHETIC
PREPARATION
(REQUIRED)
MRI SAFETY
ZONE 3**

CORRIDOR

PLAN

NOTE: ROOM WIDTH DESIGNED TO CAPTURE 3 TESLA 5 GAUSS LINE
ROOM WIDTH MAY BE DECREASED FOR 1.5 TESLA MRI

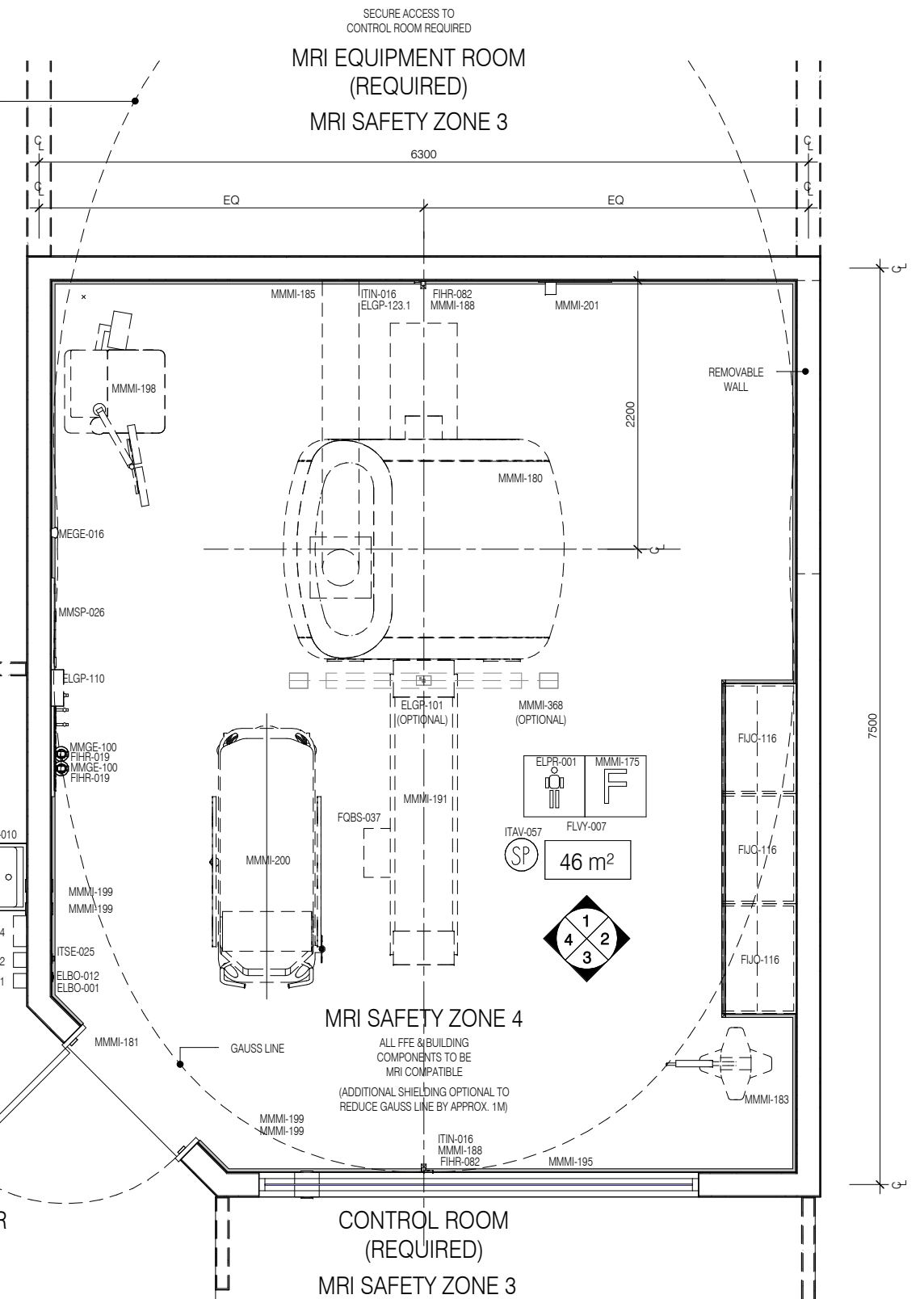

CODE	DESCRIPTION
DWPR-005	DOOR PROTECTION: protection plate to 900 AFFL
ELBO-001	BUTTON: emergency stop
ELBO-012	SWITCH: light, dimmer
ELGP-101	GPO: single, ceiling mounted
ELGP-109	GPO: single, wall mounted
ELGP-110	GPO: single, wall mounted, cleaner
ELGP-122.1	GPO: emergency power, single, on services panel (V)
ELGP-123.1	GPO: emergency power, single, wall mounted (V)
ELGP-133	GPO: UPS, single, on services panel
ELPR-001	BODY PROTECTED ELECTRICAL AREA
ELPR-006	RCD: residual current device
ELPR-007	UPS: status indicator
FIHR-019	BRACKET: for suction bottle
FIHR-082	BRACKET: for observation camera, MRI compatible, wall mounted
FJJO-116	CUPBOARD: tall, double door, adj shelves
FJO-212	BULKHEAD: joinery
FLSK-010	SKIRTING: vinyl, floor vinyl coved, 150H, prefinished
FLVY-007	FLOOR FINISH: vinyl, seamless, coved, standard slip resistant
FOBS-037	FOOTSTOOL
ITAV-057	SPEAKER: ceiling recessed
ITCL-004	BUTTON: nurse call, emergency
ITCL-008	BUTTON: nurse call, staff assist
ITCL-014	CLOCK: analogue, electric
ITIN-016	OUTLET: data, single RJ45, wall mounted
ITSE-025	DOOR RELEASE: access control, remote activation

CODE	DESCRIPTION
MEGE-016	SENSOR: oxygen depletion
MGAS-022	OUTLET: medical air (MA), on services panel
MGAS-032	OUTLET: nitrous oxide (N2O), on services panel
MGAS-042	OUTLET: oxygen (O2), on services panel
MGAS-053	OUTLET: scavenge, on services panel
MGAS-062	OUTLET: suction, on services panel
MGFP-002	FLOWMETER: medical air
MGFP-004	FLOWMETER: oxygen
MMGE-002	ADAPTER: suction
MMGE-100	SUCTION BOTTLE
MMMI-175	CABIN: radio frequency, faraday cage, MRI
MMMI-180	DEVICE: imaging, magnet, MRI
MMMI-183	INJECTOR: contrast, MRI
MMMI-185	PIPE: quench, MRI
MMMI-188	CAMERA: observation, MRI
MMMI-191	TABLE: patient, fixed, MRI
MMMI-195	WINDOW: radiofrequency, MRI
MMMI-198	MACHINE: anaesthetic, MRI compatible
MMMI-199	PANEL: waveguide, MRI
MMMI-200	TROLLEY: patient, transport, MRI compatible
MMMI-201	PANEL: penetration, MRI
MMMI-368	LASER: positioning lights, MRI
MMSP-026	SERVICES PANEL: wall mounted
WLWA-004	WALL FINISH: paint, acrylic, washable
WLWA-025	WALL FINISH: vinyl, to 1200 AFFL



REV	DESCRIPTION	DATE
1	First Issue	29.05.2019

FOR GUIDANCE

SCALE	RLS Room Code	REV
1 : 50 @ A3	MRIR	1

AUSTRALASIAN HFG STANDARD COMPONENTS

Room Layout Sheet

RLS Room Code: **MRIR**

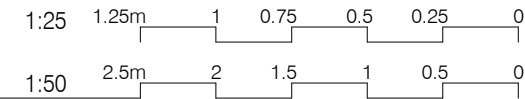

Room Name:

MRI ROOM

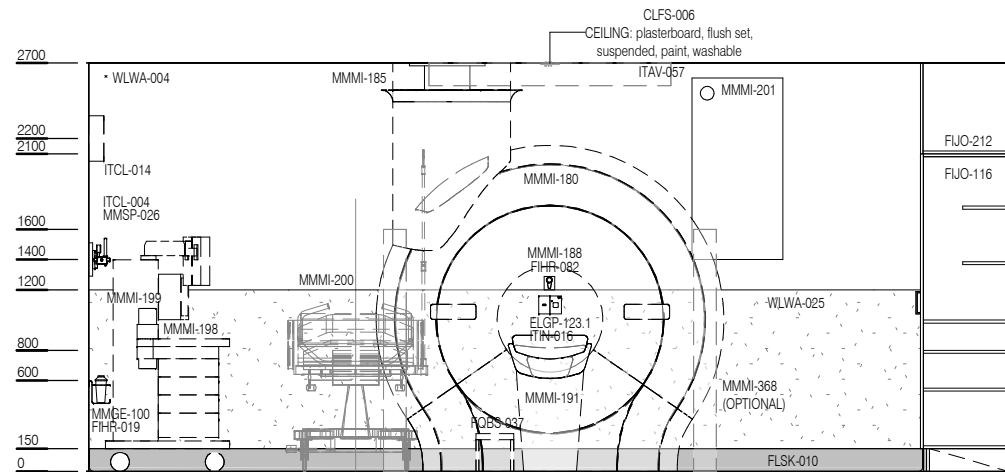

ELEVATION 1

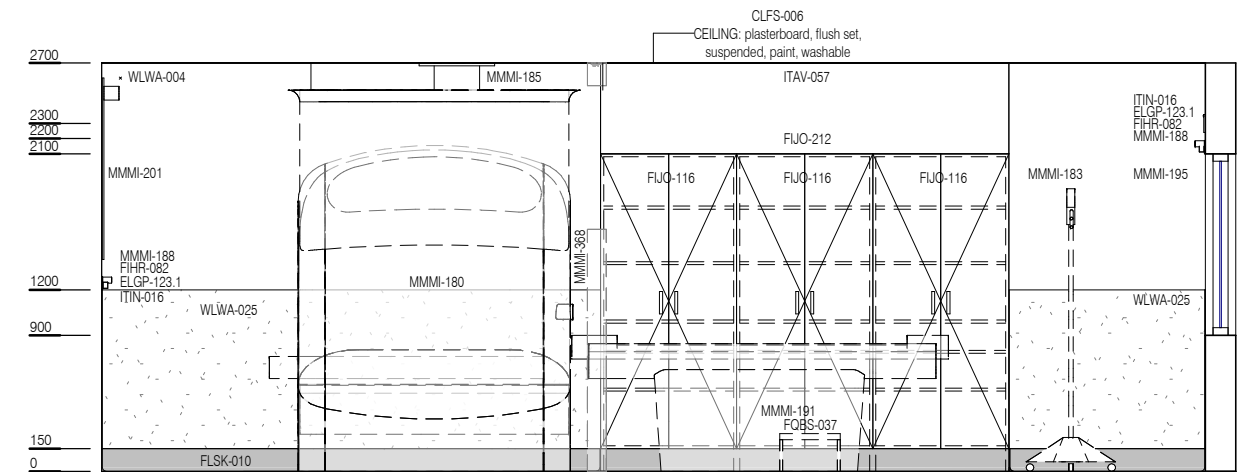

ELEVATION 2

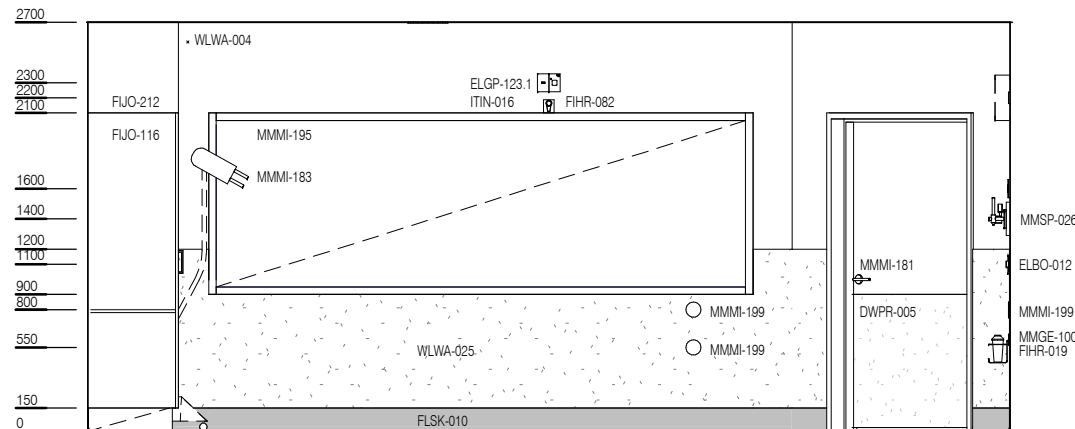

ELEVATION 3

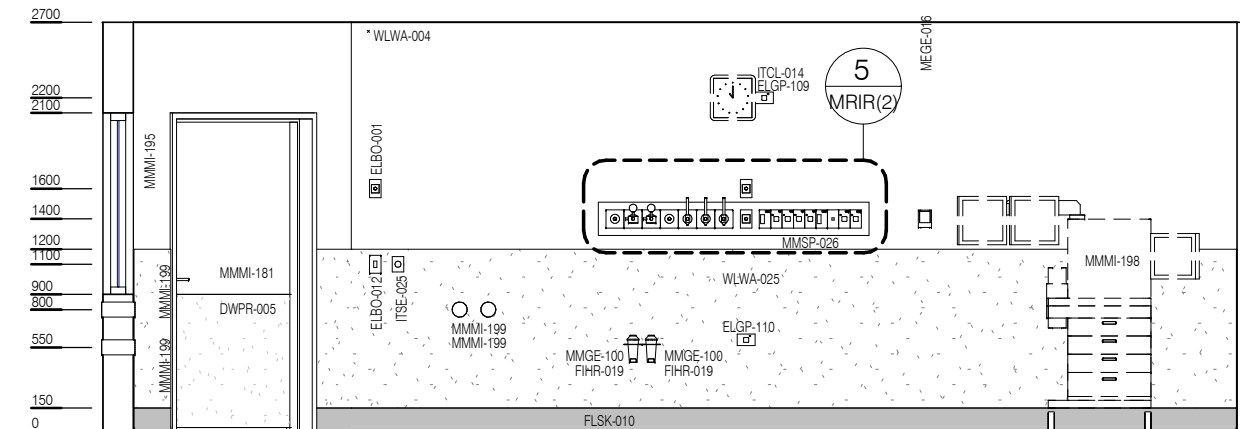

ELEVATION 4

CODE	DESCRIPTION
DWPR-005	DOOR PROTECTION: protection plate to 900 AFFL
ELBO-001	BUTTON: emergency stop
ELBO-012	SWITCH: light, dimmer
ELGP-101	GPO: single, ceiling mounted
ELGP-109	GPO: single, wall mounted
ELGP-110	GPO: single, wall mounted, cleaner
ELGP-122.1	GPO: emergency power, single, on services panel (V)
ELGP-123.1	GPO: emergency power, single, wall mounted (V)
ELGP-133	GPO: UPS, single, on services panel
ELPR-001	BODY PROTECTED ELECTRICAL AREA
ELPR-006	RCD: residual current device
ELPR-007	UPS: status indicator
FIHR-019	BRACKET: for suction bottle
FIHR-082	BRACKET: for observation camera, MRI compatible, wall mounted
FUJO-116	CUPBOARD: tall, double door, adj shelves
FUJO-212	BULKHEAD: joinery
FLSK-010	SKIRTING: vinyl, floor vinyl coved, 150H, prefinished
FLVY-007	FLOOR FINISH: vinyl, seamless, coved, standard slip resistant
FQBS-037	FOOTSTOOL
ITAV-057	SPEAKER: ceiling recessed
ITCL-004	BUTTON: nurse call, emergency
ITCL-008	BUTTON: nurse call, staff assist
ITCL-014	CLOCK: analogue, electric
ITIN-016	OUTLET: data, single RJ45, wall mounted
ITSE-025	DOOR RELEASE: access control, remote activation

CODE	DESCRIPTION
MEGE-016	SENSOR: oxygen depletion
MGAS-022	OUTLET: medical air (MA), on services panel
MGAS-032	OUTLET: nitrous oxide (N2O), on services panel
MGAS-042	OUTLET: oxygen (O2), on services panel
MGAS-053	OUTLET: scavenge, on services panel
MGAS-062	OUTLET: suction, on services panel
MGFP-002	FLOWMETER: medical air
MGFP-004	FLOWMETER: oxygen
MMGE-002	ADAPTER: suction
MMGE-100	SUCTION BOTTLE
MMMI-175	CABIN: radio frequency, faraday cage, MRI
MMMI-180	DEVICE: imaging, magnet, MRI
MMMI-183	INJECTOR: contrast, MRI
MMMI-185	PIPE: quench, MRI
MMMI-188	CAMERA: observation, MRI
MMMI-191	TABLE: patient, fixed, MRI
MMMI-195	WINDOW: radiofrequency, MRI
MMMI-198	MACHINE: anaesthetic, MRI compatible
MMMI-199	PANEL: waveguide, MRI
MMMI-200	TROLLEY: patient, transport, MRI compatible
MMMI-201	PANEL: penetration, MRI
MMMI-368	LASER: positioning lights, MRI
MMSP-026	SERVICES PANEL: wall mounted
WLWA-004	WALL FINISH: paint, acrylic, washable
WLWA-025	WALL FINISH: vinyl, to 1200 AFFL

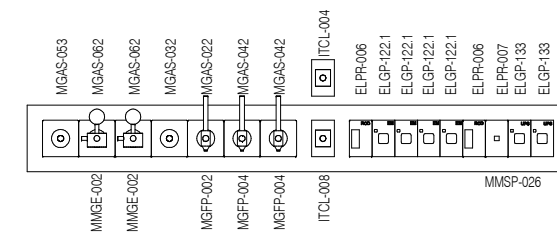

ELEVATION 5 (1 : 25 @ A3)



REV	DESCRIPTION	DATE
1	First Issue	29.05.2019

FOR GUIDANCE

SCALE	RLS Room Code	REV
1 : 50 @ A3	MRIR	1