

AUSTRALASIAN HFG STANDARD COMPONENTS

Room Layout Sheet

RLS Room Code: OFF-4P

1:50 2.5m 2 1.5 1 0.5 0

Room Name:

OFFICE - 4 PERSON SHARED, 20m²



CODE	DESCRIPTION
CAC	Cable access cap
DWPR-003	DOOR PROTECTION: kickplate, to 300 AFFL, vinyl, prefinished
DWWD-006	BLIND: venetian
DWWH-005	WINDOW
ELBO-015	SWITCH: light, single
ELGP-208	GPO: double, wall mounted
FIBM-013	NOTICEBOARD: fixed, fabric covered
FIBM-018	WHITEBOARD: fixed
FUJO-152	CUPBOARD: wall mount, shelf unit, adj shelves
FLCP-003	FLOOR FINISH: carpet, broadloom, 48 oz., 90/10 wool/nylon
FLSK-009	SKIRTING: vinyl, feather edged, 150H, prefinished
FQBS-018	CHAIR: office, ergonomic
FQCW-016	BIN: waste, general, 20L
FQDW-019	WORKSTATION: corner, adj height, 1800/1800W x 750D x 750H nom.
FQSM-007	PEDESTAL: mobile, drawer unit, 660H
FQSM-009	PEDESTAL: mobile, filing unit, 660H
FQTA-057	TABLE: round, 900 diam, work height
ITIN-026	OUTLET: data, double RJ45, wall mounted
ITNE-007	COMPUTER: desktop, with display screen
ITNE-023	PRINTER: networked
ITNE-049	TELEPHONE: handset, desktop
LIFX-008	LIGHT: task light, built in
WLWA-004	WALL FINISH: paint, acrylic, washable

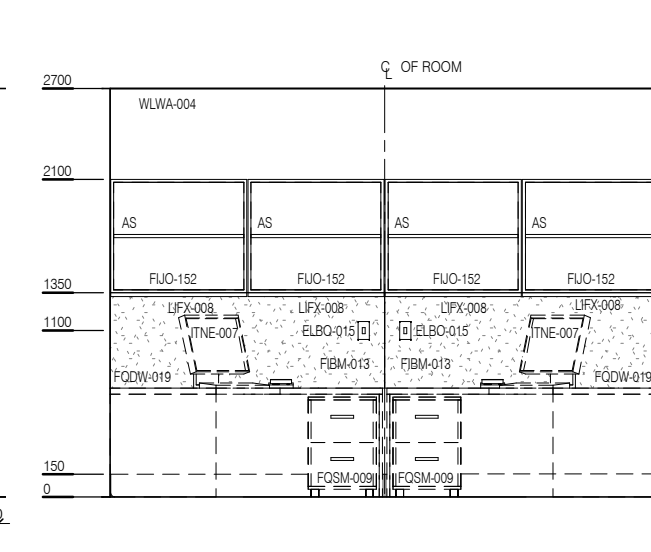
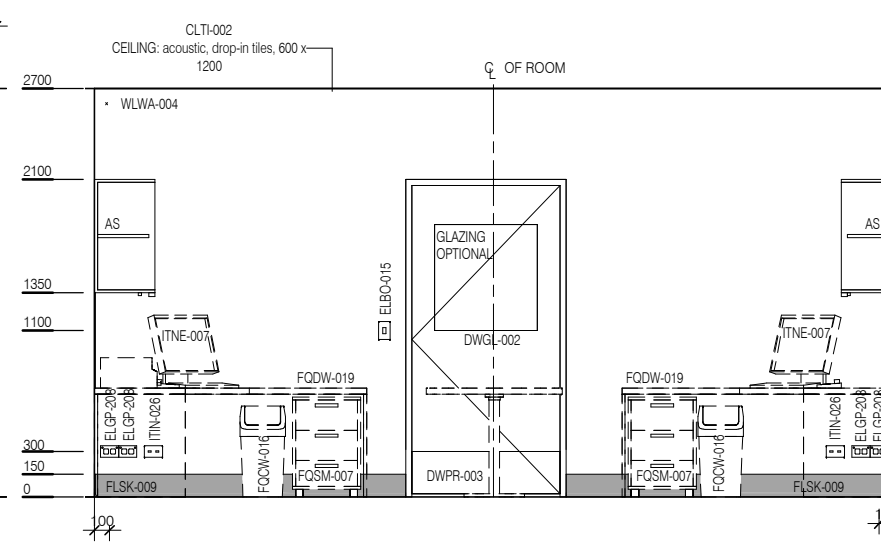
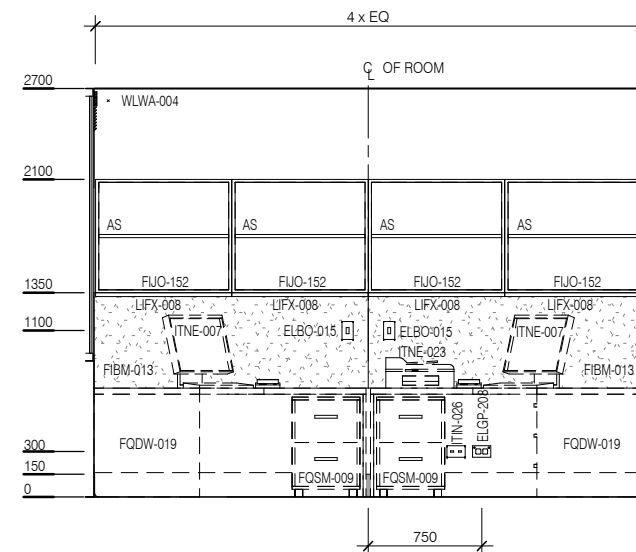
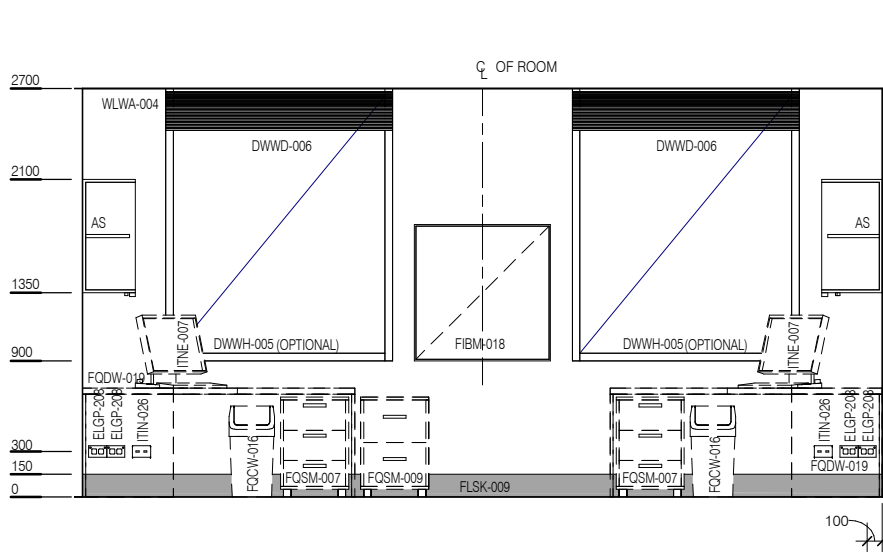
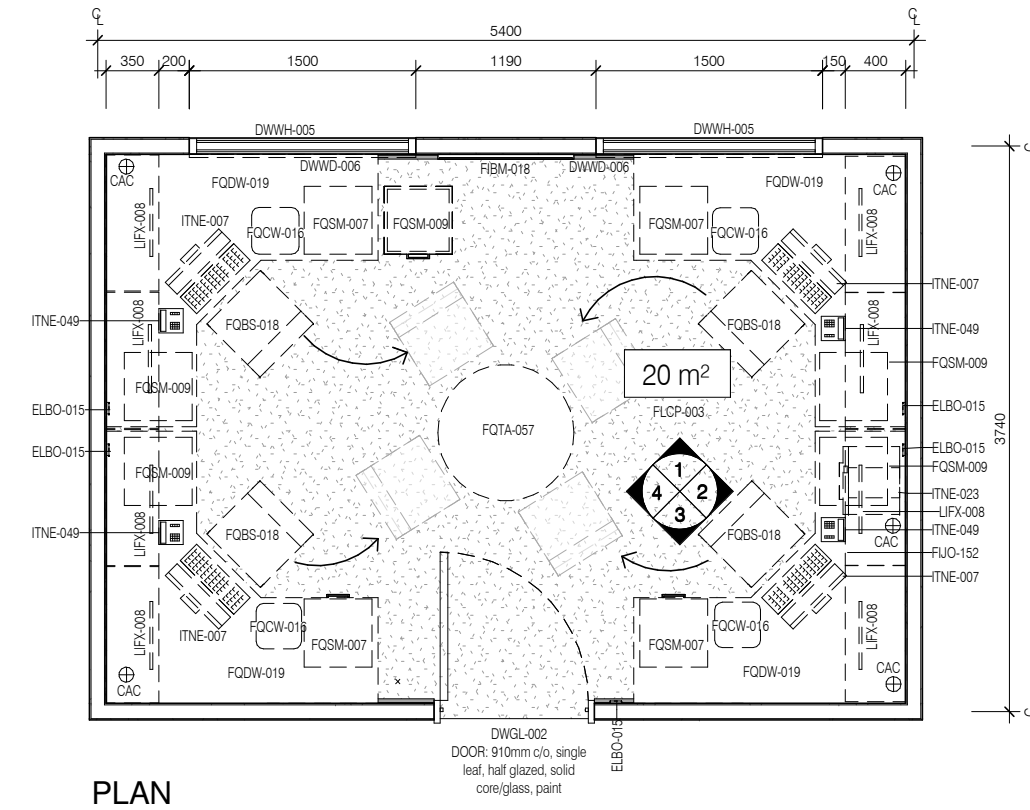

REV	DESCRIPTION	DATE
6	Coding and naming updated	20.03.2017

FOR GUIDANCE

SCALE	RLS Room Code	REV
1 : 50 @ A3	OFF-4P	6