

AUSTRALASIAN HFG STANDARD COMPONENTS

Room Layout Sheet

RLS Room Code: OFF-CLN

Room Name:

OFFICE - CLINICAL WORKROOM

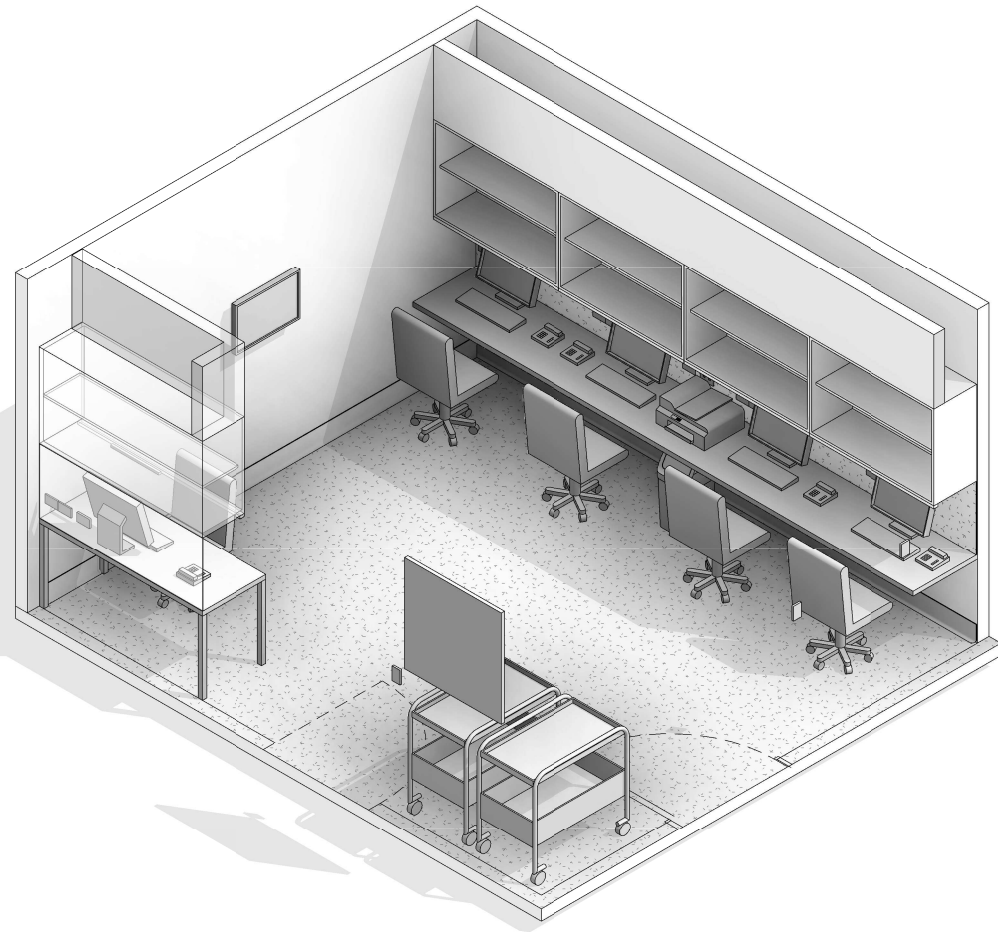

CODE	DESCRIPTION
DWOB-002	OBSERVATION: internal window, alum/glass, door height, powdercoat
DWPR-002	DOOR PROTECTION: kickplate, to 300 AFFL, composite, prefinished
ELBO-015	SWITCH: light, single
ELGP-208	GPO: double, wall mounted
FIBM-013	NOTICEBOARD: fixed, fabric covered
FIBM-019	WHITEBOARD: fixed, magnetic
FIHR-006	BRACKET: for display screen, wall mounted
FJO-020	BENCH: 600D, open under, laminate finish
FJO-152	CUPBOARD: wall mount, shelf unit, adj shelves
FLCP-006	FLOOR FINISH: carpet, carpet tiles, 90/10 wool/nylon
FLSK-009	SKIRTING: vinyl, feather edged, 150H, prefinished
FQBS-018	CHAIR: office, ergonomic
FQCW-016	BIN: waste, general, 20L
ITBU-013	DISPLAY SCREEN: patient flow system
ITIN-016	OUTLET: data, single RJ45, wall mounted
ITIN-026	OUTLET: data, double RJ45, wall mounted
ITNE-007	COMPUTER: desktop, with display screen
ITNE-023	PRINTER: networked
ITNE-049	TELEPHONE: handset, desktop
LIFX-008	LIGHT: task light, built in
MMGE-129	TROLLEY: medical records
WLWA-004	WALL FINISH: paint, acrylic, washable

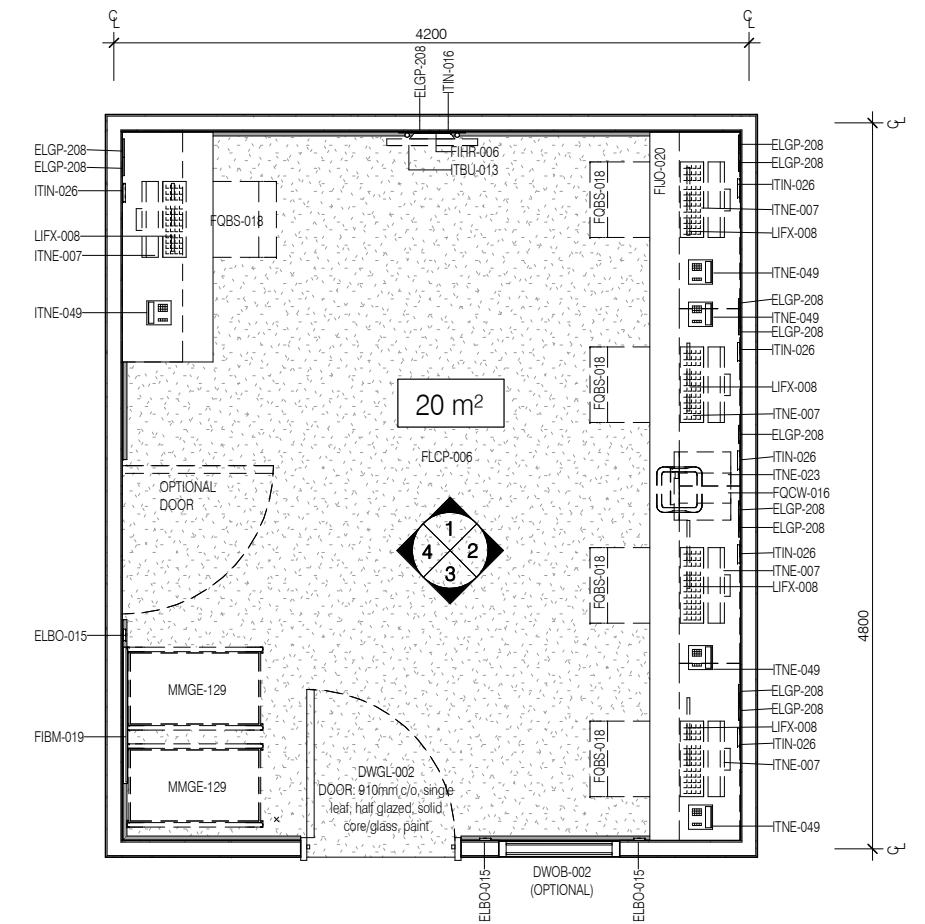

PLAN

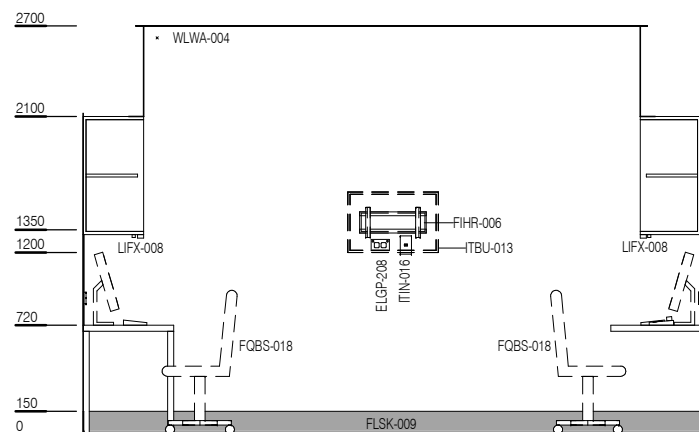

ELEVATION 1

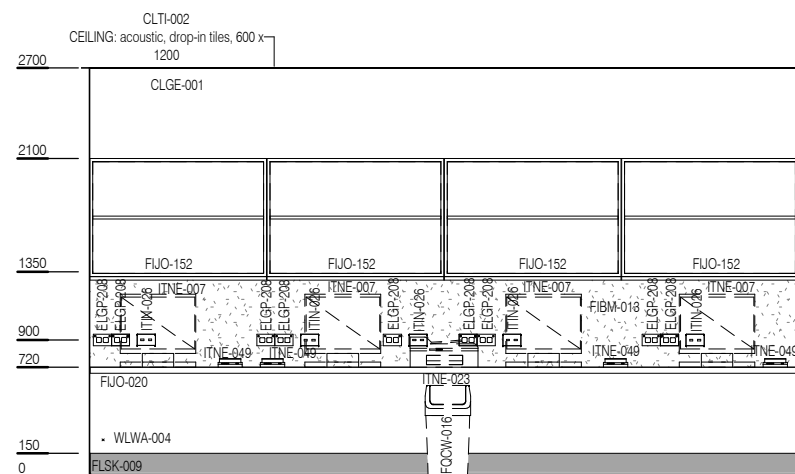

ELEVATION 2

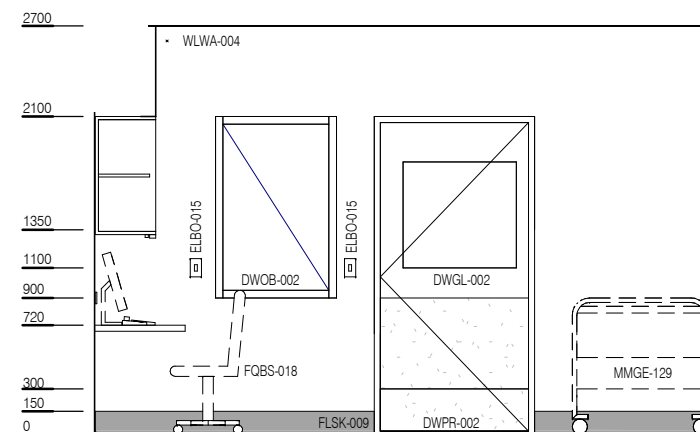

ELEVATION 3

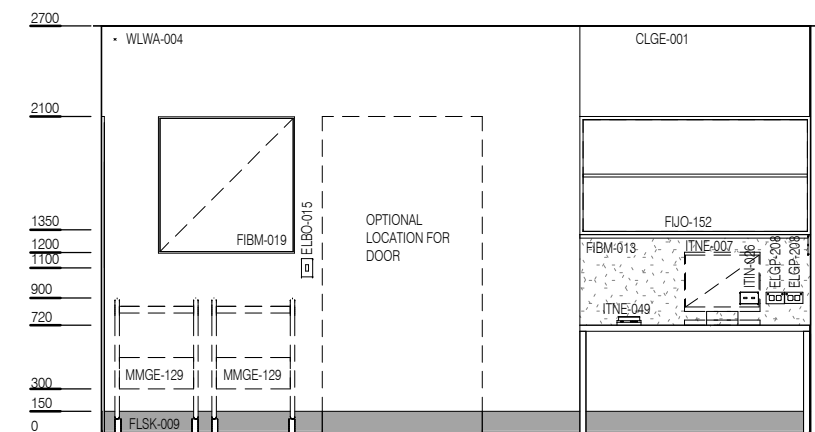

ELEVATION 4



REV	DESCRIPTION	DATE
5	Coding and naming updated	20.03.2017

FOR GUIDANCE

SCALE	RLS Room Code	REV
1 : 50 @ A3	OFF-CLN	5