

AUSTRALASIAN HFG STANDARD COMPONENTS

Room Layout Sheet

RLS Room Code: **PBTR-AS**

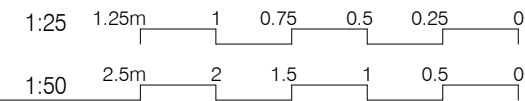

Room Name: **PATIENT ROOM, EMERGENCY - ACUTE TREATMENT SPECIAL**

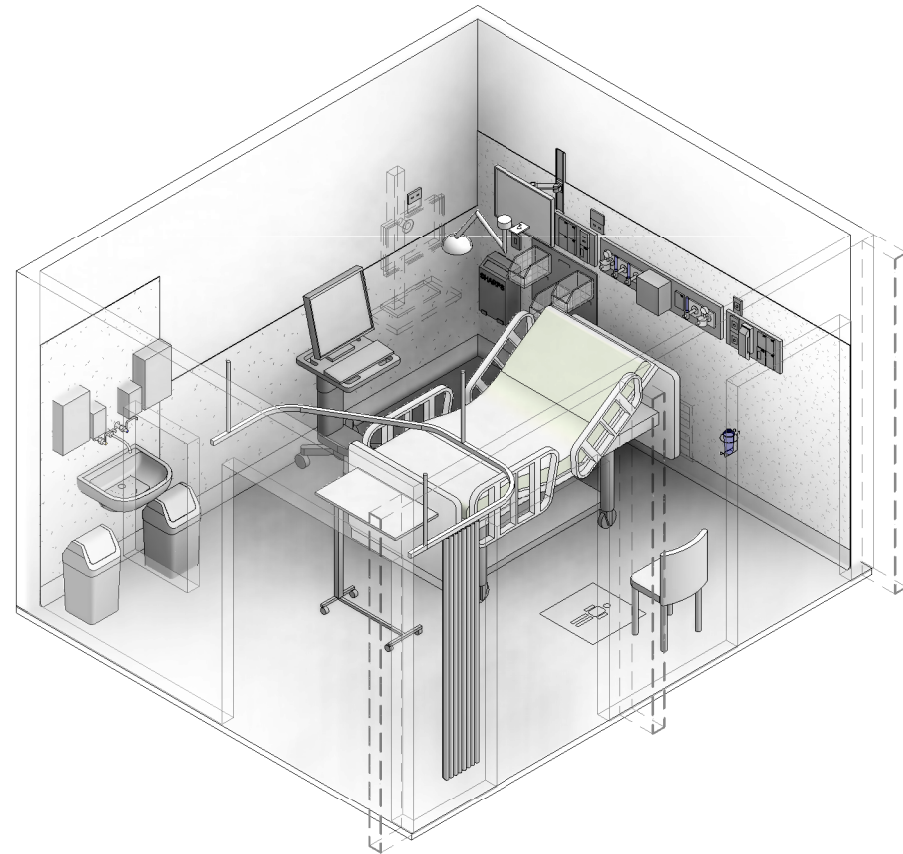

CODE	DESCRIPTION
DWOB-006	OBSERVATION: internal window, alum/safety glass, double glazed, integral venetian blind, powdercoat
DWPR-005	DOOR PROTECTION: protection plate to 900 AFFL
DWWD-007	BLIND: venetian, integral
ELBO-012	SWITCH: light, dimmer
ELGP-110	GPO: single, wall mounted, cleaner
ELGP-122.1	GPO: emergency power, single, on services panel (V)
ELGP-123	GPO: emergency power, single, wall mounted
ELGP-125	GPO: emergency power, single, ceiling mounted
ELGP-223	GPO: emergency power, double, wall mounted
ELPR-001	BODY PROTECTED ELECTRICAL AREA
ELPR-006	RCD: residual current device
FIDI-001	DISPENSER: alcohol based hand rub
FIDI-014	DISPENSER: disposable glove
FIDI-025	DISPENSER: paper/hand towel
FIDI-030	DISPENSER: soap
FIDI-031	DISPENSER: soap antiseptic
FIHR-016	BRACKET: for sharps bin
FIHR-019	BRACKET: for suction bottle
FIHR-033	PANEL: for storage bins, wall mount
FIHR-063	BRACKET: for all-in-one computer, with keyboard shelf, wall mounted
FIHR-067	BRACKET: for monitor, wall mounted, articulated, adj height
FIRT-041	TRACK: curtain, privacy, U shaped, angled
FLSK-010	SKIRTING: vinyl, floor vinyl covered, 150H, prefinished
FLVY-007	FLOOR FINISH: vinyl, seamless, coved, standard slip resistant
FQBS-030	CHAIR: visitor, patient
FQCW-005	BIN: waste, clinical, 20L
FQCW-016	BIN: waste, general, 20L
FQCW-044	BIN: waste, sharps, wall mounted
FQGE-010	CURTAIN: privacy screen
FQSN-006	BIN: storage bins, for wall mounted panel
FQTA-013	TABLE: overbed
HYBA-010	BASIN: handwash, Type B
HYTP-037	TAPWARE: mixer, elbow levers
ITCL-004	BUTTON: nurse call, emergency
ITCL-006	BUTTON: nurse call, patient to staff
ITCL-008	BUTTON: nurse call, staff assist
ITCL-028	HANDSET: nurse call, with patient to staff call button
ITIN-025	OUTLET: data, double RJ45, on services panel
ITIN-026	OUTLET: data, double RJ45, wall mounted
ITNE-008	COMPUTER: for workstation on wheels
ITNE-066	COMPUTER: all-in-one, wall mounted
ITNE-067	KEYBOARD: keyboard and mouse only
LIFX-013	LIGHT: procedure, ceiling mounted, small
MEEX-008	EXHAUST: low level
MGAS-022	OUTLET: medical air (MA), on services panel
MGAS-042	OUTLET: oxygen (O2), on services panel
MGAS-062	OUTLET: suction, on services panel
MGFP-002	FLOWMETER: medical air
MGFP-004	FLOWMETER: oxygen
MMBE-011	BED: patient, emergency, electric
MMGE-002	ADAPTER: suction
MMGE-031	DIAGNOSTIC SET: wall mounted
MMGE-100	SUCTION BOTTLE
MMGE-164	WORKSTATION ON WHEELS: clinical, mobile
MMHA-005	MONITOR: patient, cardiac
MMSP-026	SERVICES PANEL: wall mounted
WLPR-002	WALL PROTECTION: bed protection wall panel, composite, laminate finish
WLWA-004	WALL FINISH: paint, acrylic, washable
WLWA-010	WALL FINISH: splashback, vinyl
WLWA-025	WALL FINISH: vinyl, to 1200 AFFL

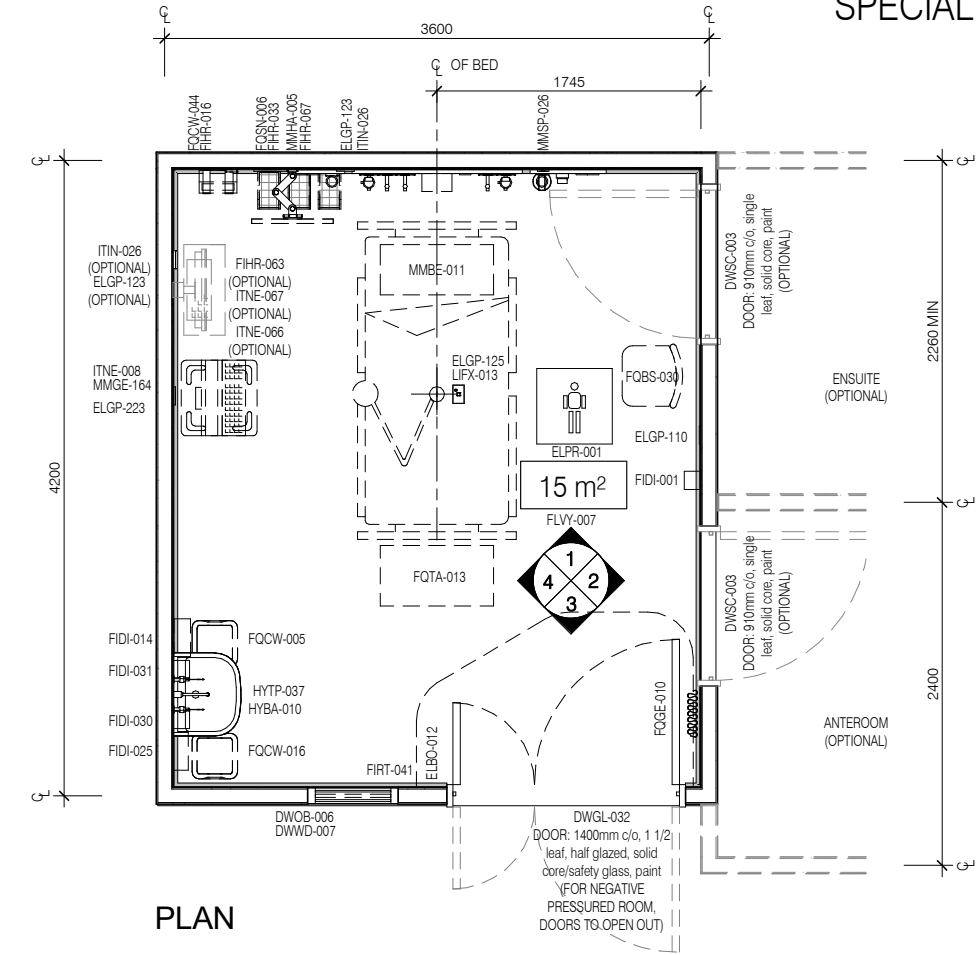

PLAN

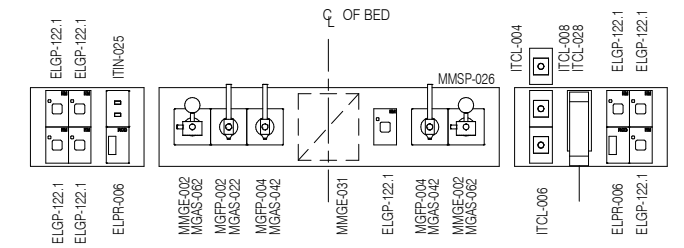

ELEVATION 5 (1 : 25 @ A3)

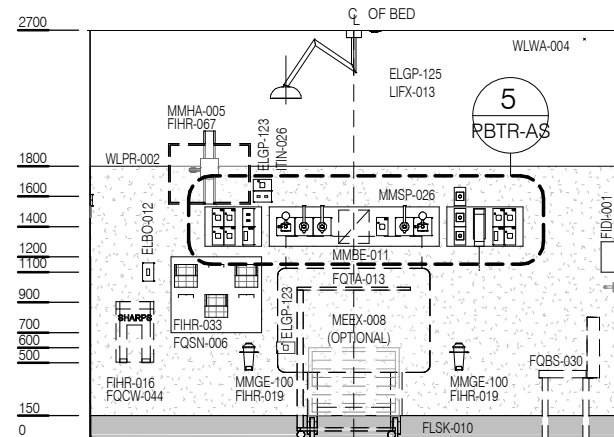

ELEVATION 1

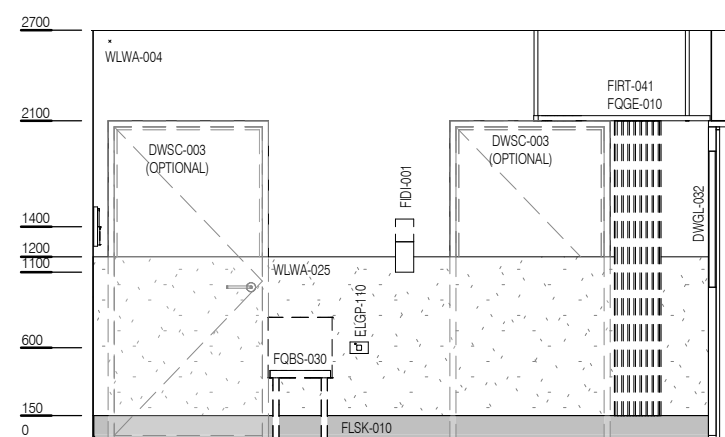

ELEVATION 2

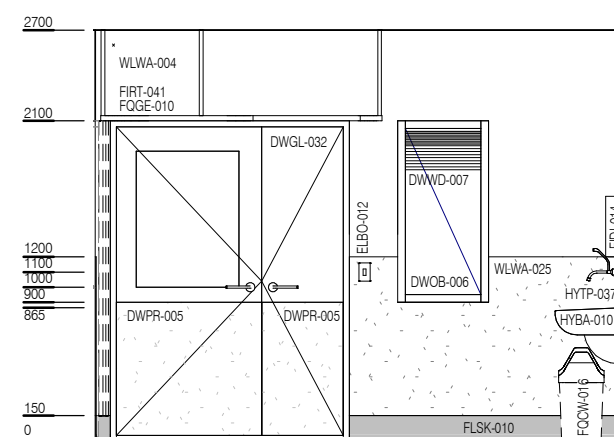

ELEVATION 3

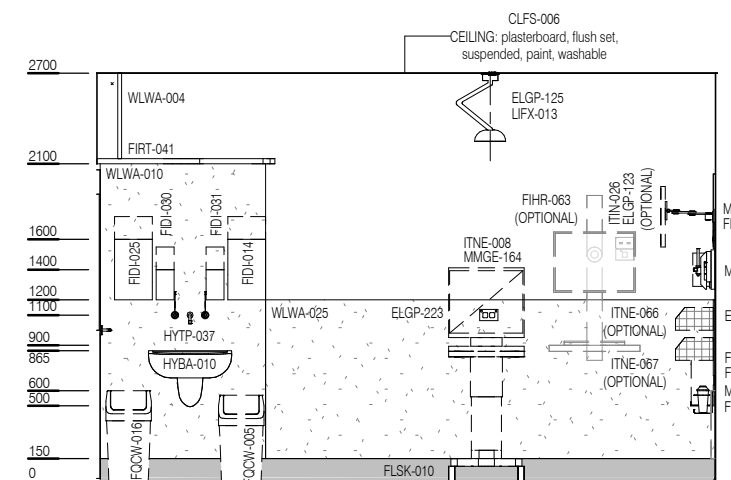

ELEVATION 4



REV	DESCRIPTION	DATE
1	First Issue	29.05.2019

FOR GUIDANCE

SCALE	RLS Room Code	REV
1 : 50 @ A3	PBTR-AS	1