

AUSTRALASIAN HFG STANDARD COMPONENTS

Room Layout Sheet

RLS Room Code: **PREP**

Room Name: **PREPARATION ROOM - NON STERILE (PHARMACY)**

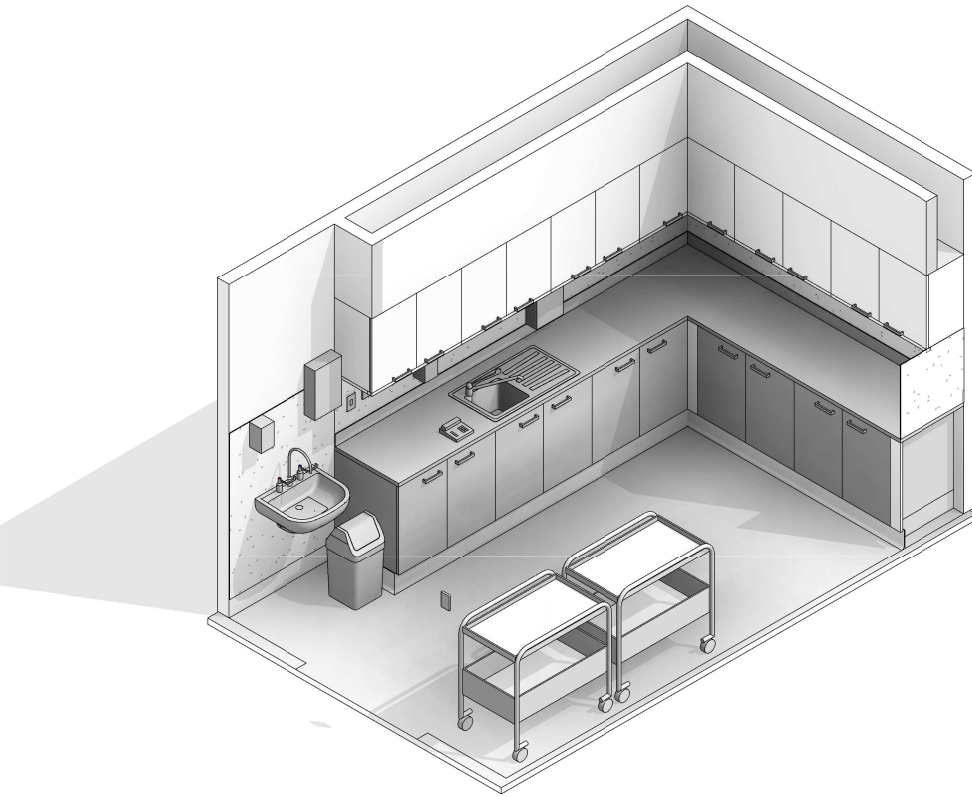
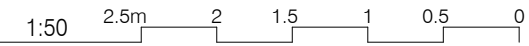

| CODE | DESCRIPTION |
|----------|---|
| ELBO-015 | SWITCH: light, single |
| ELGP-208 | GPO: double, wall mounted |
| FIDI-025 | DISPENSER: paper/hand towel |
| FIDI-030 | DISPENSER: soap |
| FJO-059 | BENCH TOP: 600D, joinery under, laminate finish |
| FJO-136 | CUPBOARD: underbench, double door, adj shelves, lockable |
| FJO-145 | CUPBOARD: wall mount, double door, adj shelves, lockable |
| FJO-157 | CUPBOARD: wall mount, single door, adj shelves, lockable |
| FLSK-010 | SKIRTING: vinyl, floor vinyl coved, 150H, prefinished |
| FLVY-007 | FLOOR FINISH: vinyl, seamless, coved, standard slip resistant |
| FQCW-016 | BIN: waste, general, 20L |
| FQSM-016 | TROLLEY |
| HYBA-010 | BASIN: handwash, Type B |
| HYBA-071 | SINK: single, with drainer, 930mmL, right bowl |
| HYTP-037 | TAPWARE: mixer, elbow levers |
| HYTP-040 | TAPWARE: mixer, sink, accessible |
| ITIN-026 | OUTLET: data, double RJ45, wall mounted |
| ITNE-049 | TELEPHONE: handset, desktop |
| LIFX-008 | LIGHT: task light, built in |
| WLPR-012 | WALL PROTECTION: corner guards, to 900 AFFL, prefinished PVC |
| WLWA-004 | WALL FINISH: paint, acrylic, washable |
| WLWA-010 | WALL FINISH: splashback, vinyl |

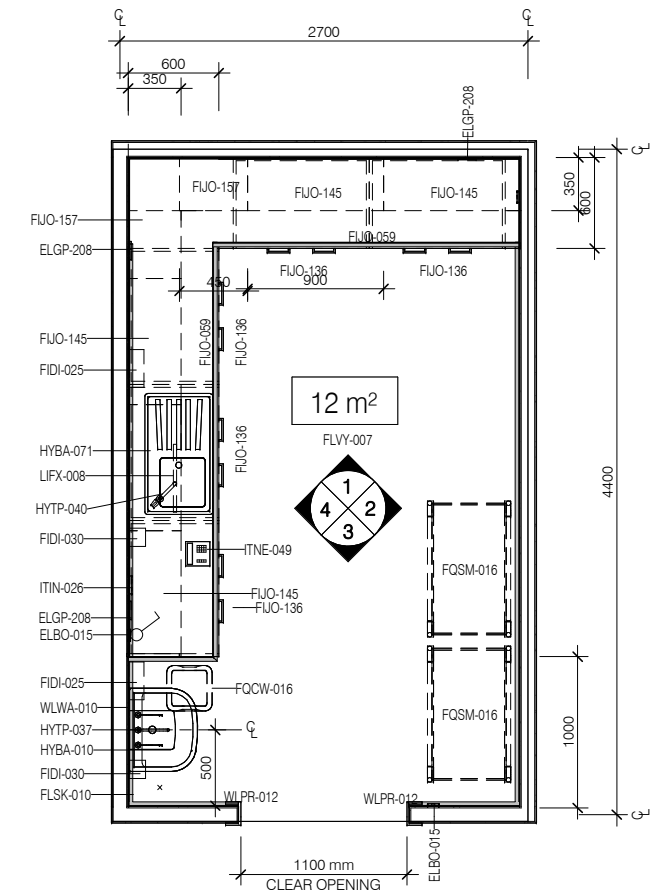

PLAN

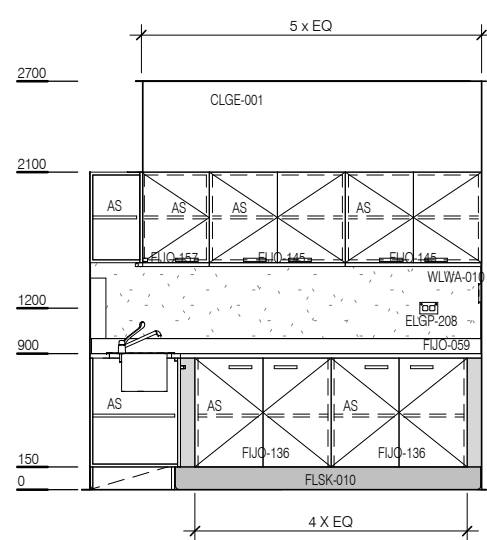

ELEVATION 1

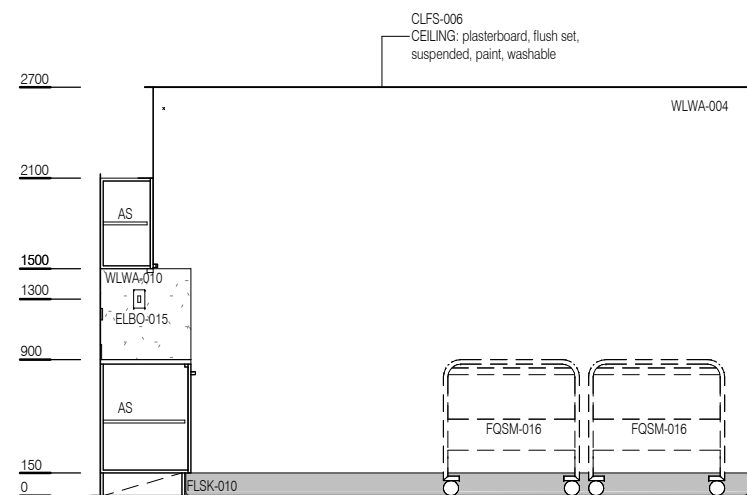

ELEVATION 2

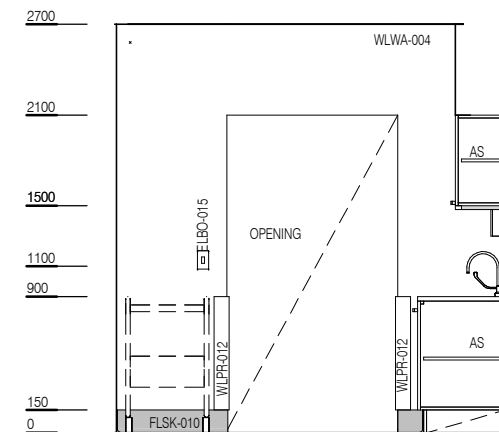

ELEVATION 3

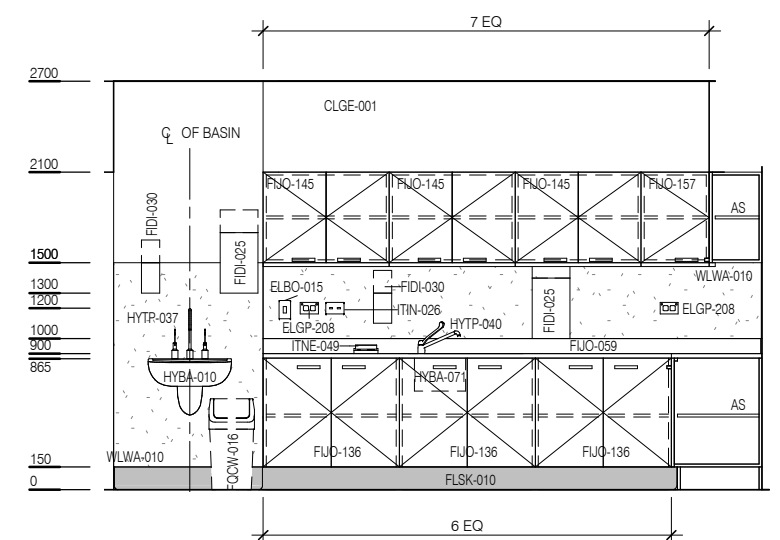

ELEVATION 4



| REV | DESCRIPTION | DATE |
|-----|---------------------------|------------|
| 3 | Coding and naming updated | 20.03.2017 |

FOR GUIDANCE

| SCALE | RLS Room Code | REV |
|-------------|---------------|-----|
| 1 : 50 @ A3 | PREP | 3 |