

AUSTRALASIAN HFG STANDARD COMPONENTS

Room Layout Sheet

RLS Room Code: **PROC-20**

Room Name:

PROCEDURE ROOM, 20m²

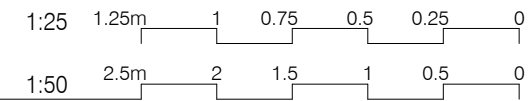

CODE	DESCRIPTION
CLGE-001	CEILING: plasterboard, bulkhead, paint
DWPR-005	DOOR PROTECTION: protection plate to 900 AFFL
DWPR-006	DOOR PROTECTION: protection plate, to 900 AFFL, PVC, prefinished
DWPR-010	DOOR PROTECTION: to door frame, PVC, prefinished
DWWD-003	BLIND: integral
DWWH-005	WINDOW
ELBO-015	SWITCH: light, single
ELGP-105	GPO: single, on services panel
ELGP-109	GPO: single, wall mounted
ELGP-109.1	GPO: single, wall mounted (V)
ELGP-122.1	GPO: emergency power, single, on services panel (V)
ELGP-123.1	GPO: emergency power, single, wall mounted (V)
ELGP-208	GPO: double, wall mounted
ELPR-001	BODY PROTECTED ELECTRICAL AREA
FIDI-001	DISPENSER: alcohol based hand rub
FIDI-014	DISPENSER: disposable glove
FIDI-022	DISPENSER: moisturiser
FIDI-025	DISPENSER: paper/hand towel
FIDI-030	DISPENSER: soap
FIDI-031	DISPENSER: soap antiseptic
FIHR-011	BRACKET: for monitor
FIHR-016	BRACKET: for sharps bin
FIHR-019	BRACKET: for suction bottle
FUO-059	BENCH TOP: 600D, joinery under, laminate finish
FUO-116	CUPBOARD: tall, double door, adj shelves
FUO-136	CUPBOARD: underbench, double door, adj shelves, lockable
FUO-145	CUPBOARD: wall mount, double door, adj shelves, lockable
FIRT-026	TRACK: curtain, bedscreen, Z shape
FLSK-010	SKIRTING: vinyl, floor vinyl coved, 150H, prefinished
FLVY-004	FLOOR FINISH: vinyl, seamless, coved, non-slip, safety
FLVY-007	FLOOR FINISH: vinyl, seamless, coved, standard slip resistant
FOBS-052	STOOL: mobile, high, adj height

CODE	DESCRIPTION
FQCW-016	BIN: waste, general, 20L
FQCW-044	BIN: waste, sharps, wall mounted
FQGE-009	CURTAIN: bed screen
HYBA-009	BASIN: handwash, Type A, scrub
HYTP-037	TAPWARE: mixer, elbow levers
ITCL-014	CLOCK: analogue, electric
ITCL-028	HANDSET: nurse call, with patient to staff call button
ITIN-016	OUTLET: data, single RJ45, wall mounted
ITIN-025	OUTLET: data, double RJ45, on services panel
ITIN-026	OUTLET: data, double RJ45, wall mounted
ITNE-007	COMPUTER: desktop, with display screen
ITNE-050	TELEPHONE: handset, desktop, handsfree
ITSE-006	BUTTON: duress, fixed
LIFX-013	LIGHT: procedure, ceiling mounted, small
MGAS-022	OUTLET: medical air (MA), on services panel
MGAS-032	OUTLET: nitrous oxide (N ₂ O), on services panel
MGAS-042	OUTLET: oxygen (O ₂), on services panel
MGAS-053	OUTLET: scavenge, on services panel
MGAS-062	OUTLET: suction, on services panel
MGFP-002	FLOWMETER: medical air
MGFP-004	FLOWMETER: oxygen
MMBE-010	BED: patient, electric with mattress
MMGE-001	ADAPTER: scavenge
MMGE-002	ADAPTER: suction
MMGE-100	SUCTION BOTTLE
MMGE-119	TROLLEY: equipment
MMHA-008	MONITOR: patient, cardiac with vital signs
MMSP-026	SERVICES PANEL: wall mounted
WLPR-001	WALL PROTECTION: bed protection wall panel
WLWA-004	WALL FINISH: paint, acrylic, washable
WLWA-007	WALL FINISH: splashback

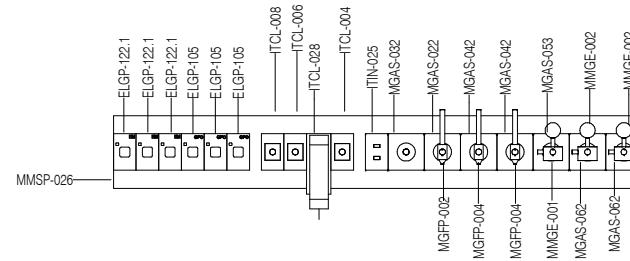

ELEVATION 5 (1 : 25 @ A3)

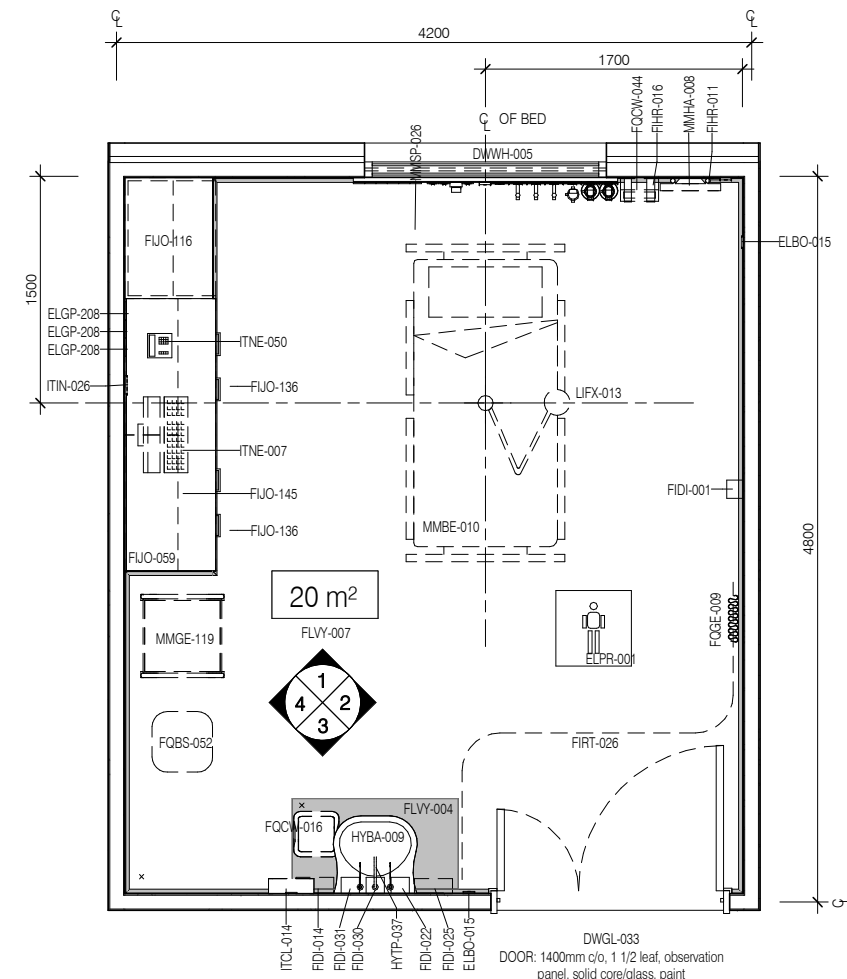

PLAN

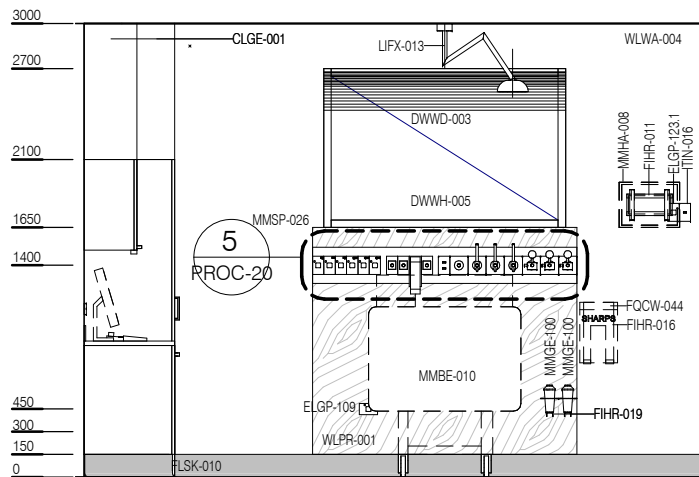

ELEVATION 1

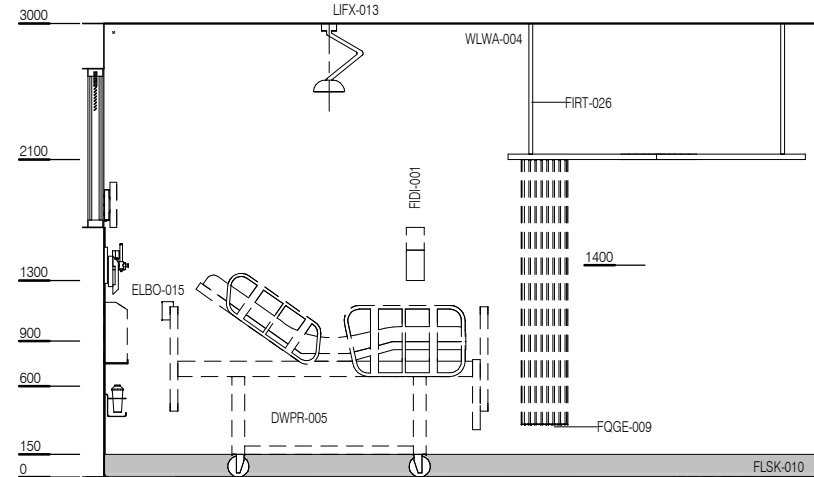

ELEVATION 2

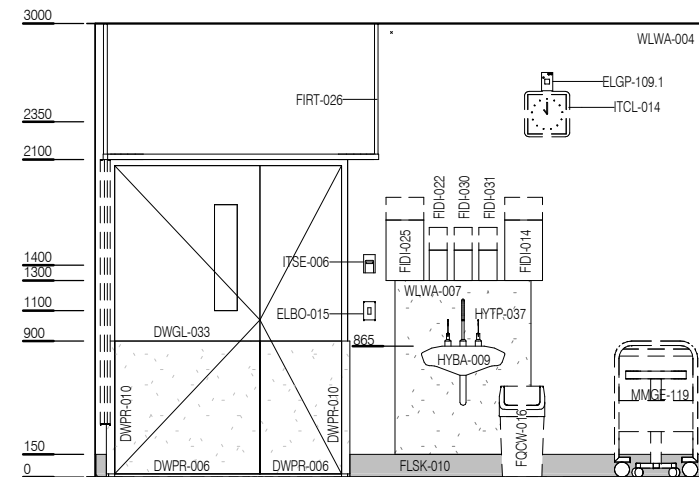

ELEVATION 3

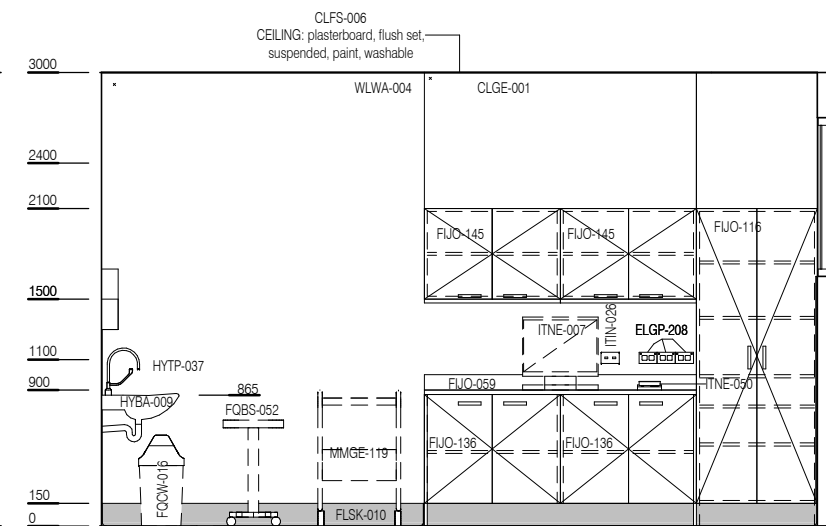

ELEVATION 4



REV	DESCRIPTION	DATE
5	Coding and naming updated	20.03.2017

FOR GUIDANCE

SCALE	RLS Room Code	REV
1 : 50 @ A3	PROC-20	5