

AUSTRALASIAN HFG STANDARD COMPONENTS

Room Layout Sheet

RLS Room Code: PROC

Room Name:

PROCEDURE ROOM

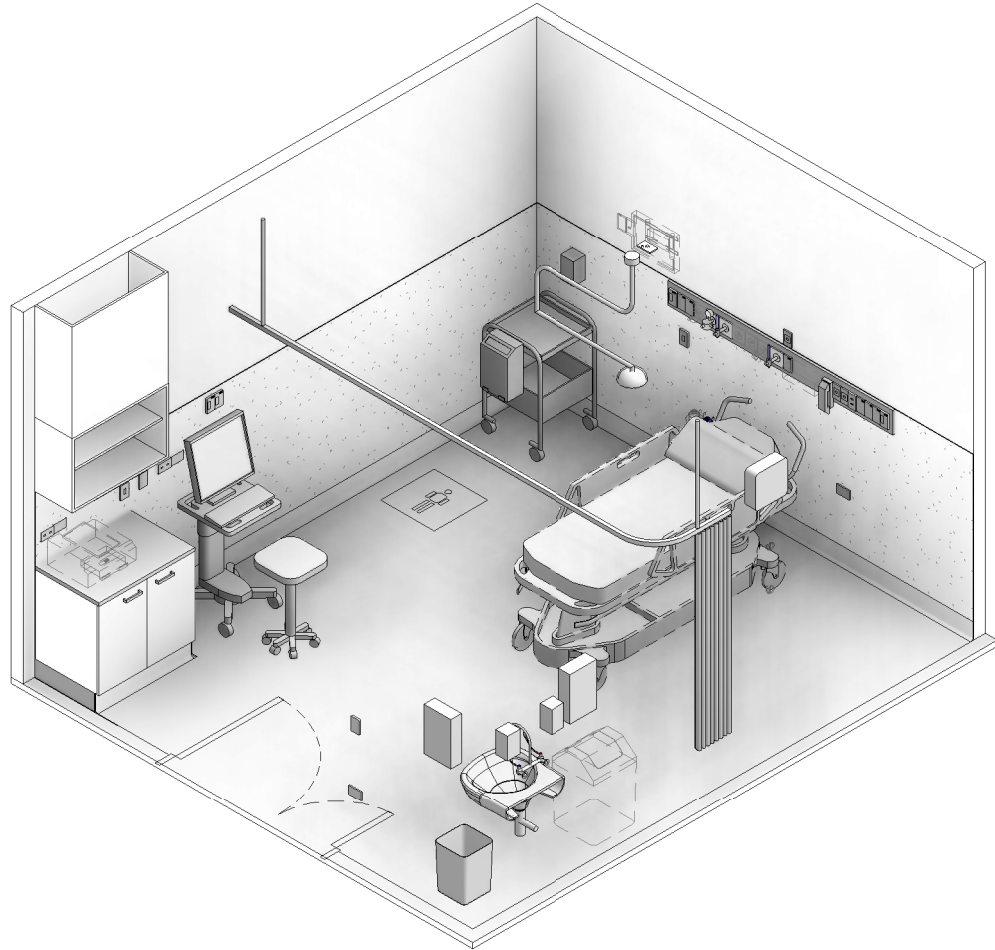
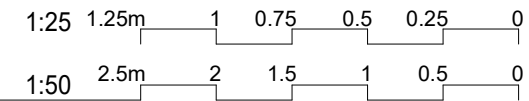

CODE	DESCRIPTION
DWPR-006	DOOR PROTECTION: protection plate, to 900 AFFL, PVC, prefinished
ELBO-015	SWITCH: light, single
ELGP-101	GPO: single, ceiling mounted
ELGP-105	GPO: single, on services panel
ELGP-109	GPO: single, wall mounted
ELGP-110	GPO: single, wall mounted, cleaner
ELGP-122.1	GPO: emergency power, single, on services panel (V)
ELGP-123.1	GPO: emergency power, single, wall mounted (V)
ELGP-208	GPO: double, wall mounted
ELPR-001	BODY PROTECTED ELECTRICAL AREA
ELPR-006	RCD: residual current device
FIDI-001	DISPENSER: alcohol based hand rub
FIDI-014	DISPENSER: disposable glove
FIDI-025	DISPENSER: paper/hand towel
FIDI-030	DISPENSER: soap
FIDI-031	DISPENSER: soap antiseptic
FIHR-011	BRACKET: for monitor, wall mounted
FIHR-016	BRACKET: for sharps bin
FIHR-019	BRACKET: for suction bottle
FIHR-026	HOOK: coat
FIJO-059	BENCH TOP: 600D, joinery under, laminate finish
FIJO-135	CUPBOARD: underbench, double door, adj shelves
FIJO-152	CUPBOARD: wall mount, shelf unit, adj shelves
FIJO-212	BULKHEAD: joinery
FIRT-032	TRACK: curtain, privacy, L shaped
FLSK-010	SKIRTING: vinyl, floor vinyl coved, 150H, prefinished
FLVY-007	FLOOR FINISH: vinyl, seamless, coved, standard slip resistant
FQBS-052	STOOL: mobile, high, adj height
FQCW-008	BIN: waste, clinical, 50L
FQCW-016	BIN: waste, general, 20L
FQCW-043	BIN: waste, sharps, on trolley
FOGE-010	CURTAIN: privacy screen

CODE	DESCRIPTION
HYBA-009	BASIN: handwash, Type A, scrub
HYTP-037	TAPWARE: mixer, elbow levers
ITCL-004	BUTTON: nurse call, emergency
ITCL-006	BUTTON: nurse call, patient to staff
ITCL-008	BUTTON: nurse call, staff assist
ITCL-014	CLOCK: analogue, electric
ITCL-028	HANDSET: nurse call, with patient to staff call button
ITIN-016	OUTLET: data, single RJ45, wall mounted
ITIN-025	OUTLET: data, double RJ45, on services panel
ITIN-026	OUTLET: data, double RJ45, wall mounted
ITNE-008	COMPUTER: for workstation on wheels
ITNE-023	PRINTER: networked
ITNE-053	TELEPHONE: handset, wall mount, handsfree
ITSE-006	BUTTON: duress, fixed
LIFX-008	LIGHT: task light, built in
LIFX-013	LIGHT: procedure, ceiling mounted, small
MGAS-022	OUTLET: medical air (MA), on services panel
MGAS-032	OUTLET: nitrous oxide (N2O), on services panel
MGAS-042	OUTLET: oxygen (O2), on services panel
MGAS-053	OUTLET: scavenge, on services panel
MGAS-062	OUTLET: suction, on services panel
MGFP-002	FLOWMETER: medical air
MGFP-004	FLOWMETER: oxygen
MMBE-043	TROLLEY: patient, examination
MMGE-002	ADAPTER: suction
MMGE-031	DIAGNOSTIC SET: wall mounted
MMGE-100	SUCTION BOTTLE
MMGE-119	TROLLEY: equipment
MMGE-164	WORKSTATION ON WHEELS: clinical, mobile
MMHA-008	MONITOR: patient, cardiac with vital signs
MMSP-026	SERVICES PANEL: wall mounted
WLWA-004	WALL FINISH: paint, acrylic, washable
WLWA-007	WALL FINISH: splashback
WLWA-020	WALL FINISH: vinyl, to 1500 AFFL

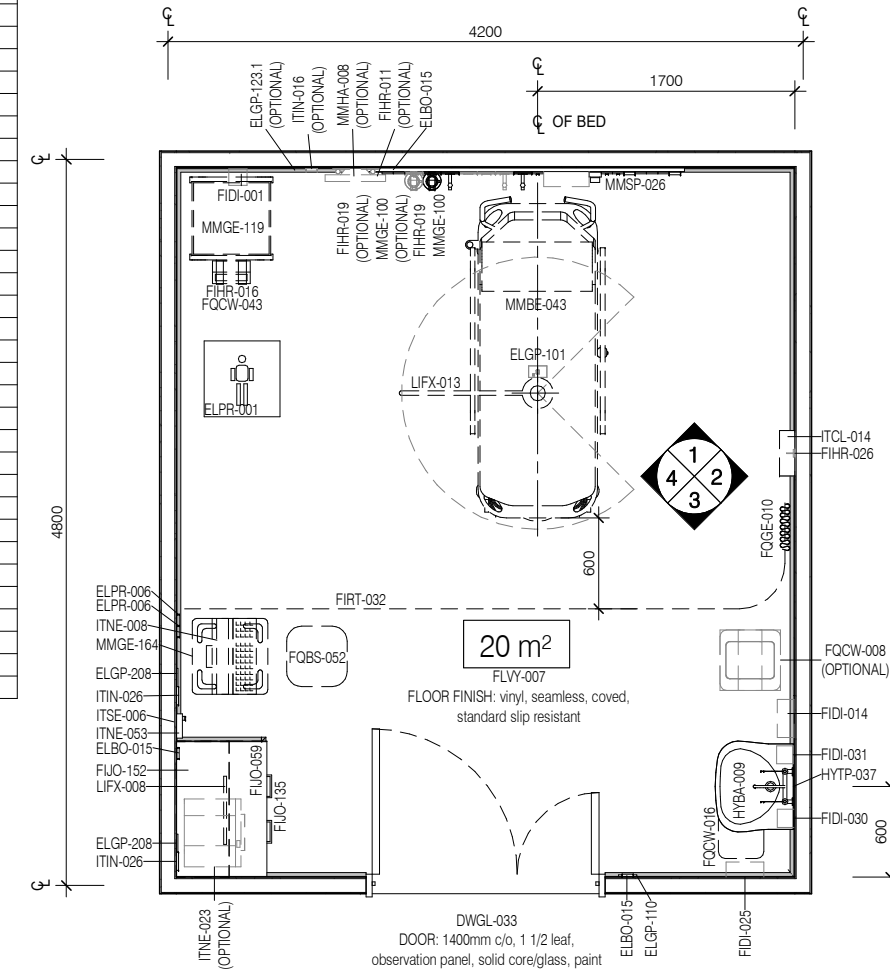

PLAN

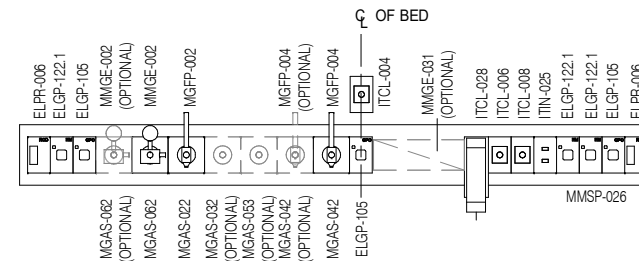

ELEVATION 5 (1 : 25 @ A3)

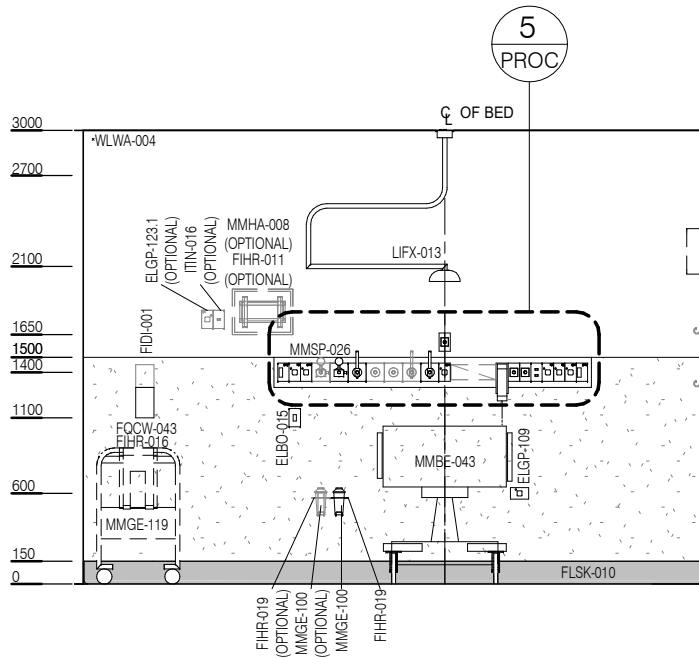

ELEVATION 1

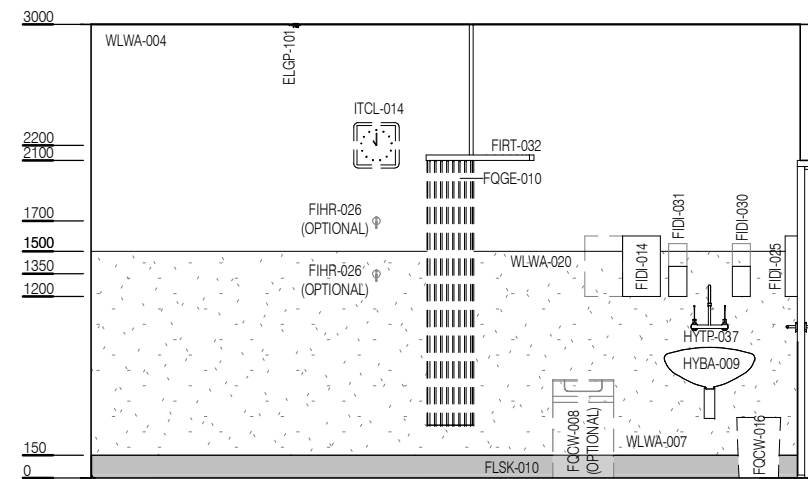

ELEVATION 2

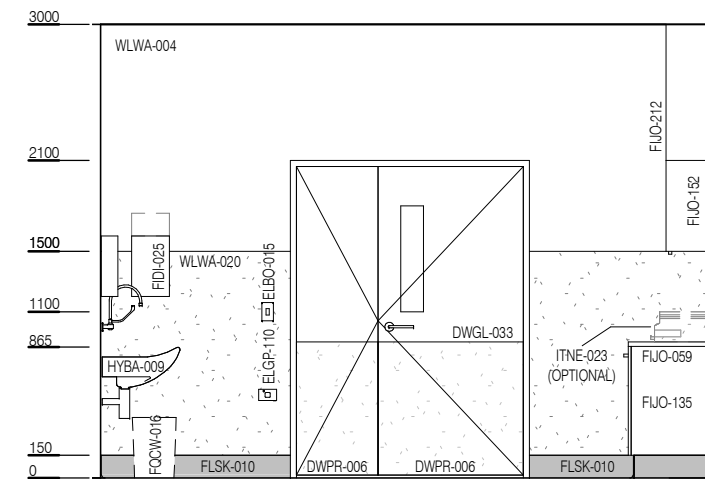

ELEVATION 3

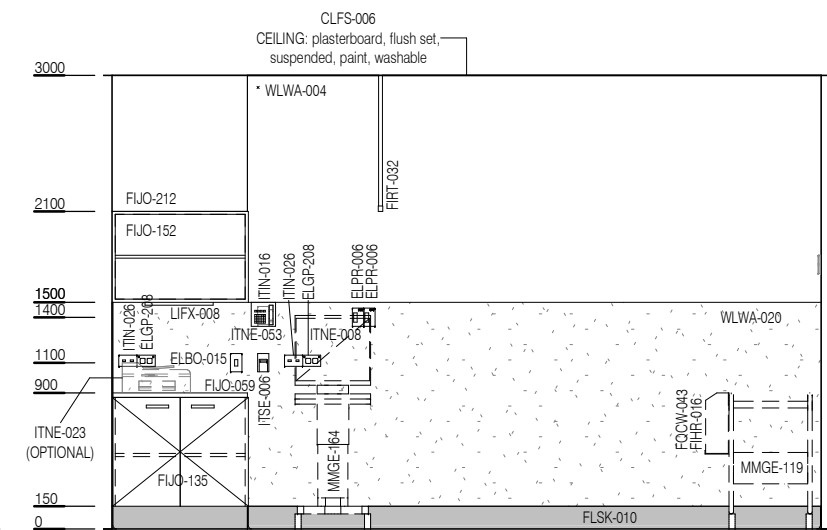

ELEVATION 4



REV	DESCRIPTION	DATE
6	General update following ERG review	18.01.2021

FOR GUIDANCE

SCALE	RLS Room Code	REV
1 : 50 @ A3	PROC	6