

AUSTRALASIAN HFG STANDARD COMPONENTS

Room Layout Sheet

RLS Room Code: PTB-E-ACU-E

Room Name: PATIENT BAY - EMERGENCY, ACUTE
TREATMENT, ENCLOSED

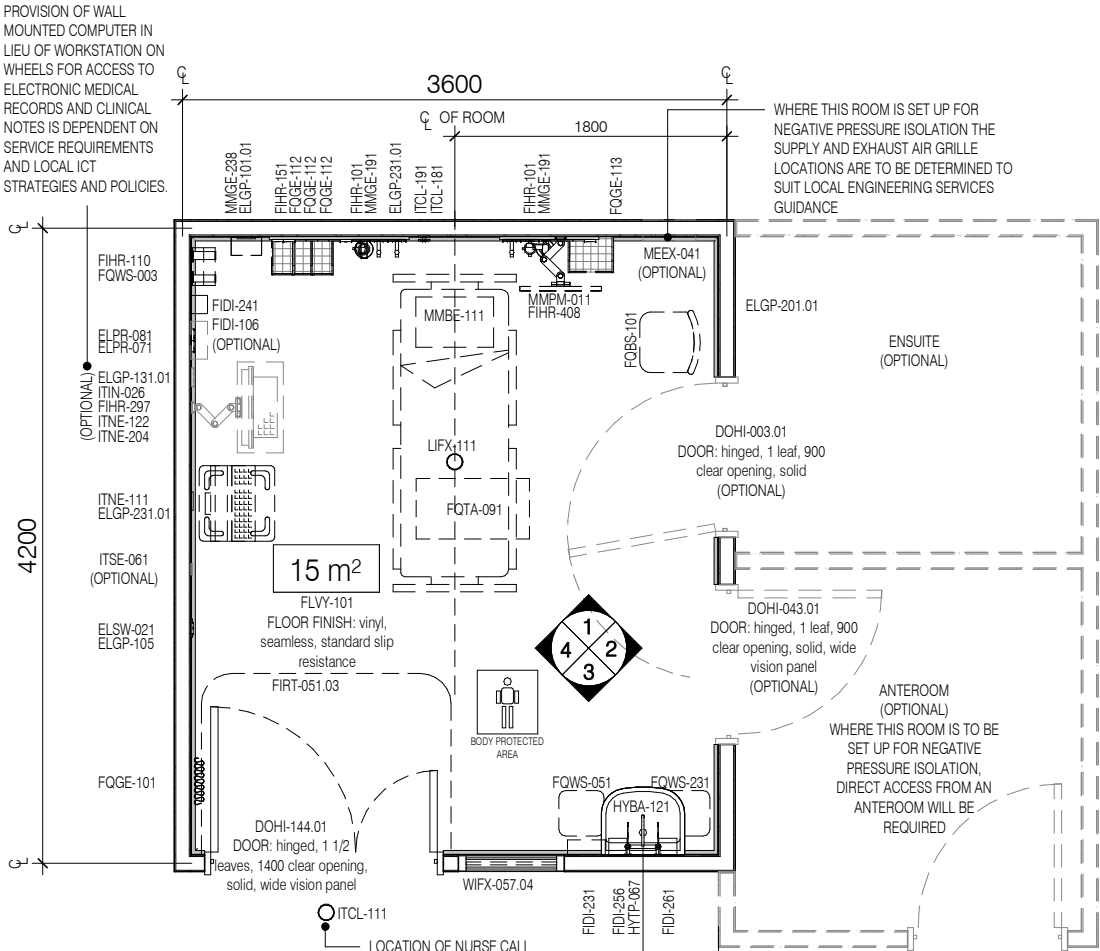

PLAN

CODE	DESCRIPTION
AFDPR-006.01	DOOR PROTECTION: plate, to 900 AFFL
AHWCV-006	WINDOW COVERING: blind, venetian
ELGP-101.01	GPO: single, wall mounted, horizontal
ELGP-105	GPO: single, wall mounted, cleaner
ELGP-131.01	GPO: single, emergency power, wall mounted, horizontal
ELGP-146	GPO: single, emergency power, on service panel
ELGP-201.01	GPO: double, wall mounted, horizontal
ELGP-231.01	GPO: double, emergency power, wall mounted, horizontal
ELPR-071	RCD: residual current device, wall mounted
ELPR-073	RCD: residual current device, on services panel
ELPR-081	RCD: residual current device, emergency power, wall mounted
ELSW-001	SWITCH: light
ELSW-021	SWITCH: light, dimmer
FIDI-106	DISPENSER: PPE, disposable gloves, wall mounted
FIDI-231	DISPENSER: paper towel, wall mounted
FIDI-241	DISPENSER: alcohol-based hand rub, wall mounted
FIDI-256	DISPENSER: soap, wall mounted
FIDI-261	DISPENSER: soap, antiseptic, wall mounted
FIHR-101	BRACKET: suction bottle, wall mounted
FIHR-110	BRACKET: sharps bin, wall mounted
FIHR-151	PANEL: storage baskets, wall mounted
FIHR-161	BRACKET: wire storage basket, wall mounted
FIHR-297	BRACKET: combined single screen all-in-one computer, keyboard and mouse, height adjustable, wall mounted
FIHR-408	BRACKET: patient monitor, articulated, wall mounted
FIRT-051.03	TRACK: curtain, privacy, U-shaped
FLSK-021	SKIRTING: vinyl, integral with floor vinyl, coved
FLVY-101	FLOOR FINISH: vinyl, seamless, standard slip resistance
FQBS-101	CHAIR: visitor, clinical areas
FQGE-101	CURTAIN: privacy screen
FQGE-112	BASKET: storage, for wall mounted panel, small
FQGE-113	BASKET: storage, for wall mounted panel, medium
FQTA-091	TABLE: overbed, mobile, height adjustable
FQWS-003	BIN: sharps, clinical, medium

CODE	DESCRIPTION
FQWS-051	BIN: general waste, 20L
FQWS-231	BIN: clinical waste, 20L
HYBA-121	BASIN: type B, handwashing
HYTP-067	TAPWARE: basin, tap set, wall mounted, lever handles
ITCL-133	BUTTON: patient to staff call, with cancel, with handset connection point, on services panel
ITCL-181	BUTTON: staff assist, with cancel, wall mounted
ITCL-191	BUTTON: emergency, with cancel, wall mounted
ITCL-251	HANDSET: patient to staff call
ITIN-025	OUTLET: data, double RJ45, on services panel
ITIN-026	OUTLET: data, double RJ45, wall mounted
ITNE-111	COMPUTER: workstation on wheels (WOW), medical grade, all-in-one computer, keyboard and mouse, on cart
ITNE-122	COMPUTER: single display screen, all-in-one, medical grade
ITNE-204	INPUT DEVICE: keyboard and mouse, wireless, medical grade, washable
ITSE-061	BUTTON: security, duress, fixed, wall mounted
LIFX-111	LIGHT: examination, ceiling recessed
MEEX-041	GRILLE: exhaust, wall mounted, low level
MGAS-022	OUTLET: medical air, on services panel
MGAS-042	OUTLET: oxygen (O2), on services panel
MGAS-062	OUTLET: suction, on services panel
MGFP-021	FLOWMETER: medical air
MGFP-041	FLOWMETER: oxygen
MGFP-061	ADAPTER: suction
MMBE-111	BED: patient, electric, with mattress, emergency
MMGE-191	CANNISTER: suction bottle
MMGE-238	DIAGNOSTIC SET: otoscope, ophthalmoscope and thermometer, wall mounted
MMPM-011	MONITOR: patient, medium acuity
MMSP-051	MEDICAL SERVICES PANEL: wall mounted
WIFX-057.04	WINDOW: fixed, internal, double glazed, sill at 900H, with integral blind
WLFI-002	WALL FINISH: paint, clinical areas
WLFI-011.04	WALL FINISH: vinyl, to 1500 AFFL
WLFI-101	SPLASHBACK: vinyl
WLPR-002	WALL PROTECTION: bedhead wall panel, low height

AUSTRALASIAN HFG STANDARD COMPONENTS

Room Layout Sheet

RLS Room Code: PTB-E-ACU-E

Room Name:

PATIENT BAY - EMERGENCY, ACUTE
TREATMENT, ENCLOSED

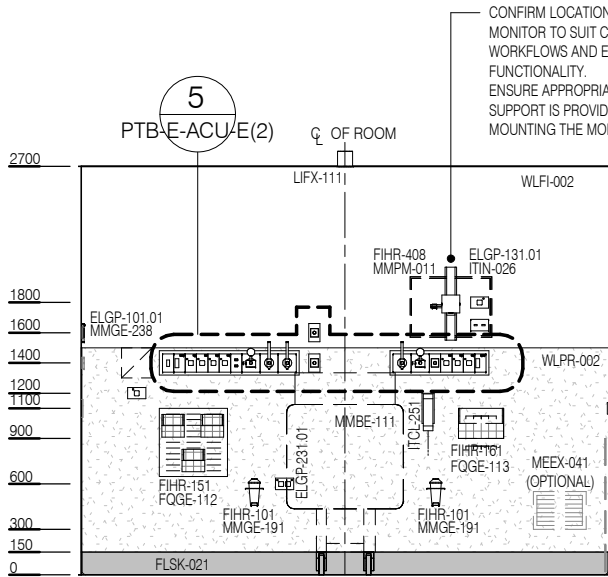
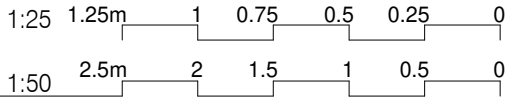

ELEVATION 1

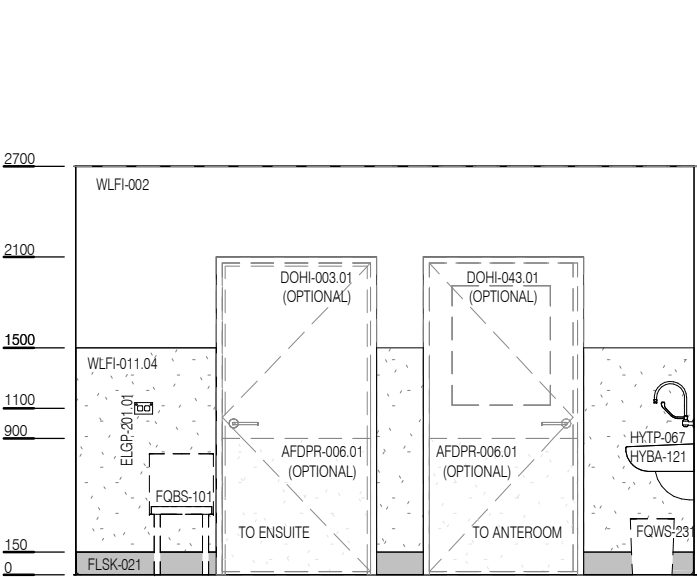

ELEVATION 2

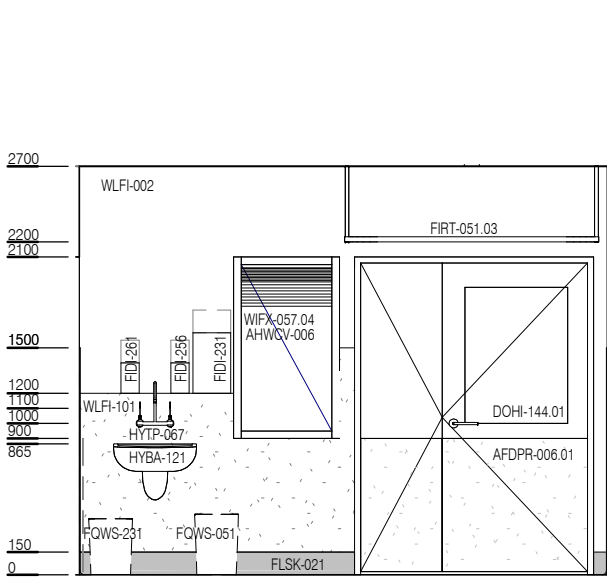

ELEVATION 3

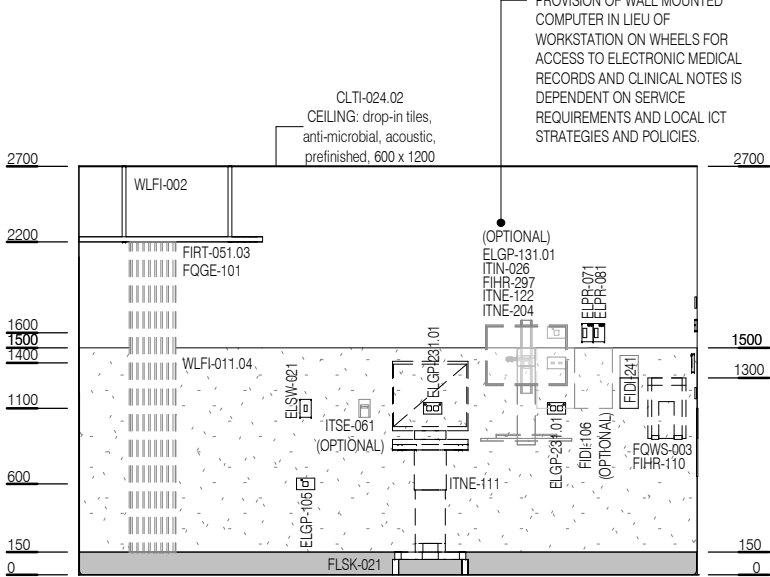

ELEVATION 4

CODE	DESCRIPTION
AFDPR-006.01	DOOR PROTECTION: plate, to 900 AFFL
AHWCV-006	WINDOW COVERING: blind, venetian
ELGP-101.01	GPO: single, wall mounted, horizontal
ELGP-105	GPO: single, wall mounted, cleaner
ELGP-131.01	GPO: single, emergency power, wall mounted, horizontal
ELGP-146	GPO: single, emergency power, on service panel
ELGP-201.01	GPO: double, wall mounted, horizontal
ELGP-231.01	GPO: double, emergency power, wall mounted, horizontal
ELPR-071	RCD: residual current device, wall mounted
ELPR-073	RCD: residual current device, on services panel
ELPR-081	RCD: residual current device, emergency power, wall mounted
ELSW-001	SWITCH: light
ELSW-021	SWITCH: light, dimmer
FIDI-106	DISPENSER: PPE, disposable gloves, wall mounted
FIDI-231	DISPENSER: paper towel, wall mounted
FIDI-241	DISPENSER: alcohol-based hand rub, wall mounted
FIDI-256	DISPENSER: soap, wall mounted
FIDI-261	DISPENSER: soap, antiseptic, wall mounted
FIHR-101	BRACKET: suction bottle, wall mounted
FIHR-110	BRACKET: sharps bin, wall mounted
FIHR-151	PANEL: storage baskets, wall mounted
FIHR-161	BRACKET: wire storage basket, wall mounted
FIHR-297	BRACKET: combined single screen all-in-one computer, keyboard and mouse, height adjustable, wall mounted
FIHR-408	BRACKET: patient monitor, articulated, wall mounted
FIRT-051.03	TRACK: curtain, privacy, U-shaped
FLSK-021	SKIRTING: vinyl, integral with floor vinyl, coved
FLVY-101	FLOOR FINISH: vinyl, seamless, standard slip resistance
FQBS-101	CHAIR: visitor, clinical areas
FQGE-101	CURTAIN: privacy screen
FQGE-112	BASKET: storage, for wall mounted panel, small
FQGE-113	BASKET: storage, for wall mounted panel, medium
FQTA-091	TABLE: overbed, mobile, height adjustable
FQWS-003	BIN: sharps, clinical, medium

CODE	DESCRIPTION
FQWS-051	BIN: general waste, 20L
FOWS-231	BIN: clinical waste, 20L
HYBA-121	BASIN: type B, handwashing
HYTP-067	TAPWARE: basin, tap set, wall mounted, lever handles
ITCL-133	BUTTON: patient to staff call, with cancel, with handset connection point, on services panel
ITCL-181	BUTTON: staff assist, with cancel, wall mounted
ITCL-191	BUTTON: emergency, with cancel, wall mounted
ITCL-251	HANDSET: patient to staff call
ITIN-025	OUTLET: data, double RJ45, on services panel
ITIN-026	OUTLET: data, double RJ45, wall mounted
ITNE-111	COMPUTER: workstation on wheels (WOW), medical grade, all-in-one computer, keyboard and mouse, on cart
ITNE-122	COMPUTER: single display screen, all-in-one, medical grade
ITNE-204	INPUT DEVICE: keyboard and mouse, wireless, medical grade, washable
ITSE-061	BUTTON: security, duress, fixed, wall mounted
LIFX-111	LIGHT: examination, ceiling recessed
MEEX-041	GRILLE: exhaust, wall mounted, low level
MGAS-022	OUTLET: medical air, on services panel
MGAS-042	OUTLET: oxygen (O2), on services panel
MGAS-062	OUTLET: suction, on services panel
MGFP-021	FLOWMETER: medical air
MGFP-041	FLOWMETER: oxygen
MGFP-061	ADAPTER: suction
MMBE-111	BED: patient, electric, with mattress, emergency
MMGE-191	CANNISTER: suction bottle
MMGE-238	DIAGNOSTIC SET: otoscope, ophthalmoscope and thermometer, wall mounted
MMPM-011	MONITOR: patient, medium acuity
MMSP-051	MEDICAL SERVICES PANEL: wall mounted
WIFX-057.04	WINDOW: fixed, internal, double glazed, sill at 900H, with integral blind
WLF-002	WALL FINISH: paint, clinical areas
WLF-011.04	WALL FINISH: vinyl, to 1500 AFFL
WLF-101	SPLASHBACK: vinyl
WLPR-002	WALL PROTECTION: bedhead wall panel, low height

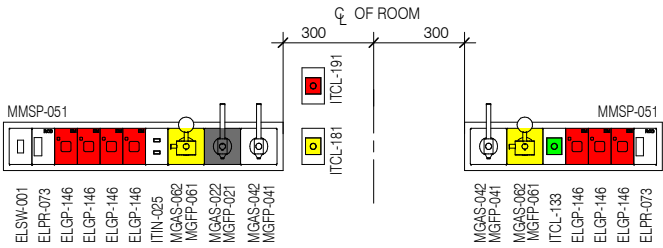

ELEVATION 5 (1 : 25 @ A3)