

AUSTRALASIAN HFG STANDARD COMPONENTS

Room Layout Sheet

RLS Room Code: SECL

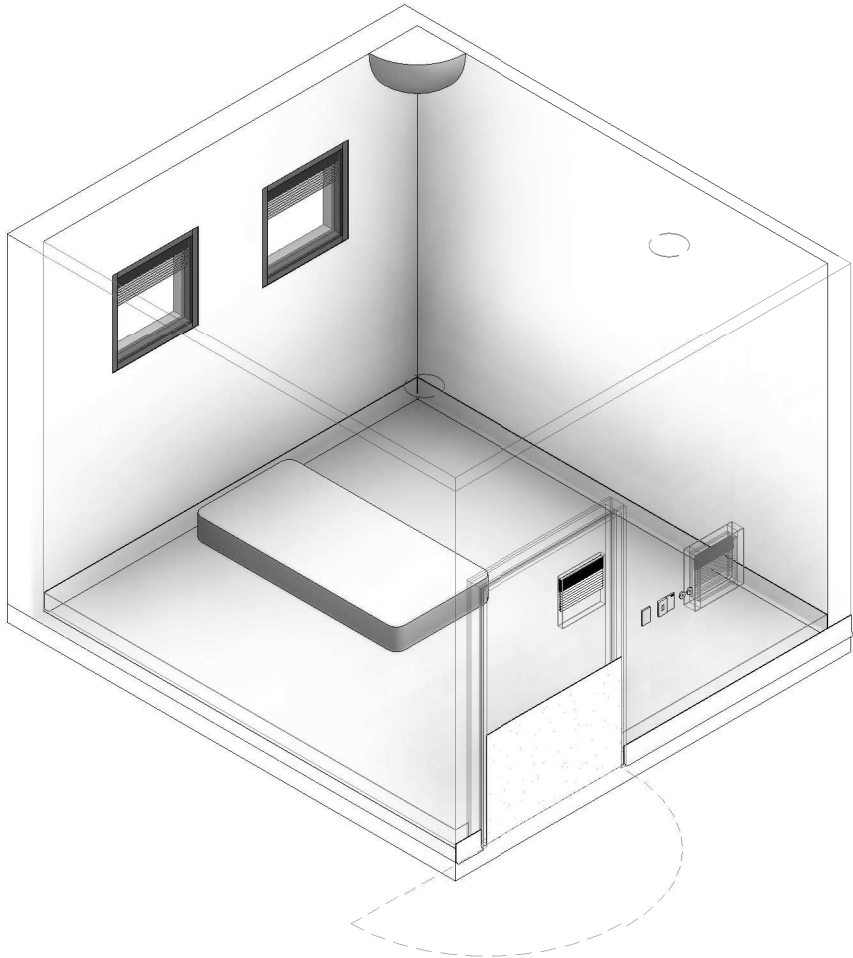

CODE	DESCRIPTION
AHWCV-006	WINDOW COVERING: blind, venetian
ELGP-201.02	GPO: double, wall mounted, vertical
ELSW-001	SWITCH: light
ELSW-021	SWITCH: light, dimmer
FIBM-112	MIRROR: fixed, convex, tamper proof, anti-ligature
FLSK-022	SKIRTING: vinyl, integral with floor vinyl, coved, tamper proof, anti-ligature
FLVY-102	FLOOR FINISH: vinyl, seamless, standard slip resistance, cushioned
ITAV-152	SPEAKER: AV system, ceiling recessed
MMBE-181	MATTRESS: patient
WIFX-057.04	WINDOW: fixed, internal, double glazed, sill at 900H, with integral blind
WIOP-262.03	WINDOW: operable, jockey sash, external, double glazed, sill at 1600H, with integral blind, tamper proof, anti-ligature
WLFI-002	WALL FINISH: paint, clinical areas

REQUIREMENTS FOR THE SELECTION OF SUITABLE FINISHES, HARDWARE, FIXTURES AND FITTINGS OF THE TYPE MANUFACTURED AND MARKETING AS TAMPER PROOF AND ANTI-LIGATURE, INCLUDING ANY WEIGHT LIMITS FOR COLLAPSING/BREAKING STRAIN FOR FIXTURES) MUST BE CONFIRMED AT PROJECT LEVEL BASED ON LOCAL PATIENT SAFETY POLICIES, LOCAL DESIGN GUIDANCE, RISK ASSESSMENTS AND CONFIRMATION OF OPERATIONAL MODELS. ALL TAMPER PROOF AND ANTI-LIGATURE ITEMS MUST BE INSTALLED IN ACCORDANCE WITH THEIR MANUFACTURER'S INSTRUCTIONS.

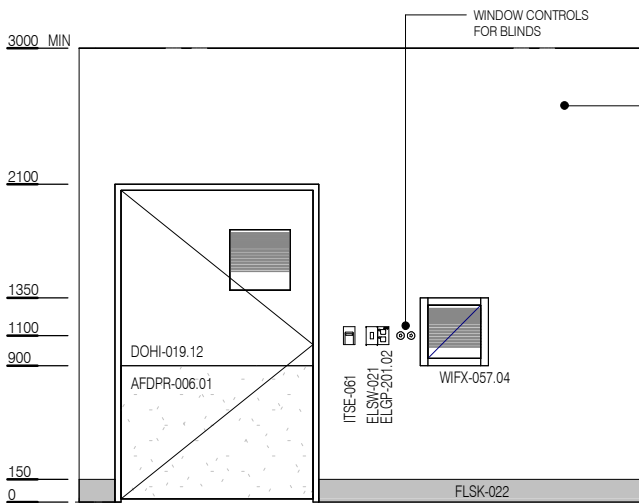

ELEVATION 5

Room Name:

1:50 2.5m 2 1.5 1 0.5 0

SECLUSION ROOM

DIRECT/CLOSE ACCESS TO AN EXTERNAL SPACE MAY BE CONSIDERED TO SUPPORT FUTURE FLEXIBILITY FOR USE AS A DE-ESCALATION SPACE

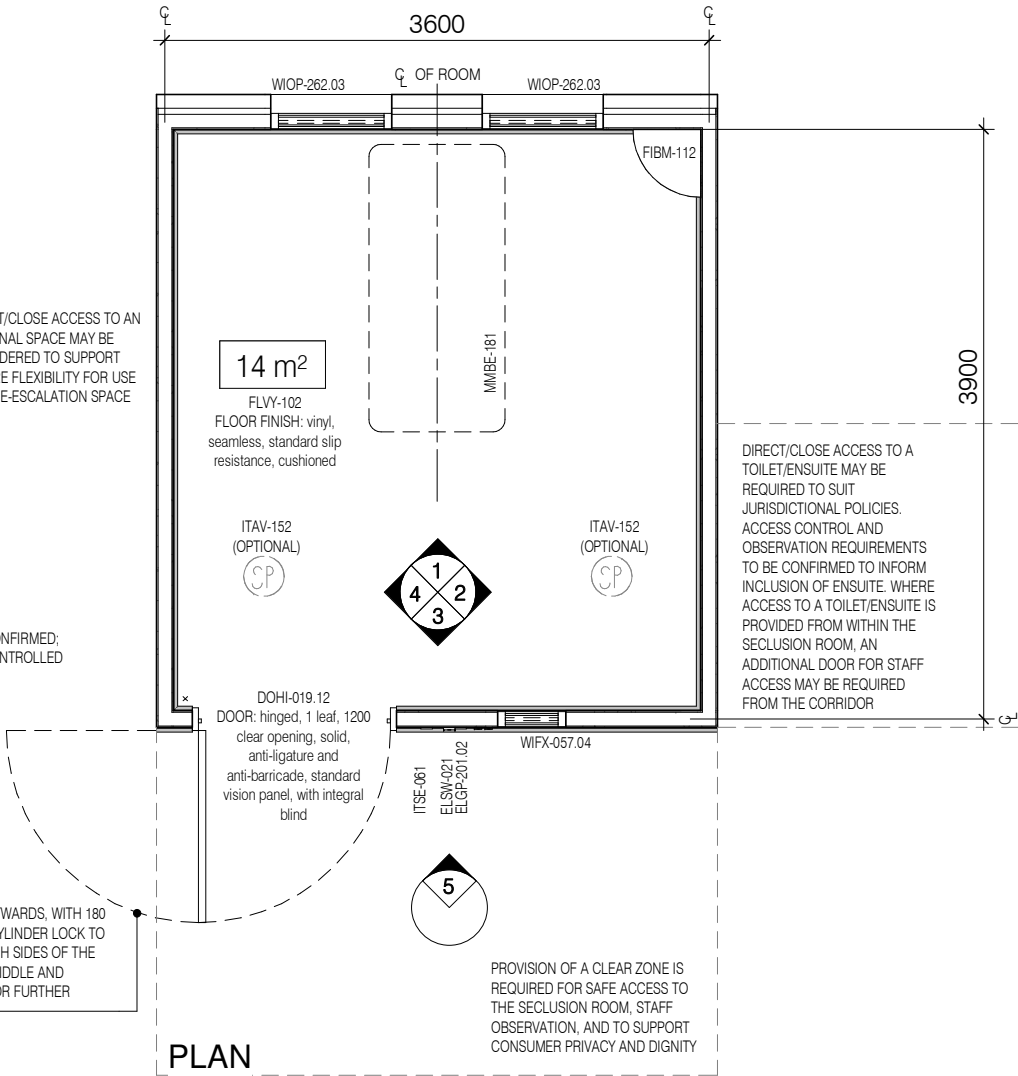

PLAN

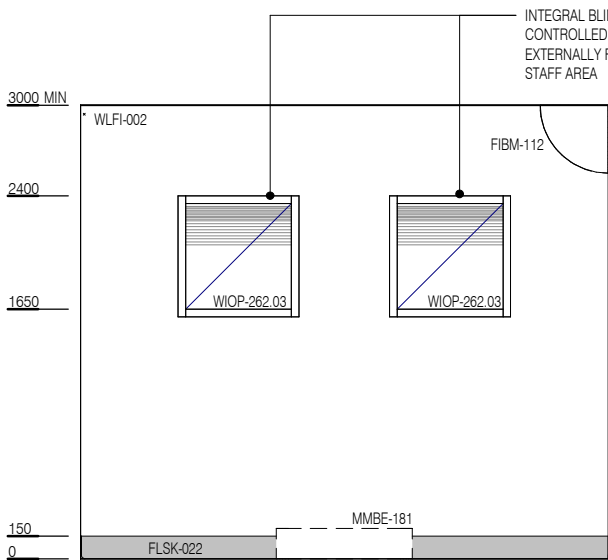

ELEVATION 1

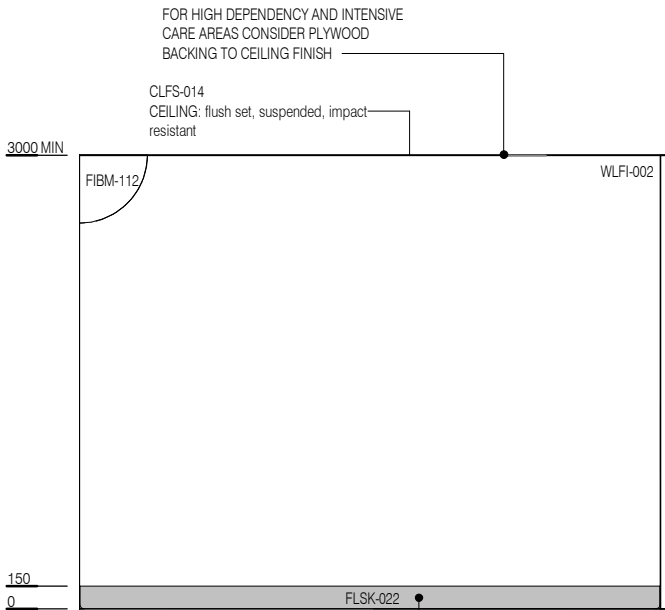

ELEVATION 2

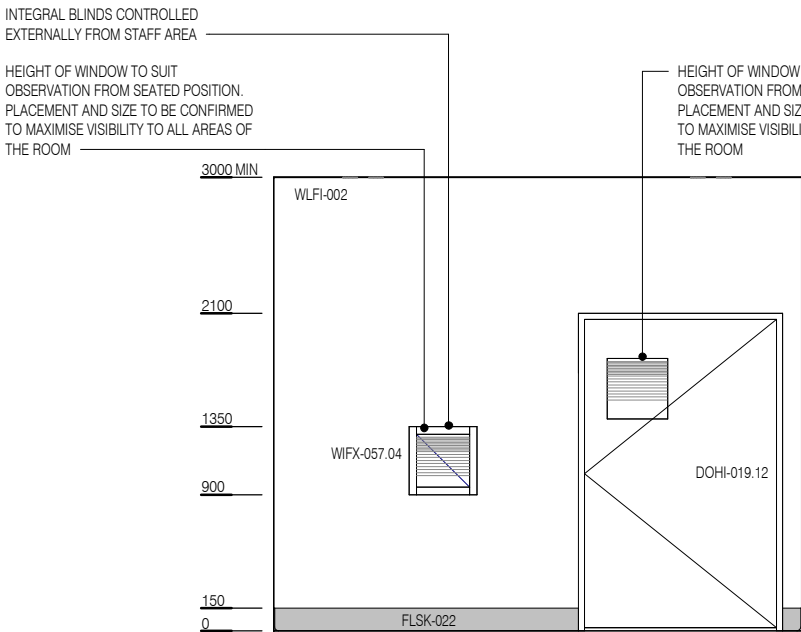

ELEVATION 3

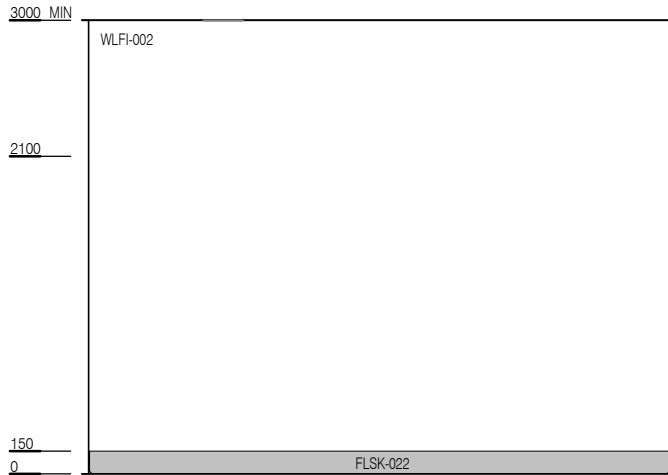

ELEVATION 4