

# AUSTRALASIAN HFG STANDARD COMPONENTS

Room Layout Sheet

RLS Room Code: **SSTN-20**

Room Name:

1:50 2.5m 2 1.5 1 0.5 0

**STAFF STATION, 20m<sup>2</sup>**

CODE	DESCRIPTION
CAC	Cable access cap
ELBO-003	CONTROL PANEL: lighting
ELBO-015	SWITCH: light, single
ELGP-106	GPO: single, special, for equipment
ELGP-208	GPO: double, wall mounted
FIBM-013	NOTICEBOARD: fixed, fabric covered
FUO-179	JOINERY UNIT: staff station, laminate
FLSK-010	SKIRTING: vinyl, floor vinyl coved, 150H, prefinished
FLVY-007	FLOOR FINISH: vinyl, seamless, coved, standard slip resistant
FOBS-018	CHAIR: office, ergonomic
FQCW-016	BIN: waste, general, 20L
FQDW-004	KEYBOARD SHELF: drop down, for workstation
FQSM-009	PEDESTAL: mobile, filing unit, 660H
ITCL-001	ANNUNCIATOR: nurse call
ITIN-026	OUTLET: data, double RJ45, wall mounted
ITNE-007	COMPUTER: desktop, with display screen
ITNE-049	TELEPHONE: handset, desktop
ITSE-006	BUTTON: duress, fixed
LIFX-008	LIGHT: task light, built in
MEGE-007	CONTROL PANEL: temperature
MGFP-001	ALARM PANEL: medical gases
MMBE-045	WHEELCHAIR
MMGE-152	VIEWER: X-ray, 2 screen
WLPR-017	WALL PROTECTION: rail & crash bar combined, at 900 AFFL, prefinished PVC
WLPT-003	PARTITION: laminate
WLWA-004	WALL FINISH: paint, acrylic, washable

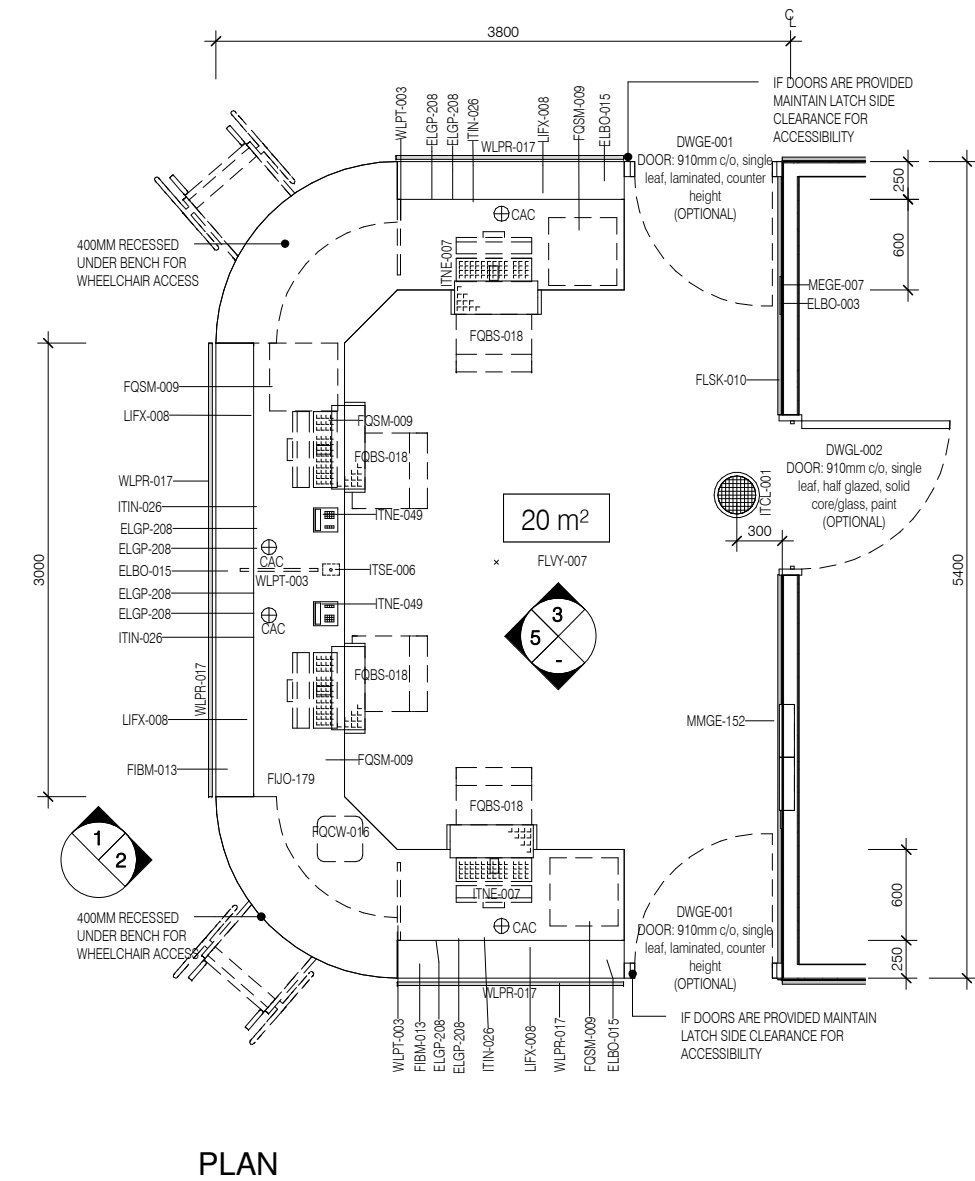
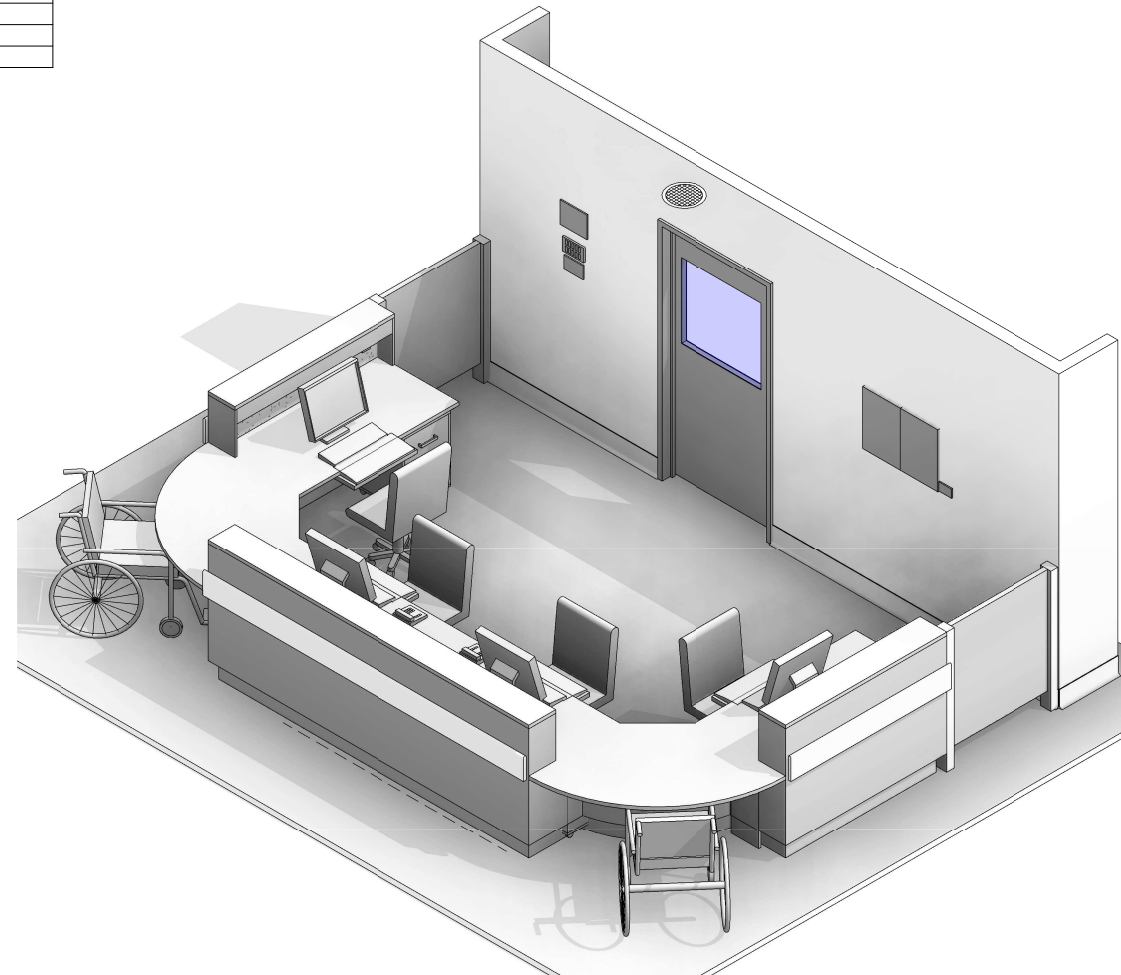

REV	DESCRIPTION	DATE
4	Coding and naming updated	20.03.2017

**FOR GUIDANCE**

SCALE	RLS Room Code	REV
1 : 50 @ A3	SSTN-20	4

# AUSTRALASIAN HFG STANDARD COMPONENTS

Room Layout Sheet

RLS Room Code: **SSTN-20**

1:50 2.5m 2 1.5 1 0.5 0

Room Name:

**STAFF STATION, 20m<sup>2</sup>**

CODE	DESCRIPTION
CAC	Cable access cap
ELBO-003	CONTROL PANEL: lighting
ELBO-015	SWITCH: light, single
ELGP-106	GPO: single, special, for equipment
ELGP-208	GPO: double, wall mounted
FIBM-013	NOTICEBOARD: fixed, fabric covered
FJO-179	JOINERY UNIT: staff station, laminate
FLSK-010	SKIRTING: vinyl, floor vinyl coved, 150H, prefinished
FLYY-007	FLOOR FINISH: vinyl, seamless, coved, standard slip resistant
FQBS-018	CHAIR: office, ergonomic
FQCW-016	BIN: waste, general, 20L
FQDW-004	KEYBOARD SHELF: drop down, for workstation
FQSM-009	PEDESTAL: mobile, filing unit, 660H
ITCL-001	ANNUNCIATOR: nurse call
ITIN-026	OUTLET: data, double RJ45, wall mounted
ITNE-007	COMPUTER: desktop, with display screen
ITNE-049	TELEPHONE: handset, desktop
ITSE-006	BUTTON: duress, fixed
LIFX-008	LIGHT: task light, built in
MEGE-007	CONTROL PANEL: temperature
MGFP-001	ALARM PANEL: medical gases
MMBE-045	WHEELCHAIR
MMGE-152	VIEWER: X-ray, 2 screen
WLPR-017	WALL PROTECTION: rail & crash bar combined, at 900 AFFL, prefinished PVC
WLPT-003	PARTITION: laminate
WLWA-004	WALL FINISH: paint, acrylic, washable

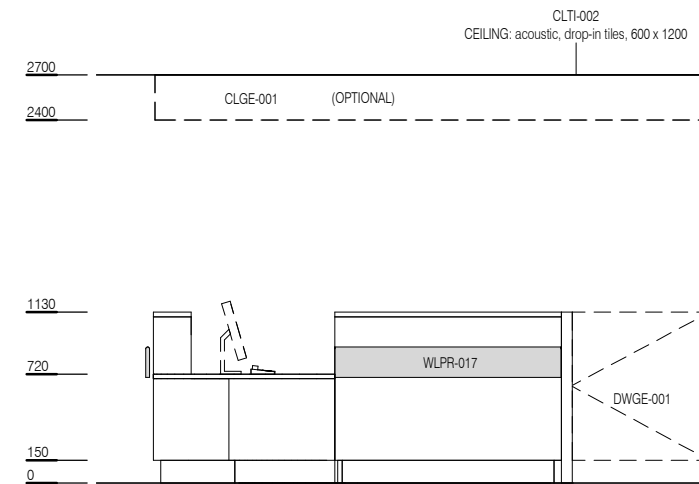

**ELEVATION 1**

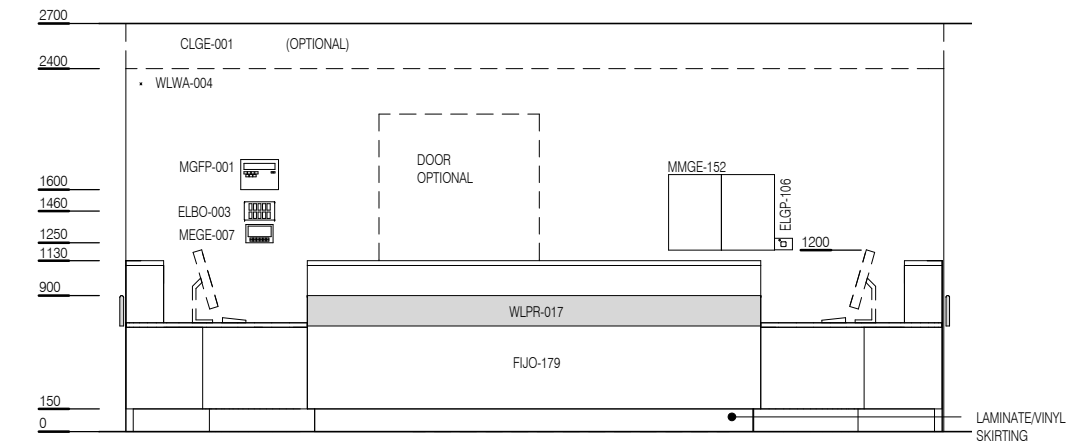

**ELEVATION 2**

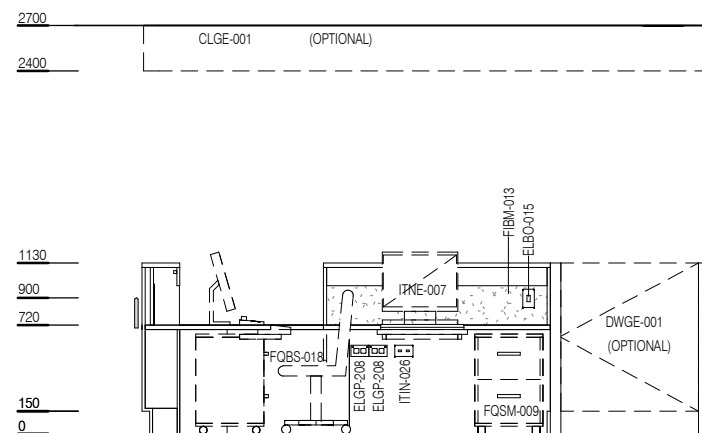

**ELEVATION 3 & ELEVATION 4 (MIRRORED)**

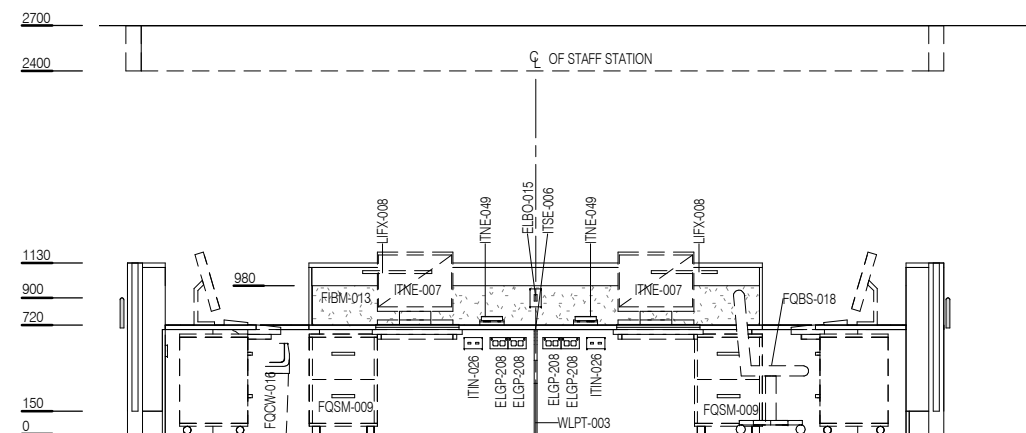

**ELEVATION 5 ( 1 : 50 @ A3 )**



REV	DESCRIPTION	DATE
4	Coding and naming updated	20.03.2017
	Coding and naming updated	20.03.2017

FOR GUIDANCE

SCALE	RLS Room Code	REV
1 : 50 @ A3	SSTN-20	4