

AUSTRALASIAN HFG STANDARD COMPONENTS

Room Layout Sheet

RLS Room Code: **STAD**

Room Name:

1:50 2.5m 2 1.5 1 0.5 0
STORE - ACCOUNTABLE DRUGS

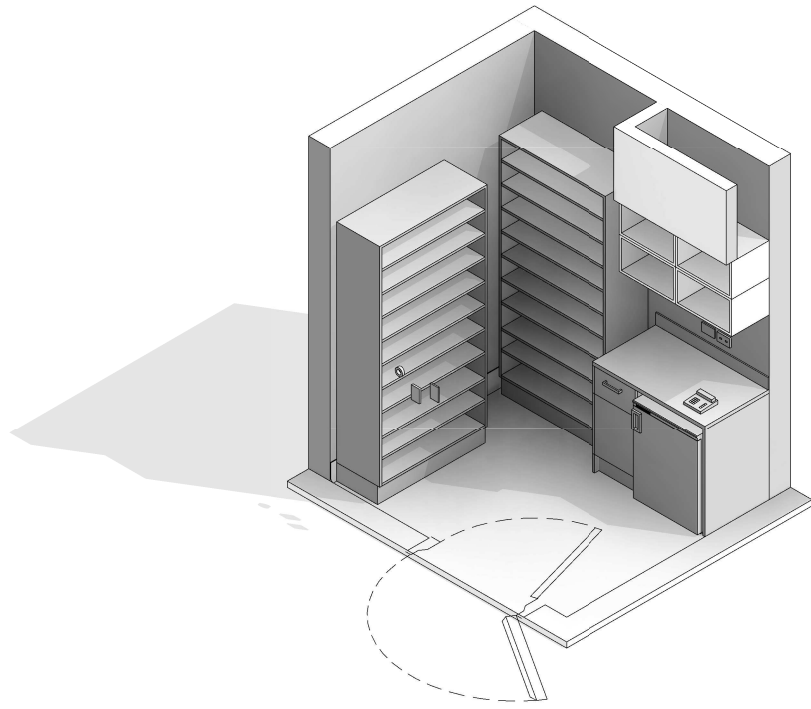

CODE	DESCRIPTION
DWGE-002	DOOR: 910mm c/o, steel, strongroom, grille gate door, paint
ELBO-015	SWITCH: light, single
ELGP-109	GPO: single, wall mounted
ELGP-208	GPO: double, wall mounted
FIJO-059	BENCH TOP: 600D, joinery under, laminate finish
FIJO-128	CUPBOARD: tall, shelf unit, pharmacy shelves
FIJO-142	CUPBOARD: underbench, single, adj shelves, with single drawer
FIJO-152	CUPBOARD: wall mount, shelf unit, adj shelves
FLSK-010	SKIRTING: vinyl, floor vinyl coved, 150H, prefinished
FLVY-007	FLOOR FINISH: vinyl, seamless, coved, standard slip resistant
ITIN-026	OUTLET: data, double RJ45, wall mounted
ITNE-049	TELEPHONE: handset, desktop
ITSE-002	ALARM: duress
LIFX-008	LIGHT: task light, built in
MEGE-015	VENTILATION PORT
MMGE-036	FRIDGE: drugs, underbench
WLWA-004	WALL FINISH: paint, acrylic, washable

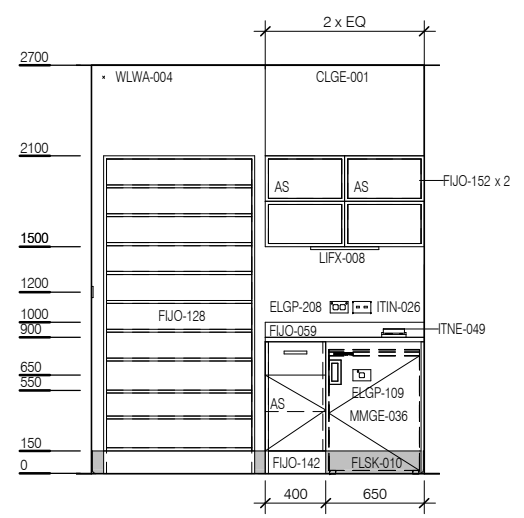
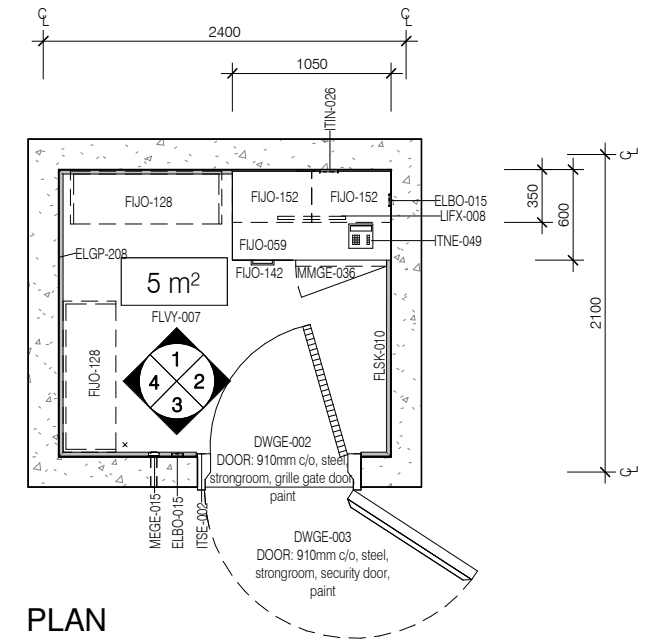

ELEVATION 1

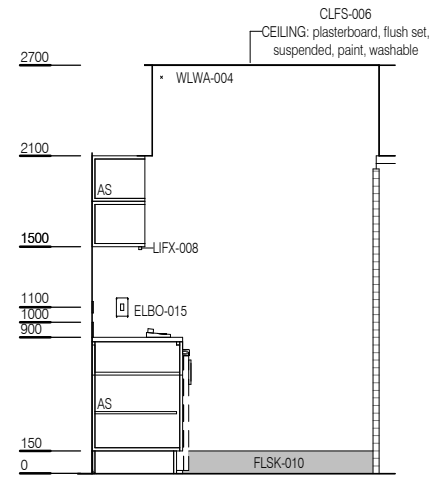

ELEVATION 2

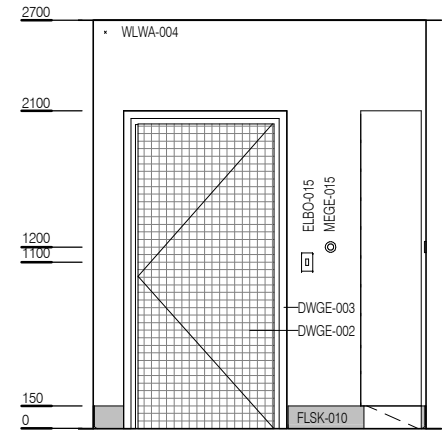

ELEVATION 3

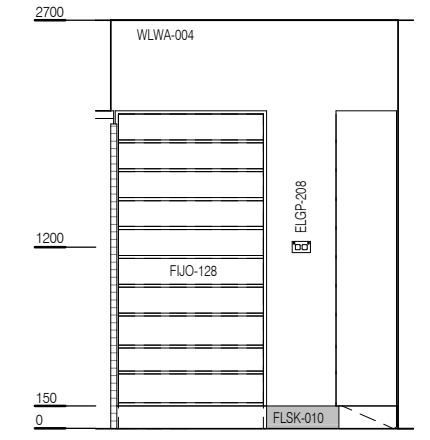

ELEVATION 4



REV	DESCRIPTION	DATE
3	Coding and naming updated	20.03.2017

FOR GUIDANCE

SCALE	RLS Room Code	REV
1 : 50 @ A3	STAD	3