

AUSTRALASIAN HFG STANDARD COMPONENTS

Room Layout Sheet

RLS Room Code: **STBK-40**

1:50 2.5m 2 1.5 1 0.5 0

Room Name:

STORE - BULK, 40m²

CODE	DESCRIPTION
DWPR-006	DOOR PROTECTION: protection plate, to 900 AFFL, PVC, prefinished
DWPR-010	DOOR PROTECTION: to door frame, PVC, prefinished
ELBO-015	SWITCH: light, single
ELGP-208	GPO: double, wall mounted
ELGP-223	GPO: emergency power, double, wall mounted
FLSK-010	SKIRTING: vinyl, floor vinyl coved, 150H, prefinished
FLVY-007	FLOOR FINISH: vinyl, seamless, coved, standard slip resistant
FQCA-026	FRIDGE: commercial, floor standing, double door
FQSN-086	SHELVING: floor standing, 900W x 400D x 2100H nom., metal
ITIN-026	OUTLET: data, double RJ45, wall mounted
WLPR-019	WALL PROTECTION: crash rail, at 900 AFFL, prefinished PVC
WLWA-004	WALL FINISH: paint, acrylic, washable

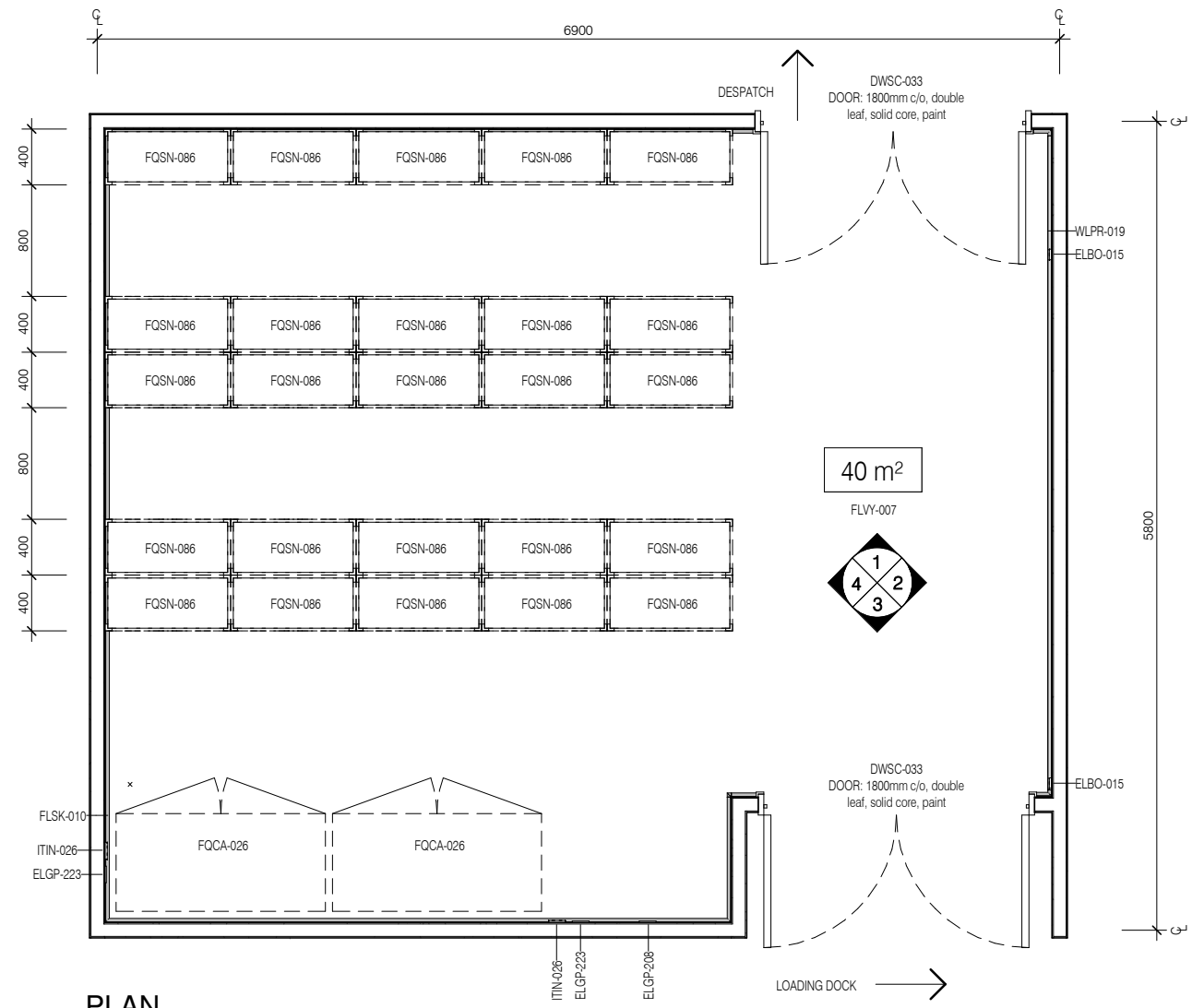
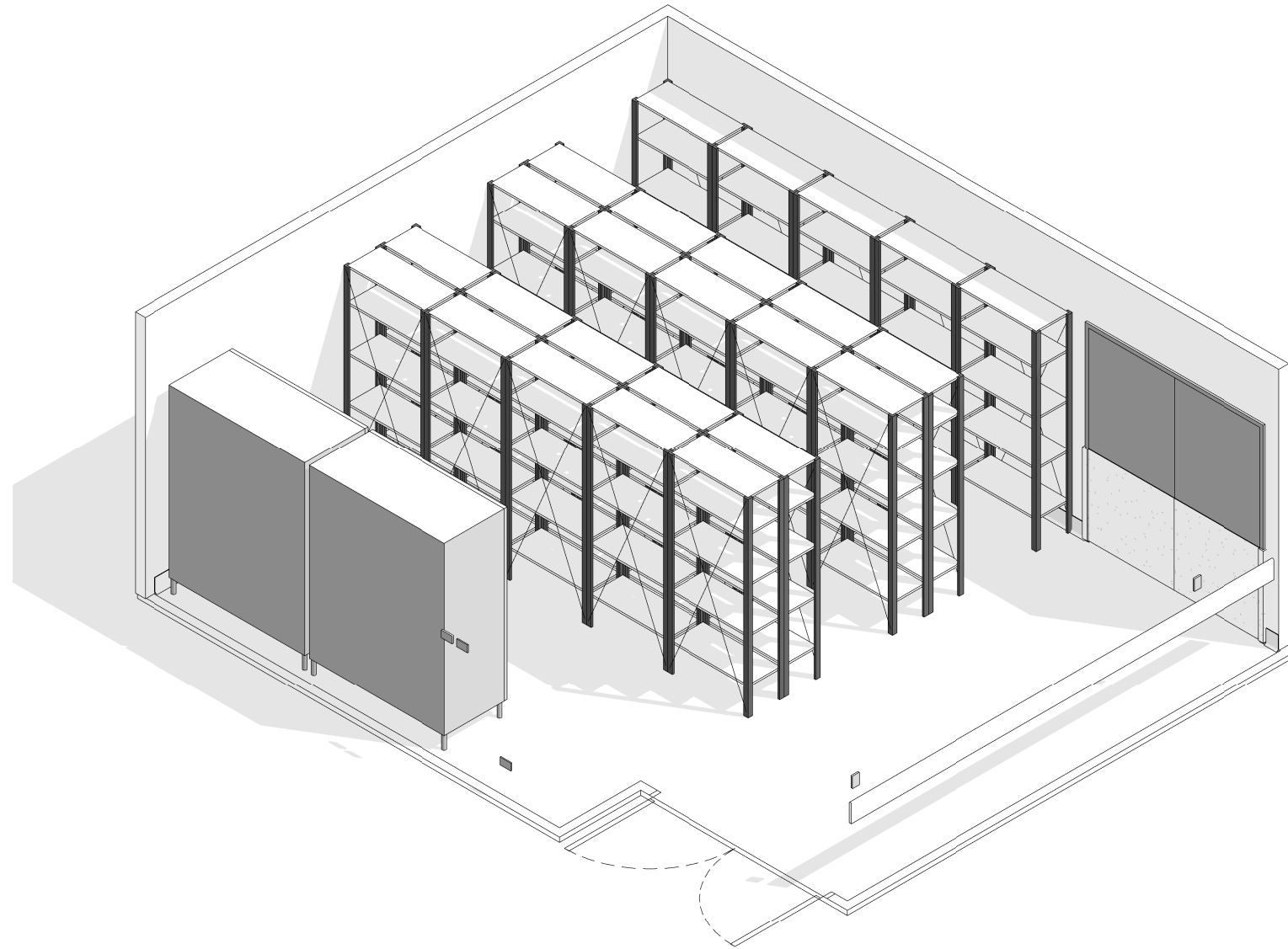

PLAN



REV	DESCRIPTION	DATE
3	Coding and naming updated	20.03.2017

FOR GUIDANCE

SCALE	RLS Room Code	REV
1 : 50 @ A3	STBK-40	3

CODE	DESCRIPTION
DWPR-006	DOOR PROTECTION: protection plate, to 900 AFFL, PVC, prefinished
DWPR-010	DOOR PROTECTION: to door frame, PVC, prefinished
ELBO-015	SWITCH: light, single
ELGP-208	GPO: double, wall mounted
ELGP-223	GPO: emergency power, double, wall mounted
FLSK-010	SKIRTING: vinyl, floor vinyl coved, 150H, prefinished
FLVY-007	FLOOR FINISH: vinyl, seamless, coved, standard slip resistant
FOCA-026	FRIDGE: commercial, floor standing, double door
FQSN-086	SHELVING: floor standing, 900W x 400D x 2100H nom., metal
ITIN-026	OUTLET: data, double RJ45, wall mounted
WLPR-019	WALL PROTECTION: crash rail, at 900 AFFL, prefinished PVC
WLWA-004	WALL FINISH: paint, acrylic, washable

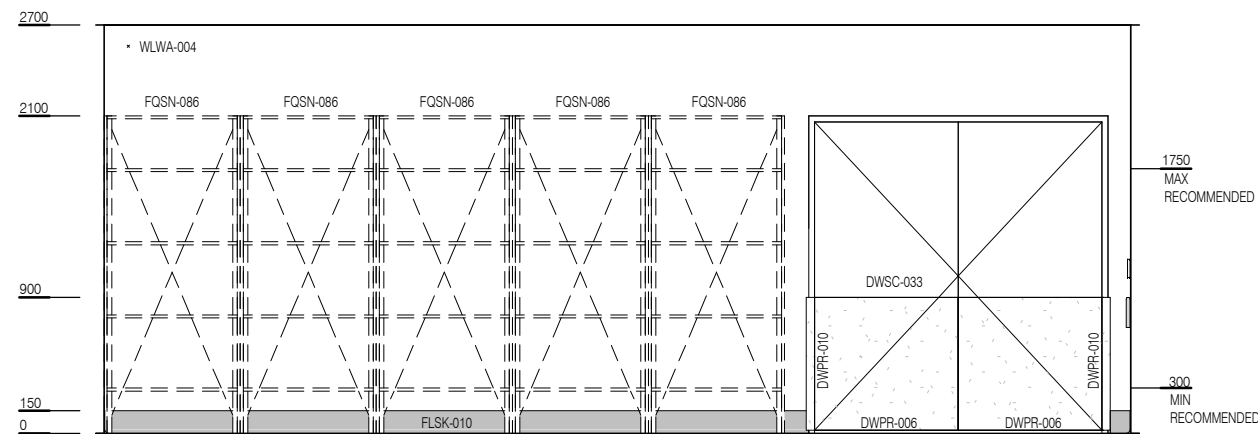

ELEVATION 1

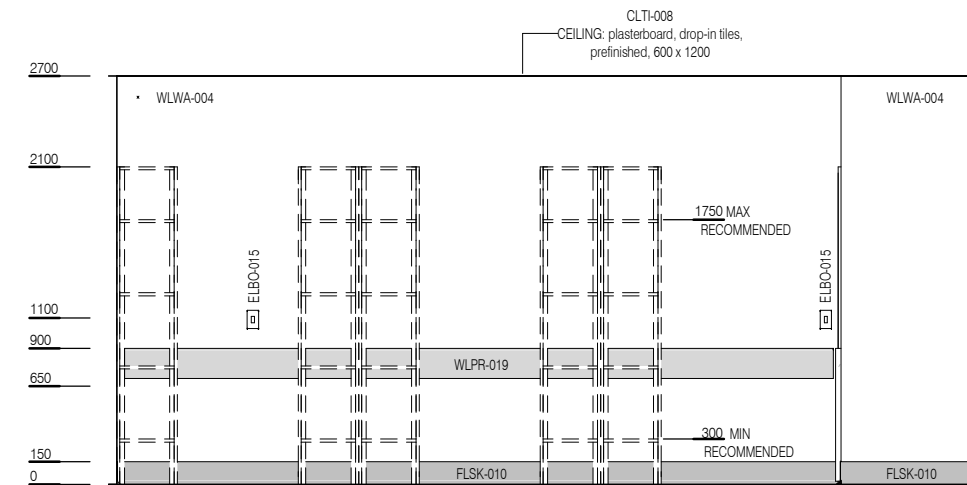

ELEVATION 2

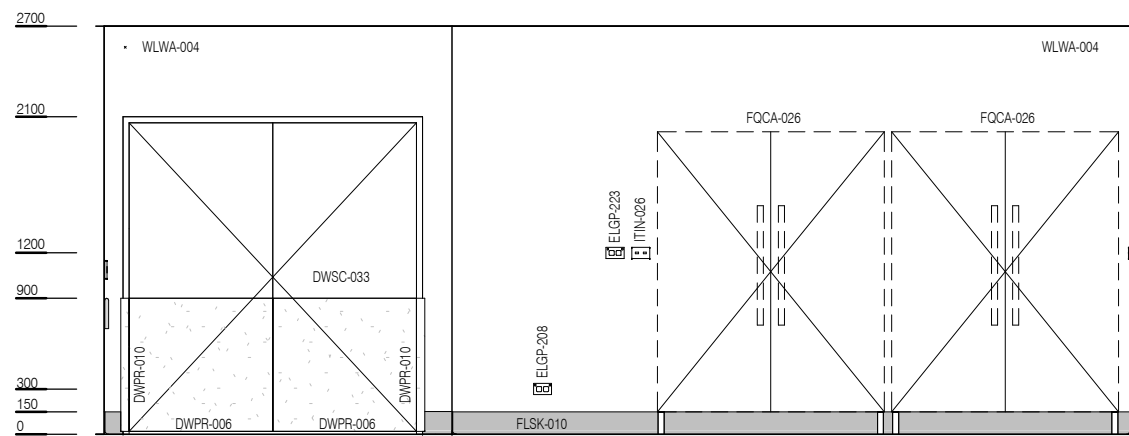

ELEVATION 3

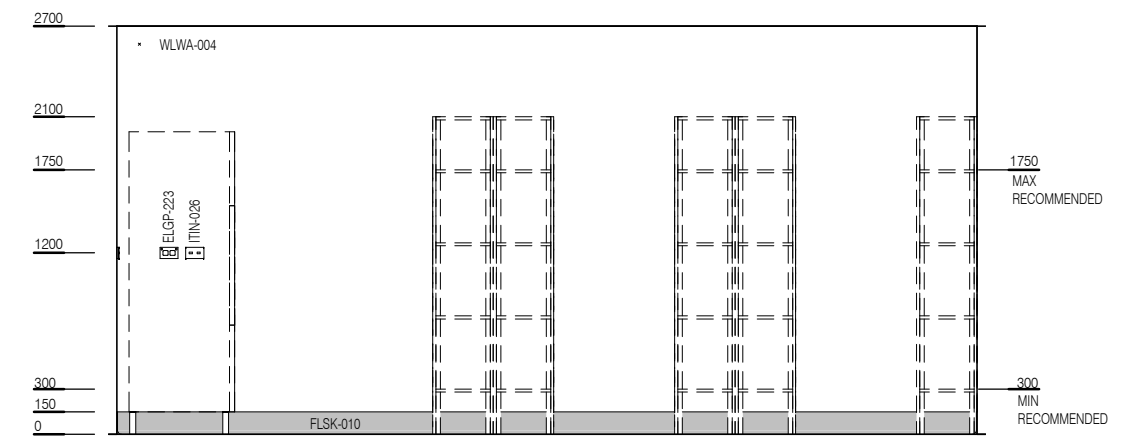

ELEVATION 4