

# AUSTRALASIAN HFG STANDARD COMPONENTS

Room Layout Sheet

RLS Room Code: STPS-10

Room Name:

STORE - PHOTOCOPY/ STATIONERY, 10m<sup>2</sup>

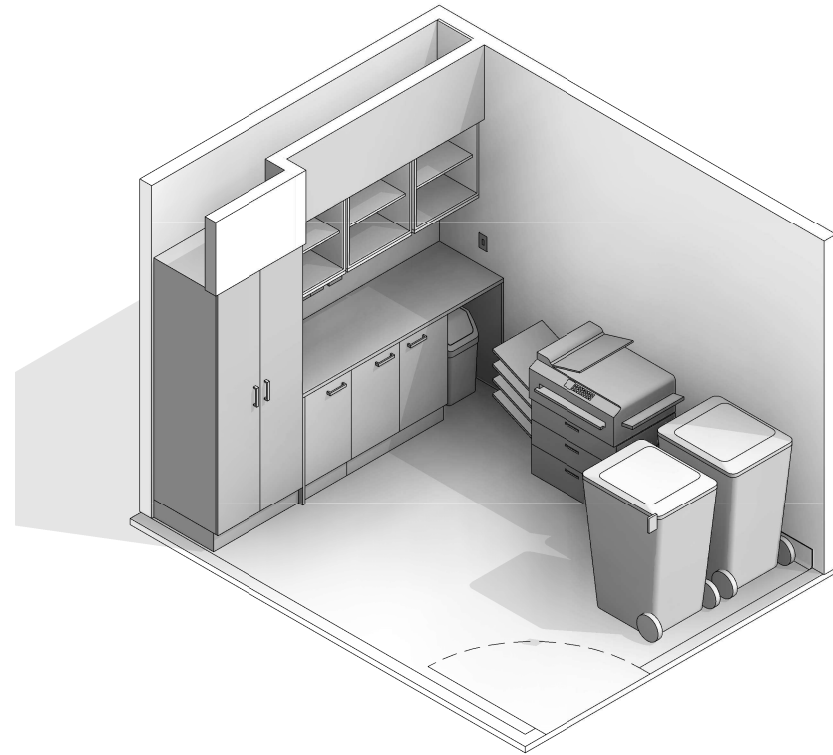
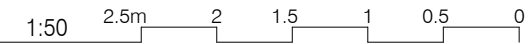

CODE	DESCRIPTION
DWPR-001	DOOR PROTECTION: kickplate, to 300 AFFL
ELBO-015	SWITCH: light, single
ELGP-109	GPO: single, wall mounted
ELGP-208	GPO: double, wall mounted
FUO-059	BENCH TOP: 600D, joinery under, laminate finish
FUO-116	CUPBOARD: tall, double door, adj shelves
FUO-136	CUPBOARD: underbench, double door, adj shelves, lockable
FUO-141	CUPBOARD: underbench, single door, adj shelves, lockable
FUO-152	CUPBOARD: wall mount, shelf unit, adj shelves
FLSK-010	SKIRTING: vinyl, floor vinyl coved, 150H, prefinished
FLY-007	FLOOR FINISH: vinyl, seamless, coved, standard slip resistant
FQCW-016	BIN: waste, general, 20L
FQCW-029	BIN: waste, recycling, paper, 240L
FQCW-038	BIN: waste, secure
ITIN-026	OUTLET: data, double RJ45, wall mounted
ITNE-021	MULTIFUNCTION DEVICE: floorstanding
LIFX-008	LIGHT: task light, built in
WLWA-004	WALL FINISH: paint, acrylic, washable

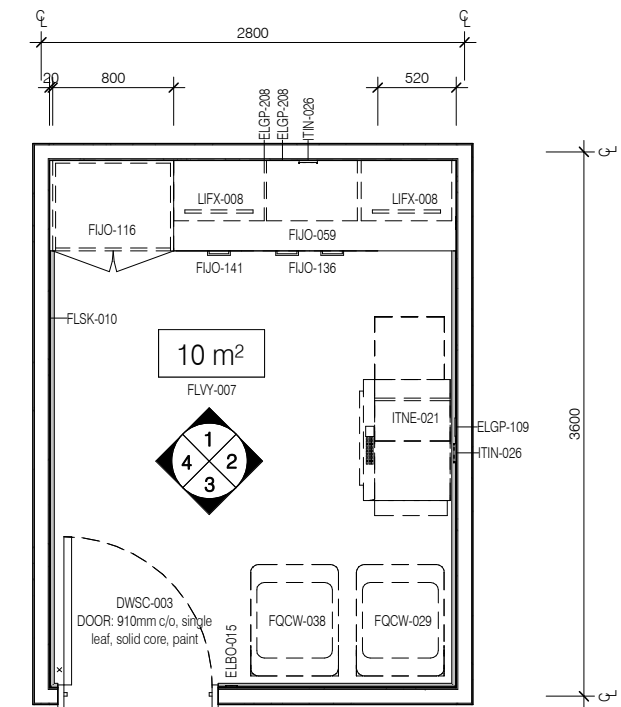

PLAN

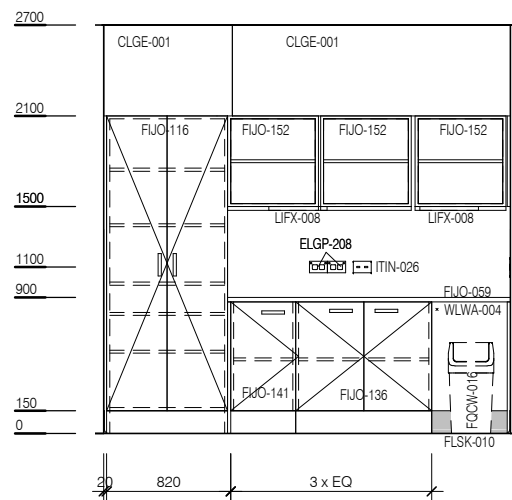

ELEVATION 1

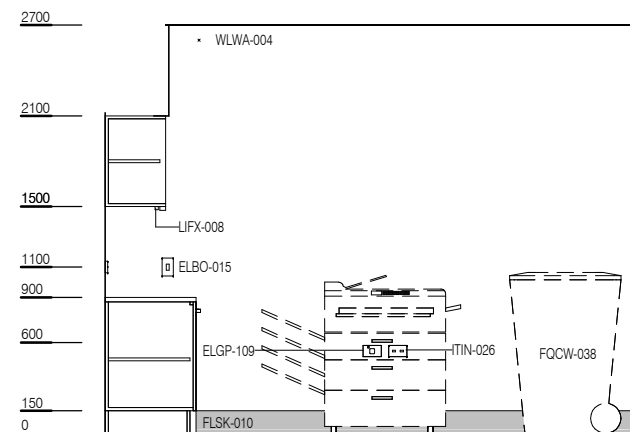

ELEVATION 2

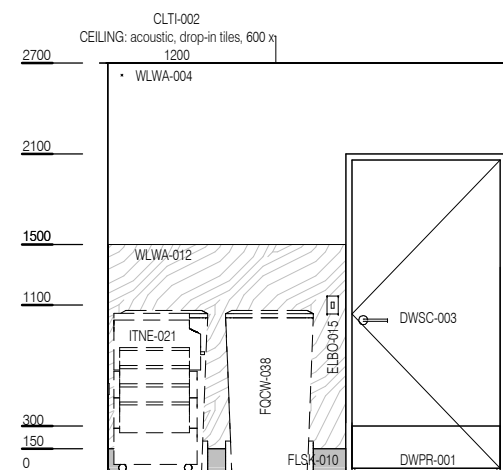

ELEVATION 3

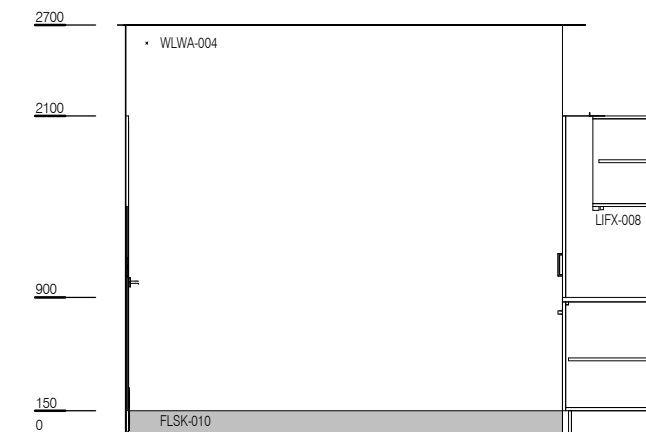

ELEVATION 4



REV	DESCRIPTION	DATE
3	Coding and naming updated	20.03.2017

FOR GUIDANCE

SCALE	RLS Room Code	REV
1 : 50 @ A3	STPS-10	3