

# AUSTRALASIAN HFG STANDARD COMPONENTS

Room Layout Sheet

RLS Room Code: TRMT-HTS

Room Name:

TREATMENT ROOM - HAND THERAPY / SPLINTING

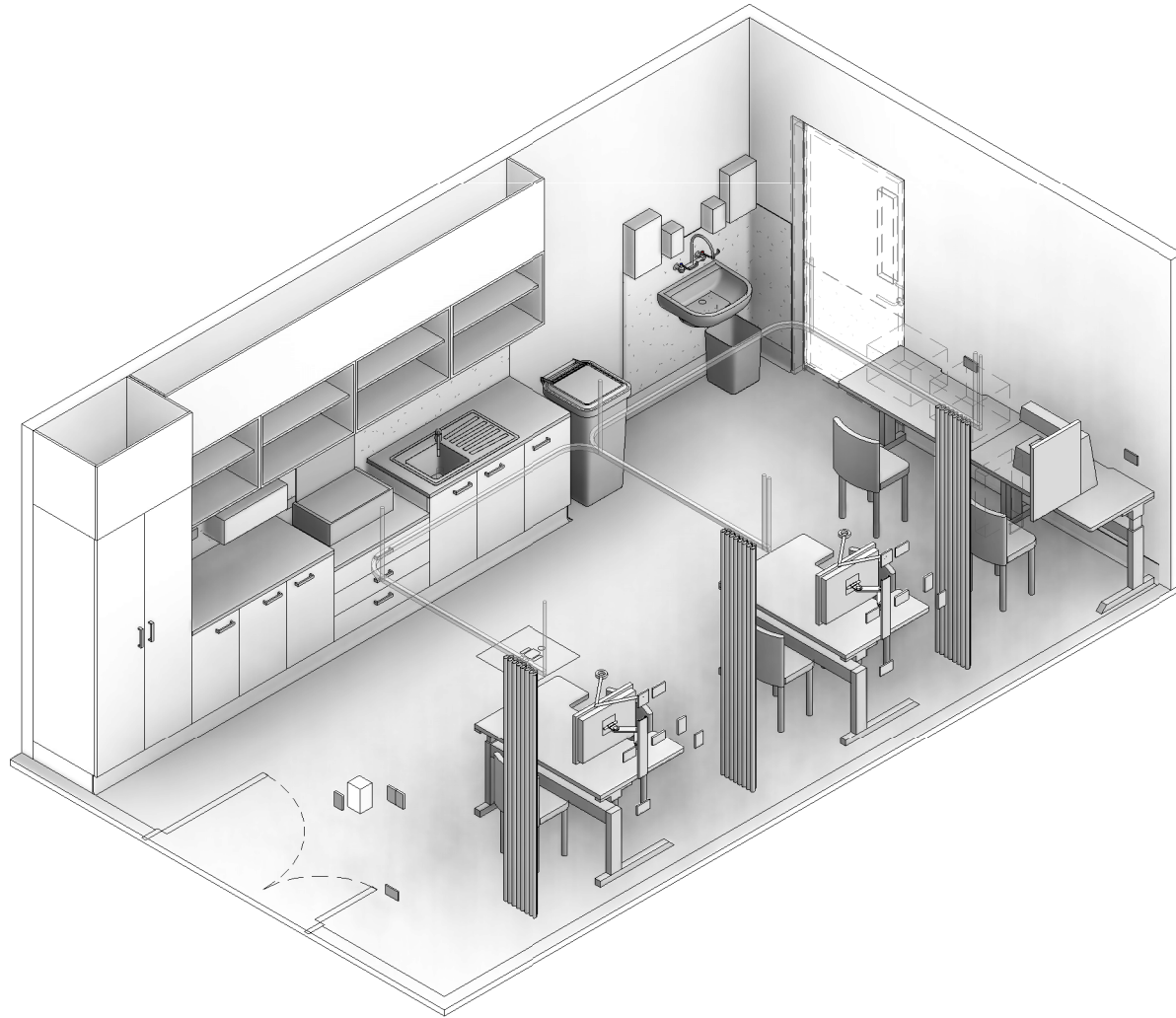

CODE	DESCRIPTION
DWPR-005	DOOR PROTECTION: protection plate to 900 AFFL
ELBO-015	SWITCH: light, single
ELGP-109	GPO: single, wall mounted
ELGP-110	GPO: single, wall mounted, cleaner
ELGP-208	GPO: double, wall mounted
ELPR-001	BODY PROTECTED ELECTRICAL AREA
ELPR-006	RCD: residual current device
FIBM-019	WHITEBOARD: fixed, magnetic
FIDI-001	DISPENSER: alcohol based hand rub
FIDI-014	DISPENSER: disposable glove
FIDI-025	DISPENSER: paper/hand towel
FIDI-030	DISPENSER: soap
FIDI-031	DISPENSER: soap antiseptic
FIDI-053	DISPENSER: velcro
FIHR-067	BRACKET: for monitor, wall mounted, articulated, adj height
FJO-059	BENCH TOP: 600D, joinery under, laminate finish
FJO-104	CUPBOARD: drawer unit, 3 equal
FJO-116	CUPBOARD: tall, double door, adj shelves
FJO-135	CUPBOARD: underbench, double door, adj shelves
FJO-140	CUPBOARD: underbench, single door, adj shelves
FJO-152	CUPBOARD: wall mount, shelf unit, adj shelves
FJO-212	BULKHEAD: joinery
FIRT-047	TRACK: curtain, privacy, U shaped
FLSK-010	SKIRTING: vinyl, floor vinyl covered, 150H, prefinished
FLVY-007	FLOOR FINISH: vinyl, seamless, coved, standard slip resistant
FQBS-030	CHAIR: visitor, patient
FQCW-010	BIN: waste, clinical, 80L
FQCW-016	BIN: waste, general, 20L
FQDW-049	DESK: adj height, 1200W x 600D x 750H nom.
FQGE-010	CURTAIN: privacy screen
FQGE-043	MACHINE: sewing
FQTA-084	TABLE: adjustable height, hand therapy
HYBA-010	BASIN: handwash, Type B
HYBA-069	SINK: single, with drainer, 930mmL
HYDR-008	TRAP: plaster
HYTP-037	TAPWARE: mixer, elbow levers
HYTP-040	TAPWARE: mixer, sink, accessible
ITIN-016	OUTLET: data, single RJ45, wall mounted
ITIN-026	OUTLET: data, double RJ45, wall mounted
ITNE-053	TELEPHONE: handset, wall mount, handsfree
ITNE-066	COMPUTER: all-in-one, wall mounted
ITSE-006	BUTTON: duress, fixed
LIFX-026	LIGHT: examination, wall mounted
MMAH-012	DEVICE: continuous passive motion (CPM), hand and fingers
MMAH-021	PAN: splint, molding
MMGE-150	VIEWER: X-ray, 1 screen
MMLA-014	DEVICE: wax bath
WLWA-004	WALL FINISH: paint, acrylic, washable
WLWA-007	WALL FINISH: splashback
WLWA-010	WALL FINISH: splashback, vinyl

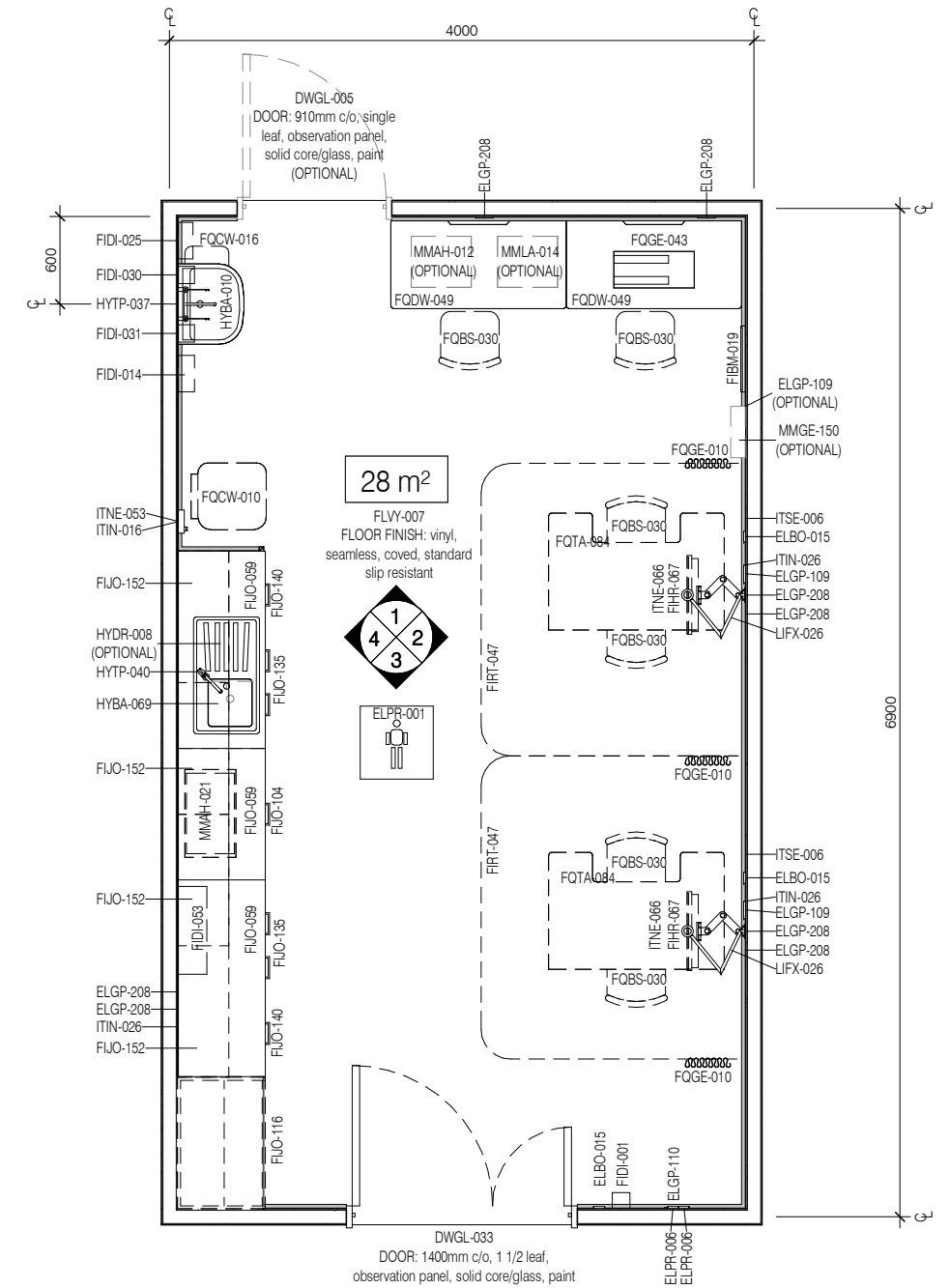

REV	DESCRIPTION	DATE
1	First Issue	26.04.2021

FOR GUIDANCE

SCALE	RLS Room Code	REV
1 : 50 @ A3	TRMT-HTS	1

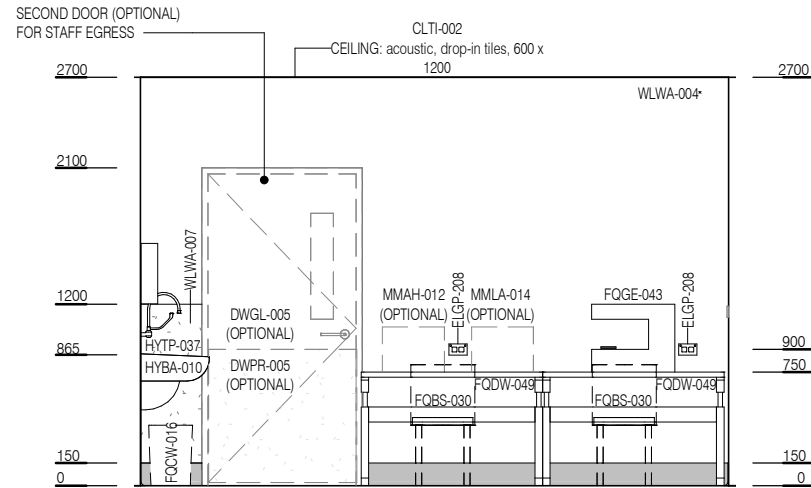

ELEVATION 1

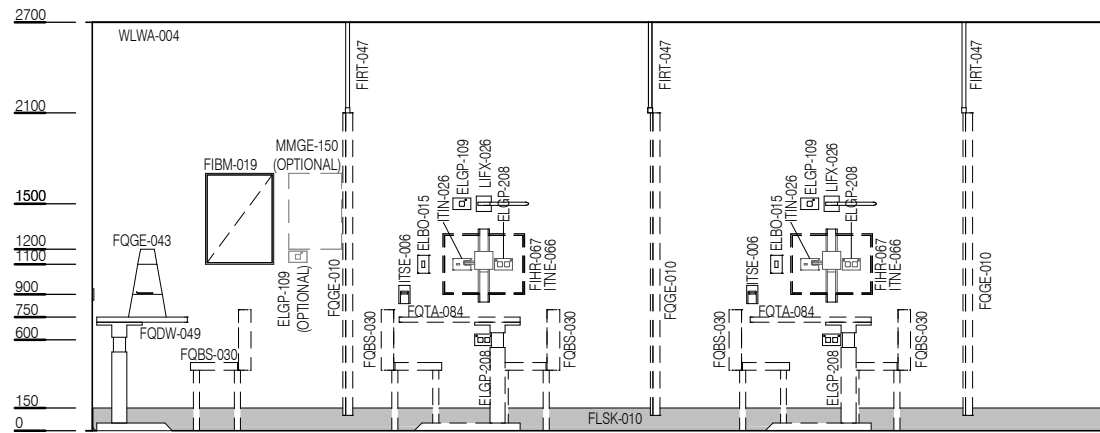

ELEVATION 2

CODE	DESCRIPTION
DWPR-005	DOOR PROTECTION: protection plate to 900 AFFL
ELBO-015	SWITCH: light, single
ELGP-109	GPO: single, wall mounted
ELGP-110	GPO: single, wall mounted, cleaner
ELGP-208	GPO: double, wall mounted
ELPR-001	BODY PROTECTED ELECTRICAL AREA
ELPR-006	RCD: residual current device
FIBM-019	WHITEBOARD: fixed, magnetic
FIDI-001	DISPENSER: alcohol based hand rub
FIDI-014	DISPENSER: disposable glove
FIDI-025	DISPENSER: paper/hand towel
FIDI-030	DISPENSER: soap
FIDI-031	DISPENSER: soap antiseptic
FIDI-053	DISPENSER: velcro
FIHR-067	BRACKET: for monitor, wall mounted, articulated, adj height
FJO-059	BENCH TOP: 600D, joinery under, laminate finish
FJO-104	CUPBOARD: drawer unit, 3 equal
FJO-116	CUPBOARD: tall, double door, adj shelves
FJO-135	CUPBOARD: underbench, double door, adj shelves
FJO-140	CUPBOARD: underbench, single door, adj shelves
FJO-152	CUPBOARD: wall mount, shelf unit, adj shelves
FJO-212	BULKHEAD: joinery
FIRT-047	TRACK: curtain, privacy, U shaped
FLSK-010	SKIRTING: vinyl, floor vinyl coved, 150H, prefinished
FLVY-007	FLOOR FINISH: vinyl, seamless, coved, standard slip resistant
FOBS-030	CHAIR: visitor, patient
FOCW-010	BIN: waste, clinical, 80L
FOCW-016	BIN: waste, general, 20L
FQDW-049	DESK: adj height, 1200W x 600D x 750H nom.
FOGE-010	CURTAIN: privacy screen
FOGE-043	MACHINE: sewing
FQTA-084	TABLE: adjustable height, hand therapy
HYBA-010	BASIN: handwash, Type B
HYBA-069	SINK: single, with drainer, 930mmL
HYDR-008	TRAP: plaster
HYTP-037	TAPWARE: mixer, elbow levers
HYTP-040	TAPWARE: mixer, sink, accessible
ITIN-016	OUTLET: data, single RJ45, wall mounted
ITIN-026	OUTLET: data, double RJ45, wall mounted
ITNE-053	TELEPHONE: handset, wall mount, handsfree
ITNE-066	COMPUTER: all-in-one, wall mounted
ITSE-006	BUTTON: duress, fixed
LIFX-026	LIGHT: examination, wall mounted
MMAH-012	DEVICE: continuous passive motion (CPM), hand and fingers
MMAH-021	PAN: splint, molding
MMGE-150	VIEWER: X-ray, 1 screen
MMLA-014	DEVICE: wax bath
WLWA-004	WALL FINISH: paint, acrylic, washable
WLWA-007	WALL FINISH: splashback
WLWA-010	WALL FINISH: splashback, vinyl

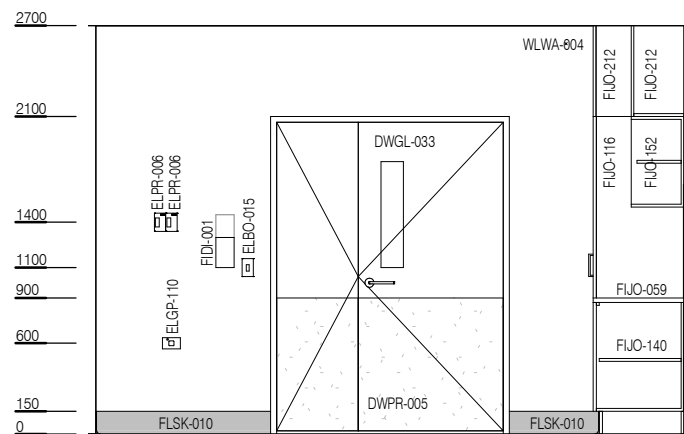

ELEVATION 3

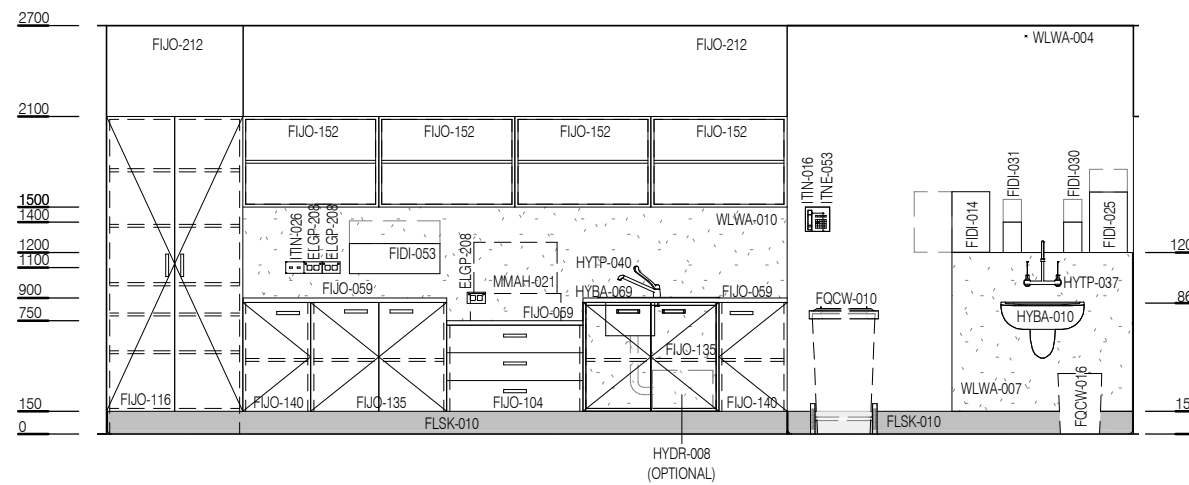

ELEVATION 4