

AUSTRALASIAN HFG STANDARD COMPONENTS

Room Layout Sheet

RLS Room Code: **TRMT**

Room Name:

TREATMENT ROOM, 14m²

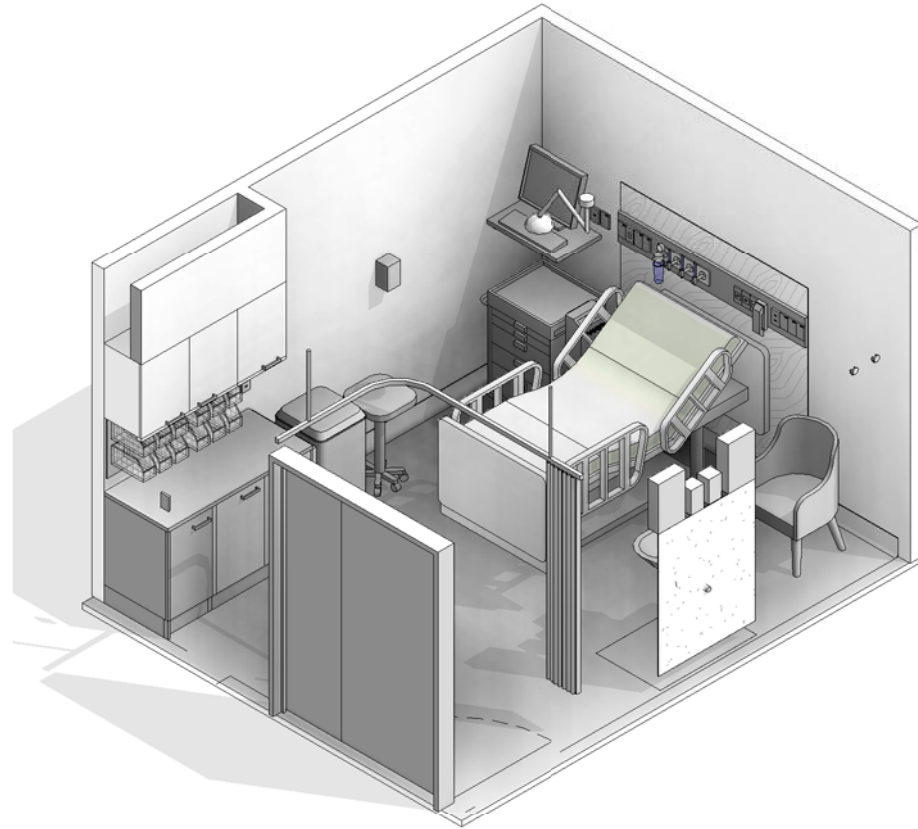
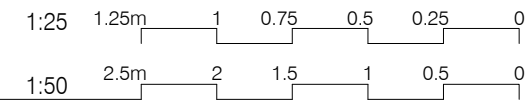

BIM ID	DESCRIPTION
1045	VINYL FLOORING, NON-SLIP
2000	FLOOR VINYL COVERED SKIRTING
2525	WALL PROTECTION - BED
2527	WALL SPLASHBACK
2529	DOOR PROTECTION FRAME - 2529
2712	DOOR PROTECTION PLATE - 2712
FE-3100	BASIN - SCRUB, TYPE A
FE-5622	BED - INPATIENT, ELECTRIC + STANDARD PATIENT MATTRESS
FE-5857	LIGHT PROCEDURE - SMALL CEILING MOUNTED
FE-11400	COMPUTER - PC & MONITOR
FE-54520	TELEPHONE - STANDARD - WALL MOUNTED HANDSFREE
FF-150	AIR FLOWMETER
FF-1050	BENCHTOP - LAMINATE
FF-1465	BRACKET - SUCTION BOTTLE
FF-1470	BRACKET - SHARPS
FF-1480	COMPUTER PACS BRACKET
FF-2150	CHAIR - PATIENT
FF-3350	CLOCK - BATTERY OPERATED_FF-3350
FF-3400	COAT HOOK
FF-4410	CUPBOARD - UNDER BENCH DOUBLE - 970W X 870H X 600D
FF-4420	CUPBOARD - UNDER BENCH - 450W X 870H X 600D
FF-4470	CUPBOARD - WALL MOUNTED, LOCKABLE
FF-4472	CUPBOARD - OVERHEAD - SINGLE 450W X 600H X 350D
FF-4600	CURTAIN TRACK - BED SCREEN
FF-5000	CURTAIN - BED SCREEN

BIM ID	DESCRIPTION
FF-5824	WASTE BIN, GENERAL
FF-5830	DISPENSER - ANTISEPTIC HAND RUB
FF-5975	WASTE BIN - CLINICAL - 120L
FF-6152	DISPENSER - DISPOSABLE GLOVES
FF-6154	DISPENSER - HAND TOWEL
FF-6156	DISPENSER - SOAP
FF-6158	DISPENSER - SOAP ANTISEPTIC
FF-6600	TROLLEY - DRESSING
FF-12900	LOUVRED PANEL
FF-16250	OXYGEN FLOWMETER
FF-19700	SHARPS BINS
FF-21700	STOOL - ADJUSTABLE - HIGH
FF-21755	STORAGE BINS - FOR LOUVRED PANEL
FF-21950	SUCTION ADAPTER
FF-22000	SUCTION BOTTLE
S-1005	VOICE DATA OUTLET - SINGLE
S-1006	VOICE DATA OUTLET - DOUBLE
S-1951	STAFF ASSIST CALL
S-6055	SPECIAL TASK LIGHT, BUILT-IN
S-6200	LIGHT SWITCH
S-7000	MEDICAL GAS OUTLET - OXYGEN
S-7020	MEDICAL GAS OUTLET - MEDICAL AIR
S-7040	MEDICAL GAS OUTLET - SUCTION
S-8000	PATIENT TO STAFF CALL
S-8005	PATIENT CALL HANDSET
S-8080	EMERGENCY CALL
S-9000	GENERAL POWER OUTLET - SINGLE
S-9001	GENERAL POWER OUTLET - SINGLE
S-9001	GENERAL POWER OUTLET - DOUBLE
S-9010	EMERGENCY POWER OUTLET - SINGLE
S-9040	BODY PROTECTED
S-10005	DURESS ALARM

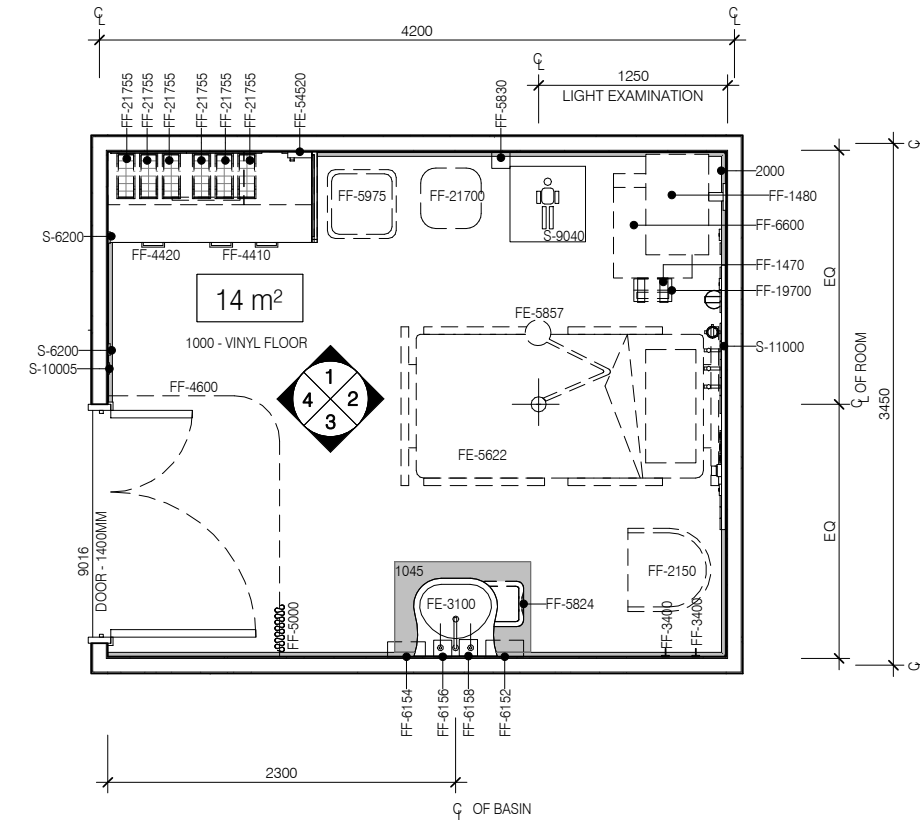

PLAN

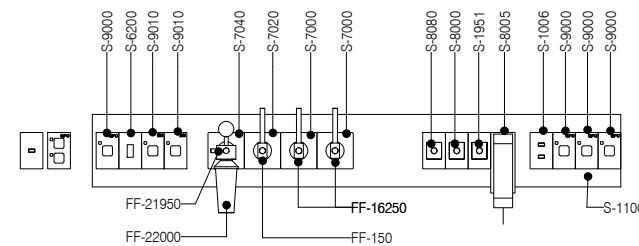

ELEVATION 5 (1 : 25 @ A3)

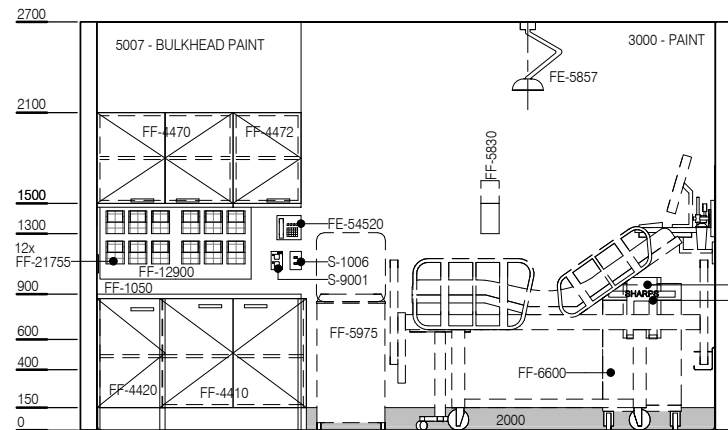

ELEVATION 1

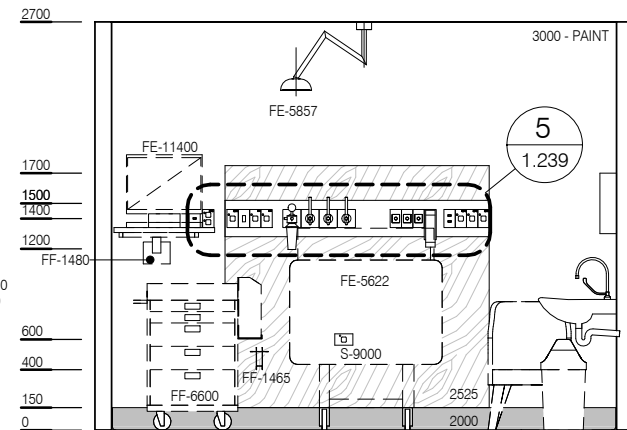

ELEVATION 2

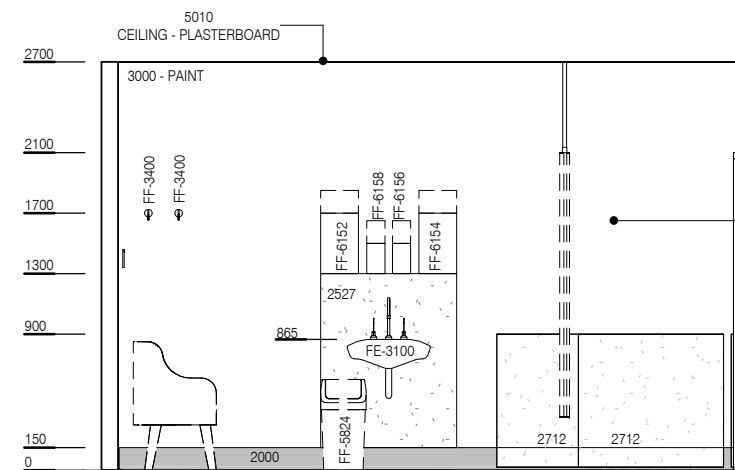

ELEVATION 3

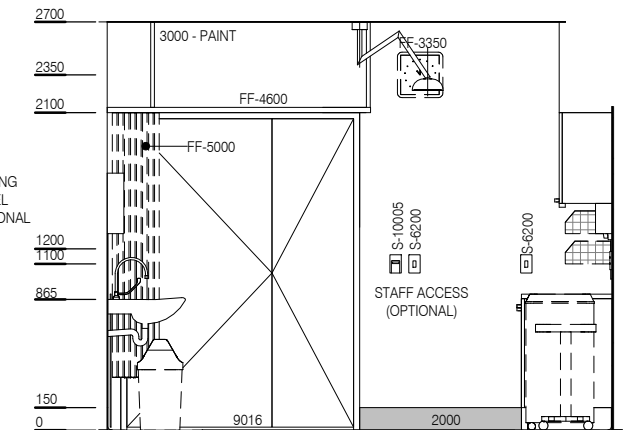

ELEVATION 4



REV	DESCRIPTION	DATE
6	This RLS has been reviewed, redocumented and reissued	01.03.2016

FOR GUIDANCE

SCALE	RLS Room Code	Room Tag	REV
1 : 50 @ A3	TRMT	1.239	6