

# AUSTRALASIAN HFG STANDARD COMPONENTS

Room Layout Sheet

RLS Room Code: **ULTR**

Room Name:

**ULTRASOUND**

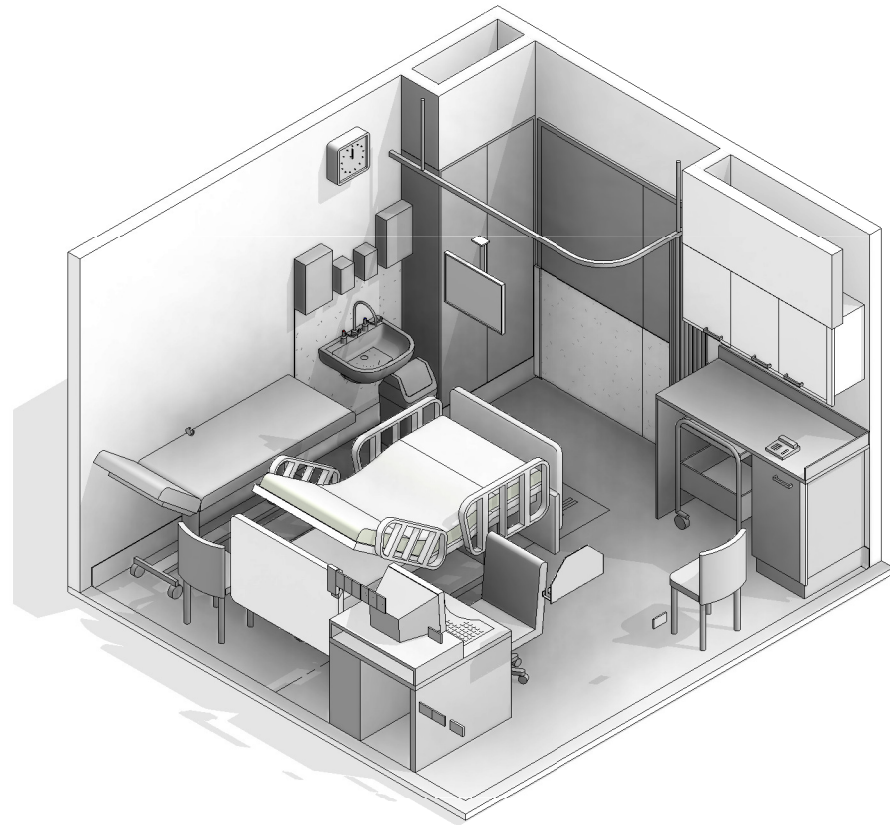
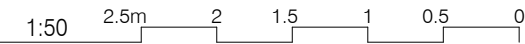

CODE	DESCRIPTION
CLGE-001	CEILING: plasterboard, bulkhead, paint
DWPR-006	DOOR PROTECTION: protection plate, to 900 AFFL, PVC, prefinished
DWPR-010	DOOR PROTECTION: to door frame, PVC, prefinished
ELBO-015	SWITCH: light, single
ELGP-106	GPO: single, special, for equipment
ELGP-109.1	GPO: single, wall mounted (V)
ELGP-110	GPO: single, wall mounted, cleaner
ELGP-208	GPO: double, wall mounted
ELGP-209.1	GPO: double, wall mounted, RCD protected (V)
ELPR-001	BODY PROTECTED ELECTRICAL AREA
FIDI-014	DISPENSER: disposable glove
FIDI-025	DISPENSER: paper/hand towel
FIDI-030	DISPENSER: soap
FIDI-031	DISPENSER: soap antiseptic
FIHR-004	BRACKET: for display screen, ceiling mounted
FIHR-026	HOOK: coat
FIHR-055	RACK: scanhead
FUJO-059	BENCH TOP: 600D, joinery under, laminate finish
FUJO-120	CUPBOARD: tall, double door, sliding, adj shelves
FUJO-140	CUPBOARD: underbench, single door, adj shelves
FUJO-145	CUPBOARD: wall mount, double door, adj shelves, lockable
FUJO-157	CUPBOARD: wall mount, single door, adj shelves, lockable
FIRT-032	TRACK: curtain, privacy, L shaped
FLSK-010	SKIRTING: vinyl, floor vinyl coved, 150H, prefinished
FLVY-007	FLOOR FINISH: vinyl, seamless, coved, standard slip resistant
FOBS-018	CHAIR: office, ergonomic
FOBS-028	CHAIR: visitor, clinical areas
FOBS-037	FOOTSTOOL
FQCW-016	BIN: waste, general, 20L
FQGE-005	CLOCK: analogue, battery operated
FQGE-010	CURTAIN: privacy screen
FQSM-016	TROLLEY
HYBA-010	BASIN: handwash, Type B
HYTP-037	TAPWARE: mixer, elbow levers
ITCL-004	BUTTON: nurse call, emergency
ITCL-006	BUTTON: nurse call, patient to staff
ITCL-008	BUTTON: nurse call, staff assist
ITCL-028	HANDSET: nurse call, with patient to staff call button
ITIN-026	OUTLET: data, double RJ45, wall mounted
ITN-049	TELEPHONE: handset, desktop
MMBE-010	BED: patient, electric with mattress
MMBE-024	COUCH: examination, manual, mobile
MMMI-329	DEVICE: imaging, ultrasound scanning unit
MMMI-340	DISPLAY SCREEN: slave, for ultrasound
WLWA-004	WALL FINISH: paint, acrylic, washable
WLWA-010	WALL FINISH: splashback, vinyl

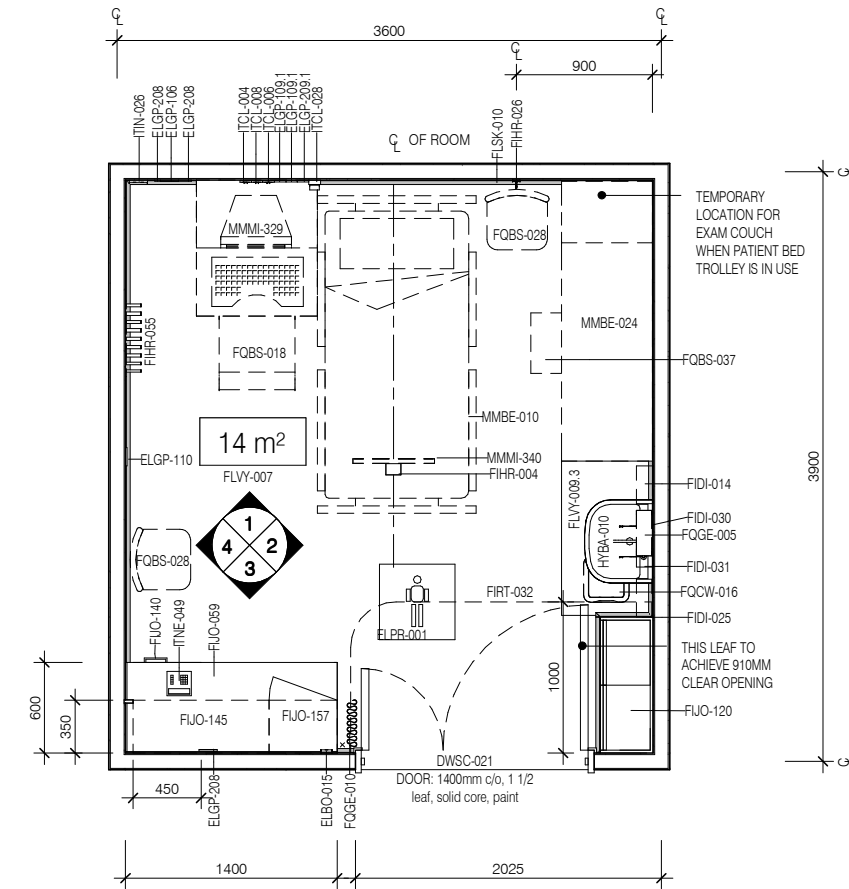

**PLAN**

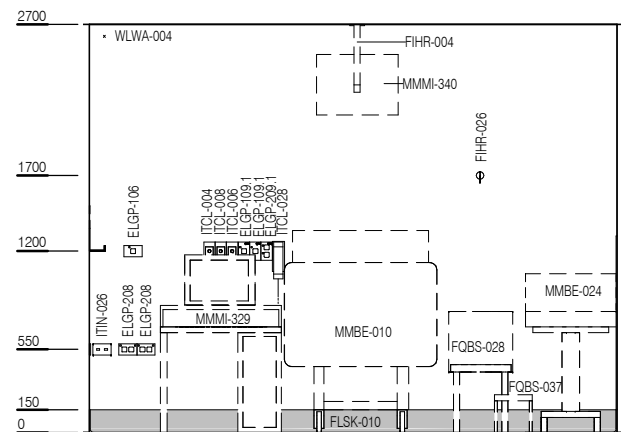

**ELEVATION 1**

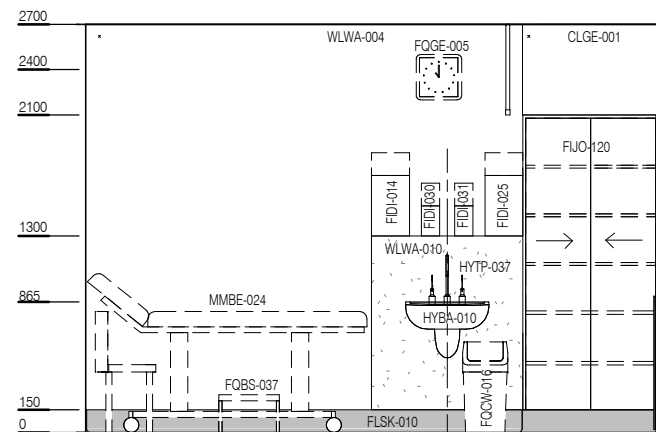

**ELEVATION 2**

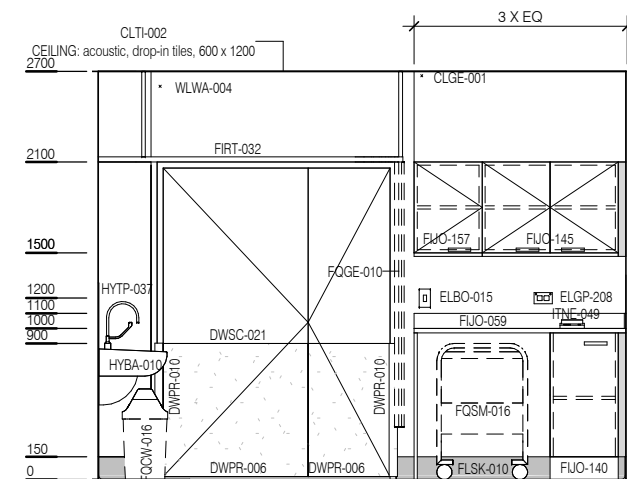

**ELEVATION 3**

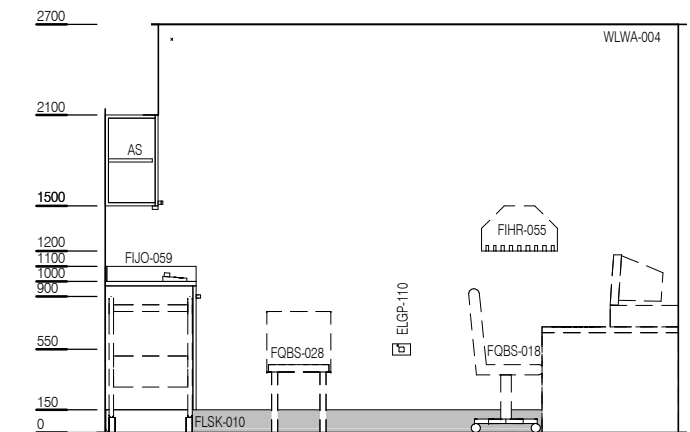

**ELEVATION 4**



REV	DESCRIPTION	DATE
4	Coding and naming updated	20.03.2017

**FOR GUIDANCE**

SCALE	RLS Room Code	REV
1 : 50 @ A3	ULTR	4