

AUSTRALASIAN HFG STANDARD COMPONENTS

Room Layout Sheet

RLS Room Code: **WAIT-SEC**

Room Name:

WAITING - SECURE, 6m²

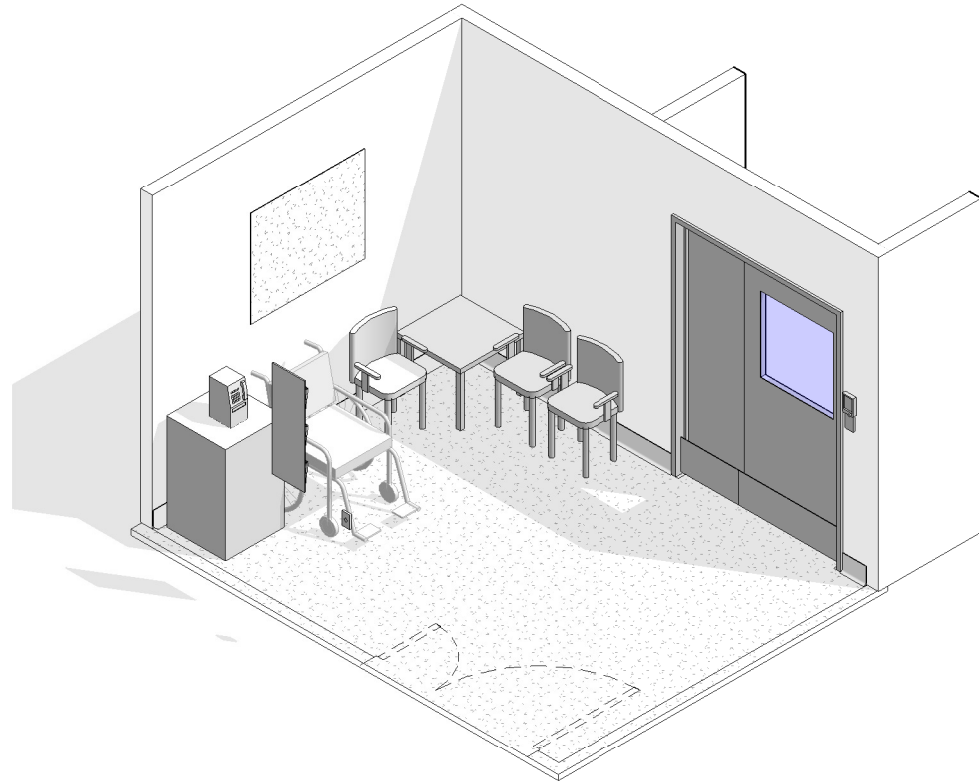
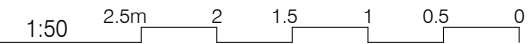

CODE	DESCRIPTION
ELGP-208	GPO: double, wall mounted
FIBM-013	NOTICEBOARD: fixed, fabric covered
FIHR-045	RACK: magazine/pamphlet
FLCP-003	FLOOR FINISH: carpet, broadloom, 48 oz., 90/10 wool/nylon
FLSK-009	SKIRTING: vinyl, leather edged, 150H, prefinished
FOBS-032	CHAIR: waiting
FOGE-080	STAND: public telephone
FQTA-075	TABLE: square, 600W, low height
ITIN-016	OUTLET: data, single RJ45, wall mounted
ITNE-057	TELEPHONE: public
ITSE-023	DOOR RELEASE: access control, buzzer
MMBE-045	WHEELCHAIR
WLWA-004	WALL FINISH: paint, acrylic, washable
DWPR-003	DOOR PROTECTION: kickplate, to 300 AFFL, vinyl, prefinished
FLSK-009	SKIRTING: vinyl, leather edged, 150H, prefinished
ITSE-023	DOOR RELEASE: access control, buzzer
ITSE-029	INTERCOM: audio, wall mount
WLWA-004	WALL FINISH: paint, acrylic, washable

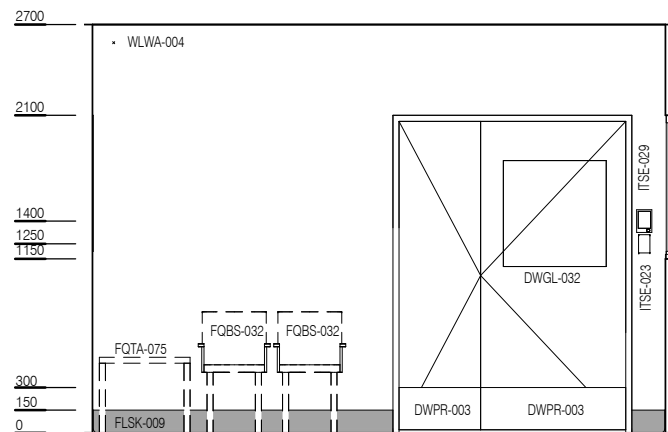
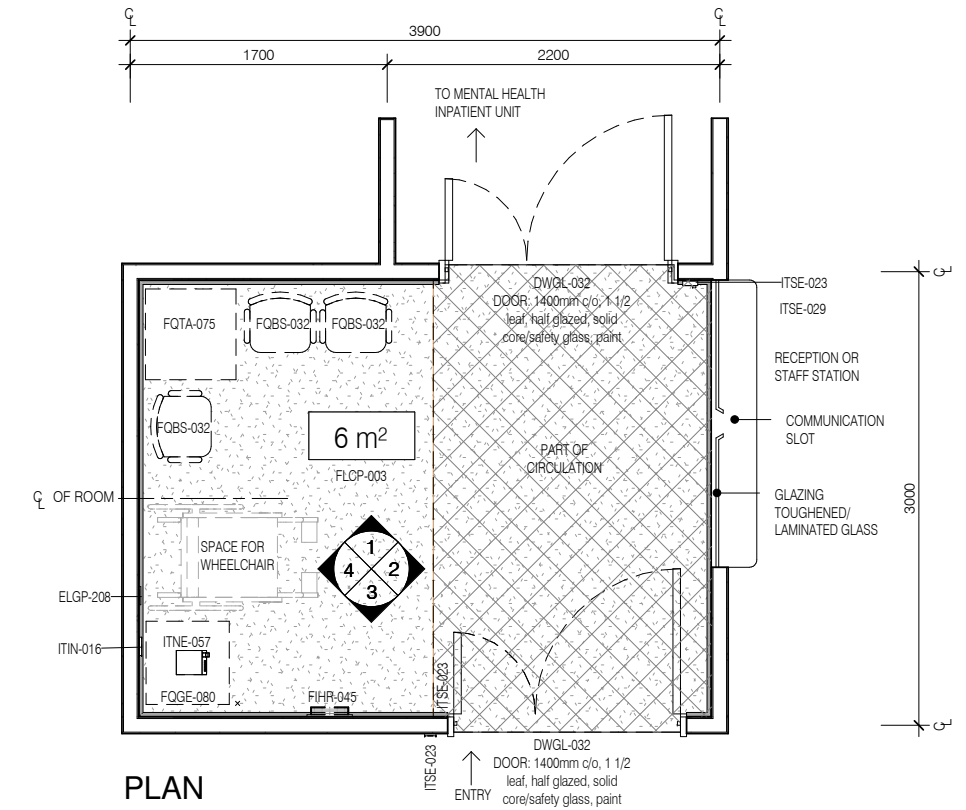

ELEVATION 1

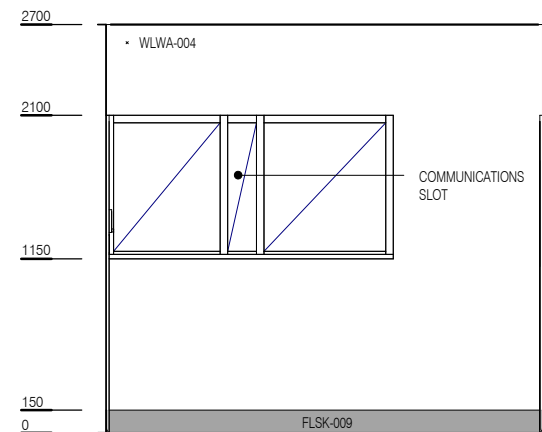

ELEVATION 2

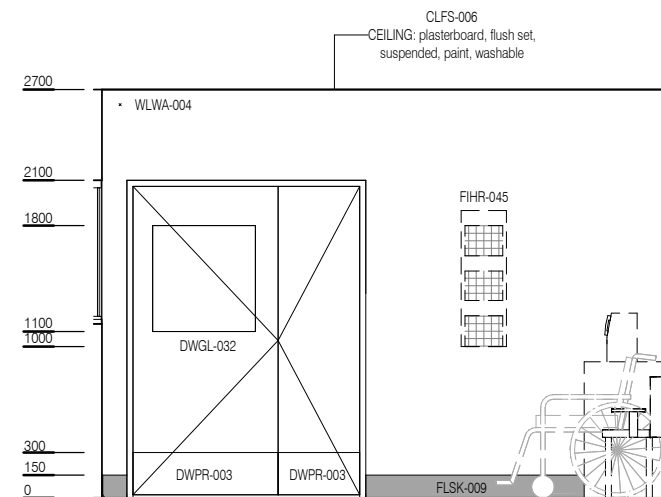

ELEVATION 3

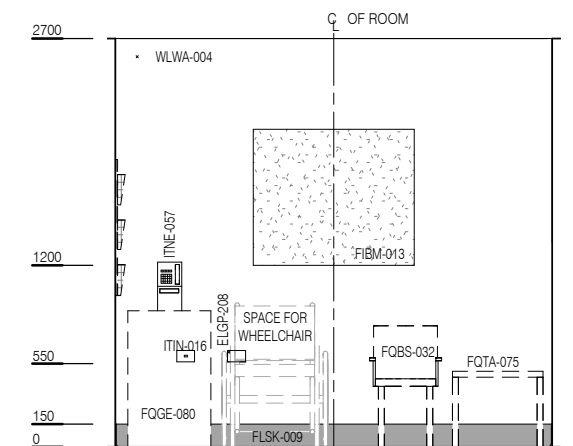

ELEVATION 4



REV	DESCRIPTION	DATE
3	Coding and naming updated	20.03.2017

FOR GUIDANCE

SCALE	RLS Room Code	REV
1 : 50 @ A3	WAIT-SEC	3